

Smart Lock Matter Gateway

G6

Manual

Introduction

The Smart Lock Matter Gateway G6 not only supports basic gateway functions such as remote unlocking, remote smart lock management, and remote time calibration, but also features deep compatibility with the Matter protocol. Leveraging Matter over Wi-Fi technology, this gateway seamlessly integrates smart locks into the Matter smart home ecosystem, enabling cross-brand device interoperability, cross-platform scenario control, and enriching application scenarios for smart locks.

Smart Lock Matter Gateway G6

Model:	G6
Dimensions:	75mm*75mm*23.5mm
Wireless network frequency:	2.4G
Network standard:	802.11 b/g/n
Power Supply:	Type-C 5V/500mA

Guide to lights

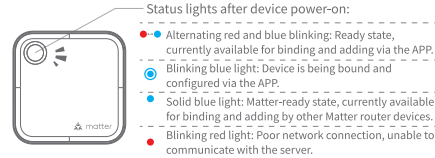

Adding the Gateway via TTlock APP

- 1 Open the TTlock APP and tap the "≡" (three-line) icon in the top-left corner.
- 2 Select "Gateway" from the dropdown menu.



- 3 Choose the gateway model "G6 Matter", then power on the gateway

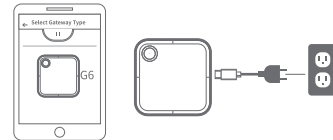

- 4 When the device's red and blue lights are alternating/blinking, select the device and tap "+" to add.
- 5 Configure the network by entering your Wi-Fi credentials, then complete the binding process.



- 6 After successful pairing, associate and bind the smart locks you want to control under the G6 gateway settings.

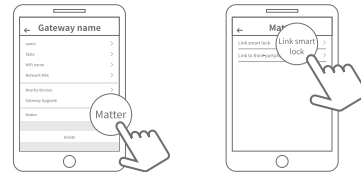

*If the binding fails due to timeout, restart the gateway by disconnecting and reconnecting the power.
*Before associating locks, ensure they are already bound to the APP. If not, bind the lock to the APP first, then link it to the gateway.

Adding the Gateway via Apple Home App

- 1 Open the TLock APP, select your gateway device, choose "Matter", then tap "Link to Third-Party App" to activate the Matter provisioning state.

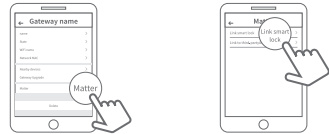

- 2 Open the Apple Home app, tap the "+" icon in the top-left corner, select "Add Accessory" > "Scan Setup Code".



- 3 Use the Home app to scan the QR code on the G6 Matter Gateway.

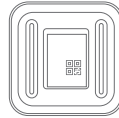

- 4 After successful binding, you can unlock via the device card (requires prior lock association).



- 5 Customize the device name, assign rooms, or adjust settings as needed.

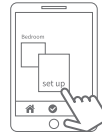

⚠ Note: Ensure a HomePod is already added to the Home app before pairing the G6 Matter Gateway. For HomePod setup, refer to Apple's official documentation. Lock association must be completed in the TLock APP before unlocking via the Home app.

Limited Warranty

1. Within 7 days of purchase, if the product has a non-human-caused quality issue, you may choose a full refund or a replacement of the same model.
2. Within 15 days of purchase, if the product has a non-human-caused quality issue, you may choose a free replacement of the same model.
3. Within 12 months of purchase, if the product has a non-human-caused performance malfunction, free repair service will be provided.

Disclaimer:
We continuously optimize products as new technologies and features are developed. For this reason, we reserve the right to make alterations to the products without prior notice.

FCC WARNING

This device complies with part 15 of the FCC Rules. Operation is subject to the following two conditions: (1) This device may not cause harmful interference, and (2) this device must accept any interference received, including interference that may cause undesired operation.

Note: This equipment has been tested and found to comply with the limits for a Class B digital device, pursuant to part 15 of the FCC Rules. These limits are designed to provide reasonable protection against harmful interference in a residential installation. This equipment generates, uses and can radiate radio frequency energy and, if not installed and used in accordance with the instructions, may cause harmful interference to radio communications. However, there is no guarantee that interference will not occur in a particular installation. If this equipment does cause harmful interference to radio or television reception, which can be determined by turning the equipment off and on, the user is encouraged to try to correct the interference by one or more of the following measures:

- Reorient or relocate the receiving antenna.
- Increase the separation between the equipment and receiver.
- Connect the equipment into an outlet on a circuit different from that to which the receiver is connected.
- Consult the dealer or an experienced radio/TV technician for help.

Note: The Grantee is not responsible for any changes or modifications not expressly approved by the party responsible for compliance. Such modifications could void the user's authority to operate the equipment.

The device has been evaluated to meet general RF exposure requirement. To maintain compliance with FCC's RF exposure guidelines, the distance must be at least 20 cm between the radiator and your body, and fully supported by the operating and installation configurations of the transmitter and its antenna(s).