

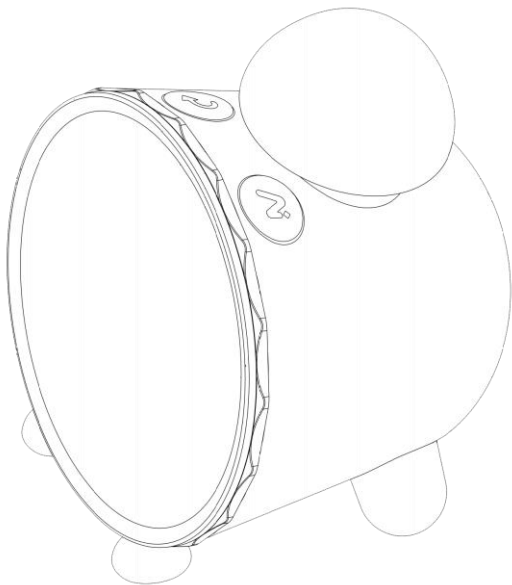

Quick Start

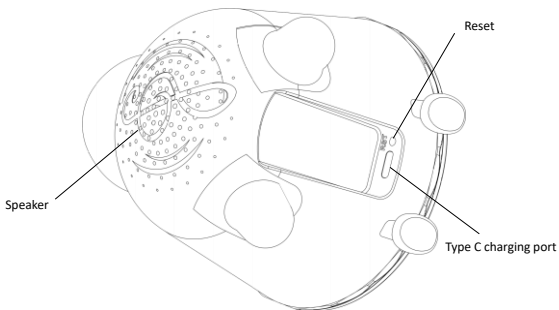

■ Get to know the product

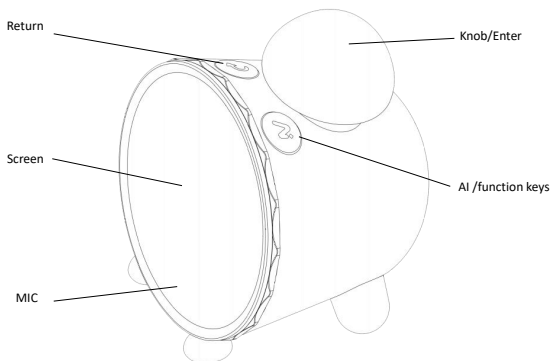

■ **Activate your Alclock**

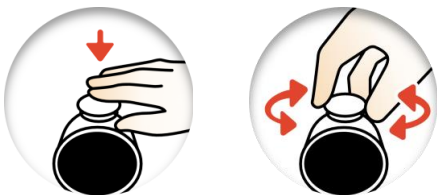

For the first time, press and hold the knob for more than 3 seconds to activate your Alclock.

When activating for the first time, plug in the power supply.

Please follow the screen guide pages to learn how to use the function keys, set the language, the international time zone where you are located, set the time/date display format, configure the network, and read the wake word.

■ **Setup your Alclock**

After the Alclock is activated, you can enter the menu interface by pressing the knob. Rotate the knob to choose themes, the AI assistant, three types of timers as well as the settings interface.

➤ **Choose a theme**

Press the knob on the standby interface, rotate the knob to select the theme, press the knob again to enter the theme menu, and rotate the knob to select the theme you like.

➤ **Setup**

Press the knob on the standby interface, rotate the knob to select the setting, press the knob to enter the settings interface, you can set the language, set Wi-Fi, time, date, time zone, system volume, alarm volume, screen brightness, knob light, power saving mode (sleep mode), do not disturb mode, about the interface to find the latest software updates, restore the device and other operations.

➤ **AI assistant**

In the standby interface, you can wake up the AI assistant by saying: "Hello Timi" voice, or you can wake up the voice assistant by pressing and holding the AI button; After the AI assistant responds, you can set an alarm clock or schedule

by voice, or set your Alclock, and you can also interact with the AI assistant by voice, check the weather, quiz knowledge, interact with communication, and play music. Note: You need to wait for 2 seconds before you can wake up the AI assistant by voice during the animation playback on the standby interface. When your Alclock enters sleep mode, you need to press the knob first to exit the sleep mode before you can wake up the AI assistant by voice.

➤ **Shutdown**

Enter the shutdown interface by pressing and holding the knob, rotate the knob to select power off and press the knob again, and the device will power off. When the power is off for a long time, the charging cable plug should be unplugged.

➤ **Safety Information**

Please read the safety information tips before using the device to avoid dangerous or illegal situations.

Impact on medical devices: The radio waves generated by the device may affect the proper functioning of medical devices or personal medical devices implanted in the human body. If you are using such a device as a pacemaker, cochlear implant, hearing aid, etc., please check with the medical device supplier for restrictions on the use of the device.

Operating environment: Please use the device in the range of 0-40℃, and store the device in the range of -20℃-70℃, when the ambient temperature is too low or too high, it may cause damage to the device.

Accessories requirements: Only accessories approved by the equipment manufacturer can be used, and the charging cable should use the original charging cable or 5V1A qualified charging cable.

Power Requirements: The power plug is used as a device to disconnect the power supply to the device, and the power plug should be removed when this device is not in use.

Environmental protection: Do not dispose of this appliance as ordinary household waste. Please comply with local laws regarding the recycling of this device and accessories and support the recycling action.

FCC Warning

This device complies with Part 15 of the FCC Rules. Operation is subject to the following two conditions:

(1) This device may not cause harmful interference, and (2) this device must accept any interference received, including interference that may cause undesired operation.

NOTE 1: This equipment has been tested and found to comply with the limits for a Class B digital device, pursuant to part 15 of the FCC Rules. These limits are designed to provide reasonable protection against harmful interference in a residential installation. This equipment generates, uses and can radiate radio frequency energy and, if not installed and used in accordance with the instructions, may cause harmful interference to radio communications. However, there is no guarantee that interference will not occur in a particular installation. If this equipment does cause harmful interference to radio or television reception, which can be determined by turning the equipment off and on, the user is encouraged to try to correct the interference by one or more

of the following measures:

- Reorient or relocate the receiving antenna.
- Increase the separation between the equipment and receiver.
- Connect the equipment into an outlet on a circuit different from that to which the receiver is connected.
- Consult the dealer or an experienced radio/TV technician for help.

NOTE 2: Any changes or modifications to this unit not expressly approved by the party responsible for compliance could void the user's authority to operate the equipment.

The device has been evaluated to meet general RF exposure requirement. The device can be used in portable exposure condition without restriction.



快速入门手册

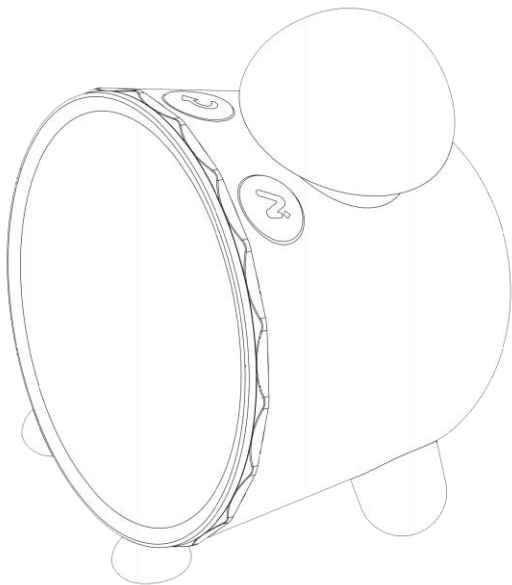

■ 快速入门

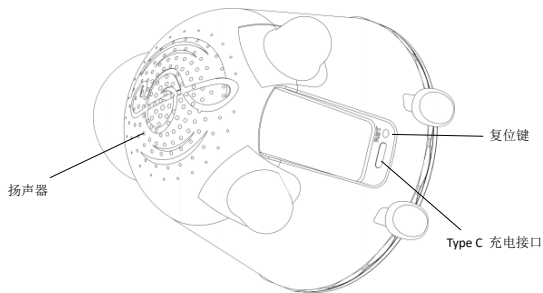
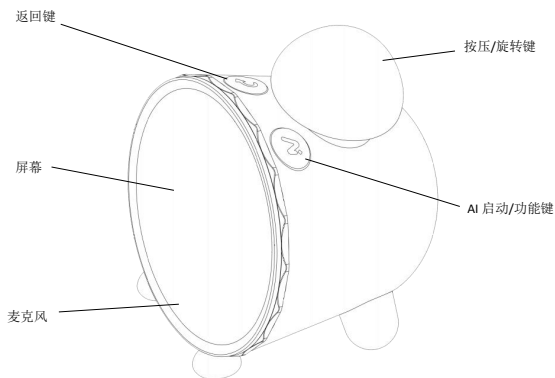

■ 激活 Alclock

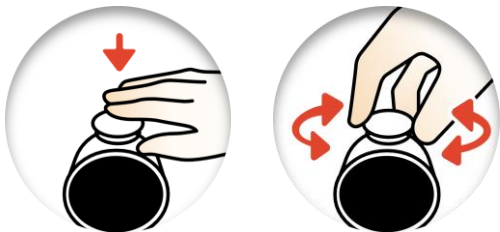

初次使用，请长按旋钮 3 秒以上可激活您的 Alclock。首次激活时，请插入电源。

请按屏幕引导页面学习功能键使用，设置语言，所在地国际时区，设置时间/日期显示格式，配置网络，跟读唤醒词。

■ 设置 Alclock

Alclock 激活后，你可以通过按压旋钮进入菜单界面，旋转旋钮选择主题、AI 助手、三种计时器以及设置界面。

➤ 选择主题

待机界面按压旋钮，旋转旋钮选择主题，再次按压旋钮进入主题菜单，旋转旋钮选择你喜欢的主题。

➤ 设置

待机界面按压旋钮，旋转旋钮选择设置，按压旋钮进入设置界面，你可以设置语言、设置 wifi、时间、日期、时区、系统音量、闹钟音量、屏幕亮度、旋钮灯、省电模式（休眠模式）、勿扰模式、关于界面可以查找最新软件更新、还原设备等操作。

➤ AI 助手

在待机界面时，你可以通过说：“Hello Timi”语音唤醒 AI 助手，你也可以通过长按 AI 键唤醒语音助手；AI 助手回应后你可以语音设置闹钟或日程，或设置你的 Alclock，你也可以与 AI 助手语音互动，查天气、知识问答、互动沟通、播放音乐。注意：待机界面动画播放过程中需等待 2 秒后才能语音唤醒 AI 助手。当你的 Alclock 进入休眠模式时需要先按压旋钮，退出休眠模式后才能语音唤醒 AI 助手。

➤ 关机

通过长按旋钮键进入关机界面，旋转旋钮选择关机并再次按下旋钮，设备关机。长时间关机时应拔除充电线插头。

➤ 安全信息

在使用设备前请阅读安全信息提示，以避免出现危险或违法情况。

对医疗设备的影响：设备产生的无线电波可能会影响人体植入的医疗设备或个人医用设备的正常工作。如起搏器、植入式耳蜗、助听器等，如您使用了该类设备，请与医疗设备供应商确认使用相关设备的限制条件。

操作环境：请在 0-40℃ 范围环境中使用设备，并在 -20℃-70℃ 范围环境下存储设备，当环境温度过低或过高时可能引起设备损坏。

配件要求：只能使用设备商认可的配件，充电线应使用原装充电线或 5V1A 合格充电线。

电源要求：电源插头作为断开设备电源的装置，当不使用本设备时应拔出电源插头。

环境保护：请勿将本设备作为普通生活垃圾处理。请遵守本设备及附件回收处理的本地法律，并支持回收行动。