

TABLO™ TV

Quick-Start Guide

TabloTV.com



Download the Tablo
app to get started.
TabloTV.com/install

TOTAL SYSTEM
TABLO + TV ANTENNA



©2024 Nuvyyo USA, LLC. All rights reserved. Tablo and Tablo TV are trademarks of Nuvyyo USA, LLC.
All third-party trademarks, including logos, are the property of their respective owners.

NUV-TF1282B-AN-03

WHAT YOU NEED FOR SETUP



An iOS or Android smartphone or tablet



A home Wi-Fi router with internet access



A compatible smart TV or streaming media device

For a list of all compatible devices such as Roku, Amazon Fire TV, Android TV, Apple TV or Samsung TV or LG, visit tablotv.com/start

WHAT'S IN THE BOX



**Tablo
Device**



Antenna



**Coaxial
Cable**



**Ethernet
Cable**



**Power
Supply**



**Quick-Start
Guide**

FCC Radiation Exposure Statement

This device complies with FCC radiation exposure limits set forth for an uncontrolled environment. This equipment must be installed and operated in accordance with provided instructions and the antenna(s) used for this transmitter must be installed to provide a separation distance of at least 20 cm from all persons.

Caution!

Any changes or modifications not expressly approved by the party responsible for compliance could void the user's authority to operate the equipment.

Canada IC Statement

This device contains licence-exempt transmitter(s)/receiver(s) that comply with Innovation, Science and Economic Development Canada's licence-exempt RSS(s). Operation is subject to the following two conditions:

- (1) This device may not cause interference.
- (2) This device must accept any interference, including interference that may cause undesired operation of the device.

L'émetteur/récepteur exempt de licence contenu dans le présent appareil est conforme aux CNR d'Innovation, Sciences et Développement économique Canada applicables aux appareils radio exempts de licence. L'exploitation est autorisée aux deux conditions suivantes :

- 1) L'appareil ne doit pas produire de brouillage;
- 2) L'appareil doit accepter tout brouillage radioélectrique subi, même si le brouillage est susceptible d'en compromettre le fonctionnement.

The device meets the exemption from the routine evaluation limits in section 2.5 of RSS 102 and compliance with RSS-102 RF exposure, users can obtain Canadian information on RF exposure and compliance.

Le dispositif rencontre l'exemption des limites courantes d'évaluation dans la section 2.5 de RSS 102 et la conformité à l'exposition de RSS-102 rf, utilisateurs peut obtenir l'information canadienne sur l'exposition et la conformité de rf.

This transmitter must not be co-located or operating in conjunction with any other antenna or transmitter. This equipment should be installed and operated with a minimum distance of 20 centimeters between the radiator and your body.

Cet émetteur ne doit pas être Co-placé ou ne fonctionnant en même temps qu'aucune autre antenne ou émetteur. Cet équipement devrait être installé et actionné avec une distance minimum de 20 centimètres entre le radiateur et votre corps.

The device for operation in the band 5150-5250 MHz is only for indoor use to reduce the potential for harmful interference to co-channel mobile satellite systems

Les dispositifs fonctionnant dans la bande 5150-5250 MHz sont réservés uniquement pour une utilisation à l'intérieur afin de réduire les risques de brouillage préjudiciable aux systèmes de satellites mobiles utilisant les mêmes canaux;

Operating temperature: 0-40°.

Warning:

If the power adapter is disconnected from the Tablo device, the power adapter shall still remain active unless disconnected from power source.

Use only with Tablo supplied power adapter: SA180-120150U/FC018A03-120015U

WARRANTIES & RETURNS

Having trouble? Before returning Tablo to the store, contact us first!

For questions about warranties or returns, please contact us directly at **1-844-TABLOTV (822-5688)** or email us at **support@TabloTV.com**.

We hope you love your Tablo, but if you're unhappy for any reason, we offer a 30-day return policy on new units purchased through [TabloTV.com](https://www.tablotv.com).

For units purchased through retail partners, the retailer's return policy applies. All Tablo units include a 100% repair or replacement warranty for 12 months from the original purchase date.

Tablo's complete warranty and return policy can be found on our website at [TabloTV.com/warranty-returns](https://www.tablotv.com/warranty-returns).

Use of the Tablo device and creation of your account are governed by our Terms of Use and Privacy Policy located at [TabloTV.com/terms-of-use](https://www.tablotv.com/terms-of-use) and [TabloTV.com/privacy](https://www.tablotv.com/privacy).

United States FCC Statement

This equipment has been tested and found to comply with the limits for a Class B digital device, pursuant to part 15 of the FCC Rules. These limits are designed to provide reasonable protection against harmful interference in a residential installation. This equipment generates, uses and can radiate radio frequency energy and, if not installed and used in accordance with the instructions, may cause harmful interference to radio communications. However, there is no guarantee that interference will not occur in a particular installation. If this equipment does cause harmful interference to radio or television reception, which can be determined by turning the equipment off and on, the user is encouraged to try to correct the interference by one or more of the following measures:

- Reorient or relocate the receiving antenna.
- Increase the separation between the equipment and receiver.
- Connect the equipment into an outlet on a circuit different from that to which the receiver is connected.
- Consult the dealer or an experienced radio/TV technician for help.

DOWNLOAD THE TABLO APP

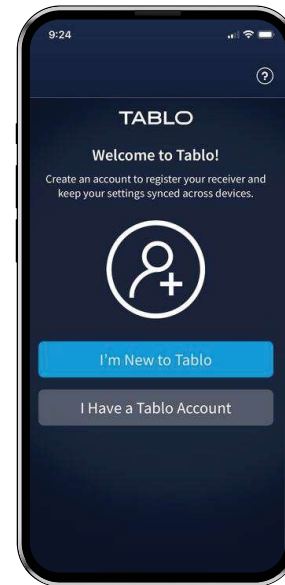

To start:

- Download the Tablo app on your smartphone or tablet.
- Scan the QR code below using your mobile device's camera to access the install page or visit **[tablotv.com/install](https://www.tablotv.com/install)** on your smartphone or tablet.
- Follow the prompts within the app to create your account and set up your Tablo.



To download the app, scan this code or visit **[TabloTV.com/install](https://www.tablotv.com/install)** on your smartphone.

While the Tablo app will guide you through the setup process, this booklet acts as a companion guide, providing detailed step-by-step instructions and helpful tips. Additional resources, answers to common questions and much more can be found at [tablotv.com/start](https://www.tablotv.com/start).

HOW TABLO WORKS



Free network TV channels are broadcast from local towers to your TV antenna.

The Tablo device connects to your TV antenna and to your home's Wi-Fi.

Tablo sends live and recorded TV wirelessly to every room in your home.

Tablo doesn't come with a remote control because it doesn't connect directly to your television. Once your Tablo device and antenna are set up, you'll use the remote that came with your smart TV or streaming device to control your Tablo through the Tablo app installed on the smart TV or streaming device.

CONTACT US



Need Help?

Find answers to common questions, how-to videos, troubleshooting tips and other first-time setup resources at TabloTV.com/start.

Or speak directly with our helpful support team:



Live chat: TabloTV.com/start



Phone: 1-844-TABLOTV (822-5688)



Email: support@TabloTV.com

NAVIGATING THE TABLO APP

Now you can watch and record TV using the Tablo app!

Home

Enjoy quick access to what's airing live, recent recordings and tailored recommendations.

Live

A familiar grid-style guide for watching live TV and seeing what's on now and over the coming weeks.

Library

See and manage your DVR schedules and recordings.

Shows, Movies, News, Sports

Browse live and upcoming programs in these streaming-style guides and set your favorite series to record.

Settings

Select the gear icon in the top right to run a new channel scan, edit your channel lineup, format external recording storage (optional) and manage other Tablo device settings.



To start watching a live TV channel, select the channel ID from the far left of the live TV grid.



America's Funniest Home Videos

WHERE TO PLACE YOUR TABLO

Before starting, select a location in your home for your Tablo.

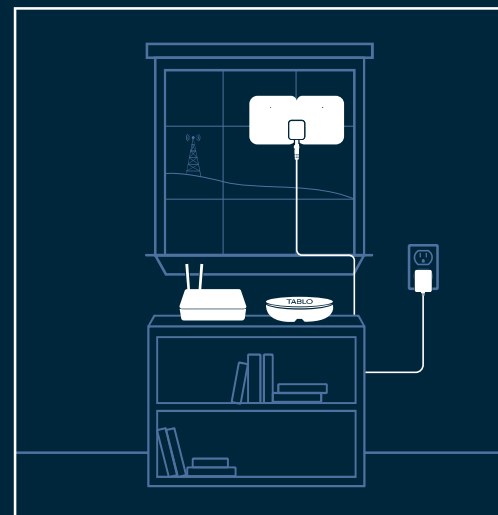

Choose a place located:

- Near your TV antenna (if you have one installed already).
- Near a power outlet (your Tablo device must remain powered on at all times).
- Near your Wi-Fi router if possible (if not, you can connect your Tablo to your network wirelessly).

**Position your TV antenna near a window on the top floor of your home, facing the direction of your local broadcast towers, and away from obstructions like trees and brick or metal walls.*

Because Tablo delivers live and recorded TV to your screens wirelessly via your home internet network, your TV antenna and your Tablo device do not need to be near your television.

HOW TO MOUNT THE TV ANTENNA

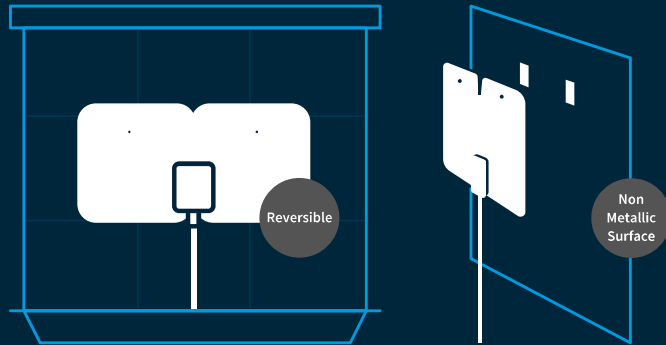

Once you've identified a good location for your TV antenna:

1. Remove the protective seal on both sides of the antenna.
2. Attach the antenna directly onto any non-metallic surface with the provided double sided stickers. The height of the antenna should be less than 6.5ft.
3. Once you have completed setup and confirmed the optimal location, use the adhesive stickers provided to securely mount the antenna and the optional cable clips to tidy the coaxial cable.

The included TV antenna is reversible, so you can choose to have the white or black side facing out to match your decor.

ACCESSING TABLO ON YOUR TV

Once you've completed the previous steps of setting up your Tablo with your smartphone or tablet, it's easy to connect your Tablo to other compatible devices in your home.

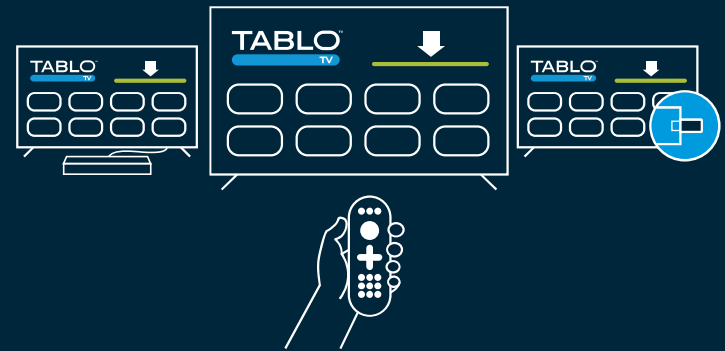

From your smart TV or streaming device's home screen, navigate to the app store and search for Tablo. Once you download and open the Tablo app, it will automatically find and connect to your Tablo over your home network.

For a full list of supported devices and apps, visit: tablotv.com/start.

Can't locate the Tablo app when searching the app store? You may need to upgrade to a newer model of compatible streaming device or connect a compatible streaming device to your television.

FINAL STEPS

Now that your Tablo device is connected to your home's internet network, you can complete the final setup steps.

Update Firmware

You may be prompted to download and install new firmware on your Tablo. This should only take a few minutes and ensure you have the best possible experience.

Set Your Location

To provide you with accurate TV listings, you must allow the Tablo app to discover your location and confirm your zip code.

Scan for Channels

Your Tablo will then use your TV antenna to scan for available local channels and use the internet to detect the included free streaming channels. If an antenna TV channel you expected to receive is not found or is not coming in with adequate signal strength, reposition your TV antenna and rescan.



Edit Your Lineup

Select the channels you would like to add or remove from your live TV guide.

Download Schedule

Once you've saved your channel lineup, your Tablo will automatically download TV guide listings for the next 24 hours. Additional data for the coming weeks will be downloaded in the background.

Wait approximately 30 minutes to allow all TV guide data listings to download before creating series recording schedules.

TABLO DEVICE CONNECTIONS

Now that you've selected the ideal location for your Tablo device, it's time to connect it.

Connect TV Antenna

Connect the end of your TV antenna's coaxial cable to the antenna port on the far right of the back of the Tablo. Finger tighten only.

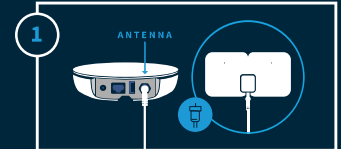

Connect Power Adapter

Plug the large end of the included power adapter into the nearest wall outlet and the small end into the power port on the far left of the back of your Tablo.

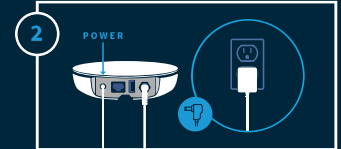

Connect Ethernet Cable (Optional)

Connect one end to your home's Wi-Fi router and the other to the Ethernet port on the left side of the back of your Tablo. (Skip this step if your Wi-Fi router is not nearby.)

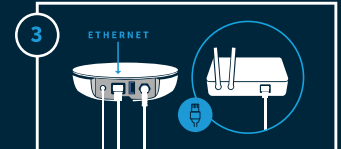

When connected, follow the prompts on the Tablo app installed on your smartphone or tablet to set up your account and finish setting up your Tablo device.

Do not connect the Ethernet cable if you are planning to connect your Tablo to the internet via Wi-Fi.

CONNECTING YOUR TABLO VIA WI-FI (Optional)

1. Check LED and Network

Ensure your Tablo's blue LED is pulsing slowly and that your smartphone or tablet is connected to the same home Wi-Fi network you'd like to use for your Tablo.

2. Connect to Your Tablo's Network

The app will prompt you to join Tablo's unique network (e.g., Tablo_XXXX). This will only appear during setup.

3. Join Your Home Wi-Fi Network

Select your home network so your Tablo can connect to it.

4. Enter Your Wi-Fi Network Password

Home network passwords are case-sensitive. Take care to enter your password correctly.

Once your Tablo device has successfully connected, its blue LED will stop flashing and turn solid blue. If your Tablo device does not connect successfully, or you encounter issues during Wi-Fi setup, visit tablotv.com/start for resources and troubleshooting tips.

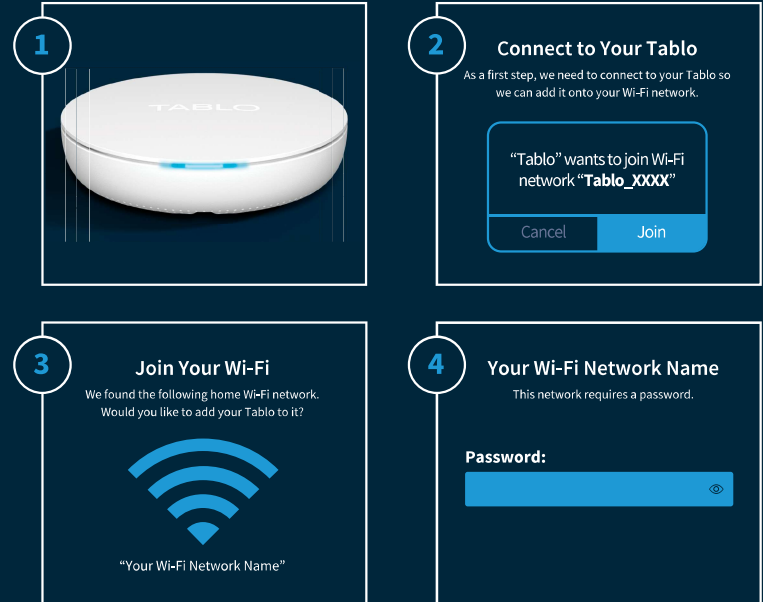

◆ To proceed with Wi-Fi setup, ensure your Tablo device is NOT connected via Ethernet and that all Virtual Private Networks (VPNs) are disabled as this will prevent device-to-device communications.