

## FCC STATEMENT

Changes or modifications not expressly approved by the party responsible for compliance could void the user's authority to operate the equipment.

This equipment has been tested and found to comply with the limits for a Class B digital device, pursuant to Part 15 of the FCC Rules.

These limits are designed to provide reasonable protection against harmful interference in a residential installation. This equipment generates uses and can radiate radio frequency energy and, if not installed and used in accordance with the instructions, may cause harmful interference to radio communications. However, there is no guarantee that interference will not occur in a particular installation. If this equipment does cause harmful interference to radio or television reception, which can be determined by turning the equipment off and on, the user is encouraged to try to correct the interference by one or more of the following measures:

- Reorient or relocate the receiving antenna.
- Increase the separation between the equipment and receiver.
- Connect the equipment into an outlet on a circuit different from that to which the receiver is connected.
- Consult the dealer or an experienced radio/TV technician for help

This device complies with part 15 of the FCC rules. Operation is subject to the following two conditions (1) this device may not cause harmful interference, and (2) this device must accept any interference received, including interference that may cause undesired operation.

This equipment complies with FCC radiation exposure limits set forth for an uncontrolled environment. This equipment should be installed and operated with minimum distance 20cm between the radiator & your body.

Serial No.: 2021M30128

# 3 Inch HD Steaming Media 4K Dash Camera

## USER MANUAL

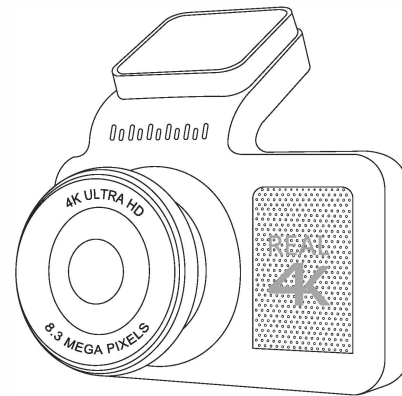

## CAUTIONS:

1. Please format the card first after inserting the card, otherwise there will be a video error and a stuck condition when playing back the video.
2. This product's power cable comes with power-off protection, and the car's flame-extinguishing machine is in the ignition-off state to enter the time lapses video and keep recording. When the voltage is low, the machine will stop recording automatically to avoid car engine can't start properly because of low voltage.
3. In the Wi-Fi interface, when mobile phone is connected to machine by Wi-Fi, video will display on mobile phone only, won't display on machine. If Wi-Fi is disconnected, video will display on machine automatically.
4. After the machine accidentally crash, long press "⏻" key to turn it off, and short press to start up again.
5. If you use OBD power, when you turn off the car, the recorder screen will remain on for about 3 minutes before turning off.
6. For the best performance and durability of video recording, we recommend to use C10 U1 level TF card or better.

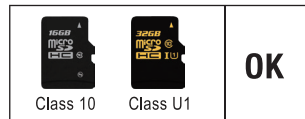
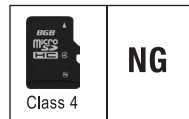

✱ This manual is only for your reference, please check the actual product as the standard!

## PACKAGE

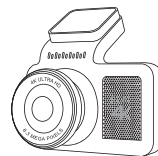

1. Dash camera

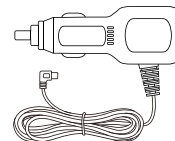

2. Car charger

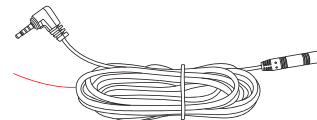

3. Extension cable



4. SD Card

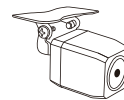

5. Rear camera

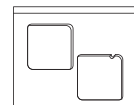

6. 3M tape and metal sheet

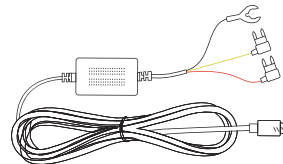

7. ACC wiring harness

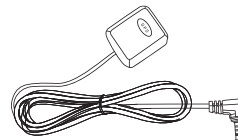

8. GPS Antenna (optional)



9. User manual

## FEATURES

- Front recording 4K
- Rear recording 1080P
- Built in mic and speaker
- Wi-Fi connection
- Parking monitor
- Time lapses video
- G-sensor
- Real-time view on app
- Waterproof rear camera
- Easy installation

## SPECIFICATIONS

Front camera	SONY 415
Front lens resolution	3840×2160 4K
Rear lens resolution	1920*1080
Display Screen	3 inch LCD
Video Format	H.264, H.265
Frequency	50 Hz 60Hz
Power Interface	Mini USB
Parking Guard	Support
Memory	SD card (MAX 128GB)
Wi-Fi	0-10m

Audio	Built in mic and speaker
G-Sensor	Support
Parking Monitor	Support
Super Capacitor	1.65F, 5.4V
Supporting platform	Android / IOS
Operation Temperature	-20°C-65°C
Storage Temperature	-30°C-80°C
Working Voltage	12V-24V
Language	English, Traditional Chinese, ..
Fixed way	3M tape or Magnet attraction

## BASIC OPERATING INSTRUCTIONS

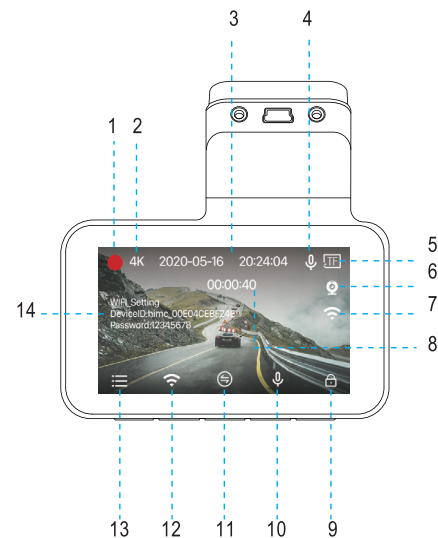

1: The red light flashing indicates the device is recording.

The blinking yellow light indicates that the current video is being locked.

2: Current recording resolution

3: Date and time display.

4: Recording sound or not.

5: Memory card identification.

6: The rear camera connected or not.

7: Wi-Fi status display.

8: Recording time.

9: Lock the current recording video

9: Video interface: Short press to switch the screen backlight;

10: Video sound on / off

11: Short press the button to switch sequentially; front and rear picture-in-picture images → Full screen image of the road ahead → Full screen image of the back road → The front and rear vertical two split screens cycle in turn

## CAUTION

### Wire Harness and Rear Camera Connection

When wiring, please align the two arrows shown in the diagram, otherwise, the wire interface may be damaged.

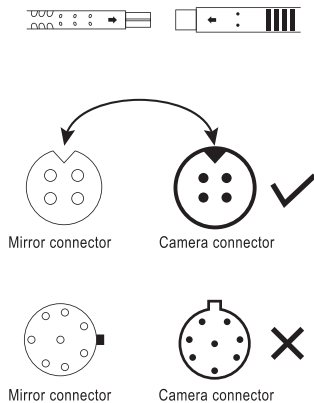
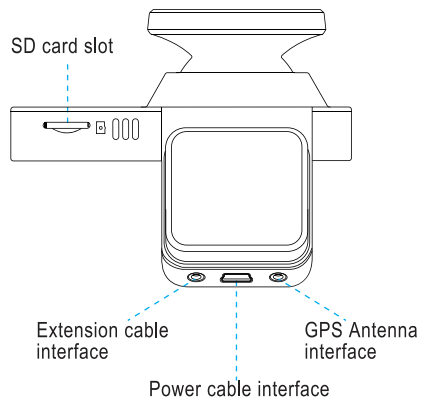

## HOW TO WIRE

### Car charger connection

\*Note: If you want to realize the parking monitoring function, you need to replace the ACC wire, and you cannot use the cigarette lighter to connect!

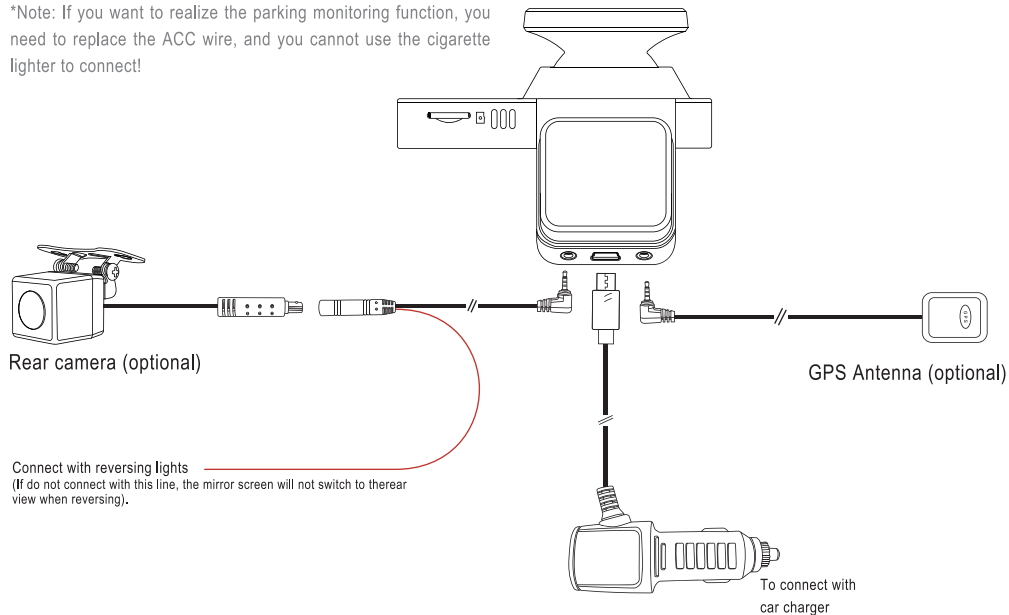

## HOW TO WIRE

Parking monitoring needs to connect ACC power control line

\*Note: If you want to realize the parking monitoring function, you need to replace the ACC wire, and you cannot use the cigarette lighter to connect!

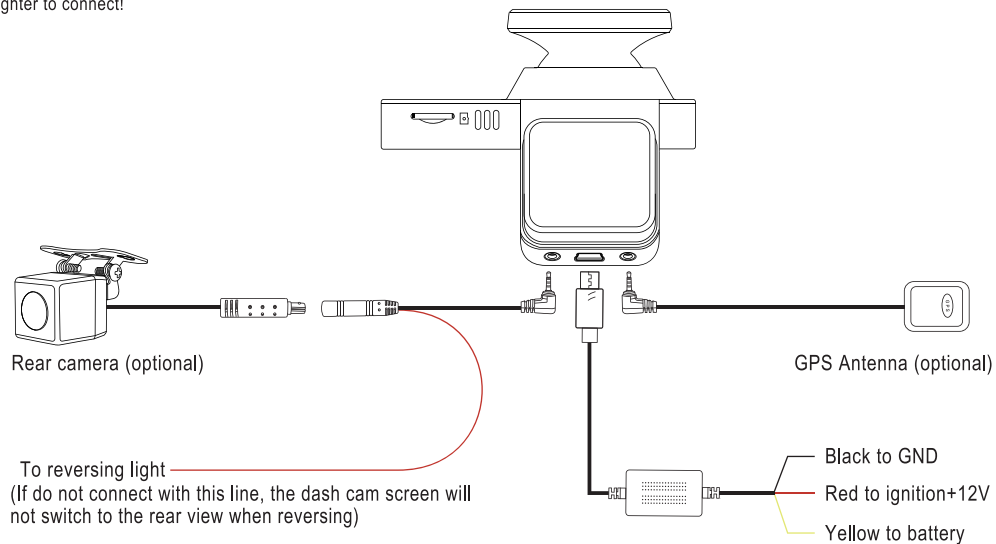

## HOW TO INSTALL

1. This recorder can be directly stuck on front windshield with equipped 3M double-sided tape.

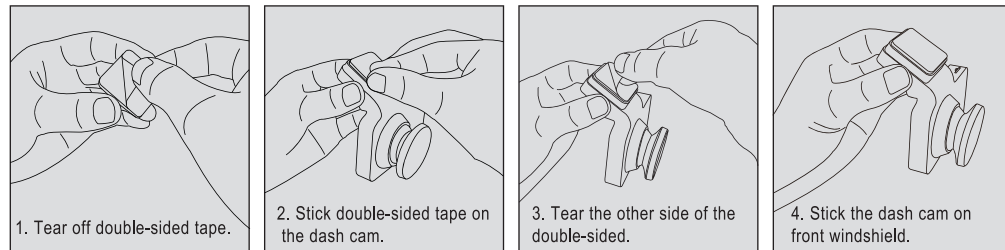

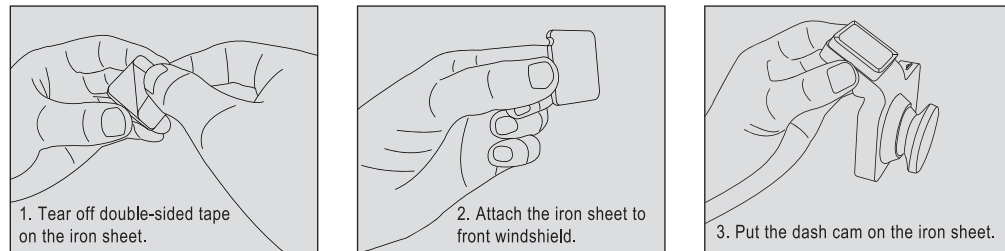

2. There is a magnet inside recorder's bracket, customer can stick iron sheet on front windshield first, then this recorder can be attracted by the iron sheet.

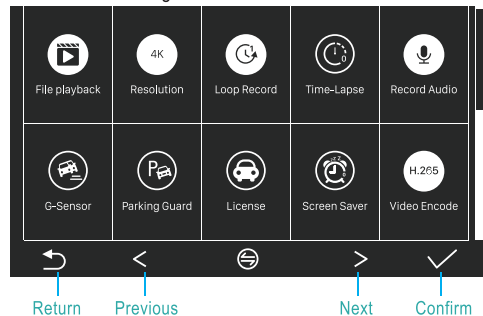

## MENU SETTINGS

Tap the icon “” in the main interface to proceed to the menu settings.



**File playback:** “Normal file”, “Event file” and “Picture file” are optional. After entering the playback page, press “” button to switch to view the front / middle / rear channel video.

**Resolution:** 4K + 1080P or 2K + 1080P .

**Loop Record:** 1 minute / 3 minutes / 5 minutes.

**Time-lapse:** “Off” “1S” “2S” “3S”.

When “OFF” is selected, the device will shut down automatically when the ACC is disconnected.

Select “1S”, “2S”, and “3S”: When ACC is disconnected, the device will automatically enter the time-lapse monitoring state and record as “1S frame”, “2S frame”, and “3S frame”.

After the ACC is powered, the device exits the time-lapse monitoring and starts normal recording. **(This function can only be used when the wire is hard line , and this function cannot be used when power by cigarette lighter)**

**Record Audio:** On / off can be set; when set to “Off”, there will be no sound in recording video.

**Sound Record:** Can set “on / off”.

**G-Sensor:** Off / High / Medium / Low can be set; when gravity sensor is turned on, the machine is subjected to collision during normal recording. When the collision acceleration value reaches the value set by G-Sensor (trigger sensitivity can be set as required), then the system will Lock the currently recorded video, and the locked video will not be covered by the loop system.

**Parking Monitor:** Off / High / Medium / Low can be set; when the dash cam is off, if it detects vibration of the car (trigger sensitivity can be set as required), then the recorder will automatically start recording for 20 seconds and then shut down.

**License:** You can set your license plate number and then display it on the recording interface and the recorded video.

**Screen Saver:** Off / 1 minute / 3 minutes.

**Video Encode:** H.264 / H.265 can be set.

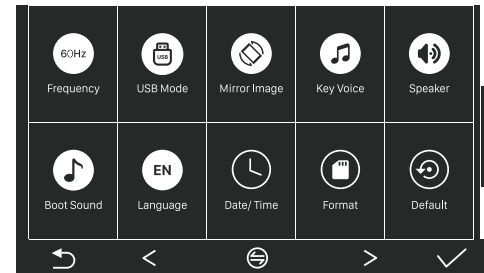

**Frequency:** 50Hz / 60Hz.

**USB Mode:** Connect the device to the PC with a USB wire and directly read the data in the machine's SD card.

**Mirror Image:** ON / OFF

**Key Sound:** On / off can be set.

**Speaker:** Off / low / medium / high.

**Boot sound:** On / off can be set.

**Language:** 8 languages optional.

**Date/Time :** time / date / time format / date format can be set.

**Format:** If the files in the SD card are not important, user can

clear all the files in the SD card with one click.

**Default:** After multiple custom settings, users can use this option to restore the recorder to the original factory setting.

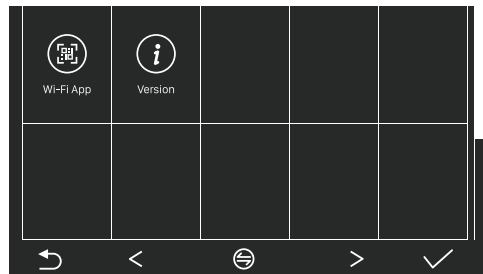

**Wi-Fi App:** Scan the QR code to download the APP, and realize the wireless connection between the mobile phone and the device through Wi-Fi.

**Version:** Check the device version number.

## MOBILE PHONE APP CONNECTION AND OPERATION MANUAL

Built-in Wi-Fi module, this machine can be connected to mobile phone through Android or IOS APP, please follow the instructions below.

1. Search "RoadCam" in the App store (Apple) or App Store (Android), or scan the QR code below to quickly install the APP.



2. Turn on the Wi-Fi of the mobile phone, and connect the Wi-Fi ID (the default name is himc\_apxxxxxxxx \_\*), enter the initial password: 12345678.



3. Open mobile phone APP, user can check the recording video and operate accordingly.

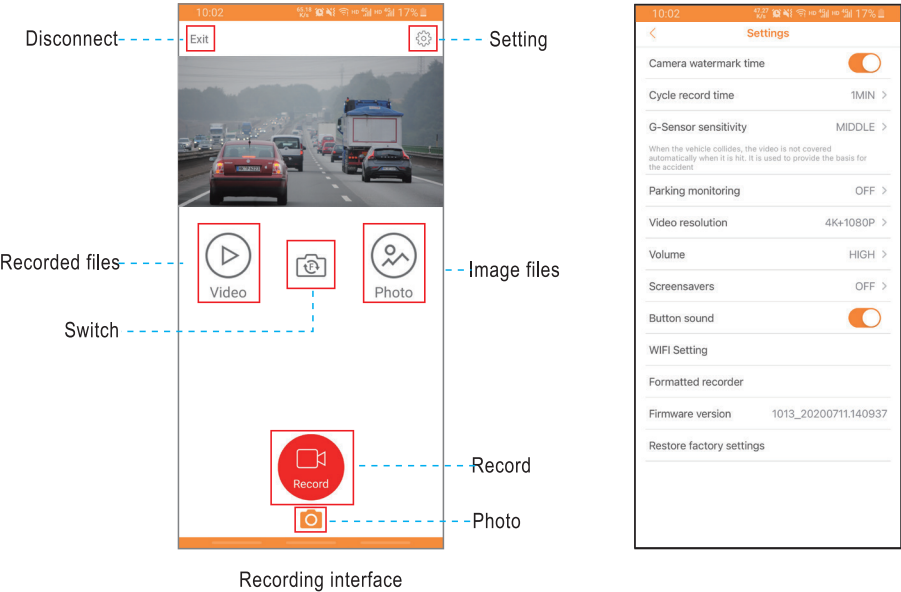

Click “” to enter the list of recorded videos, click “Edit” to switch between front and back video, download the video to the local, delete videos in batches, etc. See the figure below.

