

charge

1. This new battery pack needs to be charged before it can be used
2. Insert the wire plug of the battery pack into the plug of the charger first, and then plug the charger plug into the socket. (As shown in Figure 1) the time required for the battery to be fully charged is 2-3 hours, the charging plug has a charging indicator, no charging is the indicator light is not on, the indicator light is solid red when charging, and the indicator light is off when fully charged. Don't overcharge too much, charging for too long will not increase the power. Inspect toys and batteries regularly, and stop using the wires, plugs, and accessories of the charging cable if they are damaged until they are repaired or replaced

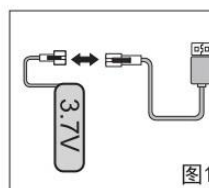

How to remotely control the car

1. Turn on the remote control car switch
2. Operate the steering stick of the remote control to remotely control the car forward or backward, left or right
3. Turn off the switch of the remote control car after use
4. When the play is over, just turn off the switch of the remote control car. The remote control will automatically go into sleep mode.

Symptoms of failure	Cause of the failure	Solution:
Vehicles cannot be exercised	The remote control does not have a connection or a switch for the remote control car Didn't open.	1. Turn on the switch of the remote control car and reconnect the remote control
	2. The remote control or remote control car is not properly loaded into the battery.	2. Put the battery into the remote control or remote control car correctly.
	3. The rechargeable battery pack has insufficient power.	3. Charge the rechargeable battery pack.
The vehicle is not controlled, and the remote control distance is close	1. The power of the battery or rechargeable battery pack in the remote control is insufficient. 2. There may be interference sources near the site,	1. Replace the battery in the remote control with a new battery, or charge the rechargeable battery pack. 2. Change the venue.
Anomaly protection	1. When the function of the remote control car is hindered by external force and cannot complete the full function, or when the circuit battery is short-circuited.	1. Turn on the power switch again and remotely control the car power-off protection

(3)

Tips for action

Please make sure that the power switch is in the "ON" position, when you are in operation, such as the power switch is in the "OFF" position, the RC car is in the OFF state. When the battery power is depleted, the left and right steering will not be sensitive, and the forward and backward will also be slower. At this point, the battery needs to be removed and charged.

The effective control distance of the remote control car is about 40 meters.

When the distance is exceeded, the RC car may stop or become uncontrolled.

Instructions

The battery charger using the toy must be inspected regularly to prevent damage to wires and other parts, and if damaged, it must be used only after the damage has been repaired.

Maintenance

1. The product should not be close to the fire source, avoid direct sunlight or high temperature and humidity, and avoid product damage and short circuit of the line.
2. Take out the batteries of the remote control car and remote control when not playing. And put the remote control car and remote control back into the color box packaging, which can avoid damage or deformation during transportation or storage.
3. After the remote control car is used, remove sand, mud, dust, etc. from the tires and body and gently wipe them with a dry cloth, and avoid wiping the lines and metal parts with a wet cloth to avoid rust and short circuit.
4. The outer metal part needs to be wiped with anti-rust oil. (Anti-rust oil needs to be purchased separately)

Tips

When the car is moving, please do not touch the wheels of the RC car with your hands to avoid injury.



1. When playing with remote control cars indoors, please be careful not to cause damage to furniture or glass,
2. Please play outdoors in a safe place. Do not play RC cars on the road and in crowds to avoid danger.
3. When you hear thunder when you are playing with a remote control car outdoors, you should stop playing immediately.
4. When the wheel is spinning, do not reach close to your hands to avoid injury, and do not get involved in hair, clothing, etc.
5. Do not drive the remote control car at people.
6. Do not throw the RC car and collide with it.
7. When placing the RC car, please keep it away from fire and high temperatures.
8. The car uses complex electronic circuits and a large number of components, please do not disassemble or modify the circuit board at will.
9. Do not put toys in water, this will damage the electronic components.

(4)



货号: UD2237A

Thank you for using our toy products, in order to make you have a better understanding of this product, please familiarize yourself with the following instructions before use, which will bring you a different sense of operation experience.

note

- Electronically controlled products
This product is suitable for children aged 6+ years. All electronic products should be used with care and prevention of electric shock.---Please use the product under the supervision of an adult Warning: Please do not disassemble or modify this product without authorization, any modification may cause the product to not work properly.

Remote control precautions

- The car uses one 3.7V rechargeable lithium battery, and the remote control uses two 1.5V "AA" non-rechargeable batteries; The battery should be removed and loaded correctly according to the polarity and voltage markings on the toy battery room, and the battery should not be short-circuited;
- Non-rechargeable batteries cannot be charged;
- Rechargeable batteries must be charged under adult supervision and rechargeable batteries should be removed from toys before charging; Different types of batteries or old and new batteries cannot be mixed; Only batteries that are the same or equivalent as the recommended batteries should be used; The exhausted battery should be removed from the toy, if it is not used for a long time, please remove the battery from the toy; the power terminal must not be short-circuited;
- Cannot be connected to more than the recommended number of power supplies; During the use of the USB cable, the wire, plug, shell and other parts should be checked regularly for damage, and if it is found to be damaged, it should be stopped until it is repaired.

2. 4G

Automatic code matching instructions

1. The remote control is equipped with the battery and turns on the switch, the indicator light of the remote control starts to flash, and the white light flashes in front of the remote control car after installing the battery and turns on the switch, and it begins to enter the connection state. When the connection is successful, the indicator light of the remote control is always red, and the front light of the car is always white. Note: If the connection is unsuccessful, please repeat the above operations. Each remote control can only be connected to one RC car, and when the connection is successful, each car will not interfere with each other. Note: No more than 2 cars can be connected at the same time.
If the remote control does not find the 2.4G signal emitted by the remote control car after one minute, it will automatically enter sleep mode (the indicator light is off), and press any button to exit the sleep mode. When you need to pair other remote controllers or RC cars of the same model, you need to turn off the remote control and the power of the RC car before re-pairing.

(1)

Product configuration

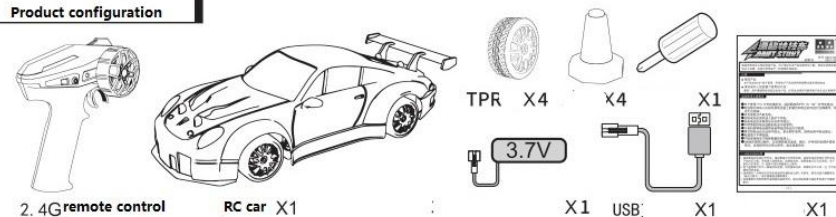

The name of the part

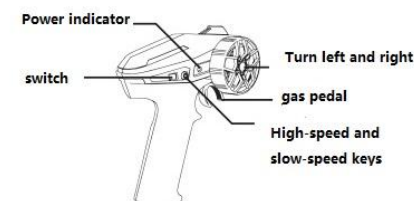
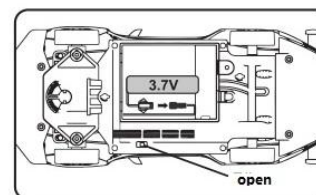

Install the remote control battery

Remote control- 1. Open the battery cover of the remote control, and insert the AA battery according to the instructions of the positive and negative poles in the battery compartment of the remote control. 2. Close the battery cover.

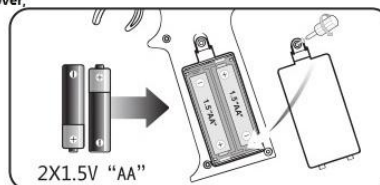

Install the RC car battery

2. 1. Open the battery cover under the car, connect the rechargeable battery pack to the power socket and put it into the battery compartment under the car. Close the battery cover and tighten it with a screwdriver.

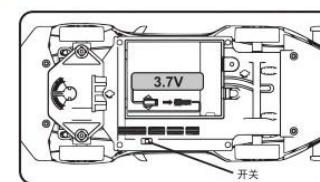

Operational diagram

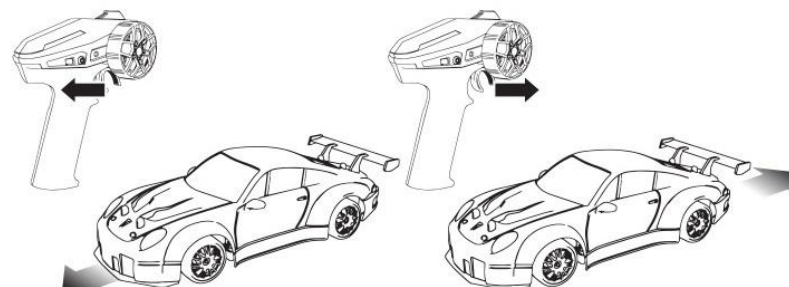

(2)

FCC Statement

This device complies with part 15 of the FCC Rules. Operation is subject to the following two conditions: (1) This device may not cause harmful interference, and (2) this device must accept any interference received, including interference that may cause undesired operation.

This equipment has been tested and found to comply with the limits for a Class B digital device, pursuant to part 15 of the FCC Rules. These limits are designed to provide reasonable protection against harmful interference in a residential installation. This equipment generates, uses and can radiate radio frequency energy and, if not installed and used in accordance with the instructions, may cause harmful interference to radio communications. However, there is no guarantee that interference will not occur in a particular installation. If this equipment does cause harmful interference to radio or television reception, which can be determined by turning the equipment off and on, the user is encouraged to try to correct the interference by one or more of the following measures:

- Reorient or relocate the receiving antenna.
- Increase the separation between the equipment and receiver.
- Connect the equipment into an outlet on a circuit different from that to which the receiver is connected.
- Consult the dealer or an experienced radio/TV technician for help.

Caution: Any changes or modifications to this device not explicitly approved by manufacturer could void your authority to operate this equipment.

RF Exposure Information

The device has been evaluated to meet general RF exposure requirement. The device can be used in portable exposure condition without restriction.