

Bluetooth 5.3 LE Audio Transceiver



Model No.: BT-LE

User Manual

Congratulations on your purchase of the BT-LE Bluetooth LE Audio Transceiver.

The following pages explain the features and operations of the BT-LE. Please take a moment to review this user guide and ensure you read all safety instructions before proceeding.

Overview

The BT-LE is a versatile 2-in-1 Bluetooth LE Audio Transceiver that can function as both a transmitter and a receiver. It works with LE Audio and Classic Bluetooth, catering to various usage scenarios.

The BT-LE supports Auracast broadcast audio, allowing an audio source device to broadcast one or more audio streams to an unlimited number of audio sink devices. With Auracast technology, the BT-LE delivers excellent performance, combining low latency, high sound quality, and efficient power consumption to meet the demands of all-day use.

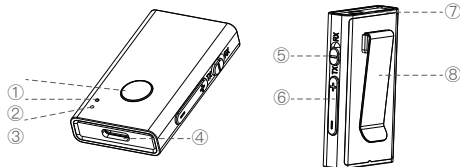

- ① Multi-functional button (MFB)
- ② LED indicator
- ③ Built-in microphone (MIC)
- ④ Type-C charging port & USB audio connection
- ⑤ TX-RX switch button
- ⑥ Volume and track controls (+/-)
- ⑦ 3.5mm audio jack
- ⑧ Secure clip

In the box

- 2-in-1 Bluetooth audio transceiver
- Type-C charging cable
- User manual

Function and Operation

Function	Operation	the LED Light
Power On/Off	Press and hold the MFB button for 3 seconds	<ul style="list-style-type: none"> • Flashes blue (power on) • Goes off (power off)

Classic Bluetooth Pairing Mode (1 to 1)	Double press the MFB button	<ul style="list-style-type: none"> • Flashes red and blue (in RX mode) • Flashes red and blue (in TX mode)
Broadcast Mode On/Off	Triple press the MFB button to enter broadcast mode	Flashes purple
Mute	Press the MFB button	Turns steady red
Pair/Play	Press the MFB button	Flashes blue slowly (only in RX mode)
Increase /Decrease Volume	Press the +/- button	Flashes blue slowly
Next/Previous Track	Long press the +/- button	Flashes blue slowly
Phone Call	Press the MFB to answer a call /end a call Double press the MFB to reject a call	Flashes blue slowly

Clear the pairing list (in RX mode)	Double-click the MFB and hold it down until the device powers off	<ul style="list-style-type: none"> • Flashes red once (clearing status) • Goes off (successful clearance)
Power Status	<ul style="list-style-type: none"> • Low Battery • Charging • Full Power 	<ul style="list-style-type: none"> • Flashes red • Turns steady red • Turns steady blue

Use as a Receiver (In RX mode)

Bluetooth—enable your home stereo or AV receiver to wirelessly stream music from your smartphones, iPad, PC, and more.

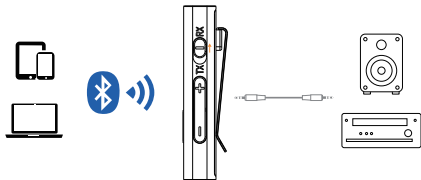

Pairing with a Smartphone

1. Switch to RX Mode. Press and hold the MFB button for 3 seconds until the LED flashes blue.
2. Double-click the MFB button until the LED flashes rapidly in red and blue, indicating the BTR5 is in Bluetooth receiver pairing mode.
3. Activate Bluetooth on your smartphone and search for available devices.
4. Select “BT-LE” from the device list. Follow any prompts and enter the passcode “0000” if requested to pair.
5. Once paired successfully, your smartphone will connect to the BTR5 automatically.
6. After successful pairing, the LED will blink blue intermittently. Press the MFB button to begin playing music.

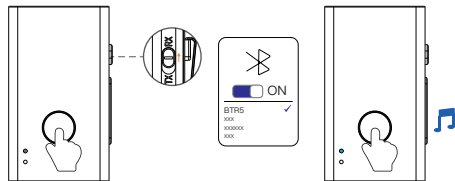

Streaming Music

1. After pairing with your smartphone, connect the BT-LE to a 3.5mm stereo headset or wired speakers using the included 3.5mm to 3.5mm audio cable.
2. Enjoy your favorite music from your smartphone's media players.
3. To control music playback (play/pause), press the MFB button once.

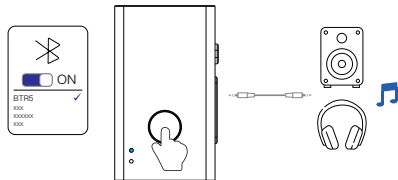

Note

1. Ensure your smartphone is Bluetooth-enabled before attempting to pair with the BT-LE.
2. The BT-LE will automatically power off if it cannot connect to any device within 5 minutes.
3. Once powered on, the BT-LE will automatically search for and connect to the last paired device that is within its operational range.

Use as a Transmitter (In TX mode)

Bluetooth-enable your TV or other home audio devices to stream music to your Bluetooth headphones, speakers, or receivers. Enjoy TV or music without wires.

Before pairing, ensure that your Bluetooth device (TV, audio source) supports the Bluetooth A2DP profile for audio streaming.

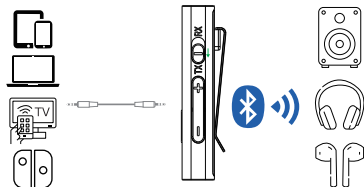

Pairing Procedure

1. Switch to TX Mode. Press and hold the MFB button for 3 seconds until the LED flashes red and blue.
2. Double-click the MFB button until the LED rapidly flashes red and blue, indicating the BTR5 is in Bluetooth transmitter pairing mode.

- Put your Bluetooth headphones, speakers, or receivers into pairing mode according to their respective instructions.
- The BT-LE will automatically search for, pair, and connect with the Bluetooth device(s) in range. Once paired successfully, the LED will blink blue intermittently.
- Use the included 3.5mm audio cable to connect the BT-LE to your TV or home audio device. Enjoy wireless stereo music.

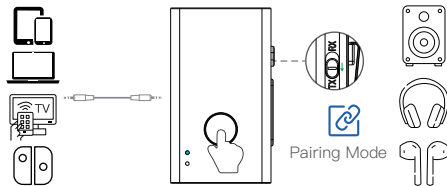

Note

- The BT-LE will automatically power off if it cannot connect to any devices within 5 minutes.
- Once powered on, the BT-LE will automatically reconnect with the last paired device that is within its operational range.
- To control music playback (play/pause), press the MFB button once.

Broadcast Mode

Broadcast mode allows the BT-LE to transmit audio without requiring pairing. Simply enable broadcast mode, and it will automatically search for nearby transmitters within a range of 30~50 meters.

- Broadcast mode eliminates the need for pairing. Once enabled, the BT-LE will search for nearby transmitters.
- There are no limitations on the devices that can receive audio in broadcast mode.
- Hand On/Off Mode: To navigate multiple transmitters in the same area, triple-click the function key to search or switch radio stations.
- Broadcast mode as a transmitter is compatible only with devices that support LE Audio.

Product Specification

Bluetooth® Version	BT 5.3 LE Audio BIS, CIS
Bluetooth protocol	A2DP/AVDTP/AVCTP/AVRCP/HFP
Support audio decoding formats	SBC/LC3
Operation Mode	Pairing Mode (A2DP/CIS) & Broadcast Mode (BIS)
Audio input (in TX mode)	3.5mm line in, USB (only one single audio source can be used at a time)
Audio output (in RX mode)	3.5mm line out
Latency	< 40ms
Battery capacity	145 mAh
Charging time	2H
DC input	5V/1000mAh
Working time	11 hours in TX mode 11 hours in RX mode (measured at 50% medium volume)
Working range	50m (open space)
Weight	10g
Dimensions	26mm X 47mm X 10mm

The working and standby times may vary when used with different smartphones or other compatible Bluetooth devices, depending on usage settings, styles, and environmental conditions.

Safety Information

- The battery used in this device may cause a risk of fire or chemical burn if mistreated.
- To avoid damage or malfunction of the device, do not drop it from high positions.
- Keep the device away from humidity, water, and any other liquids. If the device is exposed to water, moisture, or other liquids, do not operate it to prevent electrical shock, explosion, or damage to the device or yourself.
- Do not place or keep the device close to any heat sources such as direct sunlight, radiators, stoves, or other heat-producing appliances. This may cause an explosion, degrade performance, or reduce battery life.
- Do not modify, repair, or disassemble the device at your discretion, especially the battery, as it may cause an explosion and void the warranty.
- Avoid placing heavy objects on the device.
- Use only the supplied and approved charger.
- Unplug the device when not in use for long periods or during lightning storms.

Note:

This equipment has been tested and found to comply with the limits for a Class B digital device, pursuant to part 15 of the FCC Rules. These limits are designed to provide reasonable protection against harmful interference in a residential installation.

This equipment generates, uses and can radiate radio frequency energy and, if not installed and used in accordance with the instructions, may cause harmful interference to radio communications.

However, there is no guarantee that interference will not occur in a particular installation. If this equipment does cause harmful interference to radio or television reception, which can be determined by turning the equipment off and on, the user is encouraged to try to correct the interference by one or more of the following measures:

- Reorient or relocate the receiving antenna.
- Increase the separation between the equipment and receiver.
- Connect the equipment into an outlet on a circuit different from that to which the receiver is connected.
- Consult the dealer or an experienced radio/TV technician for help.
- Changes or modifications not expressly approved by the party responsible for compliance could void the user's authority to operate the equipment.

This device complies with Part 15 of the FCC Rules. Operation is subject to the following two conditions:

(1) this device may not cause harmful interference, and (2) this device must accept any interference received, including interference that may cause undesired operation.