



Alloy Fusion v3



Extended User Manual
v.1.0

MEET YOUR ALLOY SMARTHOME DEVICE

Alloy Fusion v3 lets you easily monitor, regulate and secure your home from anywhere in the world.

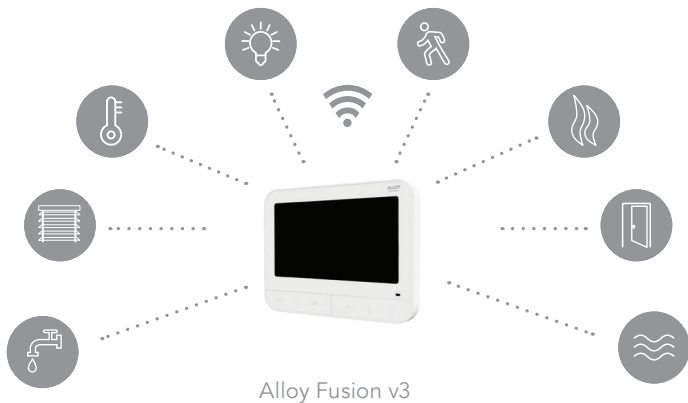

1.0. | INSTALLATION

PACKAGING CONTENT

- Alloy Fusion v3
- Quick Start Guide
- 4x Drywall anchor
- 4x Brick wall anchor
- 4x Wall screw

1.1. MOUNTING & POWER UP

- 01 | Turn off the circuit breaker for the 24 VAC system
- 02 | Remove the wallplate from Alloy Fusion v3
- 03 | Position the wallplate onto the wall and secure it with the screws
- 04 | Connect each wire to the appropriate terminal on the wallplate*
- 05 | Attach Alloy Fusion v3 to the wallplate
- 06 | Turn the circuit breaker back on
- 07 | Alloy Fusion v3 will now power ON

*The wire size must be 1/4 of what enters the relay to avoid burning.

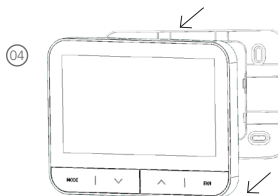
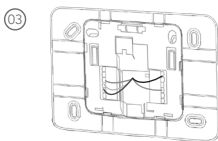
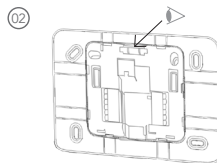
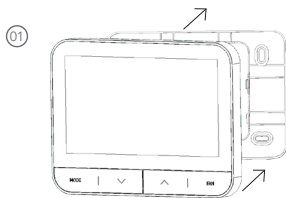

1.2. RESET

To reset Alloy Fusion v3 enter: Settings>About>Reboot.

Factory reset: press fw version 10x-> installer Mode Reboot->Factory Reset Device

1.3. HOW TO FIND THE SERIAL NUMBER

The serial number is located both on the QR code and barcode label, on two places:

- The rear of the wall plate of your Alloy Fusion v3
- Behind the front cover of your Alloy Fusion v3
- On the gift box label
- Alloy Fusion v3 UI (Settings> About)

1.4. CONNECT TO ETHERNET

Connect your Alloy Fusion v3 to your broadband router via Ethernet cable.

The Ethernet port is located on the bottom of the Alloy Fusion v3.

Alloy Fusion v3 queries your DHCP server for an IP address.

1.5. CONNECT TO WiFi

The unit can also be connected to the WiFi.

To connect to the WiFi:

1. Make sure the unit is powered off (power it off if necessary)
2. Connect power terminals on the wallplate
3. Choose "Settings" in Alloy Fusion v3 UI (Networking>WiFi)
4. Configure WiFi
5. Choose desired WiFi network

1.6. ALLOY FUSION V3 BUTTONS

① Button / MODE

② Button / -

③ Button / +

④ Button / FAN

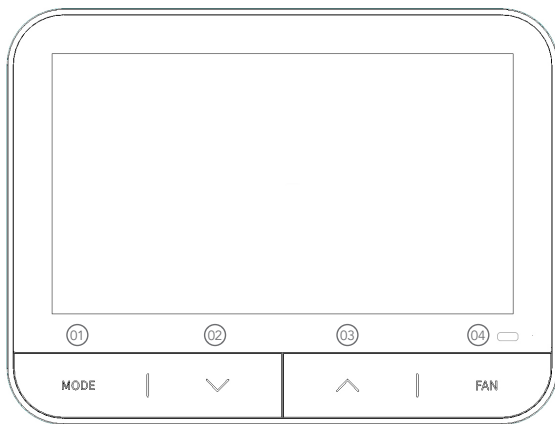

1.7. POWER TERMINALS ON THE WALLPLATE

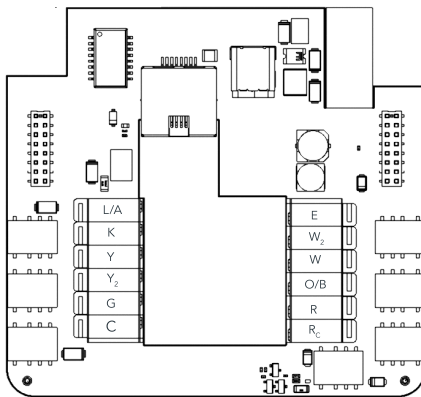



Risk of Electrical Shock Before performing any electrical work, turn OFF the power to the AC wires leading into the in-wall box at the main power source. Before starting the installation, use a non-contact voltage detector to ensure that there is no power to any wires in the wall box.

CAUTION! Installations should be performed in accordance with all national and local electrical codes. If you are unsure or have questions about the installation, please seek the advice of a qualified electrician. Do not apply power to the Alloy Fusion v3 before completing the installation. Please make sure that a proper power cut-off device is part of your power supply circuit (electrical fuse).

NOTE Use safety goggles and gloves when drilling holes in the wall for screw anchors.

NOTE This product should not be plugged in sockets that can be turned off with a switch.

2.0. | SPECIFICATIONS

→ MODEL NUMBER

- afv3.zw8us.mw.4G

→ SYSTEM

- Quad-Core Cortex-A53 ARM CPU
- 1.1 GHz CPU
- Mali400 MP2 GPU
- 2GB RAM
- 4GB FLASH

→ GRAPHICAL INTERFACE

- 7" LCD 1024x600 with Touchscreen

→ NETWORK

- Ethernet 10/100/1000M EMAC
- Wifi IEEE802.11 a/b/g/n/ac
- Bluetooth 5/LE
- Radio module: Z-Wave™ 800 / Zigbee 3.0 / Thread
- Cellular / 4G with DIV antenna

→ OPERATING SYSTEM

- Linux

→ SENSORS

- Illuminance sensor
- Humidity sensor

- Temperature sensor

→ POWER

- Power supply input 24 VAC
- Battery backed RTC
- Power usage: idle: <3W; Max: 11W

→ PHYSICAL DIMENSION

- 7.3(W) x 5.52(H) x 1.04(D) inches
- 186(W) x 140,36(H) x 26,52(D) millimeters

→ ENVIRONMENTAL

- Temperature range:
 - Operating 0° - 40° (32°F to 104°F)
 - Storage: -25° - 70° C (-13°F to 158°F)
- Humidity: 5% to 95% non condensing

→ INPUT/OUTPUT

- USB -C ; 2.0. Downstream port
- HVAC wiring terminals

→ REGULATION

- FCC

3.0. | SAFETY

Disconnect the network cable and power adapter or any other connected peripherals if any of the following conditions exist:

- The power cord or connector is damaged or frayed.
- The Alloy Fusion v3 or cables are exposed to rain, water/fluids, or excessive moisture.

 Avoid installing the Alloy Fusion v3 near or inside sources of electromagnetic interference.

4.1. IMPORTANT SAFETY INSTRUCTIONS

- Read, keep and follow these instructions.
- Heed all warnings.
- Do not use this product near water or expose the product to dripping or splashing of water or liquid of any kind.
- Clean only with a dry cloth.
- Do not install near any heat sources such as radiators, heat registers, stoves or other apparatus (including amplifiers) that produce heat.

4.0. | DISPOSING AND RECYCLING YOUR PRODUCT



(Waste Electrical & Electronic Equipment)

(Applicable in countries with separate collection systems)

This marking on the product, accessories or literature indicates that the product and its electronic accessories (e.g. charger, headset, USB cable) should not be disposed of with other household waste. To prevent possible harm to the environment or human health from uncontrolled waste disposal, please separate these items from other types of waste and recycle them responsibly to promote the sustainable reuse of material resources.

Household users should contact either the retailer where they purchased this product, or their local government office, for details of where and how they can take these items for environmentally safe recycling.

Business users should contact their supplier and check the terms and conditions of the purchase contract. This product and its electronic accessories should not be mixed with other commercial wastes for disposal. (Applicable in countries with separate collection systems)

At Alloy Home, we understand and are committed to reducing any impact our operations and products may have on the environment. To minimize this impact Alloy Home designs and builds its products to be as environmentally friendly as possible, by using recyclable, low toxic materials in both products and packaging.

Disclaimer

Some content and services accessible through this device belong to third parties and are protected by copyright, patent, trademark and/or other intellectual property laws. Such content and services are provided solely for your personal

non-commercial use. You may not use any content or services in a manner that has not been authorised by the content owner or service provider.

Without limiting the foregoing, unless expressly authorised by the applicable content owner or service provider, you may not modify, copy, republish, upload, post, transmit, translate, sell, create derivative works, exploit, or distribute in any manner or medium any content or services displayed through this device.

5.0. | ONE (1) YEAR LIMITED WARRANTY

Alloy Home, LLC warrants this product (the “Product”) against defects in materials and/or workmanship under normal use for a period of ONE (1) YEAR from the date of purchase by the original purchaser (“Warranty Period”). If a defect arises and a valid claim is received within the Warranty Period, then as your sole remedy (and Alloy Home’ sole liability), Alloy Home will at its option either 1) repair the defect at no charge, using new or refurbished replacement parts, or 2) replace the Product with a new product that is functionally equivalent to the original, in each case within 30 days following receipt of the returned Product. A replacement product or part assumes the remaining warranty of the original Product. When a Product or part is exchanged, any replacement item becomes your property and the replaced Product or part becomes Alloy Home’ property. Obtaining Service: To obtain warranty service, visit <https://smartrent.com/contact-support>. Please be prepared to describe the Product that needs service and the nature of the problem. Any claim under this Limited Warranty must be submitted to Alloy Home before the end of the

warranty period. Exclusions: This warranty does not apply to a) damage caused by failure to follow instructions relating to the Product's use or the installation of components; b) damage caused by accident, abuse, misuse, transport, neglect, fire, floods, earthquake or other external causes; c) damage caused by service performed by anyone who is not an authorized representative of Alloy Home; d) accessories used in conjunction with a covered Product; e) a Product or part that has been modified to alter functionality or capability; f) items intended to be periodically replaced by the purchaser during the normal life of the Product, including, without limitation, batteries, bulbs or cables; g) a Product that is used commercially or for a commercial purpose, in each case as determined by Alloy Home.

EXCEPT FOR BODILY INJURY, ALLOY HOME SHALL NOT BE LIABLE FOR (I) ANY LOST PROFITS, COST OF PROCUREMENT OF SUBSTITUTE PRODUCTS, OR ANY INCIDENTAL OR CONSEQUENTIAL DAMAGES, OR (II) ANY AMOUNTS IN EXCESS OF THE PURCHASE PRICE FOR THE PRODUCT, IN EACH CASE WHETHER RESULTING FROM THE USE OF OR INABILITY TO USE THIS PRODUCT, OR ARISING OUT OF ANY BREACH OF THIS WARRANTY, EVEN IF COMPANY HAS BEEN ADVISED OF THE POSSIBILITY OF SUCH DAMAGES. SOME STATES DO NOT ALLOW THE EXCLUSION OR LIMITATION OF INCIDENTAL OR CONSEQUENTIAL DAMAGES, SO THE ABOVE LIMITATION AND EXCLUSIONS MAY NOT APPLY TO YOU. TO THE EXTENT PERMITTED BY APPLICABLE LAW, ALLOY HOME DISCLAIMS ANY AND ALL STATUTORY OR IMPLIED WARRANTIES, INCLUDING WITHOUT LIMITATION, WARRANTIES OF MERCHANTABILITY, FITNESS FOR A PARTICULAR PURPOSE AND WARRANTIES AGAINST HIDDEN OR LATENT DEFECTS. IF ALLOY HOME

CANNOT LAWFULLY DISCLAIM STATUTORY OR IMPLIED WARRANTIES, THEN TO THE EXTENT PERMITTED BY LAW, ALL SUCH WARRANTIES SHALL BE LIMITED IN DURATION TO THE WARRANTY PERIOD. SOME STATES DO NOT ALLOW LIMITATIONS ON HOW LONG AN IMPLIED WARRANTY LASTS, SO THE ABOVE LIMITATIONS MAY NOT APPLY TO YOU.

This warranty gives you specific legal rights and you may also have other rights, which vary from country to country. To exercise your rights under this warranty, please follow the instructions above under the heading "Obtaining Service", or contact Alloy Home, LLC, 8665 E. Hartford Drive, Suite 200, Scottsdale, AZ 85255. Alloy Home is a registered trademark of Alloy Home, LLC.

Manufacturer / Importer: Alloy Home, LLC
8665 E. Hartford Drive, Suite 200, Scottsdale, AZ 85255

7.0. | DECLARATION OF CONFORMITY

Manufacturer's Name:

Tri plus grupa d.o.o.

Address: Banjavciceva 11, 10000 Zagreb, Croatia

Product name: Alloy Fusion v3

Model: afv3.zw8us.mw.4G

Operating Temperature: -10° C to 40° C



FCC Caution

- Any changes or modifications not expressly approved by the party responsible for compliance could void the user's authority to operate this equipment.
- This device complies with part 15 of the FCC Rules. Operation is subject to the following two conditions: (1) this device may not cause harmful interference, and (2) this device must accept any interference received, including interference that may cause undesired operation.
- This device and its antenna(s) must not be co-located or operating in conjunction with any other antenna or transmitter.

NOTE: This equipment has been tested and found to comply with the limits for a Class B digital device, pursuant to Part 15 of the FCC Rules. These limits are designed to provide reasonable protection against harmful interference in a residential installation. This equipment generates, uses and can radiate radio frequency energy and, if not installed and used in accordance with the instructions, may cause harmful interference to radio communications. However, there is no guarantee that interference will not occur in a particular installation.

- If this equipment does cause harmful interference to radio or television reception, which can be determined by turning the equipment off and on, the user is encouraged to try to correct the interference by one or more of the following measures:
- Reorient or relocate the receiving antenna.
- Increase the separation between the equipment and receiver.
- Connect the equipment into an outlet on a circuit different from that to which the receiver is connected.
- Consult the dealer or an experienced radio/TV technician for help.
- To maintain compliance with FCC's RF Exposure guidelines, This equipment should be installed and operated with minimum distance between 20cm the radiator your body: Use only the supplied antenna.

FCC ID: 2AAU7-AF3MW

IC Warning

This device contains licence-exempt transmitter(s)/receiver(s) that comply with Innovation, Science and Economic Development Canada's licence-exempt RSS(s). Operation is subject to the following two conditions:

1. This device may not cause interference.
2. This device must accept any interference, including interference that may cause undesired operation of the device.

Cet appareil contient des émetteurs/récepteurs exemptés de licence qui sont conformes aux RSS exemptés de licence d'innovation, sciences et développement économique Canada. Le fonctionnement est soumis aux deux conditions suivantes:

1. Cet appareil ne peut pas causer d'interférences.
2. Cet appareil doit accepter toute interférence, y compris les interférences qui peuvent causer un fonctionnement indésirable de l'appareil.

This equipment complies with IC radiation exposure limits set forth for an uncontrolled environment. This equipment should be installed and operated with minimum distance 20cm between the radiator & your body.

Cet équipement respecte les limites d'exposition au rayonnement IC établies pour un environnement non contrôlé. Cet équipement doit être installé et utilisé avec une distance minimale de 20cm entre le radiateur et votre corps.

IC:11391A-AF3MW

make your home smart

During the use of 6E, this product will prioritize frequencies above 6105MHz and implement the following logic.

1. After booting up, first silently scan the 6E frequency band WiFi signal in the environment, and identify and organize the number of hotspots being used at each frequency point.

2. If local regulations do not allow the use of frequencies above 6105MHz, the system will plan to use channels allowed by local regulations below 6105MHz.

3. If local regulations allow the use of frequencies above 6105MHz

- 3.1 If it is found that frequencies above 6105MHz are less occupied and continuously idle frequencies can meet the channel width requirements of the system, then priority should be given to planning and using the channels among them.

- 3.2 If none of the above conditions are met, the system will plan to use channels allowed by local regulations below 6105MHz.