

Fan USER MANUAL



ATF-005WL

CAUTION

1. Use as per the rating voltage.
2. Do not repair or remake the appliance by yourself, it should be repaired by the repairmen.
3. Do not operate the appliance with wet hands, in order to avoid damage.
4. If the supply cord is damaged, it must be replaced by a same cord from the manufacturer or its service agents.
5. When the appliance is not in use, switch it off and unplug it.
6. Do not insert things to air outlets and inlets, in order to avoid damage.
7. Do not use the appliance near explosive and combustible gas.
8. Use the appliance only on a flat surface.
9. Do not use outdoors.
10. Do not turnover the appliance. Unplug the power supply If it is toppled over and there have some water in the body. Dry the body before use.
11. Clean the appearance with a lightly damp cloth. It can clean with neutral detergents. Do not rinse with water.
12. Do not make air outlets and inlets near the wall or curtain.
13. Do not knock or shake the body when use, otherwise it may cause stop.
14. The appliance must not be located immediately below a socket outlet.
15. The rating current of socket should exceed 10A.
16. Do not use the appliance in the immediate surrounding of a bath, a shower or a swimming pool.
17. This appliance is not intended for use by persons including children with reduced physical, sensory or mental capabilities or lack of experience and knowledge unless they have been given supervision or instruction concerning use of the appliance by a person responsible for their safety.
18. Children should be supervised to ensure that they do not play with the appliance.
19. This appliance has a polarized plug (one blade is wider than the other). To reduce the risk of electric shock, this plug is intended to fit in a polarized outlet only one way. If the plug does not fit fully in the outlet, reverse the plug. If it still does not fit, contact a qualified electrician. Do not attempt to defeat this safety feature.



20. This product employs overload protection (fuse). A blown fuse indicates an overload or short-circuit situation. If the fuse blows, unplug the product from the outlet. Replace the fuse as per the user servicing instructions (follow product marking for proper fuse rating) and check the product. If the replacement fuse blows, a short-circuit may be present and the product should be discarded or returned to an authorized service facility for examination and/or repair.
21. Do not operate any fan with a damaged cord or plug. Discard fan or return to an authorized service facility for examination and/or repair.
22. Do not run cord under carpeting. Do not cover cord with throw rugs, runners, or similar coverings. Do not route cord under furniture or appliances. Arrange cord away from traffic area and where it will not be tripped over.

FUNCTIONS & OPERATION

Put the plug into the socket, products in standby mode, power lamp light on the display panel.

FAN ON/OFF button: Push it to start working, fan works in middle speed. Display panel shows the room temperature. Indicator light shows on/off at the display panel.

SPEED button: Push this button to set from LOW-MIDDLE-HIGH. Indicator light shows on the display.

OSCIL button : Push it to oscillate the fan, push it again to stop the function. Indicator light shows on/off at the display panel.

TIMER button: Push it to set from 00-12 hours. Display panel shows the timer numbers and. Indicator light shows on/off at the display panel.

LIGHT ON/OFF button: Push it to turn on and off the lights on the display panel. The Speaker light (The Ring) can not be turn off by this button

Bluetooth button: Push it to turn on and off the speaker. The connect name on your bluetooth equipment is TH-817EM. The Speaker light (The Ring) turns on in front of the fan. Indicator light shows on/off at the display panel.

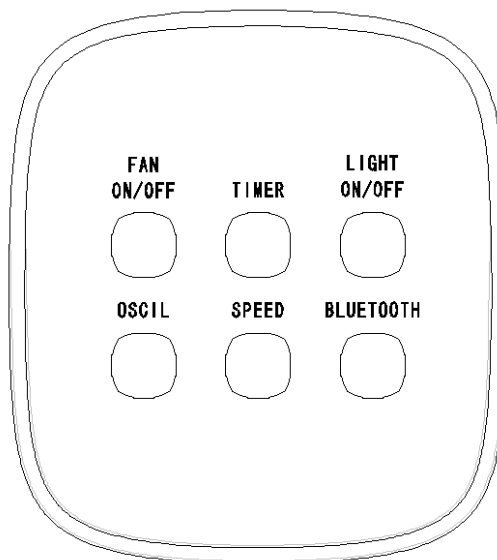

REMOTE CONTROL

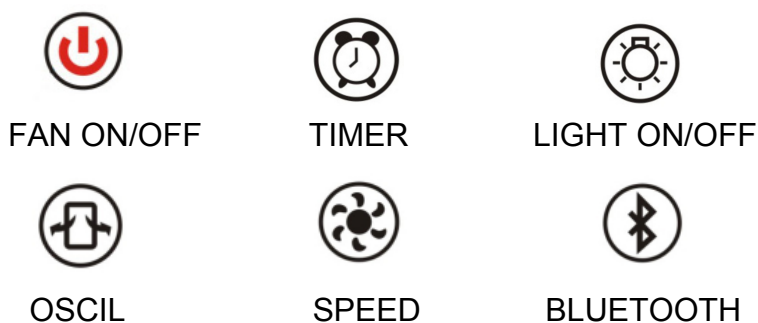
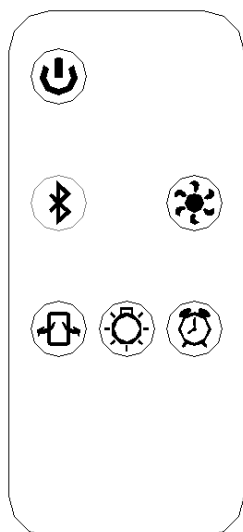

The function is same as on control panel

The remote control use one button cells, model No. CR2025 (3V). We recommend the use of Lithium type battery for longer use.

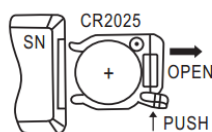
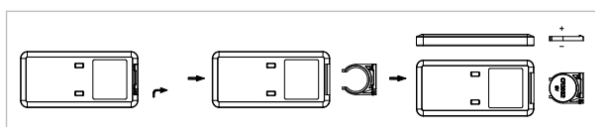

Note: Please follow battery disposal instruction on battery packaging, or contact your local councils for safely disposal of batteries.

ASSEMBLING

Step 1 : Make sure four hole of front and back base in straight alignment, Put hole of back base insert to cylinder of front base.

Step 2 : Take out the power cord from the central of base

Step 3 : Assembled base of central have four pieces of screw hole which fix into the screw holes of body ,use 4 pieces of tapping screw, fix closely the body and base. Finally take the power cord into the line hole.

Step 4 : Put the fan flatly

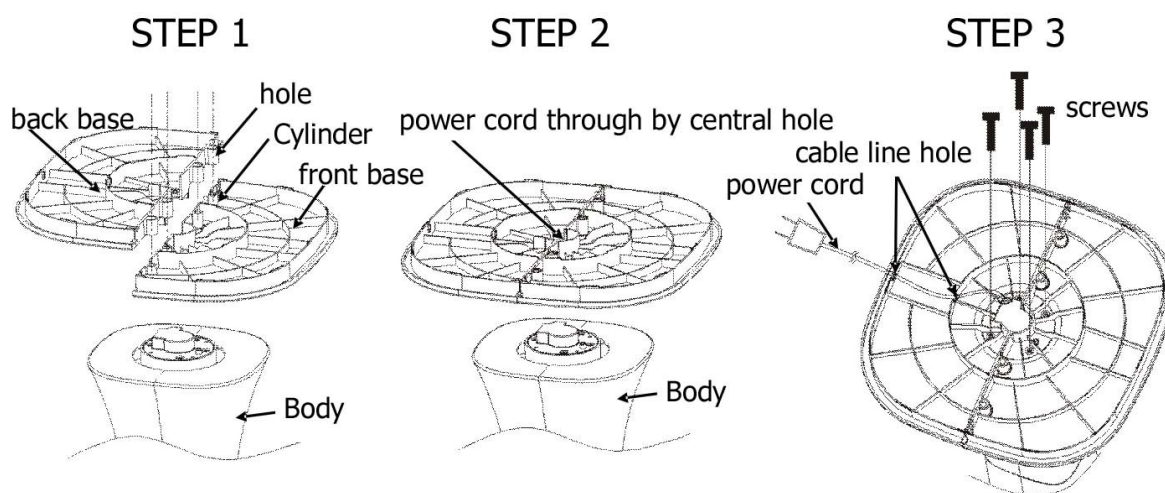

CLEANING AND MAINTENANCE

Clean with neutral detergent and soft cloth.

Attention: unplug the power plug when clean the appliance ,since there have high pressure in the body. Do not leave any water on the control panel.

Always unplug the fan before cleaning, disassembly or servicing.

User Servicing Instructions

1. Grasp plug and remove from the receptacle or other outlet device. Do not unplug by pulling on cord.
2. Open fuse cover. Slide open fuse access cover on top of attachment plug towards blades.
3. Turn fuse holder over to remove fuse. Remove fuse carefully.
4. Risk of fire. Replace fuse only with 5 Amp, 125 Volt fuse(provided with product).
5. Close fuse cover. Slide closed the fuse access cover on top of attachment plug.
6. Risk of fire. Do not replace attachment plug. Contains a safety device (fuse) that should not be removed. Discard product if the attachment plug is damaged..

FCC NOTE:

This device complies with Part 15 of the FCC Rules. Operation is subject to the following two conditions: (1) this device may not cause harmful interference, and (2) this device must accept any interference received, including interference that may cause undesired operation.

The manufacturer is not responsible for any radio or tv interference caused by unauthorized modifications or change to this equipment. Such modifications or change could void the user's authority to operate the equipment.

This equipment has been tested and found to comply with the limits for a Class B digital device, pursuant to part 15 of the FCC Rules. These limits are designed to provide reasonable protection against harmful interference in a residential installation. This equipment generates, uses and can radiate radio frequency energy and, if not installed and used in accordance with the instructions, may cause harmful interference to radio communications. However, there is no guarantee that interference will not occur in a particular installation. If this equipment does cause harmful interference to radio or television reception, which can be determined by turning the equipment off and on, the user is encouraged to try to correct the interference by one or more of the following measures:

- Reorient or relocate the receiving antenna.
- Increase the separation between the equipment and receiver.
- Connect the equipment into an outlet on a circuit different from that to which the receiver is connected.
- Consult the dealer or an experienced radio/TV technician for help.

RF warning statement:

To maintain compliance with FCC's RF exposure guidelines, this equipment should be installed and operated with a minimum distance of 20cm between the radiator and your body.

ACCESSORY

Screws for assemble the base ; Remote control