

140*74mm

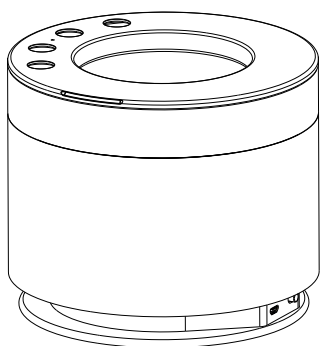

PACDOT1
wireless speaker

PACDOT1

POECES Audio Co. Ltd
Made in China

Contents

Product Features	2
Inside Package	3
Main Parts	4
General Operation	5-7
Technical Information	8
Safety Warnings	9-12
FCC Statement	13-14

Product Features

Thank you for purchasing POECES PACDOT1 wireless speaker. We recommend that you spend some time reading this instruction manual in order to understand all the operational features it offers. Please read all the safety instructions carefully before using and keep this instruction manual for future reference.

PAC-DOT1 is an excellent portable Echo-Dot Speaker. It delivers full rich sound from a very compact size. And support power charging and audio output for Amazon Echo-Dot. The high capacity battery can support Amazon Echo-Dot 6hrs playback time and 10hrs working time. Also collect Bluetooth function support speaker work without Amazon Echo-Dot.

Inside Package

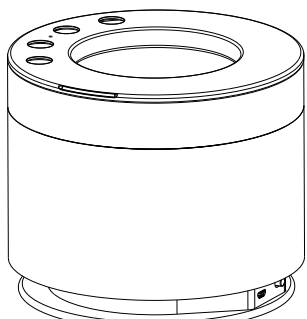

Main Unit



Instruction Manual

Main Parts

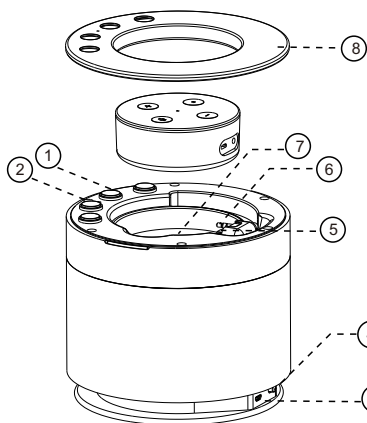

- ① Functional Buttons
- ② Play/Pause
- ③ Pre./Vol-
- ④ LED Light
- ⑤ Micro-USB port
- ⑥ OFF/NO
- ⑦ Echo Dot plug
- ⑧ Dot docking tray
- ⑨ Cover

General Operation

Connecting your Echo Dot

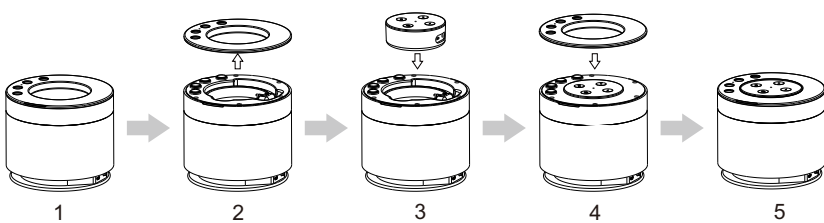

1. Unplug your Echo Dot and place into the docking tray.
2. Pick up the top cover.
3. Plug in 3.5mm and micro-USB plug into Echo Dot.
4. Cover the top cover.
5. Press power button and play.

Enjoy your PACDOT1 plugged in. When fully charged, enjoy it cord-free.

General Operation

Functional Buttons



Under Bluetooth Mode, Short press for previous track/Long press to reduce Volume
[] until hearing the Beep to Minimum volume



Under Bluetooth Mode, short press to play/pause.
[] Long press until hearing the Beep to disconnect the pairing device and enter searching mode/ready for Line-in connection.



Under Bluetooth Mode, short press for next track/long press to increase volume
[] until hearing the Beep to maximum volume



Press about 2 seconds to Echo mode /Bluetooth mode

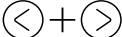

Long press Vol+ & Vol - at the same time to cancel all the background LED effect; Long press Vol+ & Vol- again to resume the LED background light

General Operation

Indicating lights



Blue Light Blinks



Searching for Bluetooth device



Solid blue light



Bluetooth connected



White Light Blinks



Low battery

Passive radiator Light



Blue Light: While playing music, blue light changes brightness with music

Technical Information

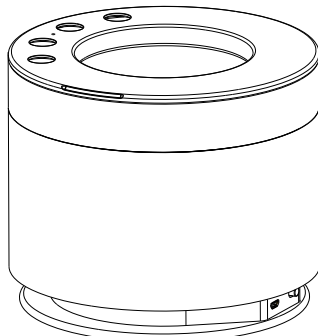

Bluetooth Pairing Name	PAC-DOT
Charging Input	5V/2000mA
Rechargeable battery type	Lithium battery
Battery Capacity	7.4V/2600mA
Power Output	15 W
Inputs	Mirc-USB DC 5V
Bluetooth Version	CSR4.2
Working Distance of Bluetooth	10M
Weight	1026g

Safety Warnings



1. Read Instructions-all the safety and operating instructions must be read and followed before the product is operated.
2. Keep and operate the unit in room temperature.
3. Keep the unit away from corrosive substance, liquid or liquid splash and heat source.
4. Keep the unit out of the reach of Children.
5. Do not press the passive radiators to avoid damage, do not touch the radiator during operation.
6. Do not keep or use the unit under high temperature.
7. Do not put any subject on the unit.
8. Refer to qualified service personnel only.
9. Do not listen under high volume for long time to avoid damage to your hearing.
10. Please charge the unit when the battery is low.
11. Do not abandon or put the unit into fire or any flame source to avoid accident.

Battery Precautions

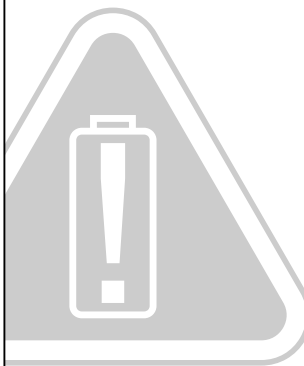

1. Please read the charging instruction in the manual, if the battery is not fully charged after 10 hours charging, stop charging and refer to qualified service;
2. Do not attempt to charge the battery in temperatures outside the range of 32-104°F (0-40°C)
3. If the battery begins to leak, do not allow the liquid to come in contact with your skin or eyes. If contact has been made, wash the affected area with plenty of water and seek medical service immediately
4. Do not expose the product or battery to excessive heat, including direct sunlight or fire and storage or use inside cars in hot weather. Doing so may cause the battery and power supply to generate heat, rupture or ignite, and it may also result in a loss of performance and a shortened life expectancy.

Battery Precautions

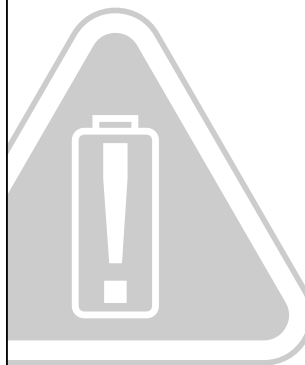

5. If the battery is damaged or on fire, use fire extinguisher to put out fire, never use water to put out fire.
6. Do not step on, throw, or drop batteries or expose it to a strong shock. Do not pierce, crush, dent, or deform the batteries in any way. If it becomes deformed, properly dispose of it
7. Do not short-circuit batteries. Avoid storing them around metal objects such as keys, pocket change, paper clips, and jewelry.
8. Do not dismantle, open or shred the battery
9. Use only DC5V charger with a charging current within the range of 500mA to charge the battery
10. Do not use the battery for other products as it may cause damages or dangers to users.
11. Charge the battery when the red light flashes. Do not over charge the battery when charging light is green. It can be used during charging

Battery Precautions



12. Do not discharge the battery completely
13. Please observe all local regulations, the timely and proper disposal of used batteries. Do not incinerate the battery. If you want to return the batteries for recycling, please contact authorized distributor.

FCC Statement

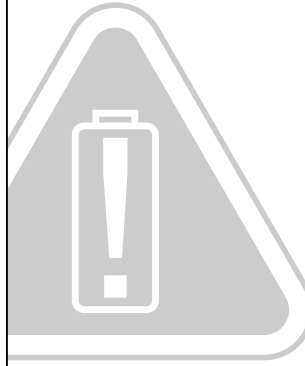

FCC STATEMENT

1. This device complies with Part 15 of the FCC Rules. Operation is subject to the following two conditions:

- (1) This device may not cause harmful interference, and
- (2) This device must accept any interference received, including interference that may cause undesired operation.

2. Changes or modifications not expressly approved by the party responsible for compliance could void the user's authority to operate the equipment.
NOTE: This equipment has been tested and found to comply with the limits for a Class B digital device, pursuant to Part 15 of the FCC Rules. These limits are designed to provide reasonable protection against harmful interference in a residential installation.

This equipment generates uses and can radiate radio frequency energy and, if not installed and used in accordance with the instructions, may cause harmful

FCC Statement

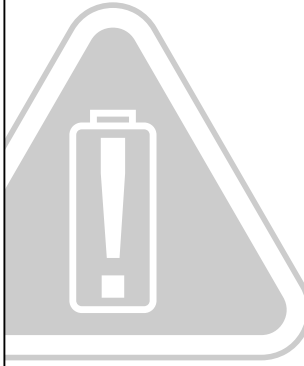

interference to radio communications. However, there is no guarantee that interference will not occur in a particular installation. If this equipment does cause harmful interference to radio or television reception, which can be determined by turning the equipment off and on, the user is encouraged to try to correct the interference by one or more of the following measures:

Reorient or relocate the receiving antenna.

Increase the separation between the equipment and receiver.

Connect the equipment into an outlet on a circuit different from that to which the receiver is connected.

Consult the dealer or an experienced radio/TV technician for help.

RF warning statement:

The device has been evaluated to meet general RF exposure requirement. The device can be used in portable exposure condition without restriction.