

BAXIA

## USER MANUAL

### Pure Sound Bluetooth Speaker



BX-BS-101

## BAXIATECH

### What's in the box

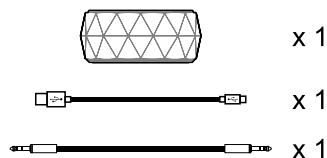

### Buttons

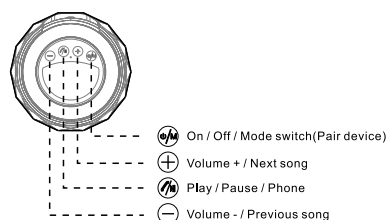

## BAXIATECH

### Wireless daisy chain

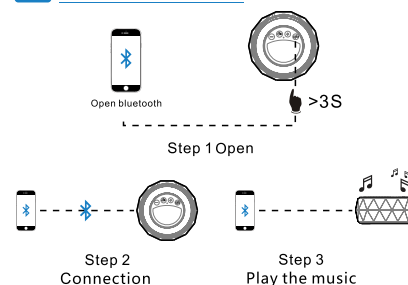

Keep an operation range of the wireless speakers up to 33 feet.

**Step 1** - Turn on the device by pressing the On/Off button for 5 seconds, it is in pairing mode when blue light is fast blinking.

**Step 2** - Open the the Bluetooth capability on your phone, search for device BX-01 and connect it. It means Bluetooth connected when blue light is slowly blinking.

## BAXIATECH

**Step 3**-Begin your wireless music sharing.

Switch Mode: Short press the On/Off button to switch to Aux mode or Bluetooth mode.

### Music control

Play Songs: Short Press "⏸" to pause or play the songs.

Select Songs: Short Press "⏮" to play the previous song.  
Short Press "⏭" to play the next song.

Adjust Volume: Press "⏮" for 5s to turn the volume down.  
Press "⏭" for 5s to turn the volume up.

### Phone answer

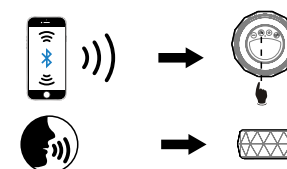

In Bluetooth mode, short Press "⏮" to answer the phone

单页尺寸：65\*85mm

## BAXIATECH

### LED indication

Status	LED indication
Pairing mode	● Fast blinking
Bluetooth connected	● Blinking
Aux connected	● Blinking
Charging	● On

### Safety notices

Read the following recommendation before using the Bluetooth speaker.

- 1.Keep it dry and do not take it to damp places to avoid the product's internal circuit being affected. (Non-waterproof)
- 2.Keep the product away from direct sunlight or hot places. High temperatures will result in permanent damage to the speaker and power source.
- 3.Don't try to disassemble the product as it may get damaged if you are not professional.
- 4.Don't let it fall down to the floor or other surfaces. The internal circuit might get damaged.
- 5.Don't use intensive chemical products or detergent to clean the product.
- 6.Don't scratch the surface with sharp tips.

## BAXIATECH

### BX-BS-101 wired connection:

In addition to operating wirelessly, your BX-BS-101 can be connected to a music source using the supplied audio cable. Cable connection is useful if the battery is low or if BX-BS-101 is to be used with a non-Bluetooth audio source device. To Connect the supplied cable to your BX-BS-101 take one end of the connection cable and carefully insert it into the socket beneath on the Speaker.

The audio cable must be disconnected for BX-BS-101 to switch on and connect via Bluetooth, however its battery can be charged while the audio cable is connected.

**Note: Connecting the audio cable will automatically switch off the Bluetooth and powered elements of BX-BS-101, BX-BS-101 will not however switch automatically when the audio cable is disconnected.**

To charge BX-BS-101 follow the steps described below. Using the supplied USB charging cable, connect the speakers to a powered USB socket; either a computer USB socket, a mains plug USB charger or an in-car charger.

**This device complies with part 15 of the FCC Rules. Operation is subject to the following two conditions:**

- (1) This device may not cause harmful interference, and
- (2) this device must accept any interference received, including interference that may cause undesired operation.

## BAXIATECH

### FCC Warning:

This equipment has been tested and found to comply with the limits for a Class B digital device, pursuant to part 15 of the FCC Rules. These limits are designed to provide reasonable protection against harmful interference in a residential installation. This equipment generates, uses and can radiate radio frequency energy and, if not installed and used in accordance with the instructions, may cause harmful interference to radio communications. However, there is no guarantee that interference will not occur in a particular installation. If this equipment does cause harmful interference to radio or television reception, which can be determined by turning the equipment off and on, the user is encouraged to try to correct the interference by one or more of the following measures:

- Reorient or relocate the receiving antenna.
  - Increase the separation between the equipment and receiver.
  - Connect the equipment into an outlet on a circuit different from that to which the receiver is connected.
  - Consult the dealer or an experienced radio/TV technician for help.
- MODIFICATION: Any changes or modifications not expressly approved by the grantee of this device could void the user's authority to operate the device.

## BAXIATECH

### Specifications

Output power: 1 x 3W  
Signal-to-noise ratio: 85dB  
Battery type: Lithium-ion polymer (3.7V, 600mAh)  
Battery Charging time: 2.5 hours, DC 5V >500mAh  
Music playing time: 4-8 hours (varies by volume level and audio content)  
Dimensions: 36mm(H), 78mm(D)  
Weight: 250g  
Operation range: <=10m  
Certification : CE, FCC, RoHS



### After-sale service

If anything arise, please do not hesitate to contact us at: glissupport@baxiatech.com