

无线充电移动电源

用户手册

感谢您购买本公司产品，本产品是一款智能手机无线充电器，让您轻松体验数码产品的无限乐趣。  
使用本产品前请认真阅读本手册并妥善保存，以备查阅。

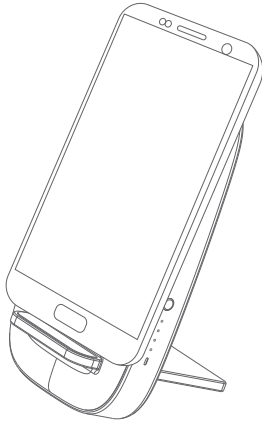

连接适配器充电

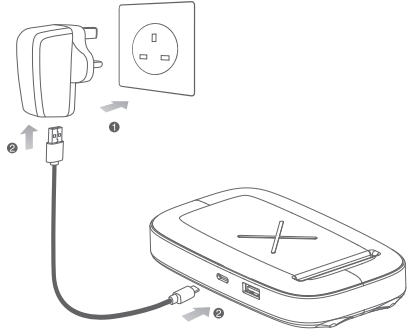

- ① 将电源适配器插在插座上。
- ② USB电源线一端连接适配器，一端连接移动电源。

\*当移动电源进行充电时，放入手机进行无线充电，程序将停止对移动电源充电，优先对手机进行无线充电。

对手机进行无线充电

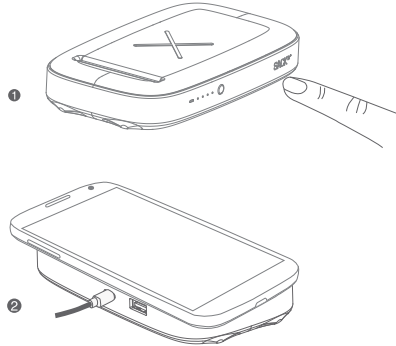

- ① 轻按开关，电源指示灯点亮并显示剩余电量，无线充电指示灯蓝绿交替闪烁后熄灭。
- ② 当移动电源充电时，白色LED 灯以跑马灯形式提示充电，30S后熄灭。移动电源放电时，当前电量 LED 常亮，30S后熄灭。

\*当手机离开移动电源30秒，无线充电自动关闭，如再充电需要需重新触摸启动。在USB-C 口没有接电的情况下可通过电池供电线圈实现无线充电的功能。

通过USB对设备进行充电

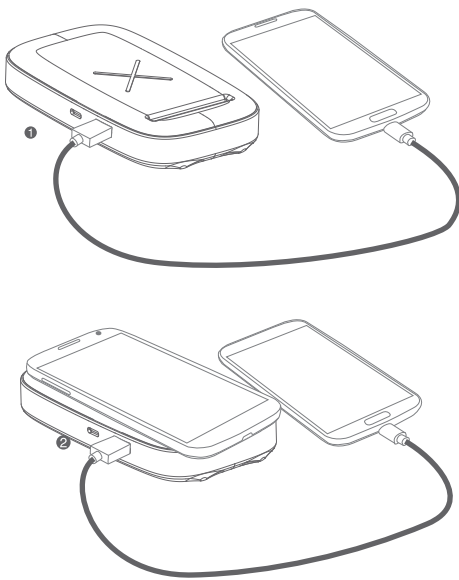

规格参数

电池类型：聚合物锂电池    电池容量：6000mA  
输入电压：DC5V/2A   DC9V/1.67A  
输出电压：5W/7.5W/10W  
USB-A输出：5V/2.1A  
规格尺寸：140\*80\*24mm

注意 事项

- 1、请勿挤压或碰撞。
- 2、请勿自行拆卸或投入火中、水中，避免造成短路漏电。
- 3、请勿在严重高温、潮湿或腐蚀性环境下使用无线充电器，避免损坏电路出现漏电现象。
- 4、请勿与带磁条或者芯片的磁卡（身份证、银行卡等）放置太近，避免造成磁卡失效。
- 5、请保持植入医疗设备（心脏起搏器、植入性耳蜗等）与无线充电器之间的距离至少为20cm，以避免对医疗设备造成潜在干扰。
- 6、应看管好儿童，以确保他们不将无线充电器当成玩具来玩，以避免不必要的意外。

说明书涉及图片均为示意图，最终产品以实物为准。  
内含：无线充电移动电源、150cm电源线、产品说明书  
\*不含电源适配器，如需要请另外购买或使用手机原装适配器。

Portable Wireless Charging Power Bank

User Manual

Thanks for choosing us!  
This is a smart phone wireless charger that allows you enjoy the fun of digital products easily.  
Please kindly read the user manual before using and keep it for future reference.

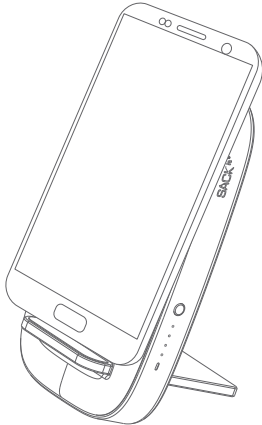

Connect to Power Adapter

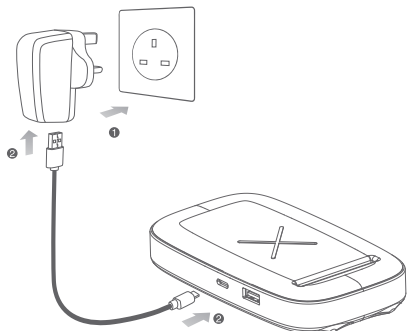

- ① Connect the power adapter to socket.
  - ② Connect adapter to the USB2.0 interface, the other micro USB to the power bank.
- \*When linked to power supply, the power bank will charge mobile phone firstly and then charge the power bank when the phone fully charged or move away.

Charge your mobile phone wirelessly

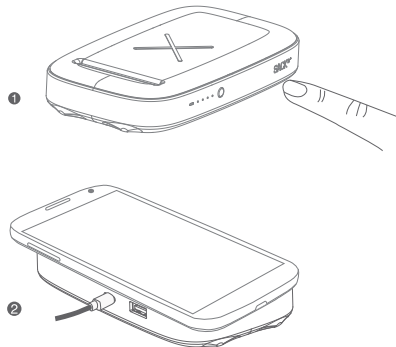

- ① Touch the switch, the power indicator light on and display the remaining power capacity, wireless charging indicator light will turn off after blue light and green light flash alternately.
  - ② When the mobile power is charged, the white LED light is prompted to charge in the form of a running horse lamp, which is extinguished after 30 S. Mobile power discharge, the current power LED always bright ,30 S after extinguishing.
- \*The wireless charging will shut down automatically if mobile phone leave mobile power bank for 30 seconds, and please touch start again if need charging.Wireless charging can be realized through the battery-powered coil if USB-C port without power connection .

Charging device with micro USB

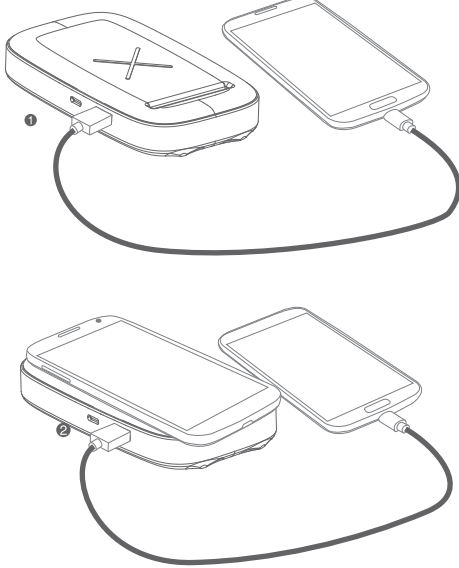

Specification

Battery: Polymer Li-ion Battery    Battery capacity: 6000mA  
Input voltage: DC5V/2A   DC9V/1.67A  
Output voltage: 5W/7.5W/10W  
USB-A output voltage: 5V/2.1A  
Dimensions: 140\*80\*24mm

Notes:

- 1、Do not squeeze or collied.
  - 2、Do not disassemble or throw into fire or water, to avoid causing a short circuit leakage.
  - 3、Do not use wireless charger in severely hot, humid or corrosive environments, to avoid circuit damage and occurs leakage phenomenon.
  - 4、Do not place too close with magnetic stripe or chip card (ID card, bank cards, etc.) to avoid magnetic failure.
  - 5、Please keep the distance at least 20cm between implantable medical devices (pacemakers, implantable cochlear, etc.) and the wireless charger, to avoid potential interference with the medical device.
  - 6、To take care of the children, to ensure that they won’ t play the wireless charger as a toy, to avoid unnecessary accidents.
- The involved images are sketch maps,the final product as per the material subjects.  
Includes: wireless charger, 150cm power cable, user’s manual.  
\*AC adapter is excluded, please buy separately or use the mobile phone original adapter if need.

This device complies with part 15 of the FCC Rules. Operation is subject to the following two conditions: (1) this device may not cause harmful interference, and (2) this device must accept any interference received, including interference that may cause undesired operation.  
Any changes or modifications not expressly approved by the party responsible for compliance could void the user's authority to operate the equipment.  
NOTE: This equipment has been tested and found to comply with the limits for a Class B digital device, pursuant to Part 15 of the FCC Rules. These limits are designed to provide reasonable protection against harmful interference in a residential installation. This equipment generates, uses and can radiate radio frequency energy and, if not installed and used in accordance with the instructions, may cause harmful interference to radio communications. However, there is no guarantee that interference will not occur in a particular installation.  
If this equipment does cause harmful interference to radio or television reception, which can be determined by turning the equipment off and on, the user is encouraged to try to correct the interference by one or more of the following measures:  
-- Reorient or relocate the receiving antenna.  
-- Increase the separation between the equipment and receiver.  
-- Connect the equipment into an outlet on a circuit different from that to which the receiver is connected.  
Consult the dealer or an experienced radio/TV technician for help.  
To maintain compliance with FCC’ s RF Exposure guidelines, This equipment should be installed and operated with minimum distance between 20cm the radiator your body: Use only the supplied antenna.

FCC ID:2A05W-CHARGEITS

Warning: Changes or modifications to this unit not expressly approved by the part responsible for compliance could void the user’ s authority to operate the equipment.