

3.8 inch

FRONT

- ⚠ WARNING**
- Remove and immediately recycle or dispose of used batteries according to local regulations and keep away from children. Do NOT dispose of batteries in household trash or incinerate.
 - Even used batteries may cause severe injury or death.
 - Call a local poison control center for treatment information.
 - Each earbud contains a LR1045 coin/button cell battery.
 - The battery voltage is 3.6V.
 - Non-rechargeable batteries are not to be recharged.
 - Do not force discharge, recharge, disassemble, heat above (55°C/131°F) or incinerate. Doing so may result in injury due to venting, leakage or explosion resulting in chemical burns.

⚠ WARNING: The earbuds contain non-replaceable batteries.

⚠ WARNING

- INGESTION HAZARD:** This product contains a button cell or coin battery.

- DEATH** or serious injury can occur if ingested.
- A swallowed button cell or coin battery can cause **Internal Chemical Burns** in as little as **2 hours**.
- KEEP** new and used batteries **OUT OF REACH OF CHILDREN**
- Seek immediate medical attention** if a battery is suspected to be swallowed or inserted inside any part of the body.



need some help?

Can't get it to pair? Have a question or comment?



call us at: 1-833-TGT-Tech or: 1-833-848-8324

safety

- Do not use near any water source
- Do not modify or repair this device
- Do not use chemical detergents to clean your device, use a soft dry cloth
- WARNING:** The battery (battery or batteries or battery pack) shall not be exposed to excessive heat such as sunshine, fire or the like

heyday™

FCC ID: 2AC23-QWS1 Model: QWS1 Input: 5V<1A
Earbud Battery Capacity: 3.7V40mAh/0.148Wh Case Battery Capacity: 3.7V<350mAh/1.250Wh Made in China
This device complies with part 15 of the FCC Rules. Operation is subject to the following two conditions: 1) This device may not cause harmful interference, and 2) this device must accept any interference received, including interference that may cause undesired operation. Warning: Changes or modifications to this unit not expressly approved by the party responsible for compliance could void the user's authority to operate the equipment.
NOTE: This equipment has been tested and found to comply with the limits for a Class B digital device, pursuant to Part 15 of the FCC Rules. These limits are designed to provide reasonable protection against harmful interference in a residential installation. This equipment generates, uses and can radiate radio frequency energy and, if not installed and used in accordance with the instructions, may cause harmful interference to radio communications. However, there is no guarantee that interference will not occur in a particular installation. If this equipment does cause harmful interference to radio or television reception, which can be determined by turning the equipment off and on, the user is encouraged to try to correct the interference by one or more of the following measures:
• Repoint or relocate the receiving antenna.
• Increase the separation between the equipment and receiver.
• Connect the equipment into an outlet on a circuit different from that to which the receiver is connected.
• Consult the dealer or an experienced radio/TV technician for help.
Target Corp. Mpls. MN 55403 Phone: 1-812-304-6073
For qualified repair specialists requesting repair information and parts please contact the original manufacturer at customersupport@gemfindyours.com

welcome!

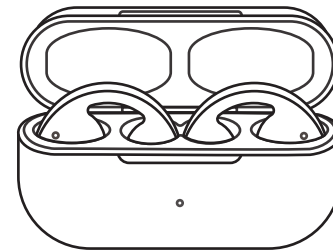

hey! welcome to your Heyday™ open ear wireless earbuds. let's get you set up.

cut line

fold line

DO NOT PRINT

how to fold



page 5

page 6

cover

page 6

page 7

page 8

cover

BACK

earbuds

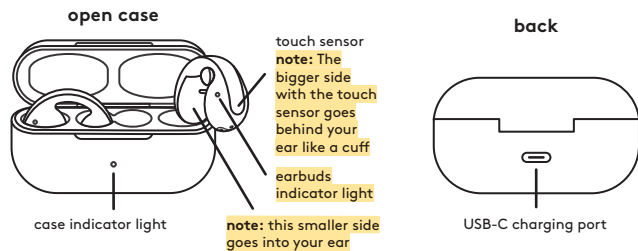

included

- Open ear wireless earbuds
- Open ear wireless earbud case
- USB-C charging cable

indicators

- Earbud Rapid Flashing White/Red - Pairing mode
- Earbud Solid White and then Fade - Paired
- Earbud Breathing Red - Low power
- Earbud Solid Red - Charging
- Earbud No Light - Charging complete
- Case Flashing White Light - Charging
- Case Solid White - Charging complete
- Ascending Tones - Power on
- Descending Tones - Power off
- Three Rapid Tones - Ready to pair
- Single Chime - Paired
- Two Rapid Dings - Low battery

pairing

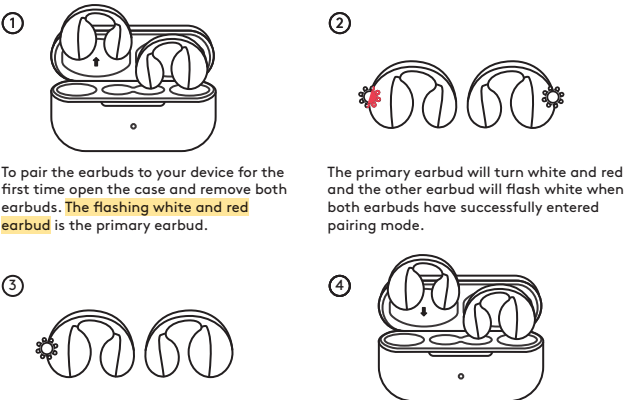

To pair the earbuds to your device for the first time open the case and remove both earbuds. **The flashing white and red earbud** is the primary earbud.

The primary earbud will turn white and red and the other earbud will flash white when both earbuds have successfully entered pairing mode.

Use the Bluetooth settings on your device to pair with **HEYDAY EARBUD 13**. When the earbuds have successfully paired, **both earbuds** will turn white for 5 seconds and then fade.

To reset to factory settings, **tap the touch sensor on both earbuds 5 times quickly**, the earbuds will flash red and white 3 times and turn off, then place the earbuds in the case. After resetting start the pairing process at step 1.

touch controls

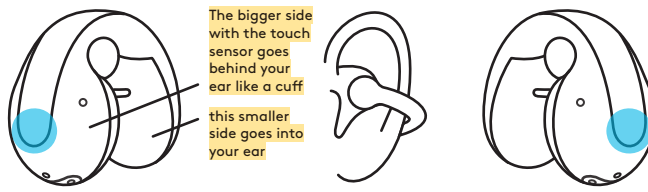

left earbud

- ⏮ - play/pause
- ⏮ - answer/end call
- ⏮ - prev. song*
- ⏮ - reject call
- ⏮ - voice assist

or

- 1 tap
- hold 2 sec.
- 3 taps

right earbud

- ⏮ - play/pause
- ⏮ - answer/end call
- ⏮ - next song*
- ⏮ - reject call
- ⏮ - voice assist

* - indicates that the left and right earbud have a different function

charging earbuds

- Place both earbuds back into the case
- Charging is complete when the earbud power indicator lights turn off
- Full charge requires approximately 2 hours, and will provide about 5 hours of earbud use

charging case

- Plug USB-C end of charger into the back of the case
- Plug USB end into a power supply of at least DC 5V 1A
- warning:** please use UL compliant power supply
- Full charge requires approximately 2 hours and will provide 20 hours of earbud use
- Charging is complete when the case power indicator is solid white

IPX4 water resistance

- The earbuds are resistant to sweat which means they're perfect for workouts **note:** the charging case does not have the same rating and should not be used in the same conditions

single earbud use

- After pairing to your device remove either earbud from the case to enter single earbud use

troubleshooting

- If the earbuds are not working correctly, **tap the touch sensor on both earbuds 5 times quickly and the earbuds will turn off, then place them into the case to reset them**
- If the earbuds won't turn on, recharge the battery and try again
- If the earbuds won't charge, make sure the power supply works, is 5V>1A, is not damaged and that the case is charged
- If the earbuds still won't charge, make sure the charge pins are clear of debris as this may cause a connection issue; if they are use a soft dry cloth to clean them
- If the earbuds make no sound or do not show as an available device, make sure they are not paired to other devices, if so unpair the device and repair to the desired device

page 2

page 3

page 4

page 5