

User Manual

A4 PORTABLE
HEAT TRANSFER PRINTER
XL-P808

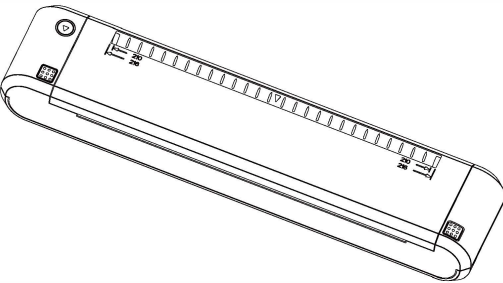

1.Packing Instruction

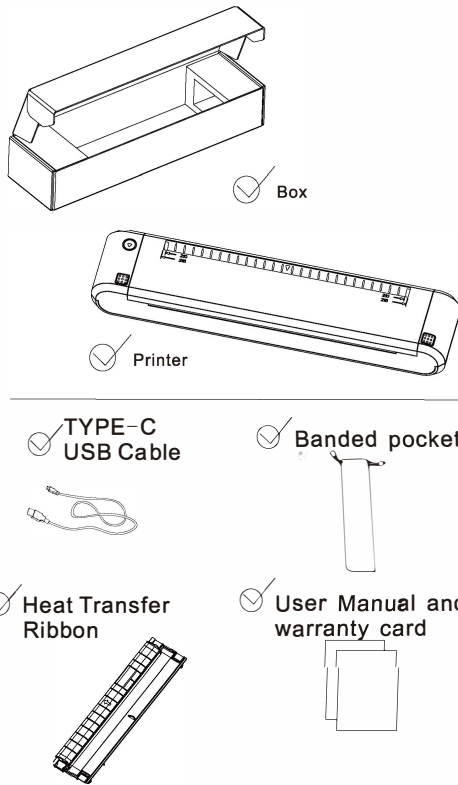

2.Operating Instructions

2.1 Deploy Copy Paper

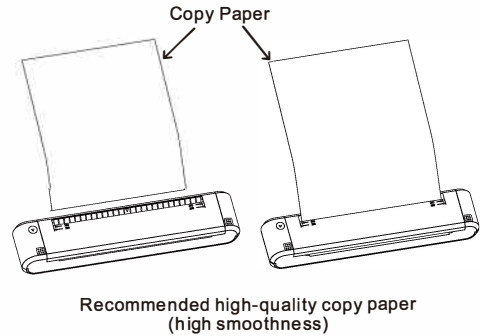

2.2 Deploy Transfer Ribbon

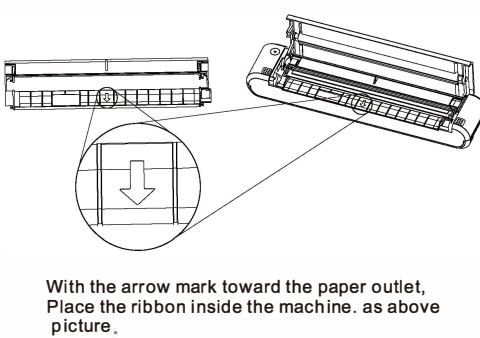

2.3 Exception Handling

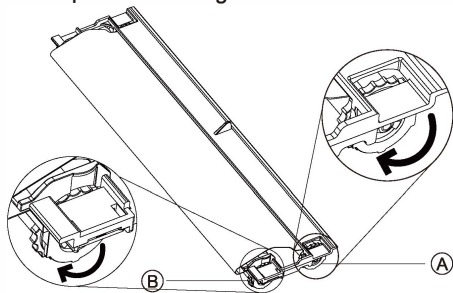

Transfer ribbon was rolled out of the outlet with the A4 copy paper during the printing process.
1. Turn off power, take out transfer ribbon.
2. Turn the "A gear" to rewind the loose ribbon; as above picture.
3. Adjust "B gear" to recycle the printed ribbon, or it could cause poor print quality.

2. 4 Daily Cleaning

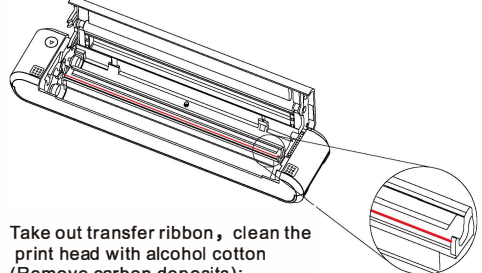

Take out transfer ribbon, clean the print head with alcohol cotton (Remove carbon deposits); as above picture.

3.Key Functions

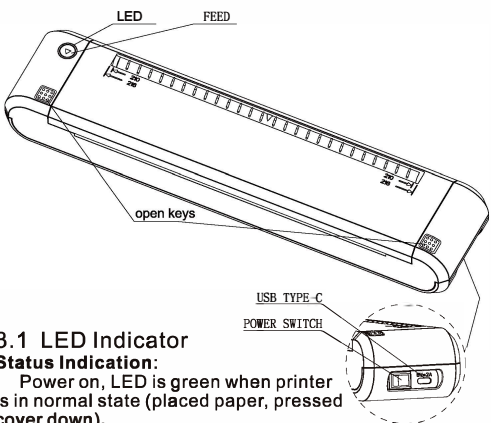

3.1 LED Indicator

Status Indication:

Power on, LED is green when printer is in normal state (placed paper, pressed cover down).
LED flash green slowly when printer is in an error state (out of paper or cover opened).

Charging Indication:

LED is red when charging; LED is off when fully charging.

3.2 Key Functions

Feed Paper key:

Short press to feed shortly. Press and hold for 3 seconds, feed out A4 paper. Press and holding feed key, and turn power switch on, to print the self-check information.

Open Key:

Press two keys at the same time to open upper cover, replace the transfer ribbon, clean the print head and paper jam issues.

Power Switch:

Power switch: press "-" to power on. press "O" to power off, Please turn off power after use.

4.APP print

4.1.App Download



Search "When turned on (with carbon ribbon installed), place A4 copy paper into the feed slot and the paper will automatically roll into the device. Shut down, long press the feed button, and turn on the power switch (switch from "O" to "-").ple Store or Google play

4.2.APP Operation

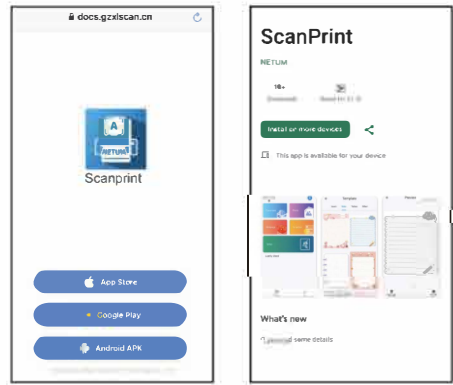

1 Scan the code to the "ScanPrint"

2 Download and install the APP

4.3. app print

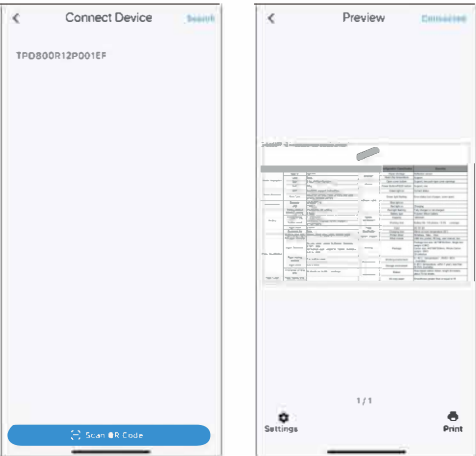

3 Tap available Bluetooth devices

4 Select the file to be printed

5.PC Print(Windows7/8/10)

5.1.Driver download

5.1.1.Link: driver.thermalprinter.cc/
thermalprinter-driver/TP800RT-12/
ThermalPrinter-12.rar

5.2.Driver installation

5.2.1.Connect the Printer machine to PC via USB cable.



5.2.2.Double click "Setup.exe".

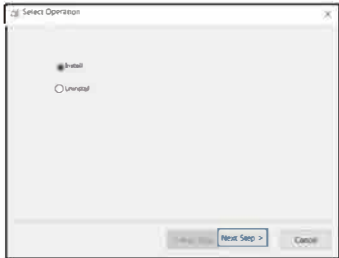

5.2.3.Click "Next Step".

5.3.Mac Driver installation



5.3.1.Double click "ThermalPrinter21.pkg".

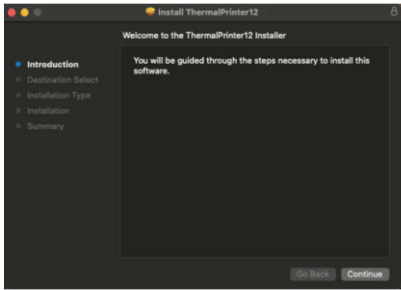

5.3.2.Click "Continue".

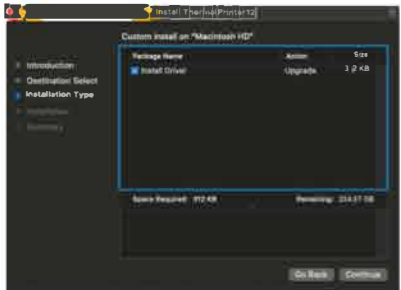

5.3.3.Click "Continue".

Announcements

If there is smoke, abnormal smell, or abnormal noise, turn off the power immediately. Continued to use may cause fire. You should unplug it immediately and contact the seller for advice. Do not attempt to repair the machine by yourself to avoid other faults. Do not disassemble or correct by yourself. Avoid damage to the machine or cause fire. Do not use a power supply that is not configured by the producers to avoid faults. Prevent foreign matter from falling into the machine, so as not to cause fire. If liquid flow into the machine, unplug it immediately, and contact the seller to find a solution, continued to use may cause fire. Do not use cables that are not configured by the company. Different connection methods may damage the machine. Place the machine on a firm, stable platform to avoid falling damage. Do not use the machine in damp and dusty places, pay attention to moisture proof. Please turn off the power when not in use for a long time.

The warranty and maintenance

The company guarantees that the product can play its superior performance under normal use and maintenance, and the company also provides a one-year warranty service.

maintenance
The maintenance of this product should be carried out by professionals with certain maintenance experience. Please do not change components without authorization during maintenance. Damage to drive board caused by unauthorized maintenance is not within the scope of warranty.

Warranty
Warranty period: the customers buy the machine from the company, have warranty period of one year calculated from the date of shipment. During the warranty period, the following conditions will not enjoy free service.
A.The driver board is damaged due to improper operation.
B.Damage caused by customer's own maintenance and transformation.
C.Damage caused by non-compliance with machine operating conditions.
d. Damage caused by natural disasters.

Certificate of approval

product model Numbers: _____

The date of production: _____

inspector: _____

Product warranty card

User name: _____

Purchase date: _____

Address: _____

Postal code / ZIP code: _____

RF exposure statement

This equipment complies with the FCC radiation exposure limits set forth for an uncontrolled environment. This transmitter must not be co-located or operating in conjunction with any other antenna or transmitter.

FCC Warning

This device complies with Part 15 of the FCC Rules. Operation is subject to the following two conditions:

(1) This device may not cause harmful interference, and (2) this device must accept any interference received, including interference that may cause undesired operation.

Note: This equipment has been tested and found to comply with the limits for a Class B digital device, pursuant to part 15 of the FCC Rules. These limits are designed to provide reasonable protection against harmful interference in a residential installation. This equipment generates, uses and can radiate radio frequency energy and, if not installed and used in accordance with the instructions, may cause harmful interference to radio communications. However, there is no guarantee that interference will not occur in a particular installation. If this equipment does cause harmful interference to radio or television reception, which can be determined by turning the equipment off and on, the user is encouraged to try to correct the interference by one or more of the following measures:

- Reorient or relocate the receiving antenna.
- Increase the separation between the equipment and receiver.
- Connect the equipment into an outlet on a circuit different from that to which the receiver is connected.
- Consult the dealer or an experienced radio/TV technician for help.

NOTE 2: Any changes or modifications to this unit not expressly approved by the party responsible for compliance could void the user's authority to operate the equipment.