

HANDHELD BUZZERS GAME SYSTEM

WIRELESS BUZZERS WITH MASTER CONSOLE



HOW TO PLAY?

- When a game buzzer is pressed, the master console will display the corresponding number for ten seconds.

- When multiple game buzzers are pressed, the master console will display the number of the 1st buzz-in only.

- All buzz-ins will be locked out for three seconds. Once three seconds has passed, the console will unlock for new buzz-ins.

These BUZZERS are a great addition to any classroom, board game, card game, game shows, trivia games and so much more!



Scan to visit our website

WHAT'S IN THE BOX?

Game Buzzers, Cables, 1 Wireless Game Console and Product Stickers.

BEFORE YOU PLAY:

Install 2 (AA) batteries into each joystick and install 2 (AAA) batteries into the game console (Batteries not included).

Turn console "ON" before use.

NOTE: Be sure to power the console off when not in use in order to not drain the battery

NOTE: If you are using a replacement joystick, please contact us for programming instructions for use.

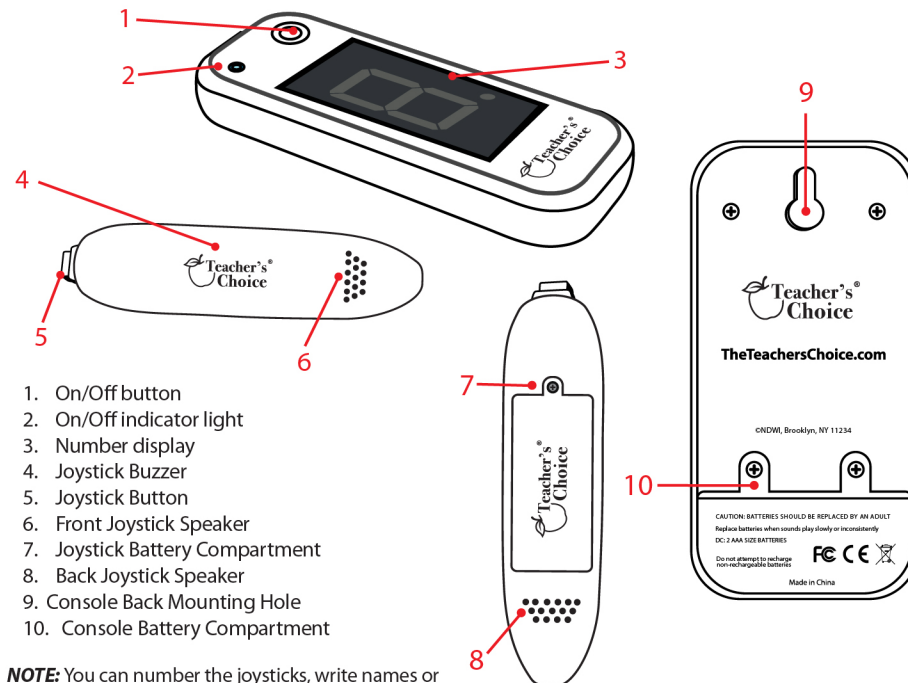

NOTE: You can number the joysticks, write names or label them as needed with the included stickers.

FCC Warning Statement

Changes or modifications not expressly approved by the party responsible for compliance could void the user's authority to operate the equipment. This equipment has been tested and found to comply with the limits for a Class B digital device, pursuant to Part 15 of the FCC Rules. These limits are designed to provide reasonable protection against harmful interference in a residential installation. This equipment generates uses and can radiate radio frequency energy and, if not installed and used in accordance with the instructions, may cause harmful interference to radio communications. However, there is no guarantee that interference will not occur in a particular installation. If this equipment does cause harmful interference to radio or television reception, which can be determined by turning the equipment off and on, the user is encouraged to try to correct the interference by one or more of the following measures:

- Reorient or relocate the receiving antenna.
- Increase the separation between the equipment and receiver.
- Connect the equipment into an outlet on a circuit different from that to which the receiver is connected.
- Consult the dealer or an experienced radio/TV technician for help.

This device complies with part 15 of the FCC Rules. Operation is subject to the following two conditions: (1) This device may not cause harmful interference, and (2) this device must accept any interference received, including interference that may cause undesired operation.