

Dell Weir MPM Label Content

**Confidentiality Statement:** The information contained in this document is the property of Sanmina.

Except as specifically authorized in writing by the authorized person from Sanmina; the holder of this document shall keep all information contained herein confidential and shall protect same; in whole or in part; from disclosure and dissemination to all third parties.

**Revision History:** See Revision History in Agile.

**Note:** This version of the Label Content was generated based on the Design Input documents such as Customer PRD's , SysRS document (MDC-DOC-004816) for Dell Weir Industrial Gateway Solution Device, as well as feedback from MET Laboratories.

## Table of Contents

1	SCOPE.....	2
2	PURPOSE .....	2
3	APPLICABLE DOCUMENTS.....	2
4	LABEL CONTENTS.....	3
4.1	SAFETY .....	4
4.2	ENVIRONMENTAL CONDITIONS .....	4
4.3	SERVICEABILITY .....	4
4.4	COUNTRY LIST .....	5
5	LABEL LOCATION.....	6
6	DRAWING.....	7
7	PREPARATION FOR DELIVERY .....	7
8	NOTES.....	7

Copies of this document are considered uncontrolled; unless otherwise specified. Verify the revision before use. Official document and revision history is available on Agile.

## Dell Weir MPM Label Content

## 1 SCOPE

This document contains the contents of the MPM Regulatory Label of Dell Weir Industrial Gateway Solution device.

## 2 PURPOSE

The purpose of this document is to outline the contents and requirements of MPM Label. This document is used for selecting and instructing suppliers and manufacturers of the MPM Label.

## 3 APPLICABLE DOCUMENTS

The latest revisions to the following documents form a part of this specification to the extent specified herein.

Item #	Reference ID	Title	Applicability
1	MDC-DOC-004816	Dell Weir Industrial Gateway Solution Design Specification	Defines specifications for the Dell Weir Industrial Gateway Solution, its components, accessories, packaging and labeling
2	MDC-DOC-004835	Dell Weir Industrial Gateway Solution MPM Engineering Specification	Defines specifications for the MPM module of Dell Weir Industrial Gateway Solution

Dell Weir MPM Label Content

#### 4 LABEL CONTENTS

**WEIR** Synertrex®

Weir Industrial Gateway

Model: MPM

Part: STX-000005

Serial:

Weight 18.8 kg, 41.4 lbs.

14.6A@24 V  $\overline{=}$  , 350 W

Unit 3, Cherrywood, Stag Oak Lane,  
Chineham, Basingstoke, RG24 8WF  
United Kingdom

IECEX certificate # IECEX EMT 17.0018X

ATEX certificate # EMT17ATEX0043X

Class I Division 2, Groups B,C,D T4

Class I Zone 2, AEx nA IIB+H2 T4

Ex nA IIB+H2 T3 Gc

$-30^{\circ}\text{C} \leq T_a \leq +70^{\circ}\text{C}$

IP66



E114376

Complies With  
UL/EN/IEC 61010-1  
CSA C22.2 No. 61010-1  
ANSI/ISA 12.12.01  
CSA C22.2 No. 213  
EN/IEC 60079-0  
EN/IEC 60079-15

II 3G

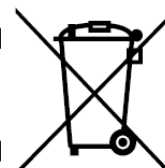

This device complies with part 15 of the FCC Rules.

Operation is subject to the following two conditions:

- (1) This device may not cause harmful interference, and
- (2) This device must accept any interference received, including interference that may cause undesired operation.

Contains FCC ID: 2ANXR-STXMPM IC: 23347-STX000004

This Class A digital apparatus complies with Canadian ICES-003.

Cet appareil numérique de la classe A est conforme à la norme NMB-003 du Canada.

WARNING: TO PREVENT FIRE OR SHOCK HAZARD, DO NOT OPEN COVERS, NO USER SERVICABLE PARTS INSIDE. REFER SERVICING TO QUALIFIED SERVICE PERSONNEL.

AVERTISSEMENT: POUR ÉVITER LE RISQUE D'INCENDIE OU DE CHOCS, NE PAS OUVRIR LES COUVERTURES. AUCUNE PIÈCE DE SERVICE UTILISABLE À L'INTÉRIEUR. CONSULTER L'ENTRETIEN AU PERSONNEL DE SERVICE QUALIFIÉ.

Dell Weir MPM Label Content

<b>4.1 SAFETY</b>			
Certification	DLWR_MPMLBL1-10	Material Certification with Shelf Life, Cure Date, and Traceable Lot Number	None
<b>4.2 ENVIRONMENTAL CONDITIONS</b>			
Temperature Range	DLWR_MPMLBL1-11	The label temperature range shall be at least -30C to +70C.	None
Storage & Transport Temperature Range	DLWR_MPMLBL1-12	The label storage/transport temperature range shall be at least -30C to +80C.	None
Storage & Transport Humidity Range	DLWR_MPMLBL1-13	The label shall be suitable for 0 % to 100% relative humidity, non-condensing conditions.	None
Environmental Safety	DLWR_MPMLBL1-14	Label shall be RoHs compliant	None
<b>4.3 SERVICEABILITY</b>			
Label Life Time	DLWR_MPMLBL1-15	The Label life time shall be at least 5 years.	None

## Dell Weir MPM Label Content

Label availability	DLWR_MPMLBL1-16	The availability of the Label has to be at least 5 years after end of production.	None
<b>4.4 COUNTRY LIST</b>			
Countries	DLWR_MPMLBL1-17	The Label shall be sellable in the following countries. Australia, Canada, Chile, China, Germany, Ireland, Netherlands, South Africa, United Kingdom, United States, Brazil	None

Dell Weir MPM Label Content

## 5 LABEL LOCATION

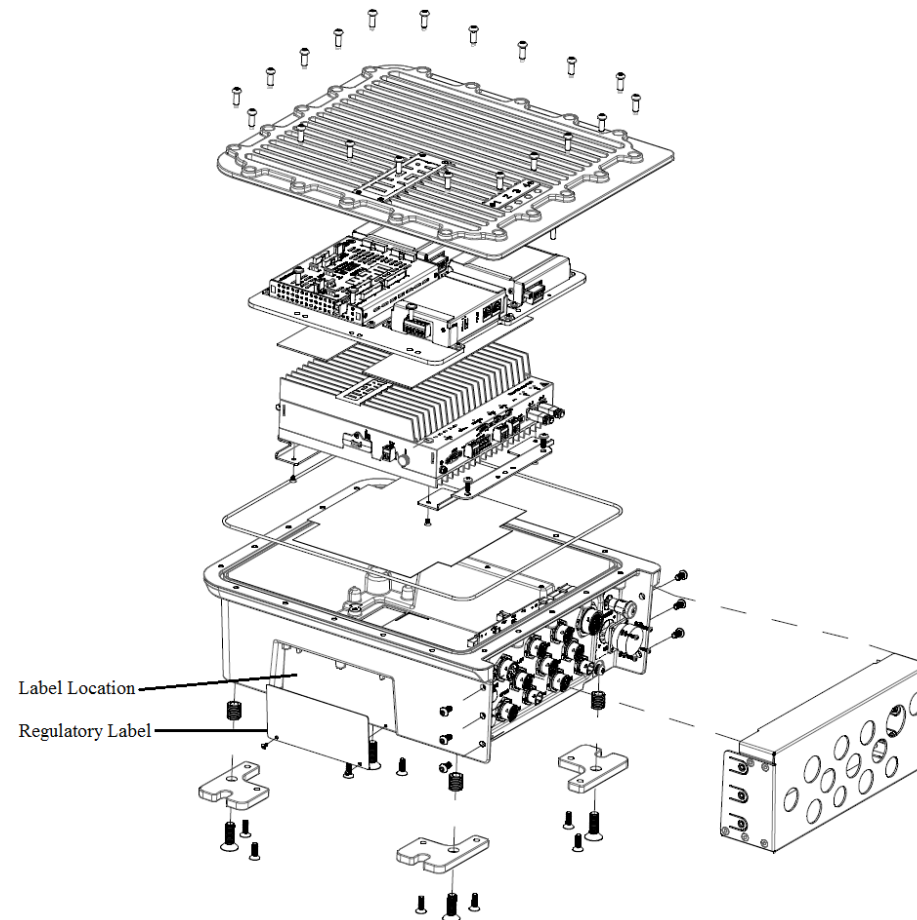

The MPM's regulatory label shall be mounted on the side of the enclosure in the recess shown in the figure. The label is secured using two M3x5 screws.

Copies of this document are considered uncontrolled; unless otherwise specified. Verify the revision before use. Official document and revision history is available on Agile.

Dell Weir MPM Label Content
-----------------------------

## 6 DRAWING

See 1004611-MDC-001 in Agile for latest drawing file.

## 7 PREPARATION FOR DELIVERY

All items shall be packaged for delivery such that they are protected from physical damage or deterioration until delivery at destination, and are acceptable to a common carrier. This may be done in packages and containers of the size and kind commonly used for this purpose, if these requirements are met.

## 8 NOTES

Labels shall be resilient and offer excellent resistance to grease, hydraulic oils, and motor oil.