

# Danfoss ICP versions with WiFi/BT

2018-11-22/Søren Lassen



# ICP versions

ICP with WiFi/BT,  
display and buttons



ICP with WiFi/BT

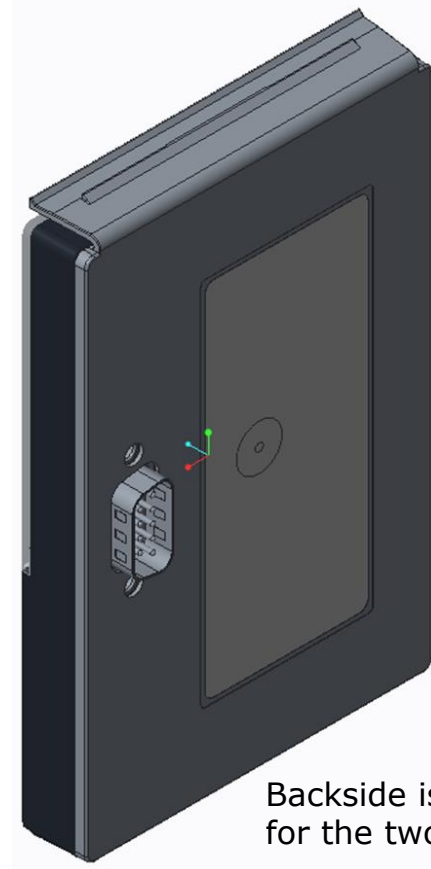
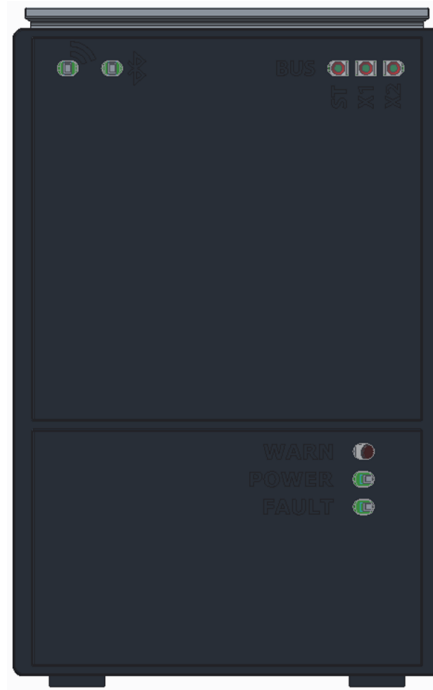

Backside is identical  
for the two variants

Both variants are delivered as interface options to the Danfoss portfolio of AC frequency Converter Drives

The options have only the full functionality when connected to a Danfoss drive

The electronics inside are based some exactly the same PCB where the option without display have the circuitry related to the display and buttons removed (see next slide)

# Exploded view of the parts of the fully equipped ICP variant

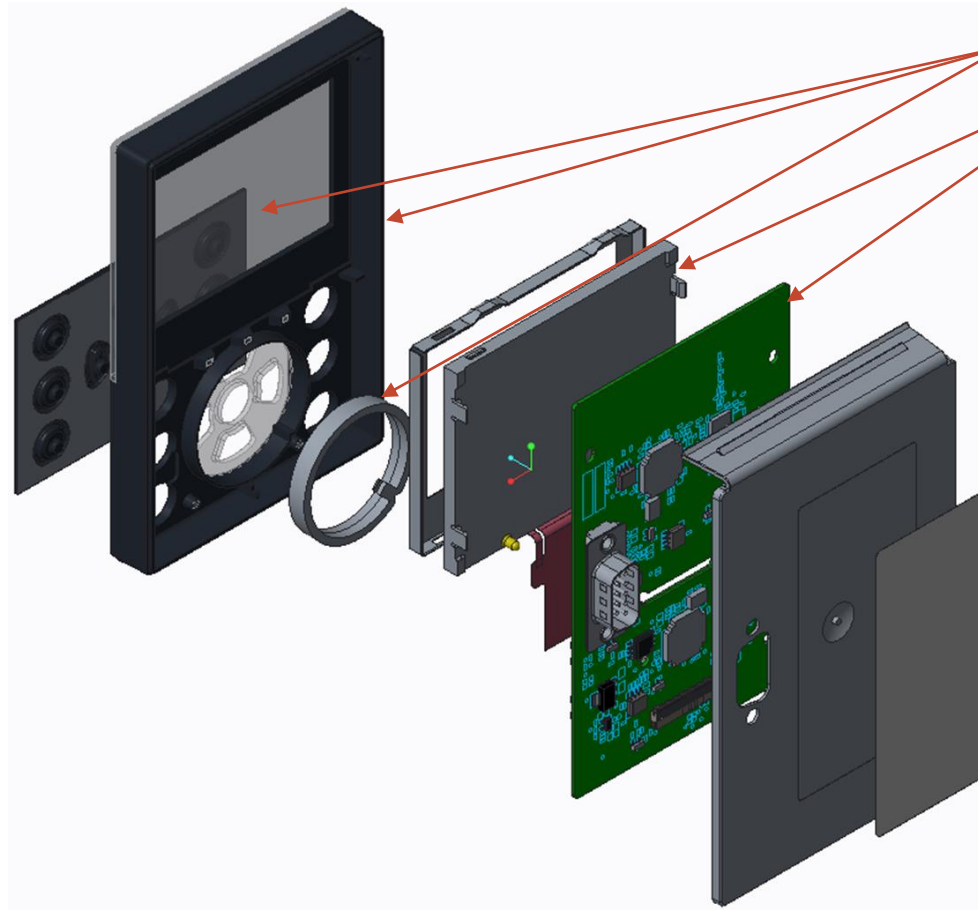

## Differences for the variant with only WiFi/BT:

1. Changed front plastic part incl. keypad foil and light guide ring
2. Display is removed
3. Reduced components on the PCB