

IR Bluetooth Ceiling Lamp

Operation instruction

(20150731)



深圳市瀚拓光电技术有限公司

ShenZhen MITLUX Optoelectronics Co., Ltd.

Catalogue

Overview	01
Product icons	01
Product Features	03
Product Specifications	04
Instructions	04
Packing list	09
Installation instructions	09
Answer for questions	12

1. Overview

Thanks for choosing Bluetooth Ceiling Lamp! In order to use the lamp in the right way, please read this manual carefully before using it and please keep properly to look up.

By remote control, users are free to adjust the brightness, audio volume, play/pause etc functions. The built-in Bluetooth of the lamp could connect Bluetooth of the mobile phone, computer etc digital device and play music in them.

The ceiling lamp is suitable for bedroom, study, living room etc, bring you a relaxing healthy and pleasant living environment.

2. Product icons

A. Ceiling Lamp picture

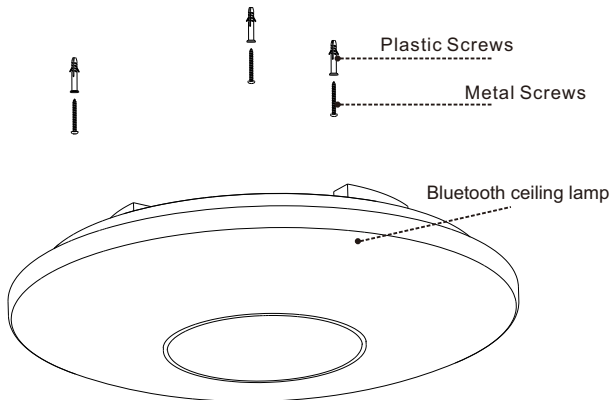

B. Remote Control & Installation diagram

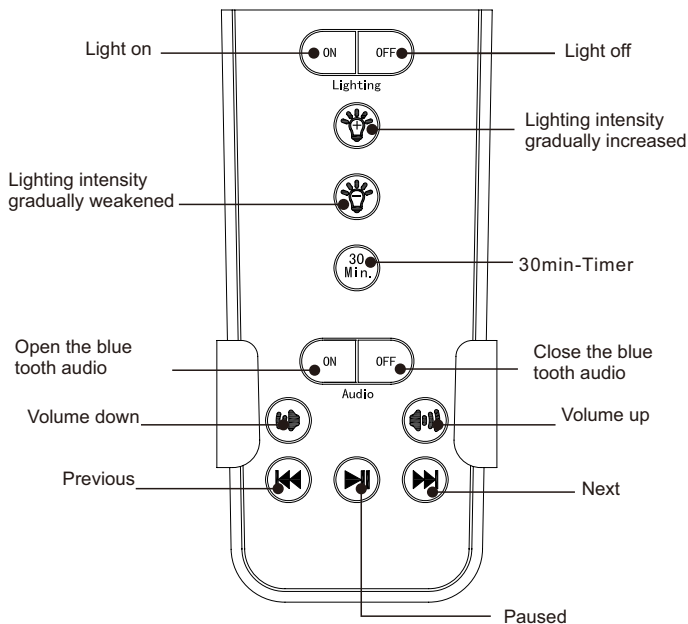

Remote control diagram

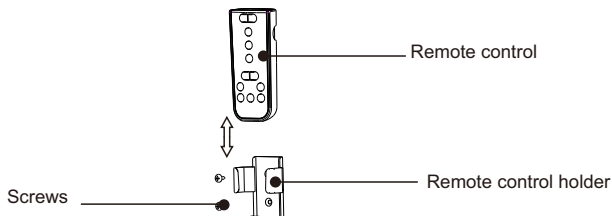

3. Product Features

- With simple product modeling & elegant appearance
- Adapting LED cold light source, High CRI, High luminance & long lifespan.
- Professional distribution design and hi-quality lampshade. with soft & uniform light.
- High-end audio make the tone quality more clear and bright.
- Adapting IR remote control to control the lamps' switch, luminance and the blue tooth module.
- The lamp speaker connect with blue tooth and blue tooth device of digital products, can play music, change songs, and adjust Volume.

4. Product Specifications

No.	Distinguish	Main technical parameters of MT-BC40W01 Bluetooth Ceiling lamp	
1	The Whole Lamp	Power	32W Max
2		Input voltage	120VAC 50/60 Hz
3		Protection	Overload, short circuit protection
4		The whole lamp size	ø400 × 79mm
5		Operating temperature	-10℃ to +40℃
6		Net Weight	1.7kg
7		Timing Switch	Close the whole lamp (light and audio)
8	Lighting	Lighting power source	<25W
9		Color Temperature	2900-3100K
10		Control method	IR remote
11		Light adjust	Dimming
12		Infrared remote control distance	Accessible <8m
13	Speaker	Speaker Specifications	2.75 inch
14		Rated Power	6W
15		Nominal impedance	6Ω
16		Frequency Range	120Hz-20kHz
17		Total harmonic distortion	≤5%
18		Bluetooth distance	Accessible situation> 10m

5. Instructions

Definition Description: Short press: Time <1.5 S; long press: time> 3S

Note: After the product successfully received remote command, it will issue a "pi" sound. If it's short press key as mentioned, the "pi" sound indicates that the operation is successful; If it's long press key, the function can reach to max/min when you will hear the "pi" sound again.

a. Timing Mode

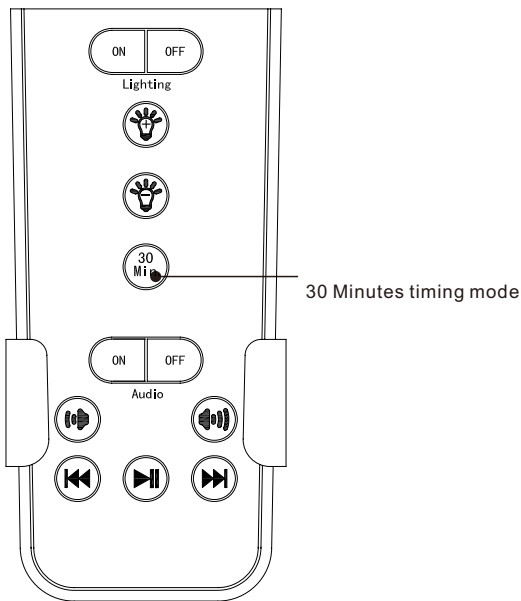

Instructions:

● Enter Auto Shutdown Timing Function:

Short press timing button, "pi pi" warning sound means ready. The lighting and audio will shut down at the same time after 30 minutes. Repeatedly short press timer will be subject to the last short press, the lighting and sound will be subject to the last short press.

● Exit Auto shutdown timing function:



Long press timing button, it will cancel the setting. When you hear "pi·····" long warning sound.

THIS PRODUCT MUST BE INSTALLED IN ACCORDANCE WITH THE APPLICABLE INSTALLATION CODE BY A PERSON FAMILIAR WITH THE CONSTRUCTION AND OPERATION OF THE PRODUCT AND THE HAZARDS INVOLVED

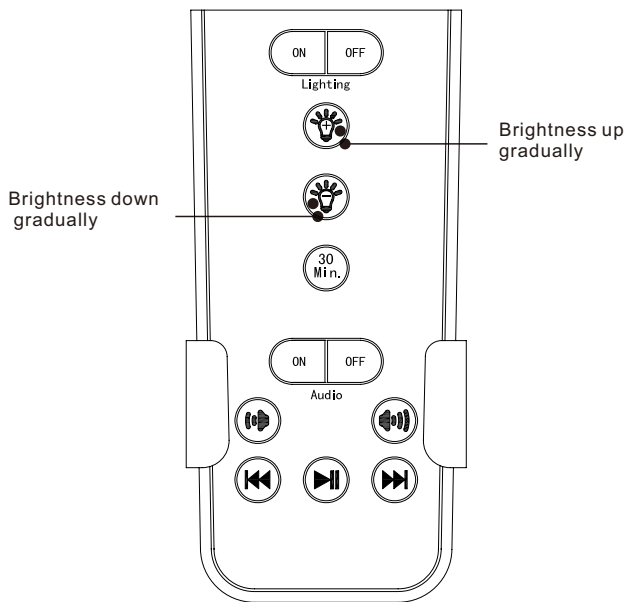
b. Brightness Up/Down mode



Instructions:

● Press “” or “” button, each press brightness enhancement or reduced, straight. To hear the “pi” sound after, that has reached the brightest or the darkest.

c. Bluetooth Audio

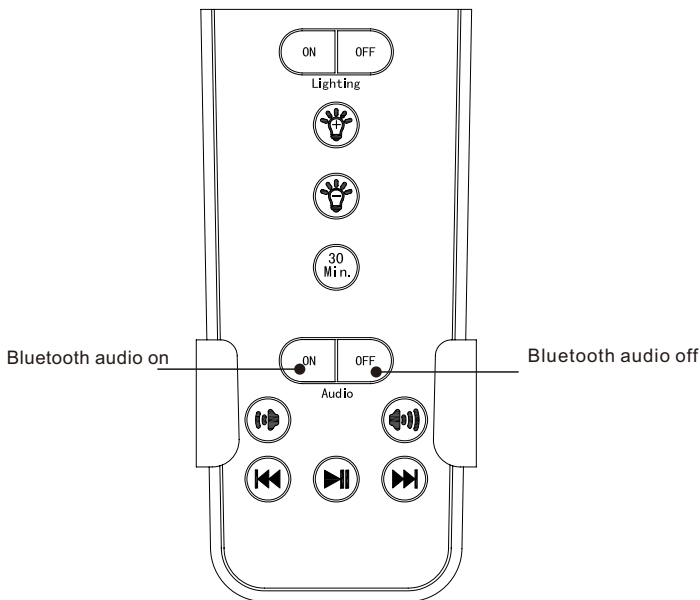

Operation:

- Short press "On", 2 seconds later will listen indicate sound.
- The Bluetooth will search the Bluetooth last time used mobile and connect with it automatically. if mobile Bluetooth still on.
- If automatically connection failed, it will warn, the Bluetooth will convert to matching model(indicator light quickly flash), search "LBT00738" and connect, listen "pi" sound the connection is OK.
- Turn on the music and play.

Notes:

- When matching with the Bluetooth speaker, Bluetooth device "LBT00738" could be found only when the indicator light flash quickly.
- It is normal if lamp responds 1-2 seconds delay when using the remote.

d. Music operation

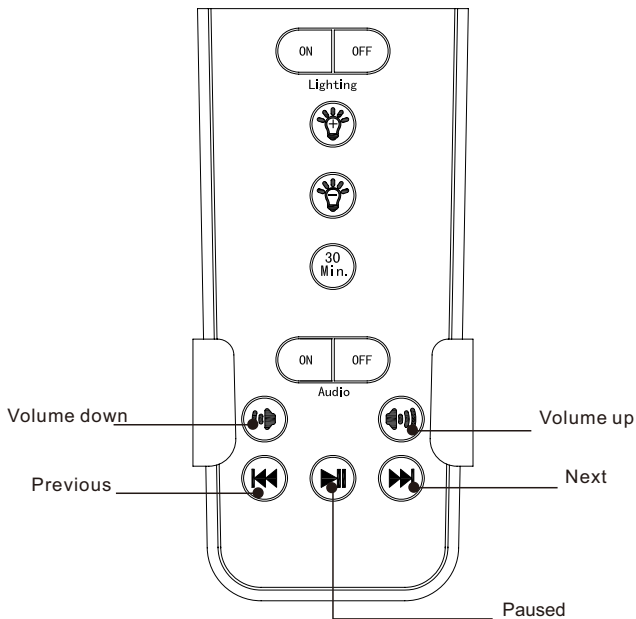

Instruction:

- Short press "Volume up", volume up, long press "Volume up", volume continuous up. When to max, "pi" sound warning
- Short press "Volume down", volume down, long press "Volume down", volume continuous down. When to min, "pi" sound warning
- Short press "Previous", music convert to last one
- Short press "Next", music switch to next one
- Short press "Paused", play/pause switch. All models are valid while music on.
Long press "Paused", cut the bluetooth connection.

6. Packing list

NO.	Part name	Quantity	Specifications
1	Ceiling Lamp	1pc	
2	Remote control	1pc	
3	Remote control holder	1pc	
4	3M tape for fix remote control	1pc	43X29X1MM
5	Metal screws for fix remote	3pcs	KA4X18MM
6	Plastic screws for holding lamp	3pcs	
7	Metal screws for holding lamp	3pcs	PWA4X45MM
8	Manual	1pc	



7. Installation instructions

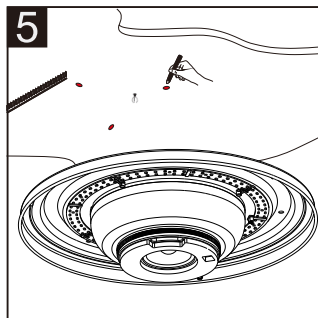
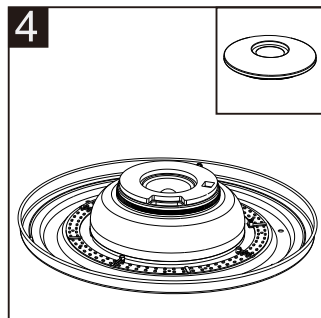
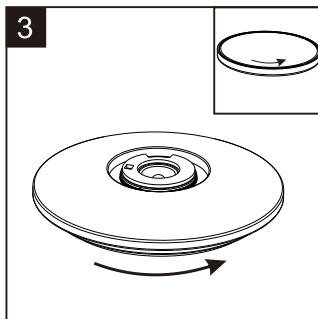
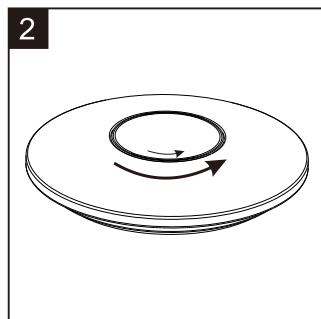
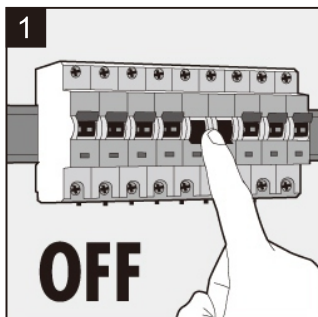
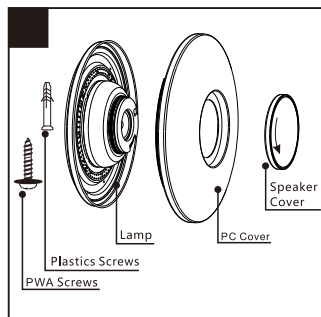

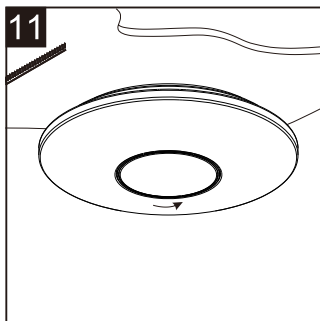
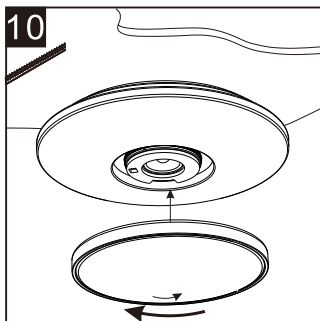
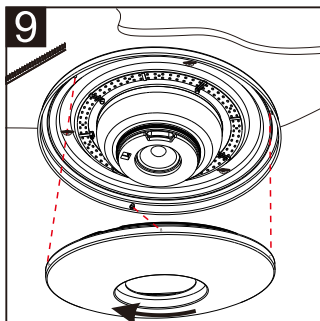
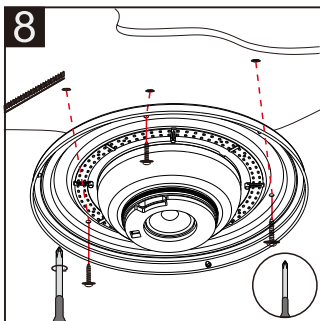
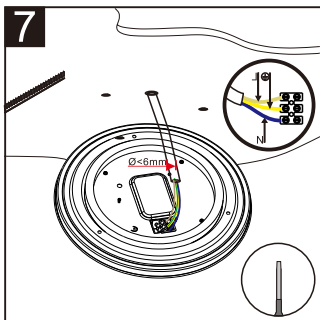
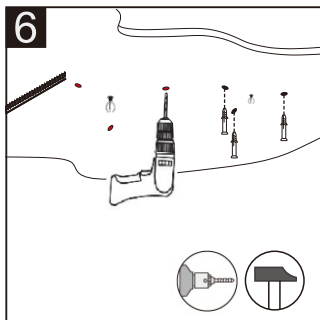



8. Answer for questions

Problem	Check by yourself
No sound	<ul style="list-style-type: none">● Please check if you have opened the Bluetooth and successfully connected the relative device.● Please check if it is the minimum voice, press “” to add volume;● Please check if it is in Pause condition, press “” to play;
Cannot find the Bluetooth	<ul style="list-style-type: none">● Please check if Bluetooth indicator light is flashing quickly or not, search the signal again when indicator light flash quickly;● Connect directly the device when finding “LBT00738” until it shows Connected.
No Light	<ul style="list-style-type: none">● Please check if lamp power on or not, press the remote control and check if indicator light or not.● Please confirm if batteries in remote control work or not;
Music not stable	<ul style="list-style-type: none">● Please check music document is good or not and test music on other music device.● Please check if the lamp has been fastened or not.

Note:



All electrical and electronic products including batteries should be disposed of separately from the municipal waste stream via designated collection facilities appointed by the government or the local authorities.

This device complies with Part 15 of the FCC rules. Operation is subject to the following two conditions: 1) this device may not cause harmful interference, and 2) this device must accept any interference received, including interference that may cause undesired operation.

Changes or modifications not expressly approved by the party responsible for compliance could void the user's authority to operate the equipment.