

# e-Button

## 便携蓝牙音箱

PORTABLE BLUETOOTH SPEAKER

产品使用说明书  
USER MANUAL

www.novomill.com.cn

15

## Contents

• Important safety notes	16
• Product features	17
• Product and accessories	18
• User interface	19
• Types of indicating LED and sound	20
• USB port and card reader	21
• Bluetooth connection	22
• Pairing mode	23
• Micro SD card and Hand free	24
• Silicone strape	25
• Change of cover	26
• Tech spec	27
• Troubleshooting	28

16

## Important safety notes

- Please follow this user manual.
- Please use and store this product between 0°C and 40°C.
- Please do not use this product in near heat sources such as radiators, hot air regulators, stoves or other heat generating equipment.
- This product is IPX4 waterproof, please unplug all cables and tightly cover the silicone cover before contact with water.
- Please do not contact product with water while charging, which may cause permanent damage to the product.
- Please do not throw or drop the product, prevent damaging the product from falling.
- Please use suitable charge adapter to charge the product.
- Please tune the sound of speaker to a suitable volume, prevent damaging to your hearing.
- Please do not step on or squeeze the charge cable.
- Li-Polymer battery is included in the product, battery (battery pack or battery) shall not be exposed to such as sunshine, fire or similar overheated environment. please do not disassemble the product, avoid it from damaging or other hazards. Piercing, short circuit of the product is strictly prohibited.
- If the product is not working, please contact with your distributor, disassemble of the product without permission will cause failure of warranty.

17

## Product features

- 8W high performance full range drive.
- Professional Digital Sound Processing (DSP), greatly improve the sound quality of wireless connection and avoid distortion.
- Tailor-made passive radiator, you can have wider and deeper bass.
- Pair, play and enjoy.
- Bluetooth 4.2, up to 10m transmission range.
- Hand free for answering phone.
- IPX4 waterproof.
- 1200mAh Li-polymer battery, up to 8-10 hours of playing time.
- Support Max. 128G Micro SD card of playing music with format of APE, FLAC, MP3, WMA, WAV.
- Interchangeable casing to create your own style.
- Environmental friendly silicone strape, it can be extended to double of its original length. e-Button can be easily for carrying, strapping and hanging wherever you need.

18

## FCC Statement & Caution

### FCC Statement

1. This device complies with Part 15 of the FCC Rules. Operation is subject to the following two conditions:

- (1) This device may not cause harmful interference.
- (2) This device must accept any interference received, including interference that may cause undesired operation.

2. Changes or modifications not expressly approved by the party responsible for compliance could void the users' authority to operate the equipment.

### FCC Caution

Note: This equipment has been tested and found to comply with the limits for a Class B digital device, pursuant to part 15 of the FCC Rules. These limits are designed to provide reasonable protection against harmful interference in a residential installation. This equipment generates, uses and can radiate radio frequency energy and, if not installed and used in accordance with the instructions, may cause harmful interference to radio communications. However, there is no guarantee that interference will not occur in a particular installation. If this equipment does cause harmful interference to radio or television reception, which can be determined by turning the equipment off and on, the user is encouraged to try to correct the interference by one or more of the following measures:

- Reorient or relocate the receiving antenna.
- Increase the separation between the equipment and receiver.
- Connect the equipment into an outlet on a circuit different from that to which the receiver is connected.
- Consult the dealer or an experienced radio/TV technician for help.

19

## Product and accessories

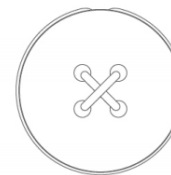

e-Button portable bluetooth speaker x 1



USB Charge cable x 1



User Manual x 1



After-sale service card x 1

## User interface

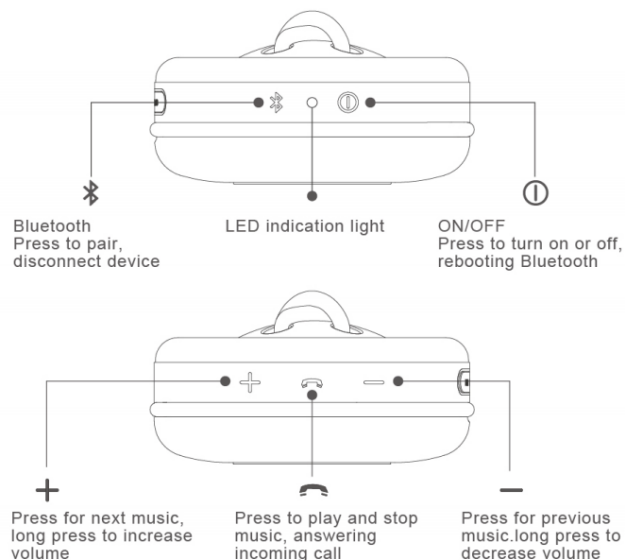

## Types of indicating LED and sound

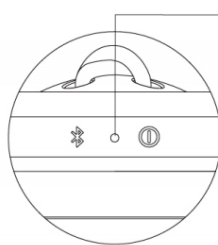

### Types of LED indicator light

**Turn On:** LED flash slowly in white color, waiting for Bluetooth connection, it turns to constant light when connection succeed.

**Charging:** LED in orange color constant light, it goes out when charge is complete.

**Pairing mode:** Main speaker LED flash fastly in white color, vice speaker LED flash slowly in white color. After pairing, main speaker LED in white color constant light, vice speaker LED flash slowly in white color.

### Types of indicating sound

- Turn on
- Turn off
- Bluetooth connection successful
- Bluetooth disconnected
- Maximum sound volume
- Micro SD card inserted
- Pairing mode activated
- Two speaker pairing succeed

## USB port and card reader

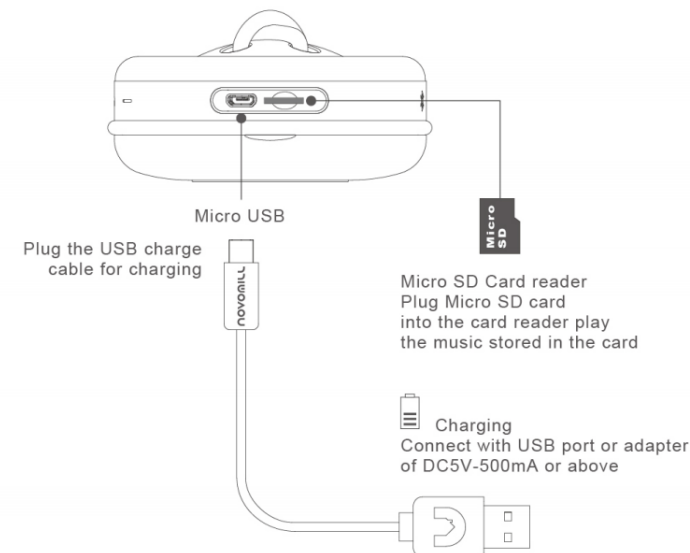

## Bluetooth connection

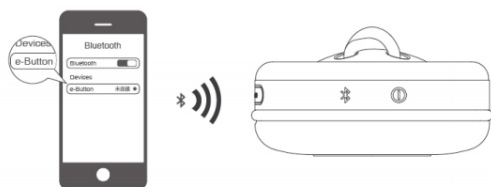

### Bluetooth search and connection

Long press ① 3 sec to turn on e-Button, open the bluetooth device list on your cellphone, tablet or laptop, find and connect with 'e-Button'. You will hear a sound if it is successfully connected and the LED will be changed to constant light.

#### Noted:

1. e-Button will connect with the latest connected device automatically of the final turning off.
2. If you need to connect e-Button with other device, press the ✕ button to disconnect with current device, and e-Button will wait for a new connection.
3. If connection is failed for several times, please restart e-Button and have another try.
4. If there is no operation in 10 min, e-Button will shut down automatically.

## Pairing mode



### Pairing

1. Please turn on two e-Button and make sure both are not connected with other devices (If your device is connected with e-Button before, please turn off the Bluetooth of your device to prevent connection back with your device automatically.)
2. Please press the ✕ button of one of the e-Button (This e-Button will become the main speaker). The LED of main speaker will flash quickly and search for another e-Button for connection.
3. After several seconds, you will hear a sound if two speaker are paired successfully, the LED of main speaker change to constant light and the other is flashing slowly.
4. Now connect your cellphone, tablet or laptop with e-Button and enjoy a wider, bigger and deeper sound. (If your device is connected with e-Button before, please ignore it before connection to avoid problem of connection of paired e-Button)

**Turning off:** Long press the ① button for 3 sec of one of the e-Button will turn off both of the e-Button at the same time.

**Please be noted that:** If two e-Button is paired latestly before turning off, two e-Button will pairing automatically if you turn on the two e-Button again.

## Micro SD card and Hand free

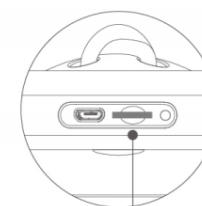

Please insert a suitable Micro SD card into the card reader, you will hear a sound if your card is recognized by the reader. e-Button will play the music automatically once the card is inserted with playable music format in the card. If Micro SD card is inserted, press the ① button can change between Micro SD mode and Bluetooth mode.

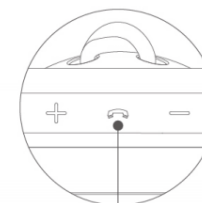

### Hand-free

1. Music will be paused automatically if there is incoming call. Press the ☎ button to answer incoming call.
2. Press the ☎ button again will hang up the call and the music will be continued.

Silicone strape

Silicone strape allows e-Button to place or hanging on different objects. When the strape in on the speaker,It can be :



Stand on any flat surface



Place on any flat surface

When the strape is taken off from the speaker, it can be :



You can push the silicone strape towards the concave to take it out easily.



Hang on any objects



Twining on bags clothes or bike

Troubleshooting

Fail to connect with device	Please reboot the speaker
Discontinuities appear while playing	Please check if there is any blocking between device or speaker is out of range.
Error in reading Micro SD card	Please check the card is not damage or the format of music file is readable
No sound during playing	Please check the volume or weather the music is paused
Not able to turn on the speaker	Please check the battery is charged or not
Fail to operate	Please reboot the speaker

Change of cover

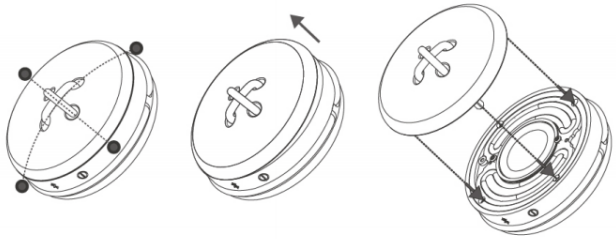

1. Choose one of the four indicated point as pic. 1 shown. Lift the cover open about 2mm (pic.2) at that point and do the same for another point,then take the cover off from e-Button slowly.
2. Install a new cover onto the speaker by make sure the four pillars on the cover are inserted in the holes on the speaker completely.

Tech Spec

Model No. : ES001  
Size : 92 x 92 x 50mm  
Material : ABS, Silicone,textile  
Charge voltage : 5V±0.5V  
Transmission range : 10 meter  
Speaker type : Active portable bluetooth speaker  
Channel : 1.0 channel + passive bass radiator  
Signal noise ratio : ≥82dB  
Driver : 4Ω 8W, φ 45mm  
Passive radiator : 80 x 13mm x 2 round shape raidiator  
Battery : 1200mAh Li- Polymer Battery (3.7V/1200mAh)  
Charge time : 80min  
Play time: 8-10 continous playing (Medium volume, standard test environment)  
Frequency response range : 20Hz-20KHz  
Transmitter frequency range : 2.4GHz-2.48GHz  
Waterproof level : IPX4 (splash proof)  
Application : Cellphone, tablet, laptop or other device support Bluetooth

Product name : e-Button  
Weight : 160g  
Charging : USB Charge cable  
Bluetooth ver. : 4.2  
Bluetooth transmitter power : class 2

深圳研物坊创意生活用品有限公司  
Novomill Creative Co.,Ltd.  
Tel: 0755-89324371  
e-mail: contact@novomill.com.cn  
www.novomill.com.cn



NOVOMILL 的产品受专利和商标法的保护  
The product of novomill are protected by patent and trademark law  
版权所有 仿冒必究  
All Rights Reserved

本生产企业通过 ( 德国TUV SUD ) ISO9001 质量管理体系认证, BSCI企业社会责任标准认证  
Our factory passed the (German TUV SUD) ISO9001 Quality management systems certification,and BSCI Business Social Compliance Initiative certification

