

## **Preface**

### **Copyright**

**Epic Optix** is a pending trademark of Epic Optix, Inc. Other trademarks are the properties of their respective owners and are hereby recognized.

### **Disclaimer**

This document is subject to change without notice. The manufacturer makes no representations or warranties with respect to the contents hereof and disclaims any implied warranties of merchantability or fitness for any particular purpose. The manufacturer reserves the right to review this guide and make content modifications when necessary without obligation of the manufacturer to notify any person of such revision or changes.

### **Trademark Recognition**

HDMI, the HDMI Logo, DLP®, the DLP® logo, and High-Definition Multimedia Interface are trademarks or registered trademarks of HDMI Licensing, LLC in the United States and other countries.

All other product names used in this manual are the properties of their respective owners and appropriately acknowledged.

### **Critical Safety Information**

*It is imperative that you carefully read this section before using the HUD. Safety and use instructions will ensure that you experience the approved use of the **HUD**. It is important to keep this manual for future reference.*

### **Warning Symbols**

Warning symbols are used on the unit and in this manual to warn you of potential hazardous situations.

The following warnings are used in this manual to notify you of important information:

**Note:** *Provides additional information on the topic at hand.*

**Important:** *Provides additional information that should not be overlooked.*

**Caution:** *Alerts you to situations that may damage the unit.*

**Warning:** *Alerts you to situations that may damage the unit, create a hazardous environment, or cause personal injury.*

Throughout this manual, component parts and items in the OSD (On-Screen Display) menus are noted in bold font as in this example:

### **General Safety Information**

- Never open the sealed HUD case/enclosure. For servicing, contact qualified service personnel, because self-service is not an option.
- Follow all warnings and cautions stated in this manual and designated on the unit case.
- By design, the projection light source is extremely bright.
- Do not place the unit on an unstable surface or stand.
- Avoid using the system near water, in direct sunlight, or near a heating device.
- Do not place heavy objects such as books or bags on the unit.

### **Power Safety**

- Use the supplied adapter ONLY.
- The adapter cable should be unencumbered. Therefore, do not place anything on the adapter cable and place it where it will not be in the way of foot traffic.

### **Regulatory Warnings**

Before installing and using the HUD, read the regulatory notices in the *Regulatory Compliance* section.

### **Symbol Explanations**



DISPOSAL: Do not use household or municipal waste collection services for disposal of electrical and electronic equipment. EU countries require the use of separate recycling collection services. Consult your local regulations before disposing of this product.

### **Main Features**

- Lightweight and easy to pack and transport.
- High brightness rating allows for presentations in daylight or in lit rooms with adjustments in projected image size.
- Flexible setup allows for front, rear, ceiling and rear ceiling projection positions.
- Direct projections are undistorted, with advanced keystone correction for angled projections.

### **About this User Manual**

This publication is intended for end users and describes how to install and operate the HUD. Wherever possible, relevant information—such as an illustration and its description—has been kept on one page. This printer-friendly format is both for your convenience and to help save paper, thereby protecting the environment. It is suggested that you only print sections that are relevant to your needs or consult the Manual via online links.

# Table of Contents

Preface ..... i

Chapter 1. At a Glance ..... 1

    Overview ..... 1

    Accessories..... 3

Chapter 2. Getting started ..... 4

    What You Need ..... 4

    Setting Up the HUD..... 4

Chapter 3. HUD Wi-Fi Mirroring Suite ..... 9

    Overview ..... 9

        iOS Wi-Fi Direct Mirroring mode ..... 10

        iOS Wi-Fi AP Mirroring mode..... 13

        Android Mirroring mode..... 18

        How to Update your Firmware ..... 19

Chapter 4. HDMI Mode..... 23

Chapter 5. On-Screen Display (OSD) Settings ..... 24

    OSD Menu Controls..... 24

Chapter 6. Taking Care of Your HUD..... 26

    Cleaning the HUD..... 26

    Specifications ..... 26

    Regulatory Compliance ..... 27

    Disposal and Recycling..... 27

Chapter 7 - Warranty Statement ..... 28

## Chapter 1. At a Glance

### Overview

#### Front View

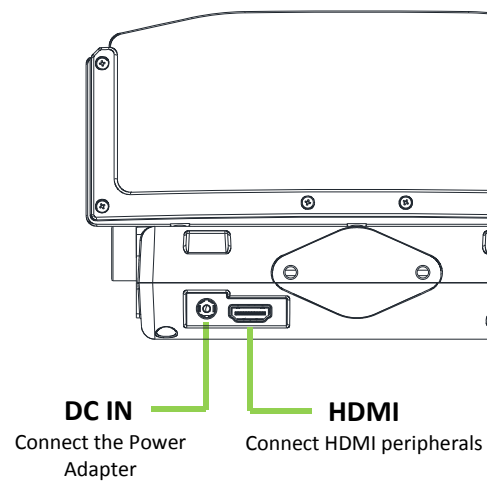

#### Rear View

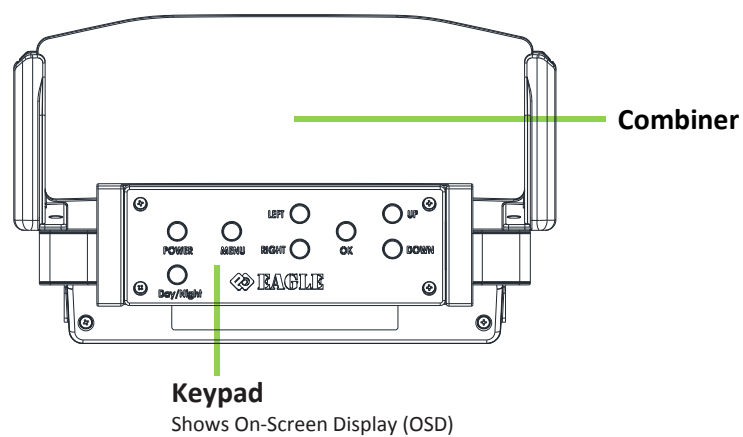

## Keypad

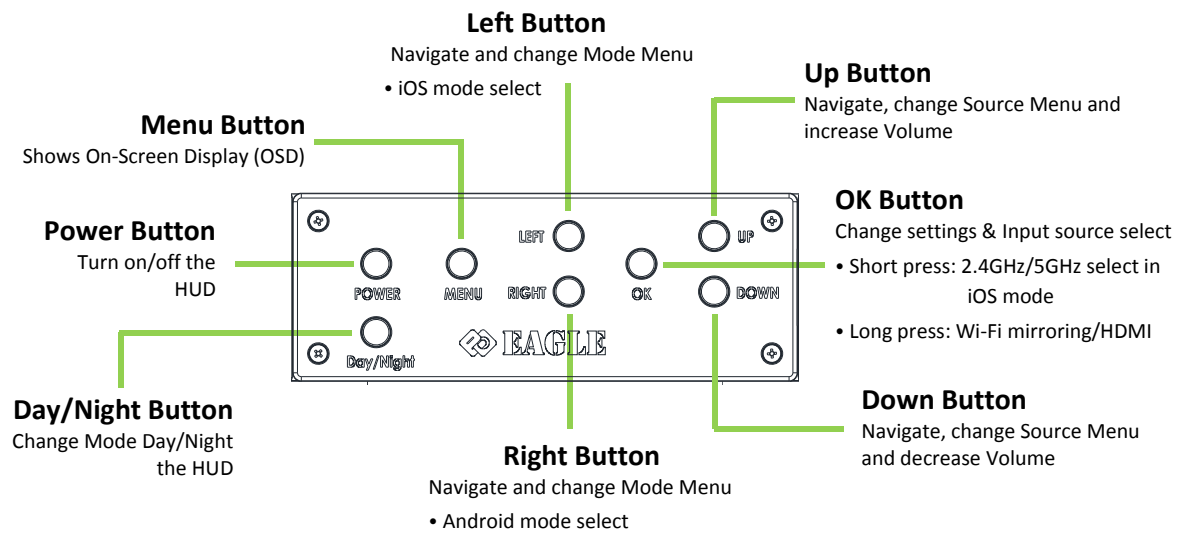

## **Accessories**

The following accessories are included with the HUD:

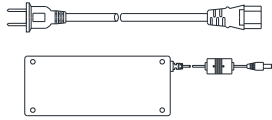

Regional Power Cord and Power Adapter

---



Cigar type Power Cable

---



Standard HDMI Cable

---

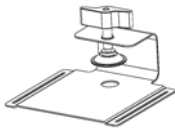

Glare shield Clip

---

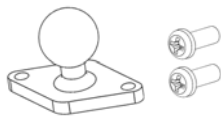

Ball Mount with 2 mounting screws

---

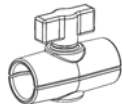

Double Socket Arm

---

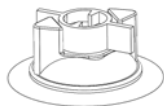

Suction Cup Mount

---



Optical Lens Cloth

---



Documentation Kit  
(Quick Start Guide, Warranty Card)

---

If any items are missing, appear damaged, or if the unit does not work, please contact your dealer immediately. It is recommended that you keep the original packing material should you ever need to return the equipment for warranty service.

## Chapter 2. Getting started

### What You Need

These devices can be connected to the HUD by using the appropriate cable. Make sure the connecting device has an appropriate output connector.

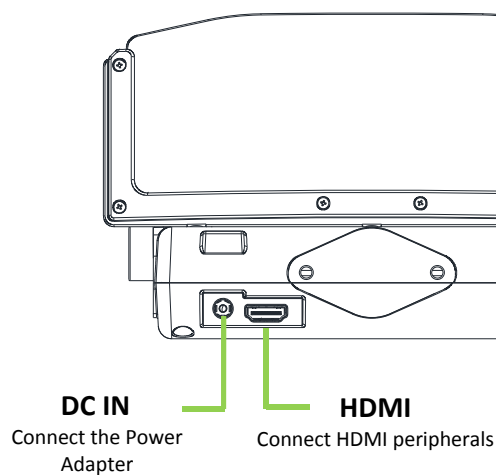

**Warning:**

As a safety precaution, disconnect all power and devices to the HUD before making connections.

### Setting Up the HUD

#### - **Connecting Apple® Devices (Wi-Fi)**

Refer to “iOS Wi-Fi Mirroring mode” in Chapter 3.

#### - **Connecting Android® Devices (Wi-Fi)**

Refer to “Android Mirroring mode” in Chapter 3.



### - Connecting Apple® Devices (Cable)

Connect an Apple® device to the HUD by using the following:

*HDMI to Apple® HDMI Adapter (not included)*

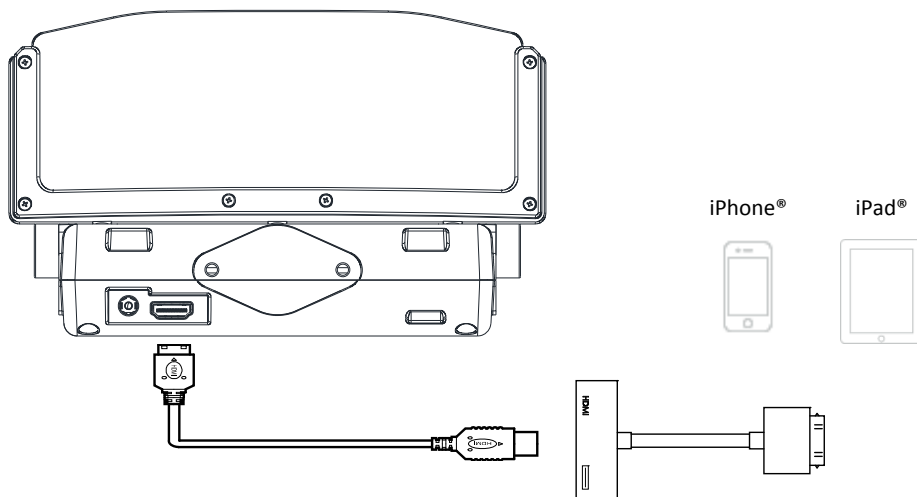

### - Connecting Peripherals by HDMI

Connect HDMI-compatible peripherals to the HUD using the Standard HDMI cable.

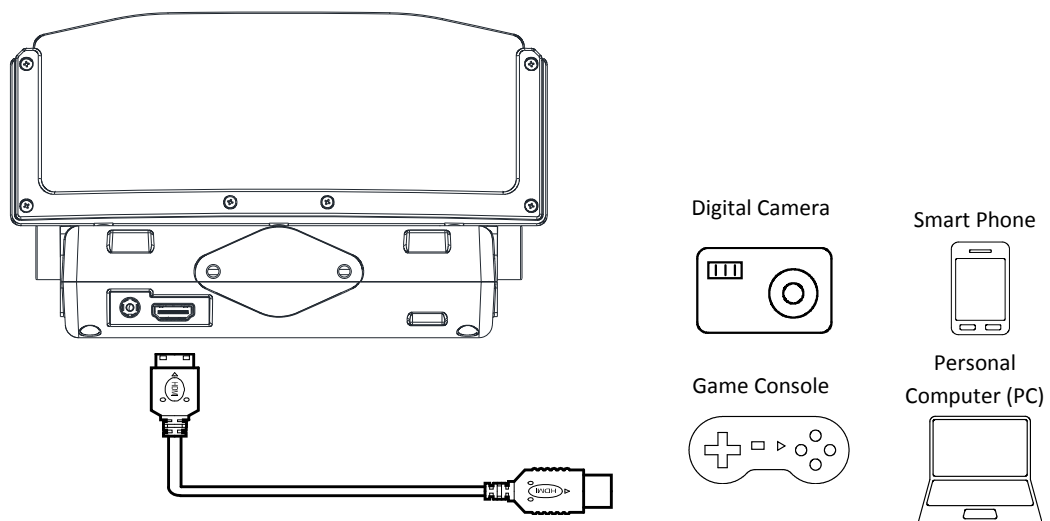

## - Starting and turning off the HUD

1. Connect the AC power adapter (or cigar cable) to the HUD. Connect the opposite end of the AC power adapter to a wall outlet.

**Note:**

Adapter models may vary between regions.

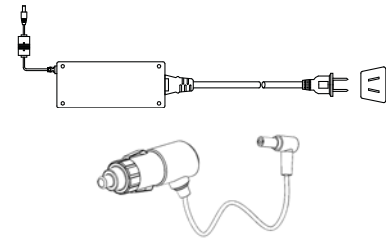

Press the POWER button on the keypad to turn on the HUD.

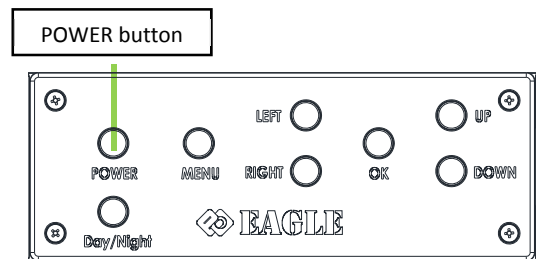

2. The HUD splash screen will appear, followed by the Wi-Fi Mirroring screen.



The Wi-Fi Mirroring screen will appear, then the HUD is ready to use Wi-Fi Mirroring on iOS mode.



3. Press the POWER button on the keypad to turn off the HUD.

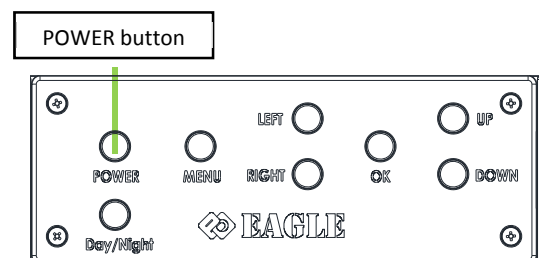

- Icon Guide

1. iOS Mode

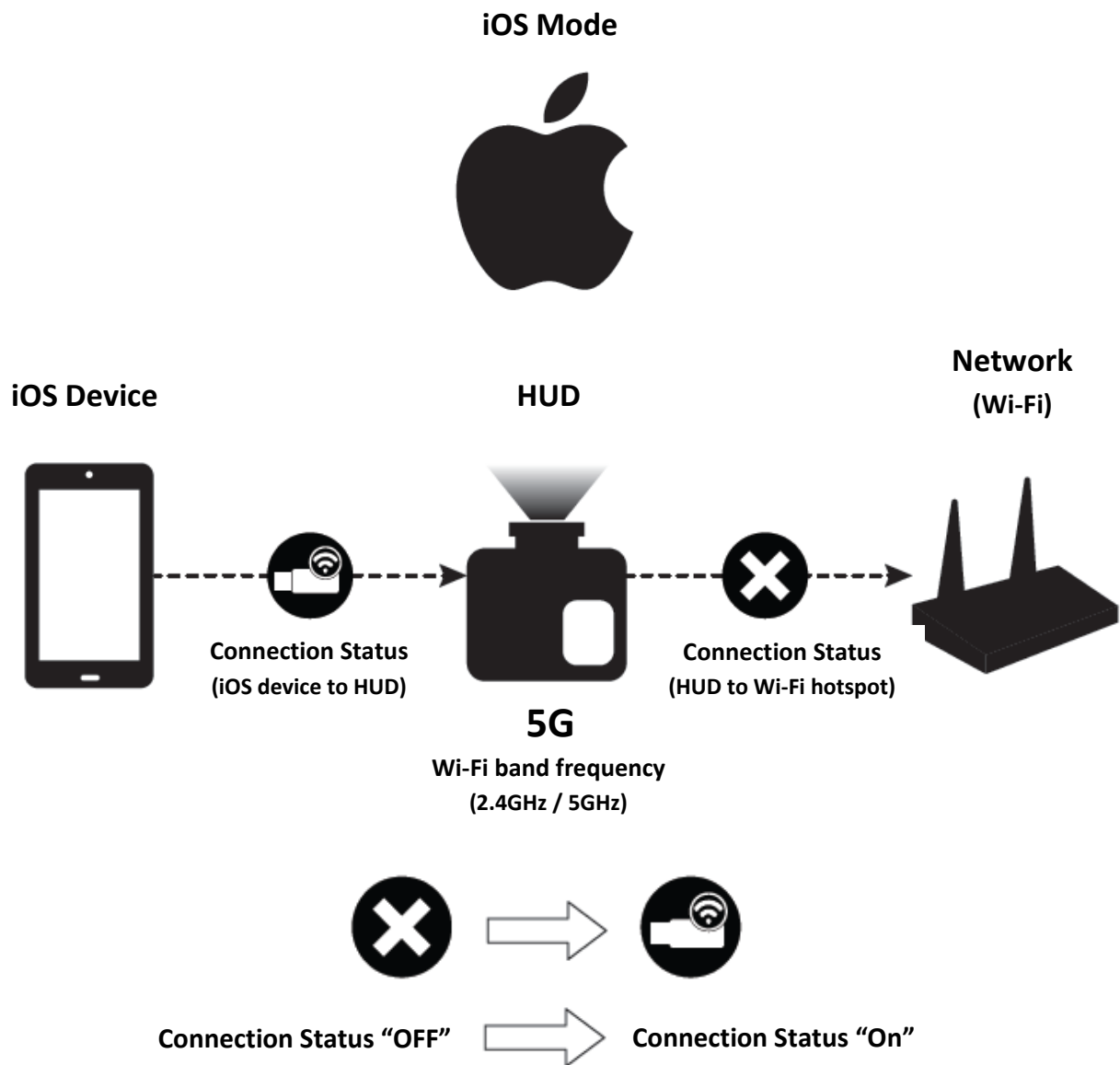

## 2. Android Mode

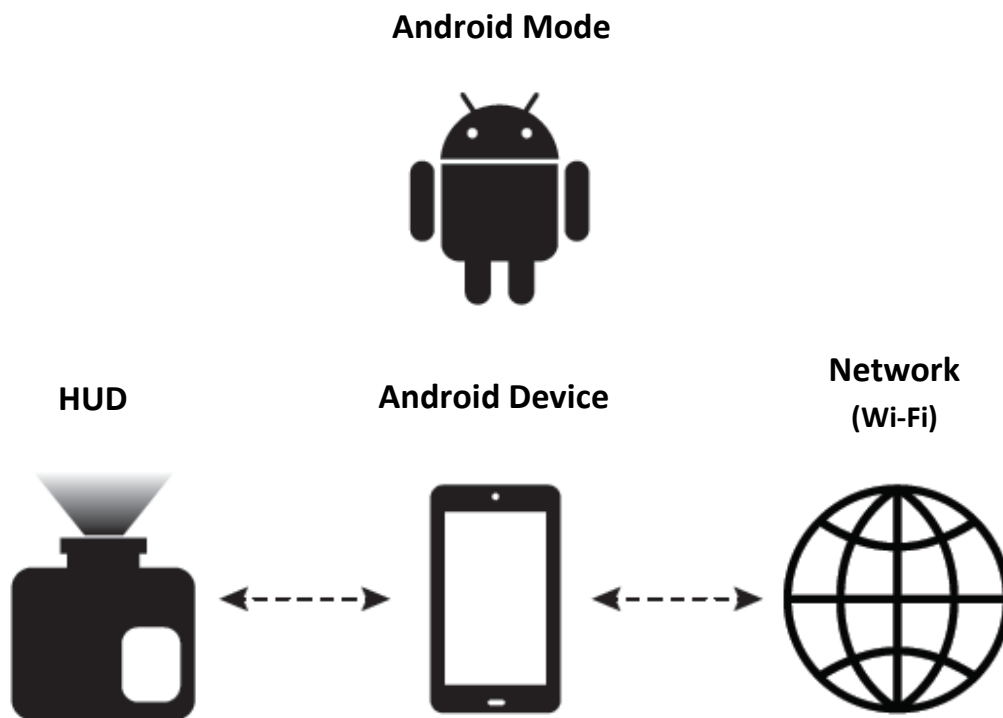

## Chapter 3. HUD Wi-Fi Mirroring Suite

### Overview

The HUD Wi-Fi Mirroring Suite is designed to provide easy access to Wi-Fi devices, such as smartphones or tablets.



The Wi-Fi Mirroring Suite menu contains 3 applications that can be accessed:

- iOS Wi-Fi Direct mode
- iOS Wi-Fi AP mode
- Android mode

## iOS Wi-Fi Direct Mirroring mode

: Not using Wi-Fi router

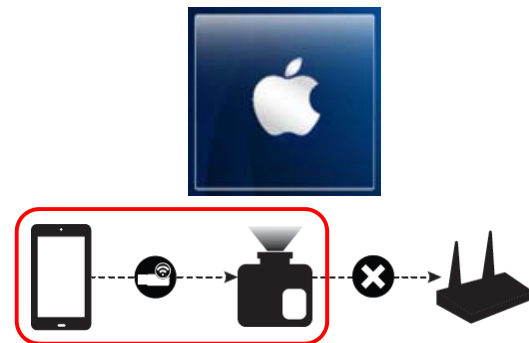

Perform the following:

1. Press the “Left” button to select the iOS Mode on the Wi-Fi Mirroring Screen.  
(If the HUD is already in iOS Mode, you do not have to press the “Left” button.)
2. Tap on “Settings” on your iOS device.

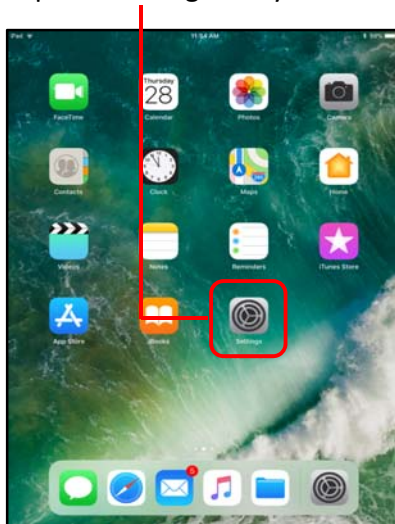

3. Tap “Wi-Fi” and choose the Epic device in the “Wi-Fi” network.

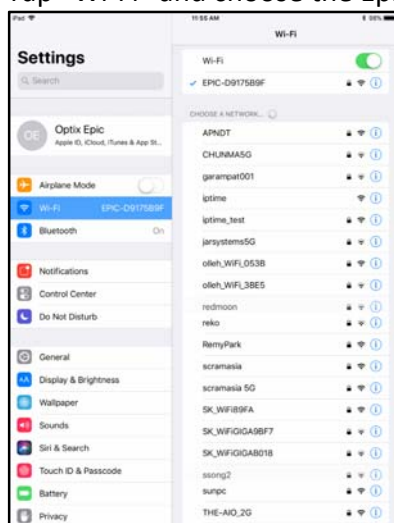

## EPIC OPTIX, INC

4. Enter the HUD password (PSK).



5. The connection status from the iOS device to the HUD will be 



6. Tap the “Home” button on your iOS device.



7. Swipe up and tap Airplay (Screen Mirroring) on your iOS device.

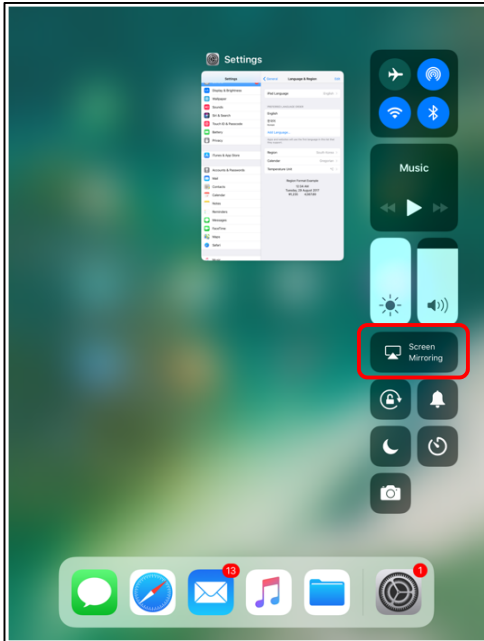

8. Select Epic device to Airplay.

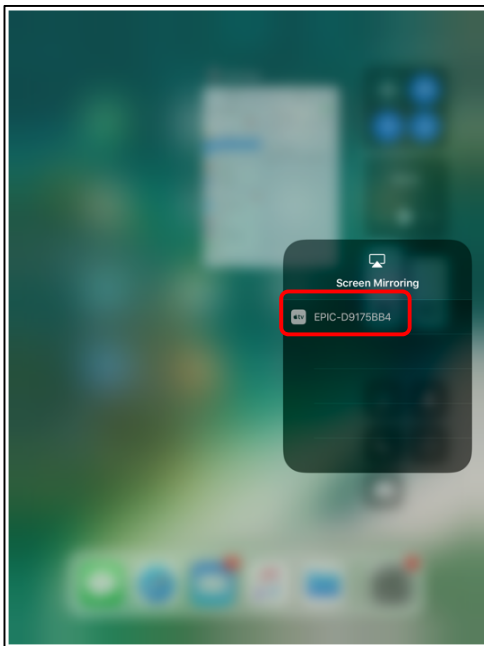



## iOS Wi-Fi AP Mirroring mode

: Using Wi-Fi router

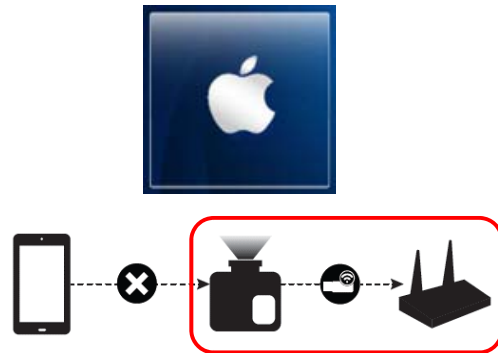

Perform the following:

1. Press the “Left” key to select the iOS Mode on the Wi-Fi Mirroring Screen.
2. (If the HUD is already in iOS Mode, you do not have to press the “Left” button.)
3. If necessary, switch from 5G to 2.4G with a short press of the “Select” button.
4. Tap on “Settings” on your iOS device.

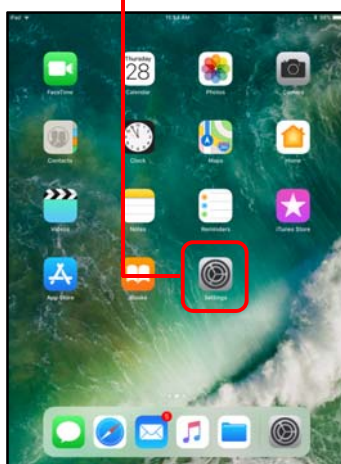

5. Tap “Wi-Fi” and choose the Epic device in the “Wi-Fi” network.

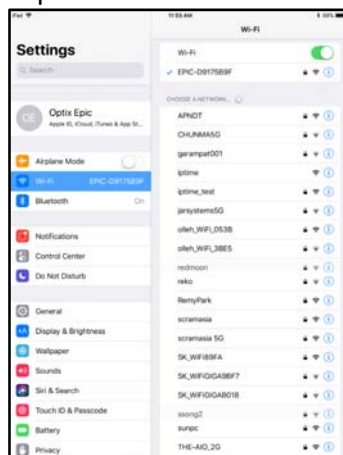

6. Enter the HUD password (PSK).

The connection status from the iOS device to the HUD will be 

The connection status from the HUD to the Wi-Fi hotspot will be 

**Default HUD Password**



7. Tap the “Home” button on your iOS device.



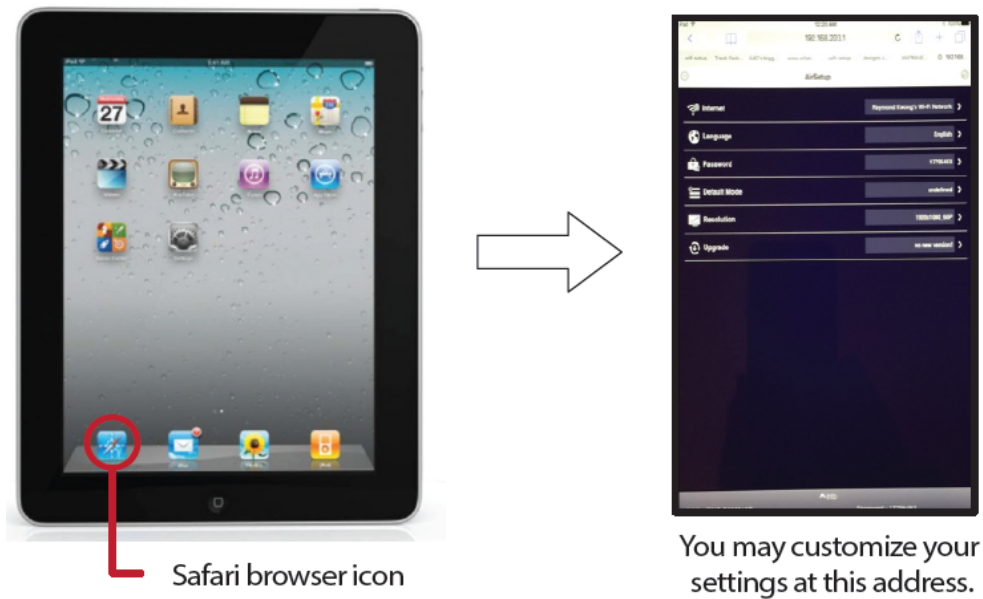

Home Button

8. Connect to your iOS device browser (Safari, Firefox, etc.) and input IP address 192.168.203.1.

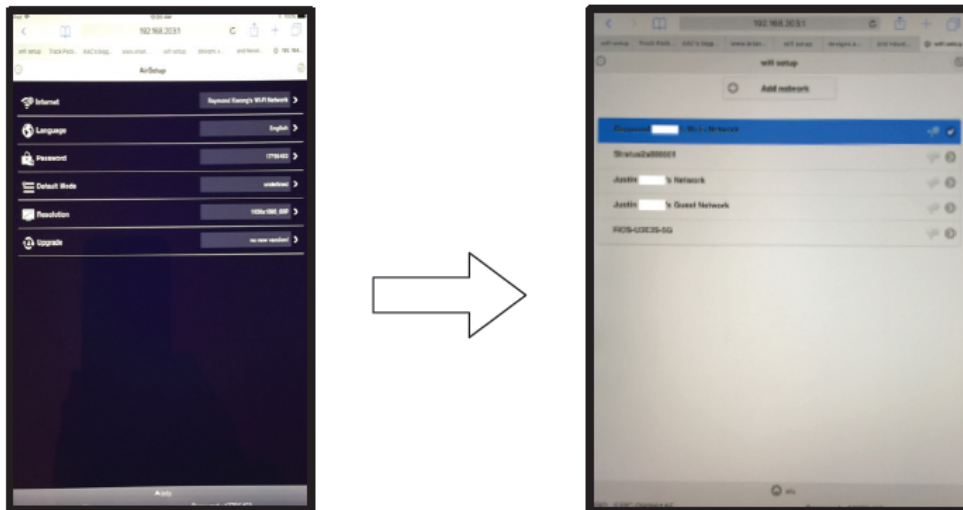

9. Establish your Wi-Fi hotspot.  
Tap "Internet" and wait for a list of networks to appear.  
Tap on your Wi-Fi router.



10. The HUD has connected to your Network Wi-Fi hotspot when  changes to 

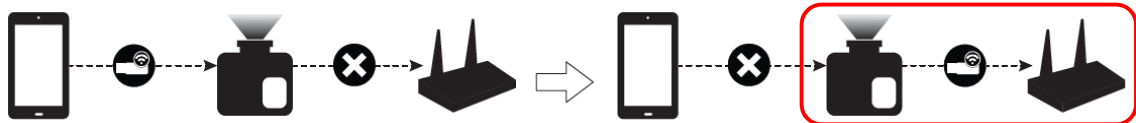

11. Exit your iOS browser by tapping the Home button of your iOS device.



12. Swipe up and tap Airplay (Screen Mirroring) on your iOS device.

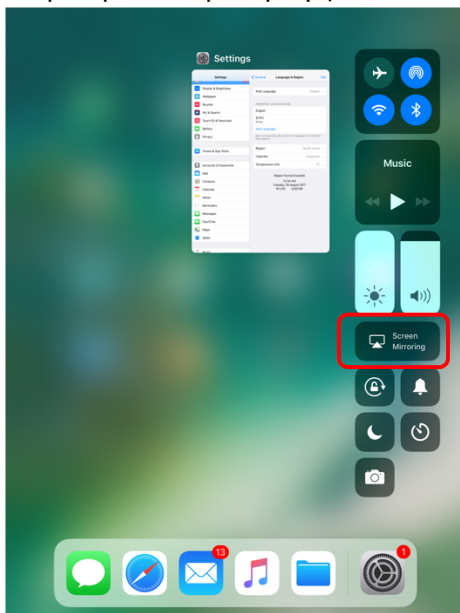

EPIC OPTIX, INC

13. Select Epic device to Airplay.

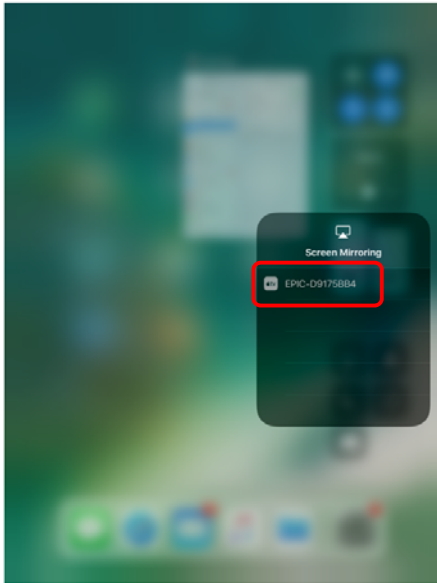

## Android Mirroring mode



Perform the following:

1. Press the “Right” button to select the Android Mode on the Wi-Fi Mirroring Screen.  
Android icon will become highlighted.  
(If the HUD is already in Android Mode, you do not have to press the “Right” button.)

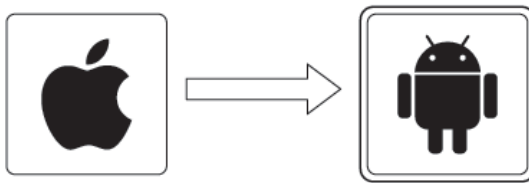

Icons under the Android icon will be changed from iOS mode to Android mode.  
This process may be delayed for a while.

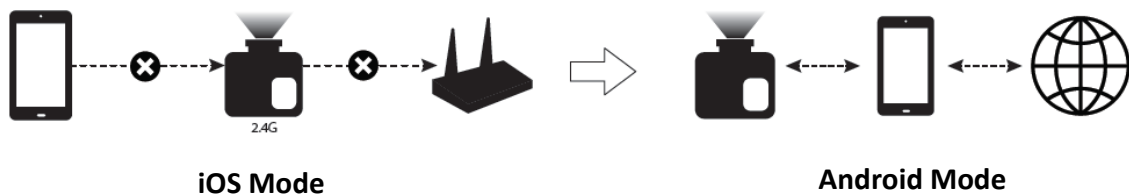

2. Swipe down and tap “Smart View” icon\*.  
(\* Check your Android User Guide as this will vary for each device)  
Select Epic device to your Android device.

a. Swipe down

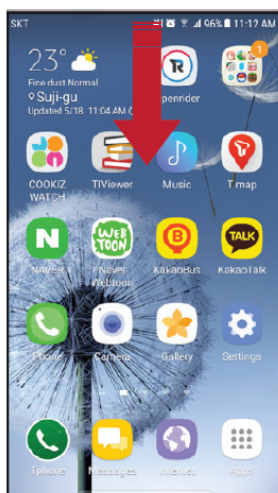

b. Tap “Smart View” icon

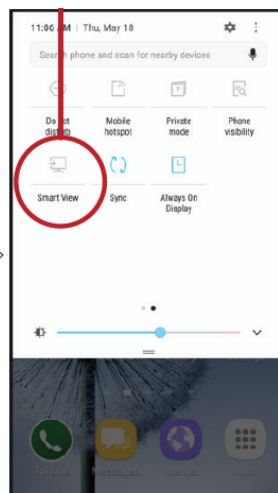

c. Connecting to HUD

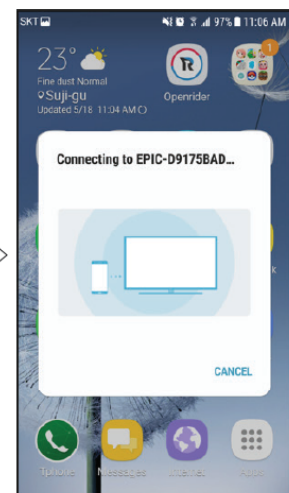

## How to Update your Firmware

### 1. Update with iOS device.

- 1) Power on HUD.
- 2) System is initialized when you see below.



- 3) Tap on "Settings" on your iOS device.

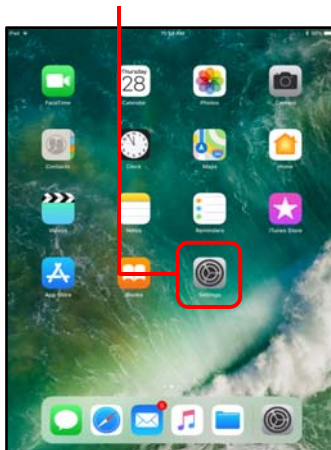

- 4) Tap "Wi-Fi" and choose the Epic device in the "Wi-Fi" network.

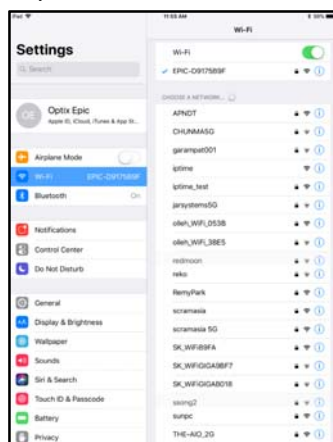

- 5) The connection status from the iOS device to the HUD will be 



- 6) Connect to your Android device browser (Google Chrome, etc.) and input IP address <http://192.168.203.1>
- 7) Tap "Internet" and wait for appearance of a list of networks.
- 8) Tap on Wi-Fi name of your router.

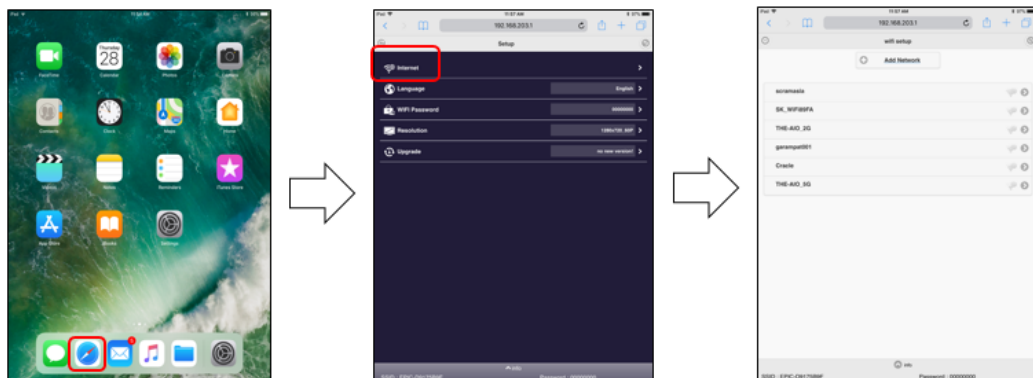

- 9) The HUD has connected to your Wi-Fi router when  changes to 

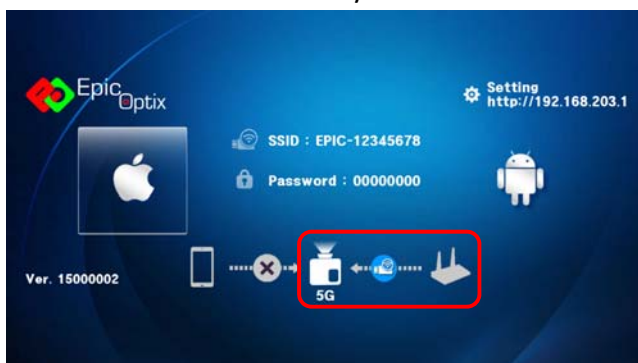

- 10) The HUD and Wi-Fi router are connected, they are automatically updated.  
Please update near a Wi-Fi router.



## 2. Update with Android device.

- 1) Power on HUD.
- 2) System is initialized when you see below.



- 3) Tap on “Settings” on your Android device.

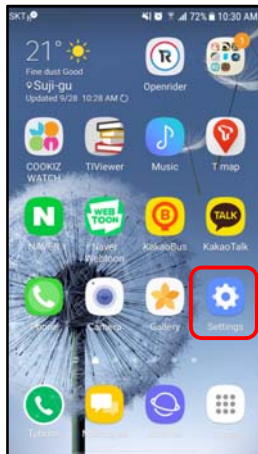

- 4) Tap “Wi-Fi” and choose the Epic device in the “Wi-Fi” network.

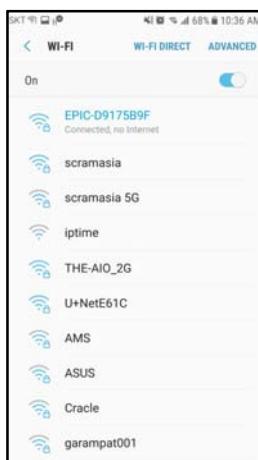

- 5) The connection status from the Android device to the HUD will be 



- 6) Connect to your Android device browser (Google Chrome, etc.) and input IP address <http://192.168.203.1>
- 7) Tap "Internet" and wait for appearance of a list of networks.
- 8) Tap on Wi-Fi name of your router.



- 9) The HUD has connected to your Wi-Fi router when  changes to 

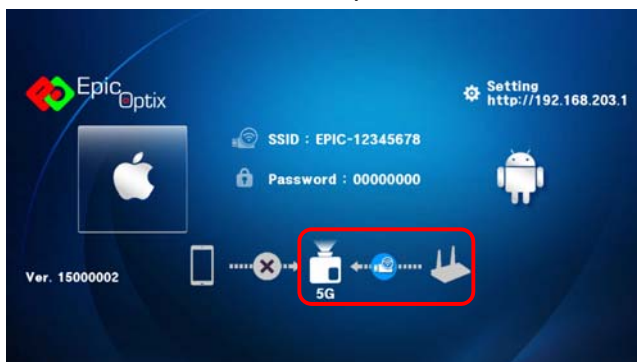

- 10) The HUD and Wi-Fi router are connected, they are automatically updated.  
Please update near a Wi-Fi router.

## Chapter 4. HDMI Mode

### How to Connect a HDMI.

1. Connect HDMI-compatible peripherals to the HUD using the Standard HDMI cable.
2. Please keep press “Select” button until Main Screen (Wi-Fi Mirroring Screen) changes to HDMI Mode. (approx. 5 seconds)  
If you press too short time, the HUD will not change to HDMI Mode, but the Wi-Fi band frequency will be changed to 2.4GHz or 5GHz.

If there is no HDMI signal, “No Signal” message will appear.

## Chapter 5. On-Screen Display (OSD) Settings

### OSD Menu Controls

The HUD has an On-Screen Display (OSD) settings menu that allows you to make adjustments and changes to Settings, such as Display Settings.

- Information – This menu show you the information of the HUD state.

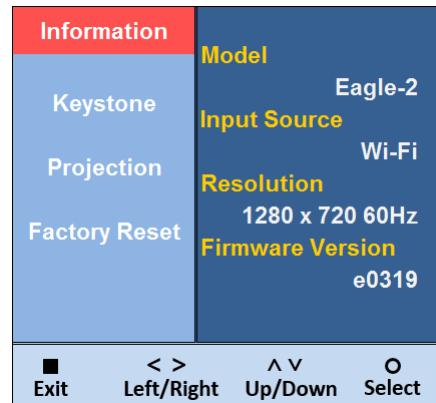

- Keystone – The HUD adjusts the image shape when the HUD and screen/wall are not perpendicular.

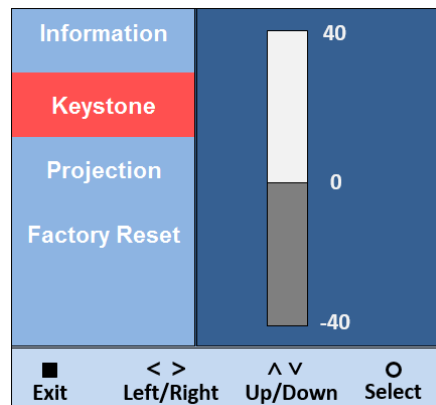

- Projection – Change the image 180° (mirror image) depending on your set up

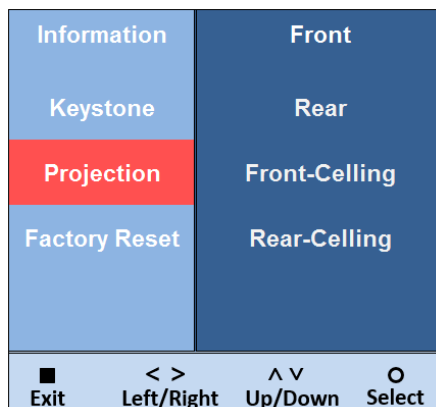

## EPIC OPTIX, INC

- Factory Reset – Reset your HUD back to default factory settings.

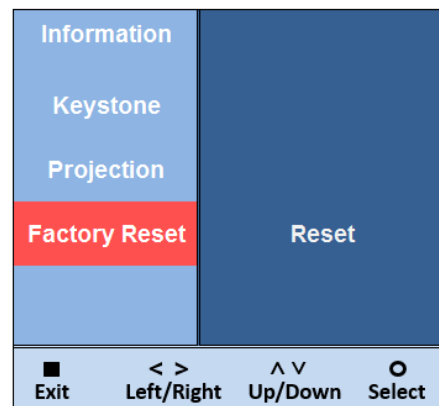

## Chapter 6. Taking Care of Your HUD

### Cleaning the HUD

It is only necessary to gently wipe your HUD when dust or dirt accumulates. When cleaning the combiner, mirror and cover window, use an optical lens cloth and enough cleaning solution just to dampen the cloth.

**Warning:**

Your HUD should not be connected to any electrical outlet when cleaning.

Use only a damp, lint-free cloth. NEVER USE WATER. Using water, which could enter the case, may VOID your warranty.

Do not apply abrasive cleansers, solvents or cloths at any time.

### Specifications

Features		Spec.	Remarks
Optical engine	Resolution	WXGA	1280x480 WXGA Cropped HD
	Projection System	0.45" DLP	Reflective, Color sequential
	Aspect ratio	16 : 6	
	Light source	LED (R/G/B)	> 30,000 hrs
	Contrast	1000:1	
	Brightness	> 10,000nit	Typical
I/O Terminal	HDMI	HDMI	HDMI Ver1.3a
	Power input	DC 12V~28V	AC adapter(12V, 3A)
Key	Function	8EA	Up, Down, Left, Right, Select, Menu, Power, Day/Night
Wi-Fi Mirroring	iOS	iOS	Direct Mode, AP Mode (2.4/5 GHz)
	Android	Android	
User control		Function Key	
Power consumption		< 20 W	Normal brightness
Cooling		Fan 1 EA	
Dimensions		7.8in x 12.8in x 4.7in	19.9Cm x 32.45Cm x 12.01Cm
Weight (grams)		750g	
Operating Temperature		0℃ ~ 35℃	

## **Regulatory Compliance**

This equipment has been tested and found to comply with the limits for a Class B digital device pursuant to Part 15 of the FCC Rules. These limits are designed to provide reasonable protection against harmful interference when the equipment is operated in a commercial environment.

This equipment generates, uses, and can radiate radio frequency energy and, if not installed and used in accordance with the instruction manual, may cause harmful interference to radio communications. Operation of this equipment in a residential area is likely to cause harmful interference, in which case, the user will be required to correct the interference at his/her own expense.

Changes or modifications not expressly approved by the parties responsible for compliance could void the user's authority to operate the equipment.

## **Disposal and Recycling**

This HUD may have components that contain hazardous waste products that require proper disposal. Be responsible and recycle or dispose accordingly. Consult your local, state or federal laws or for more information, the Electronic Industries Alliance at [www.eiae.org](http://www.eiae.org).

## Chapter 7 - Warranty Statement

1. Epic Optix, INC. warrants hardware products against defects in materials and workmanship for a period of one (1) year from date of purchase ("Warranty Period"). The customer is responsible for keeping all original proof of purchase documents during this time.
2. Epic's Limited Warranty covers only those defects which arise as a result of normal use of the product, and does not apply to:
  - a. Improper or inadequate maintenance or modification
  - b. Software, interfacing, media, parts, and supplies not provided or supported by Epic
  - c. Other user incurred damage resulting from misuse or neglect
3. If Epic receives, during the applicable Warranty Period, notice of a defect in any hardware product which is covered by Epic's warranty, Epic will either repair the product using new or refurbished replacement parts, or replace the defective product with new or like-new product of the same model with the same functionality as the original unit. If Epic is unable to repair or replace the defective product, the customer will be offered a comparable model, if available. When a product is exchanged, any replacement item becomes the property of the customer and the replaced item becomes Epic's property.
4. Epic shall have no obligation to replace or refund a defective product until the customer returns the defective product to Epic.
5. Epic is not responsible for:
  - a. any data stored on the returned products. Customers should backup his/her data prior to shipping the unit back to VM. Hard drives and devices which include a hard disk or other memory storage system will be reformatted during the repair process (even if the repair is not related to the hard drive itself) and will not include the customer's data when it is returned.
  - b. protecting the confidentiality of any data on a product sent in for repair.
6. Epic's limited warranty is only valid in the country of purchase.
7. To the extent allowed by local law, neither Epic nor its third party suppliers make any other warranty or condition of any kind, whether expressed or implied, with respect to the Epic products, and specifically disclaim the implied warranties of conditions of merchantability, satisfactory quality, and fitness for a particular purpose.
8. This Warranty Statement gives the customer specific legal rights. The customer may also have other rights that vary from state to state in the United States. To the extent that this Warranty Statement is inconsistent with such local law, this Warranty Statement shall be deemed modified to be consistent with such local law. Under such local law, certain disclaimers and limitations of this Warranty Statement may not apply to the customer. For example, some states in the United States may: preclude the disclaimers and limitations in this Warranty Statement from limiting the statutory rights of a consumer; restrict the ability of a manufacturer to enforce such disclaimers or limitations; or grant the customer additional warranty rights, specify the duration of implied warranties which the manufacturer cannot disclaim, or not allow limitations on the duration of implied warranties.



## Warning:

This device complies with Part 15 of the FCC Rules. Operation is subject to the following two conditions: (1) this device may not cause harmful interference, and (2) this device must accept any interference received, including interference that may cause undesired operation.

changes or modifications not expressly approved by the party responsible for compliance could void the user's authority to operate the equipment.

NOTE: This equipment has been tested and found to comply with the limits for a Class B digital device, pursuant to Part 15 of the FCC Rules. These limits are designed to provide reasonable protection against harmful interference in a residential installation. This equipment generates, uses and can radiate radio frequency energy and, if not installed and used in accordance with the instructions, may cause harmful interference to radio communications. However, there is no guarantee that interference will not occur in a particular installation. If this equipment does cause harmful interference to radio or television reception, which can be determined by turning the equipment off and on, the user is encouraged to try to correct the interference by one or more of the following measures:

- Reorient or relocate the receiving antenna.
- Increase the separation between the equipment and receiver.
- Connect the equipment into an outlet on a circuit different from that to which the receiver is connected.
- Consult the dealer or an experienced radio/TV technician for help.

NOTE: This device and its antenna(s) must not be co-located or operation in conjunction with any other antenna or transmitter

## RF Exposure Statement

To maintain compliance with FCC's RF Exposure guidelines, This equipment should be installed and operated with minimum distance of 20cm the radiator your body. This device and its antenna(s) must not be co-located or operation in conjunction with any other antenna or transmitter