

4. Switch on the host and place it back to start from the charging stand.

5. Press the start/stop (▶) button on the top of the vacuum cleaner or on the remote control to start cleaning. The indicator of the mode will be shown on the screen.



Intensive Cleaning

The robotic vacuum cleaner will take the current position as the center to clean intensively the space around in 1 square meter.

1. Turn on the power switch
2. Press the mode button "M" on the vacuum cleaner or on the remote control to shift to the mode for intensive cleaning.
3. Press the start/stop (▶) button on the top of the vacuum cleaner or on the remote control to start cleaning. The indicator of the mode will be showed on the screen.

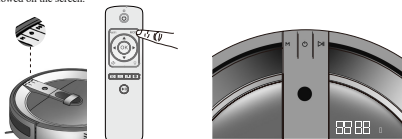

After the cleaning is finished under intensive cleaning mode, the vacuum cleaner will stop right there. At a place with too many obstacles, the cleaner may not do the cleaning normally.

Manual Cleaning

The robotic vacuum cleaner can be operated manually by using the remote control.

1. Press the start/stop (▶) button when the cleaning is working, the cleaner will be stopped.

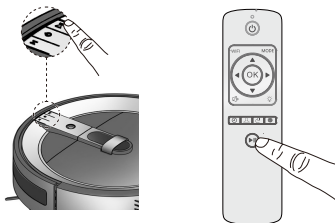

2. Using the direction button of the remote control enables you to operate the robotic vacuum cleaner freely.

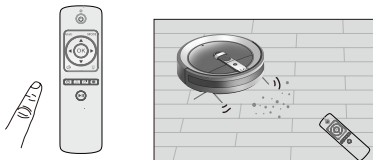

 Manual operation is not possible during charging. It can only be operated without the connection of the charging stand.

Time/Schedule Settings

The robotic vacuum cleaner has the scheduled cleaning function. You can use the remote control to schedule it to clean up at any time within 24 hours a day and 7 days a week.

Before making the schedule, please set the system clock first.

Only when the robotic vacuum cleaner is charging on the charger stand, it can be set.

If the cleaner is charging at the schedule time settled, it cannot follow the instruction until fully charged.

Set current time

a. Set current weekday

Press 'Time' button on the remote control. The time figure will change to "A: 1", keeps flashing.

Press '▲▼' button to shift from 1 to 7, and the figure 1 to 7 represents Monday to Sunday.

Press 'OK' to save the current weekday setting and enter the current hour and minute setting.

b. Set current hour and minute. Time is set according to 24-hour system.

1) To set the hour first. Press '▲' button, the number is increasing, while press '▼' button, the number is decreasing.

Press 'OK' to save the current hour setting and move on to the minute setting.

Press '◀▶' to shift between hour and minute setting.

2) After the minute setting, press 'OK' to save the whole-time setting. The figures stop flashing.

Schedule Cleaning Settings

a. Schedule weekday settings:

Press 'Schedule' button on the remote control. The time figure will change to "H1:OF", keeps flashing.

Press '▲▼' button to shift from H1 to H7, and the figure H1 to H7 represents Monday to Sunday.

Press 'OK' to save the current weekday setting.

Press '▲▼' button to shift from "OF" to "ON", and "OF" represents OFF, while "ON" represents ON.

Press 'OK' to make sure the setting status is ON/OFF.

b. Schedule cleaning hour and minute settings. Time is set according to 24-hour system.

1) To set the hour first. Press '▲' button, the number is increasing, while press '▼' button, the number is decreasing.

Press 'OK' to save the current hour setting and move on to the minute setting.

Press '◀▶' to shift between hour and minute setting.

2) After the minute setting, press 'OK' to save the whole-time setting. The figures on the screen will change to be back to the weekday setting menu.

c. Finish settings

Press 'Schedule' button on the remote control again to exit the setting menu. The indicator of the mode will be shown on the screen.

d. Press 'Time' and 'Schedule' at the same time to check the schedule and use to check different scheduled time;

e. Cancel the appointment

Under the mode of schedule, have a long press on 'Schedule' for about 3 seconds to cancel the schedule.

Suction Power Adjustment

The suction power can be adjusted by remote control according to different cleaning requirements.

Press "turbo" button on the remote control to adjust the suction power.

The battery will reduce the use of time, the working noise will increase under the turbo powerful suction mode.

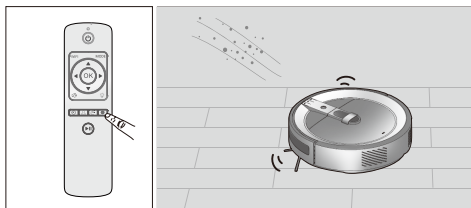

Maintenance

Cleaning Dust Bin

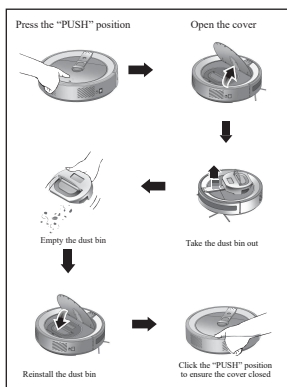

You can empty the dust bin after each cleaning. Or operate according to the dust-full indicator. The cleaning effect will be influenced, if the dust bin is not cleaned in time.

Change the filter in the dust bin

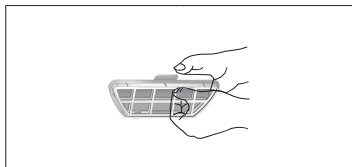

When you see the filter cracks or there are some holes on the filter, please change it immediately.

In normal environment, the use life for the filter is two months. The actual use life depends on the environment. If the filter is not changed in time, the suction power will be weakened. The filter is not washable.

Clean the Suction Inlet

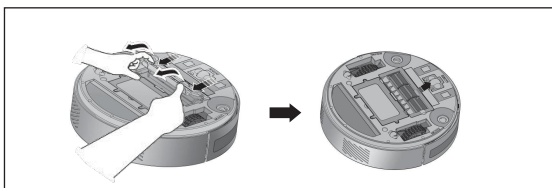

Open the cover

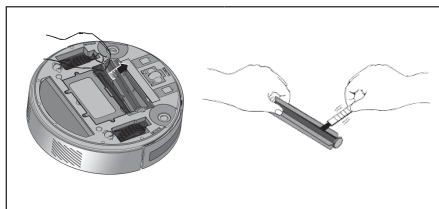

Remove the main brush.

Clean the Sensors and wheels

Clean the sensors

- 1 Use the attached cleaning brush or cotton stick to remove or clean the three anti-falling sensors shown in the picture.
- 2 If they are very dirty, please use clean and wet cotton stick to clean them.
- 3 Please do not use water to clean the floor directly or use benzene or alcohol to clean.

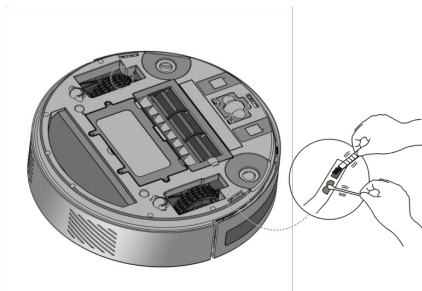

Clean the front and side wheels

1. Use hands to turn the side wheels around while cleaning them with the cleaning brush or cotton cloth.
2. Use cleaning brush to clean the front wheel.
3. Please remove the dirt which will wind the wheels such as hair.

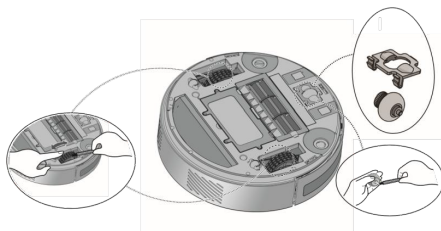

Clean the Suction Inlet

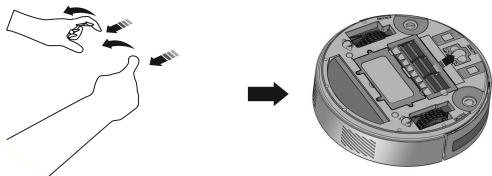

Open the cover of the suction inlet

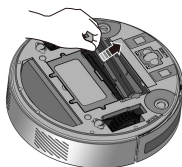

Disassemble the main brush

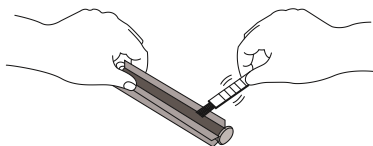

Use cleaning brush to clean the main brush

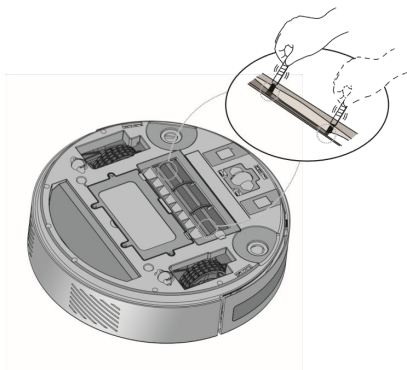

1. Use the cleaning brush or cotton stick to clean the two dust sensors.
2. If the dust sensors are very dirty, please use wet cotton stick to clean them but do not use water and benzene or alcohol to clean.

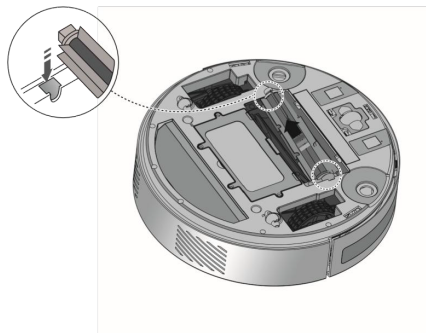

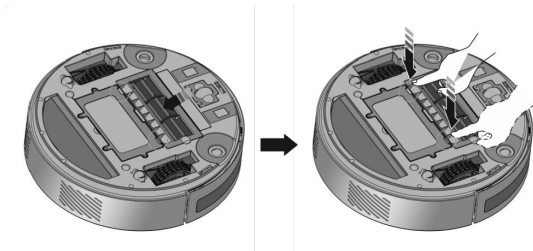

Re-install the main brush and suction inlet cover, and confirm that they are in the correct place.

Battery Management

After long time using, the life time of the battery will shorten.

Battery life

The battery life in normal environment is 12 months.

To have the best status of the batteries, please make it fully charged before using it each time.

The battery life may vary according to different environments.

If the vacuum cleaner is not used for a long time, please turn off the power switch.

Please often clean the suction inlet, dust bin, main brush, side brushes and wheels.

When the dust bin is full, the internal motor of the vacuum cleaner will run over load, which will cause the battery life shortened.

When charging and keeping the cleaner, please avoid direct sun ray exposure, fire and smoke.

Using time for the battery

When it is the first time to use the cleaner, please get it fully charged before using.

The charging needs 4 hours.

After fully charged, the vacuum cleaner can be used for 90 minutes normally.

Under the turbo powerful suction mode, the using time may be shortened to less than 1 hour.

When the surrounding is too complicated or it is too dusty, the using time may be shortened.

When keeping the vacuum cleaner without charging, the operation time will be shortened or the battery will be consumed.

Change batteries

When the operation time is shortened greatly, please change the batteries.

Please use the batteries with the same specification as requirements.

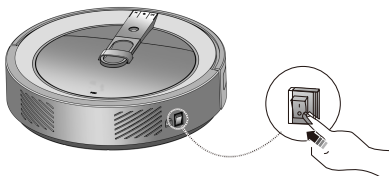

Please make sure that the power is switched off before changing the battery.

The changed or the removed batteries changed shall be disposed safely according to the local disposal regulations.

Please contact the service center for buying additional batteries.

If the battery cannot be changed by yourself, please contact the service center.

Turn off the power switch on the side of the vacuum cleaner.

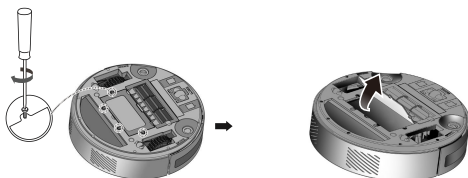

Remove the screws (4) from the battery cover and remove the battery cover.

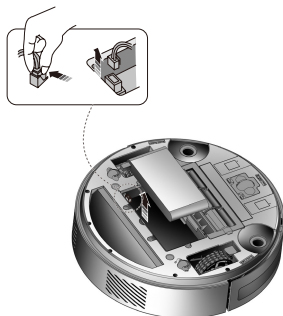

Disassemble the power line connection of the battery and remove the battery.

Voice Prompt Instruction

The Voice Prompt Instruction is a list of basic audio instructions and they may vary according to the usage convenience and cleaner types.

Function of Voice Instruction	
Content of the instructions	Working status
Now navigation cleaning starts	Start navigation cleaning mode(the default mode is with high climbing)
Now intensive cleaning starts	Start intensive cleaning mode
Now wet mopping starts	Start wet cleaning mode(the fault mode is with low climbing)
Now schedule cleaning starts	Start schedule cleaning mode
Now manual cleaning starts	Start manual cleaning mode
Now cleaning is paused	During cleaning, when the button Start/ Stop is pressed
Cleaning is completed	Cleaning operation is finished
Now start charging	Start charging
Start the Turbo mode	The suction is adjusted to the maximum
Now enter the schedule mode	Start schedule settings
The schedule is saved successfully	Complete schedule settings
The schedule is cancelled	Complete cancellation of the schedule settings
Now return to the charging stand	Start the function of recharging

ErrorCodes

Common Faults and Treatment Methods

Notes: The robot will stop working or cannot be started under the following circumstances and the device gives warning sounds; Follow the process below to remove the faults with the error codes, reasons, identification and treatment methods.

Error Code	Error reason	Error identification	Handling ways
E001	Anti-dropping sensor does not work	The sensor is blocked or the host is blocked at the stairs	Check and clean the antifailling sensors or take out the host
E002	Left or right wheel faults	There is line winding from the left or right wheels	Remove the things from the left and right wheels and restart the cleaning mode
E003	Left or right side brush faults	There is line winding from the left or right side brush	Remove the things from the left and right side brush and restart the cleaning mode
E004	Left or right wheels do not touch the floor	The left or the right wheel do not touch the floor.	Put the host on the smooth floor and restart the cleaning mode
E005	Middle brush faults	There may be line winding from the middle brush	Remove the things from middle brush and restart the cleaning mode
E006	The battery is low	The host does not work normally	Please put the host manually on the charging stand to get it charged
E007	The host cannot be charged.	The power switch of the host is not on or the battery is not connected well	Turn on the power or connect the battery properly
E008	Anti-collision sensors do not work.	Anti-collision sensors are blocked.	Clean the shell of the anticollision sensors in front of the vacuum cleaner

Notes: If the faults are not cleared after handling according to the above ways, please contact the after-sales departments of the company.

Specification

Type	RMRV10
Size	Diameter 348mm x Height 96mm
Battery	Lithium battery 14.4V 2600mAh
Capacity of the dust bin	700ml
Capacity of the water tank	120ML

Charging Stand

Size	Length 270mm x Height 146mm x Width 99 mm
Input	24 V DC
Output	24 V DC
Signal transmission distance (IR)	3m

Remote Control

Size	Length 139mm x Height 22mm x Width 40mm
Battery	AAAx2
Signal transmission distance (IR)	3m

FCC Caution.

§ 15.19 Labelling requirements.

This device complies with part 15 of the FCC Rules. Operation is subject to the following two conditions: (1) This device may not cause harmful interference, and (2) this device must accept any interference received, including interference that may cause undesired operation.

§ 15.21 Information to user.

Any Changes or modifications not expressly approved by the party responsible for compliance could void the user's authority to operate the equipment.

§ 15.105 Information to the user.

Note: This equipment has been tested and found to comply with the limits for a Class B digital device, pursuant to part 15 of the FCC Rules. These limits are designed to provide reasonable protection against harmful interference in a residential installation. This equipment generates uses and can radiate radio frequency energy and, if not installed and used in accordance with the instructions, may cause harmful interference to radio communications. However, there is no guarantee that interference will not occur in a particular installation. If this equipment does cause harmful interference to radio or television reception, which can be determined by turning the equipment off and on, the user is encouraged to try to correct the interference by one or more of the following measures:

- Reorient or relocate the receiving antenna.
- Increase the separation between the equipment and receiver.
- Connect the equipment into an outlet on a circuit different from that to which the receiver is connected.
- Consult the dealer or an experienced radio/TV technician for help.

*RF warning for Mobile device:

This equipment complies with FCC radiation exposure limits set forth for an uncontrolled environment. This equipment should be installed and operated with minimum distance 20cm between the radiator & your body.