



ELECTRON WHEEL™

User Manual & Assembly Instructions

Last Update: 10/23/17
SKU: WHE7002 / WHE2602



ENGLISH

700c & 26"

CONTENTS

1. INTRODUCTION
2. SAFETY INFORMATION
3. INTENDED USE
4. COMPONENTS OF THE ELECTRON WHEEL SYSTEM
5. ASSEMBLING AND QUICK START GUIDE
 - a. Using Quick Releases
6. APP INSTRUCTIONS
7. ASSISTANCE MODES
 - a. Range
8. RIDING AN E BIKE
 - a. Safety Check Before Ride
 - b. Legal Regulations
9. NOTES ON ELECTRICAL AND ELECTRONIC COMPONENTS
 - a. Charger and Pedal Sensor Charger
 - b. Battery
 - c. Charging Procedures
10. MAINTENANCE
 - a. Storing
 - b. Transportation
11. WEAR AND WARRANTY
12. DISPOSAL
13. RETURN & WARRANTY POLICY
14. SPECIFICATIONS

1. INTRODUCTION

Dear Customer,

Congratulations on purchasing your new Electron Wheel™! We're excited to welcome you to our growing community of riders getting around smarter, faster, and in style with Electron.

Please take the necessary time to read through this instruction manual and familiarize yourself with your new wheel. Your safety and enjoyment of the Electron Wheel™ is our top priority, so please be sure to get in touch if you have any further questions or comments.

We can be reached at *support@electronwheel.com*.

Important information can be found at *<https://electronwheel.com/>*.

It is assumed that users of this product have a basic and sufficient knowledge of how to use bicycles.

Everyone that uses, repairs or services, cleans, or disposes of this product has to understand and take note of the content and purpose of this operating manual. If you have any further questions or have not understood certain points, you should contact a specialist bicycle retailer for your own safety.

All information contained in this operating manual relates to the design, technology as well as care and maintenance of your product. Please take note of this information. Much of it is relevant to safety. Failure to consider this information can cause accidents, falls and damage to property.

As modern bicycle and E bike technology is highly complex, we have chosen to only describe the most important points.

In addition, this operating manual only applies to the product with which it was supplied.

Please carefully read all warnings and notes in this operating manual before using the product. While using the Electron Wheel™, your traditional bike is classified as an E bike. We recommend keeping the manual close to your bike so that it is always at hand. Before operating an E bike for the first time, it is highly recommended that you carefully read through the enclosed instructions about the electric motor and components.

If you lend your E bike to a third party, please give them this operating manual with the bike.

2. SAFETY INFORMATION

This operating manual contains different types of warnings;

- One providing important information about your new wheel and how to use it.
- A second referring to possible damage to property and the environment.
- And a third type warning against falls and serious damage, including physical injury.

These warnings ask you to comply with the correct torque settings in order to prevent components from coming loose or breaking. If you see a warning symbol, there is always a risk that the danger described can occur!

The text which the warning covers always has a grey background.

The warnings break down as follows:

NOTICE

Information: This symbol provides information about how to use the product or highlights specific parts of the operating manual that are particularly important.

⚠ WARNING

Warning: This symbol is aimed at warning you against improper use that could result in damage to property or the environment.

⚠ DANGER

Danger: This symbol indicates possible dangers to your health and life that could arise if specific actions are not taken or corresponding regulations adhered too.

DANGER

Modern bicycle and E Bike technology is high tech. Working on bicycle and E Bike parts therefore requires special knowledge, experience and specialist tools. Please do not attempt to work on the bike yourself. Give your bike to a specialist retailer for repair, servicing and maintenance. Contact us directly for repair, servicing, and maintenance of your Electron Wheel™.

Check that all quick releases are safe and secure every time you ride after your bike was unused, even for a short period of time! Regularly check that all bolts and components are secure. **Never ride with your hands off the handlebars.**

DANGER

Electron Wheel™ recommends use on bicycles only that meet all legally applicable standards including Consumer Product Safety Commission Standards (found at 16 CFR Part 1512) and/or ISO 4210:2014.

Before installing the Electron Wheel™ system, check to see whether your bicycle is suitable for it. In particular, there must be sufficient stability provided for. Consult your bicycle specialist for advice when in doubt.

NOTICE

ENSURE CORRECT INSTALLATION

Follow all steps listed in this manual and in the assembly video provided on the mobile app and online. Failure to follow these instructions or skipping any steps could result in operational failure, wheel damage, voiding of the warranty, or rider injury.

DANGER

BICYCLE FORK

Installing and using the Electron Wheel™ on a bicycle fork that has been previously damaged may result in failure, resulting in injury or death. If you believe that your bike fork may have been previously damaged from an accident or misuse, consult your local bike shop before installing the Electron Wheel™.

The Electron Wheel™ can only be used with metal frames. Bamboo, carbon fiber and other frame materials have not been tested for use with the Electron Wheel™.

DANGER

CHECK YOUR BRAKES

It is critical that the rider maintains front and rear brakes to optimal condition. Failure to do so, or improper installation, can lead to serious injury or death.

It is recommended that the rider tests all brake mechanisms before turning on the Electron Wheel™. Ensure that all cables have been reconnected and brake pads contact the rim.

⚠ DANGER

CHILDREN AND E BIKES

No person under the age of 16 should ride an E Bike. Should you allow a child to ride an E Bike, find out whether the child is of the required age and has the required permit for the location you intend to ride.

Note for parents and legal guardians:

As your child's legal guardian, you are responsible for your child's actions and safety. This includes responsibility for the technical condition of your child's bike and adjusting it to fit your child's body size.

Please inform yourself of what you and your child must pay attention to.

Before riding any bike, you should ensure that your child has mastered skills required to use the bike safely. The child should know how to use the bike properly and responsibly in the environment in which it will be used and ALWAYS wear appropriate safety equipment.

NOTICE

In no event shall Electron Wheel™, its subsidiaries or affiliates, be liable for any direct, indirect, punitive, incidental, special consequential damages, to property or life, whatsoever arising out of or connected with the use or misuse of our products. Riding an electric bike is an activity that may expose the user to the risk of personal injury or death. Electron Wheel™ is not a toy and shall only be used by persons 16 years of age or older.

It is the riders responsibility to follow all relevant bicycle and electric bicycle laws in their local jurisdiction.

Always wear a helmet and ensure proper visibility!

3. INTENDED USE

The Electron Wheel™ is designed and optimized for on-road conditions. The intended use is on paved roads and bike paths only.

Using the bike and Electron Wheel™ as intended also means adhering to the operating, maintenance and upkeep conditions described in this manual.

Before getting started, carefully read these operating instructions and the general bicycle manual. Electron Wheel™ accepts no liability for damages resulting from non-compliance with these instructions. Your bicycle, which is now an E Bike, must only be used in accordance with its intended use. You can find this in the bicycle`s user manual.

4. COMPONENTS



Electron Wheel™

1x Electron Wheel™



Wheel Charger

1x Standard Charger



Pedal Sensor

1x Pedal Sensor
1x Rubber Mounting Unit



Pedal Sensor Charger

1x Pedal Sensor Charger



Rubber Adapter

1x Crank Rubber Adapter
(For use with round cranks)

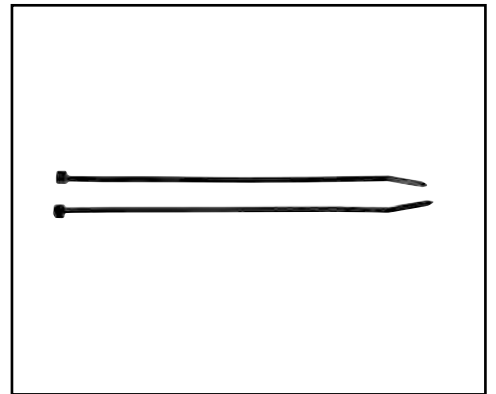

Cable Tie

2x Nylon Cable Tie
(To secure rubber adapter)
1x Washer

NOTICE

INSTALLATION VIDEO

For quick and easy installation instructions, download the Electron Wheel™ app from the App or Google Play Store. Navigate to the settings tab and watch our installation video tutorial. You can also access the video at the bottom of the page on www.electronwheel.com/technical-specs.

5. ASSEMBLY & QUICK START GUIDE

⚠ WARNING

We strongly recommend the Electron Wheel™ be installed professionally. Installation of the Electron Wheel™ can require special tools and mechanical abilities. Every installation can be different. If you are not absolutely sure you possess these abilities, you should bring your bike to a professional bicycle shop.

1. **Loosen your front brakes**

Carefully release your rim brakes. This process may differ from bicycle to bicycle. Refer to your bicycle's user manual. If you are unsure on the safe operation of your brakes, please consult with your local bike shop or professional.



2. **Remove existing front wheel**

Carefully remove your existing front wheel. For most riders this will be possible via a quick release. Loosen the lever 180 degrees, and twist counter clockwise until loose. A wrench may be required for bikes without a quick release.

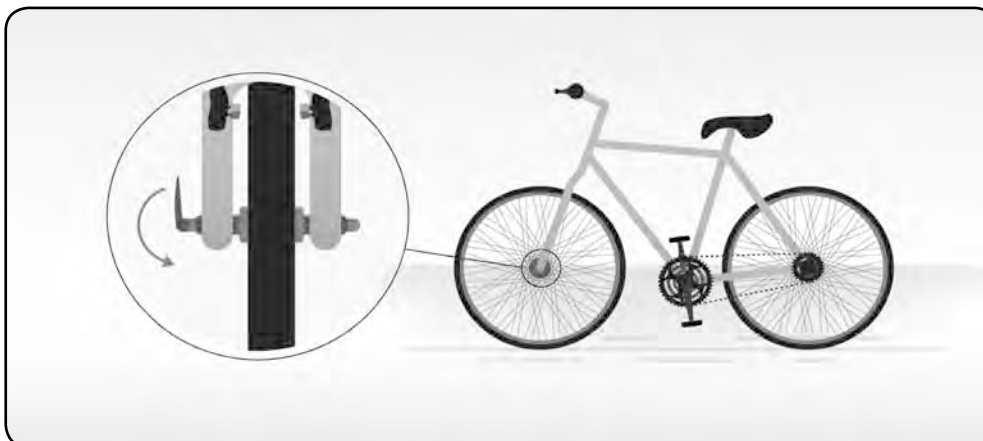

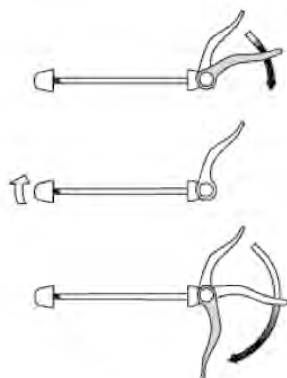

Loosening adjusting nuts

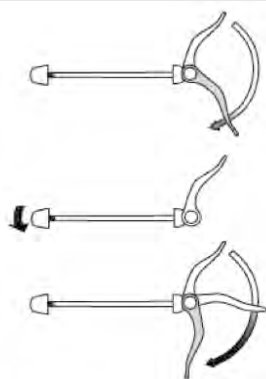

Tightening adjusting nuts

a. Using quick releases

Quick releases are systems installed on the bike in place of bolted connections. They consist of two parts: the clamping lever, which provides the necessary clamping force, and the locking nut, which allows you to regulate the clamping force. You can change the setup of your quick release when the clamping lever is open.

A good gauge for measuring if the wheel is safely clamped is if you can only close the clamping lever with the balls of your hands when the resistance increases after closing the lever about half way.

⚠ DANGER

QUICK RELEASE

Check that all quick releases are properly fastened before every ride.

- Make sure that all quick releases are properly in place, even if the bike was only left unattended for a short period.
- When it is closed, the quick release lever should be flat against the frame or fork!
- When it is closed, the end of the quick release lever should always point backwards. This ensures that it cannot be opened by contact during riding.

If you are unsure on the safe operation of your quick release, please consult with your local bike shop or professional bike mechanic.

3. a. **Loosen Electron's quick release**

This is located on the same side as the wheel's charger port. Open the lever 180 degrees and twist counter clockwise. Be careful not to loosen too much.

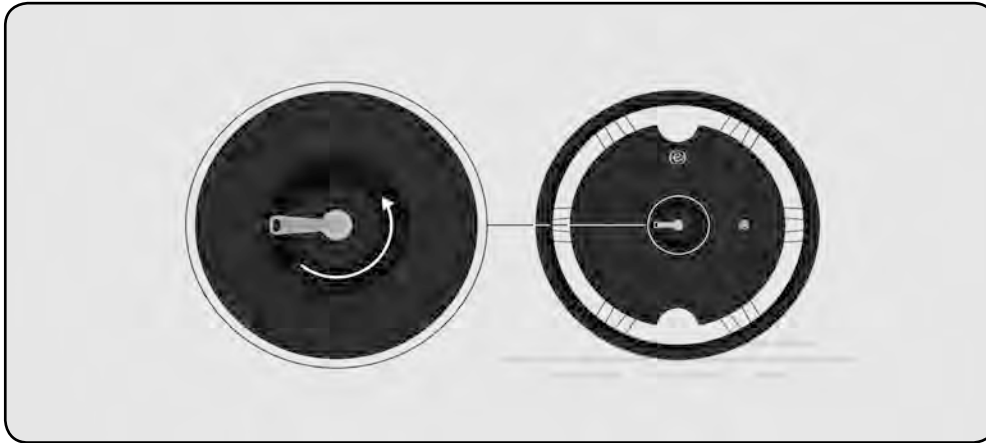

b. **Locate & position T-lever**

On the opposite side of your wheel, locate the T-lever. Ensure that the torque lever is on the same side as your bike's chain, and is pointing towards the ground.



4. Lower fork onto Electron Wheel

With the T-lever pointing downwards, carefully lower the bike's front dropouts into place on your Electron Wheel's axle.



5. Touch T-Lever to fork

Rotate the t-lever so that it is in full contact with the front fork.

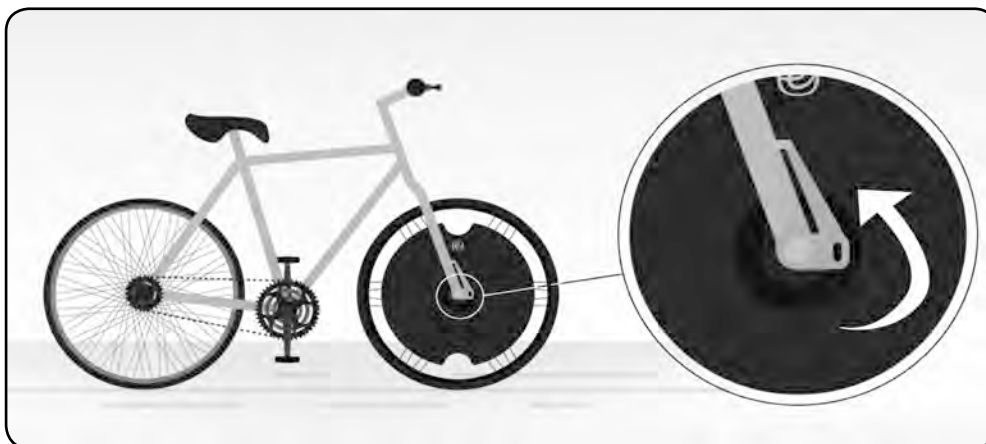

⚠ DANGER

TORQUE LEVER

The torque arm and T-Lever are important parts of the Electron Wheel™. Wrong or improper installation of the torque arm or the T-Lever can result in a fall, injury or death for the rider or damage to your bike or the Electron Wheel. Wrong or improper torque arm and T-Lever installation may damage your bike's frame.

6. Tighten quick release

Once wheel and T-lever are securely in place, tighten the wheel's quick release, and firmly close the lever 180 degrees using your full grip strength.

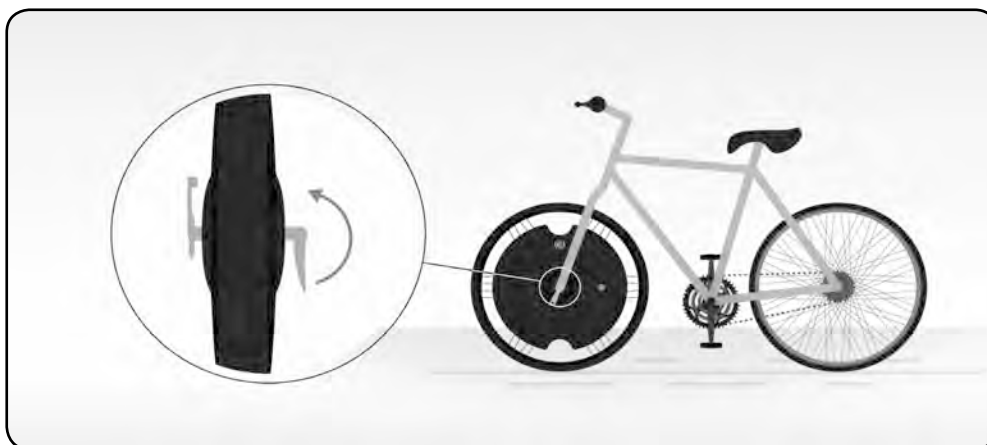

7. Re-connect front brakes

Carefully re-connect your front brakes. If you are unsure on the safe operation of your brakes, please consult with your local bike shop or professional.

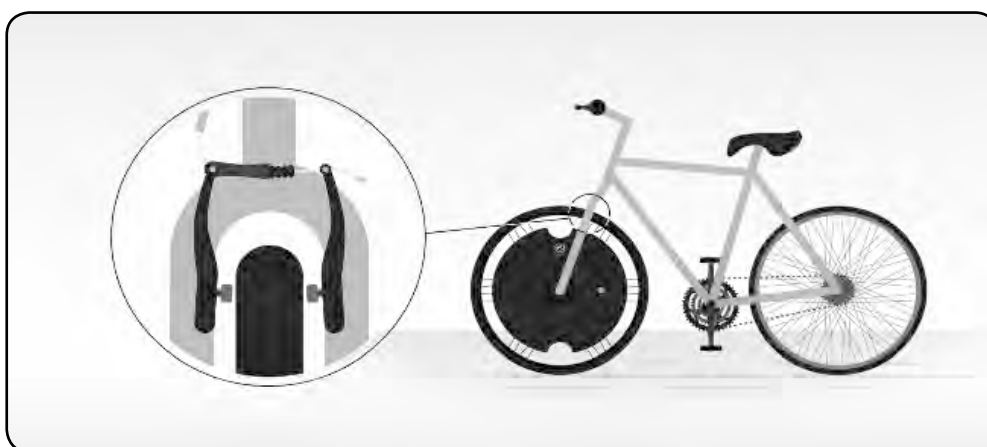

⚠ DANGER

TEST BRAKES

Make sure that the front brake works safely. The brake pads must meet the rim. If you are unsure on the safe operation of your brakes, please consult with your local bike shop or professional bike mechanic.

8. Attach pedal sensor

Attach the pedal sensor to the crank opposite your bike's chain. The sensor should be placed as close to the base of the crank as possible (i.e. as far away from the pedal as possible). Be sure both velcro straps are tight. The recommended orientation is so that the sensor faces inward. Rotate the crank. If there are obstructions, you can place the device on the outside of the crank.

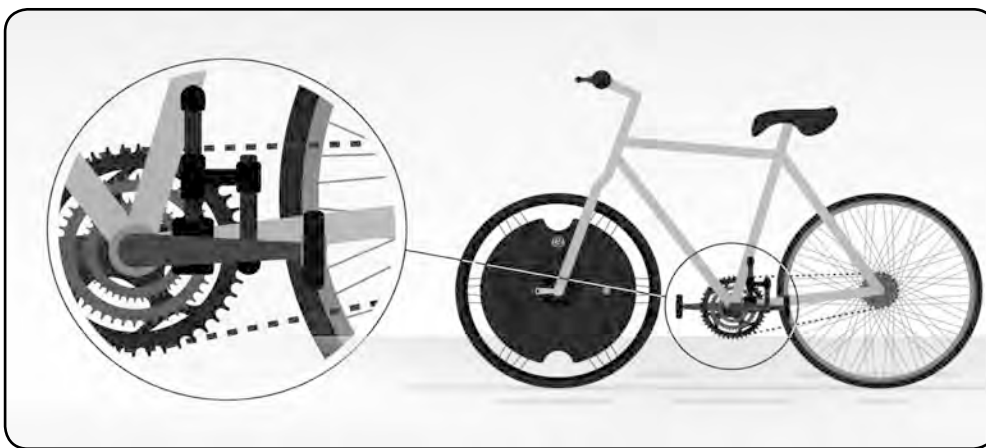

NOTICE

PEDAL SENSOR ORIENTATION

You'll need to indicate which orientation you've chosen on the Electron app (see step 12).

Recommended orientation is so that the sensor faces inwards as close to the crank base as possible



If there are obstructions, the sensor can be placed facing outwards (opposite to picture shown)

The pedal sensor must be turned on and functioning in order to use your Electron Wheel™. If the pedal sensor is installed incorrectly, your wheel could malfunction, powering on and off at unexpected times, leading to injury. It is critical you take care in ensuring proper installation.

Below is a guide to your pedal sensor's LED indicator light.

LED INDICATOR GUIDE

GREEN: 1 minute constant, then blinking	Battery full
GREEN: 3 second constant, then blinking	Battery low
GREEN: 3 second constant, then off	Battery empty
YELLOW	Battery charging
RED: Blinking every 10 seconds	Battery needs charging
RED: Blinking every 5 seconds	Battery low warning
RED: Blinking every 1 second	Battery low urgent

9. Download the Electron App

For iOS: Open the *App Store*, search for “Electron Wheel”, press the “Get” to download.

For Android: Open the *Google Play Store*, search for “Electron Wheel”, press “Install” to download.

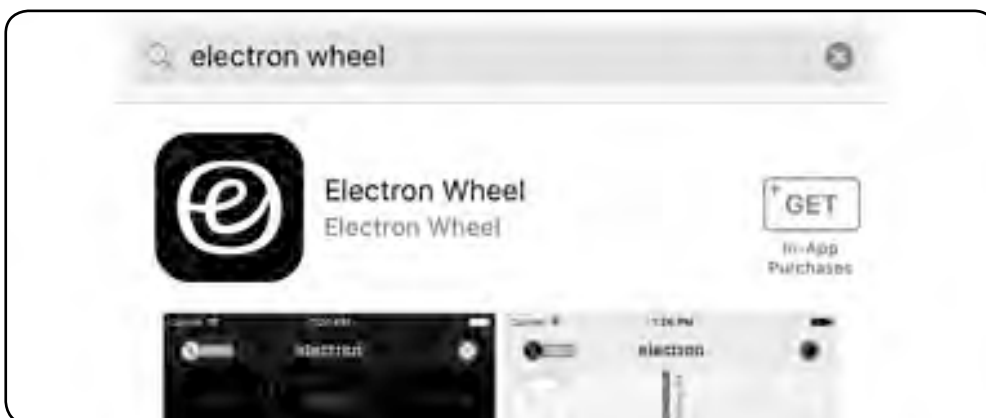

10. Power the wheel & sensor on

Be sure the wheel and pedal sensor are fully charged, then take your bike outside. Power the wheel and pedal sensor on.



11. Connect

Ensure bluetooth is enabled on your mobile device. Open the Electron app and navigate to the settings tab (gear wheel on lower menu bar). Push “connect” to sync your phone to your wheel.

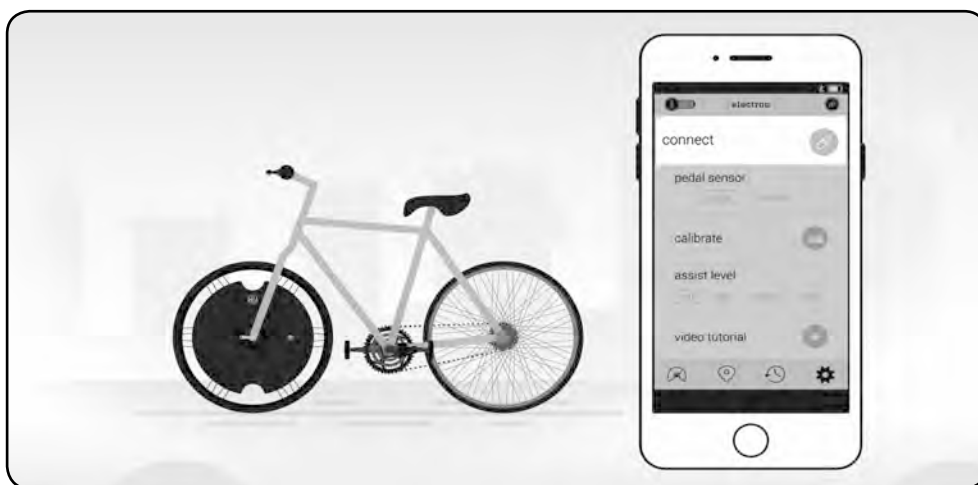

12. Select pedal sensor orientation

Indicate whether the pedal sensor is located on the inside or outside of your pedal crank.

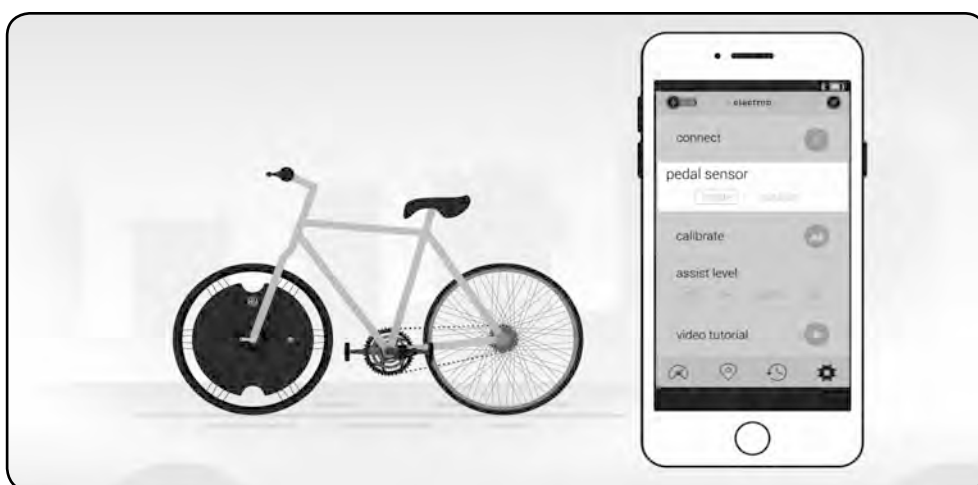

12. Calibrate

Push “calibrate” and follow the on-screen prompts. Ride the bike approximately 200 yards, and return to your starting position. It’s important to maintain a constant speed and to continue pedaling throughout the 200 yards.

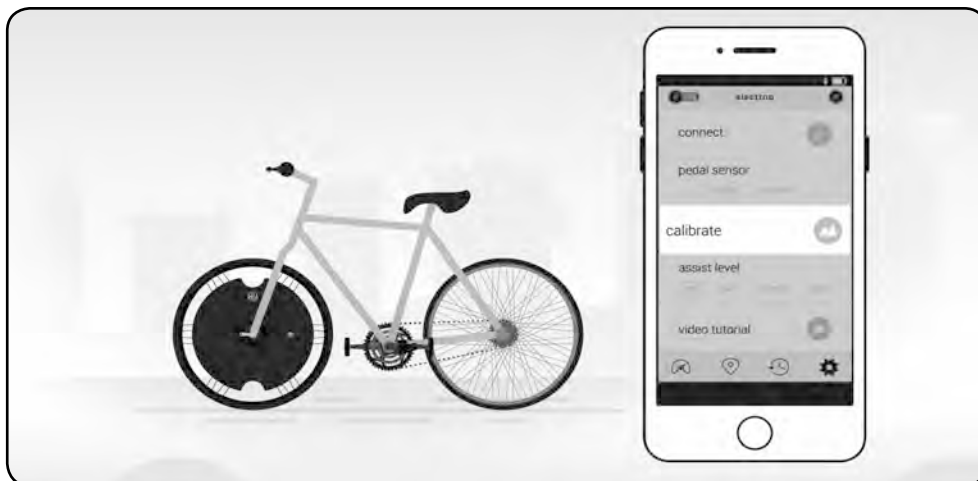

If you’re on a decline, lightly compress the brake while continuing to pedal. Once you’ve returned to your starting position, calibration is complete and you’re ready to enjoy.

NOTICE

CALIBRATION FREQUENCY

Calibration is only required when installing the wheel for the first time on a bike.

6. APP INSTRUCTIONS

The Electron Wheel™ app is designed to enhance the functionality and ease of use of your new Electron Wheel™. We've learned some users love this connectivity, while there are other users who will prefer to ride without it. That's why we've engineered a system that lets you choose whether or not to use its functionality. The App is required for initial calibration, after which you can choose to track and record your rides, view ride history, monitor your speed, distance, and time ridden, as well as toggle between power assist levels.

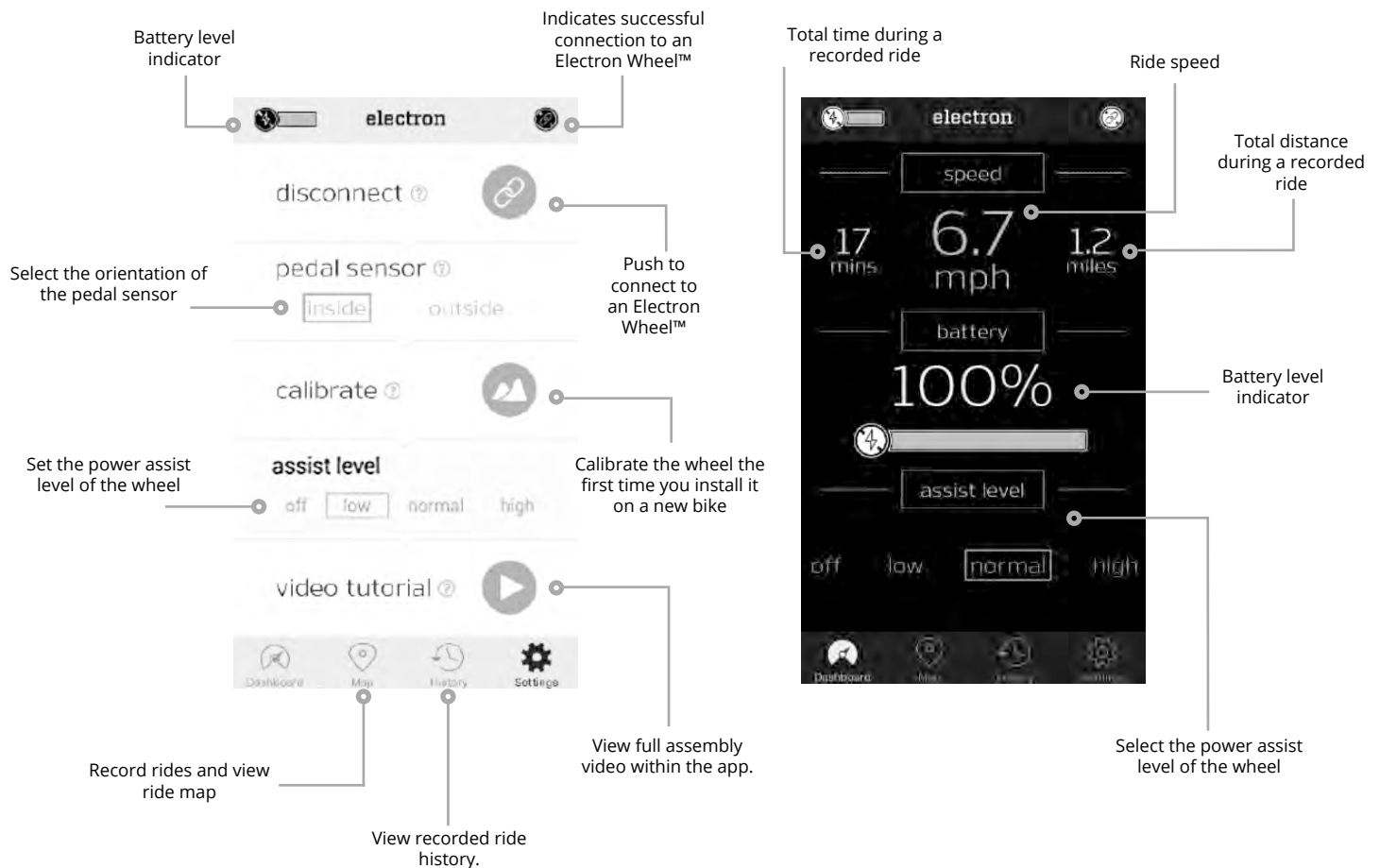

7. ASSISTANCE MODES

Your Electron Wheel™ delivers four different assistance modes.

Power Mode	Description
Off	The wheel will not provide any assist and will enter sleep mode
Low	Electron Wheel™ will assist lightly up inclines
Normal	Electron Wheel™ will assist up inclines, during normal pedaling, and during initial take off
High	Electron Wheel™ will assist at full power up inclines, during normal pedaling, and during initial take off

Start your first ride using LOW mode.

a. Range

The range of your Electron Wheel™ bike is up to 50 miles. The higher the assistance level, the more support the motor provides. High motor power is also associated with high power consumption. The lowest support level provides the least force but has the largest range.

NOTICE

RANGE & TEMPERATURE

Take note that the range of your battery is reduced at lower temperatures, like when you ride your E bike in winter. You can counteract this by storing the bike in a warm room and only taking your E Bike outdoors immediately before starting your ride.

8. RIDING AN E BIKE

a. Safety Check Before Ride

When you have finished the installation, and before riding, perform the following safety checks.

- Check front and rear brakes. They must be safely installed and working.
- Check tire pressure. Deflate or inflate if necessary.
- Check spoke tension.
- Check saddle, handlebar, shifters and brake levers for correct and safe installation.
- Check wheel fastening nuts and quick-releases for safe and correct closure.

DANGER

Practice operating and riding your E Bike in a quiet and safe place before you take to public roads!

On a closed flat track, turn the wheel on. Start your first ride using LOW mode.

Test that you can safely and gradually bring the bike to a stop even while pedaling.

The Electron Wheel™ uses a pedal sensor to turn the wheel's power on and off. If you stop pedaling, the wheel should cease providing power. In the rare event of a malfunction, it is the rider's responsibility to ensure their brakes are fully functioning to bring the bike to a complete stop.

DANGER

Take note that an E Bike is much faster than a bicycle without an electrical drive. Other traffic participants might therefore misjudge your movements.

DANGER

Note that if the road surface is slippery (e.g. due to rain, snow, sand), there is a risk that the front wheel of your E Bike may spin and slide.

NOTICE

Check the charging state of the battery before every ride using the Electron Wheel™ app. Only start off when the charging state is sufficient to support you during the entire planned trip. Always allow for some "reserve" to get home comfortably and safely.

b. FOLLOW LOCAL BICYCLE AND E BIKE USE & SAFETY LAWS

Legal regulations

Before riding your E Bike on public roads, it is your responsibility to inform yourself about all applicable regulations in your specific country and region.

These regulations will provide information on what additional equipment the bike must have to participate in public road traffic. This includes which light systems must be installed or carried with you and which brakes the bike must be equipped with.

You will also find an explanation of which age restrictions apply to bike and E bike riding. The participation of children in public road traffic is also addressed here. If there is an obligation to wear a helmet, it is stated here.

It is the rider's responsibility to follow all relevant bike and electric bicycle laws in their local jurisdiction.

The regulations governing the performance of an E Bike and the connected requirements relating to minimum age, driving license, registration and helmet regulations may differ between countries. The same applies for the obligation to use cycle paths. Please inform yourself about the applicable legislation.

Always wear a helmet and ensure proper visibility!

Please note that as a bike rider, you are particularly at risk on public roads. Ensure that you protect yourself and others with responsible and safe riding!

9. NOTES ON ELECTRONIC COMPONENTS

DANGER

Note that a sudden temperature change from cold to warm can cause condensation to form on the battery. Prevent this from happening by storing the bike in the same place you charge it. When charging the battery, only use the charger it came with or one we have permitted for use. Using any other charger increases the risk of fire.

- Avoid damaging cables and electrical components. If this happens, you should not ride the E Bike until it has been checked over by a specialist!

NOTICE

Only replace broken or worn parts with original replacement parts from the manufacturer or parts approved by your manufacturer. The manufacturer's warranty will be nullified if you install non-approved replacement parts.

DANGER

Do not leave children unattended around E Bikes and/or components. Ensure that children understand the dangers of using electrical devices. Any persons that owing to their physical, sensory, or mental limitations or lack of experience should not operate any electronic components, including batteries and chargers, due to risk of operating errors and injury.

a. Charger and Pedal Sensor Charger

- Only use chargers approved by the manufacturer.
- Only use the charger in dry rooms and do not cover it when it is turned on. This could lead to a short-circuit and a possible fire hazard. Pay attention that the charger is well ventilated during the charging procedure and that the ventilation openings on both sides are not clogged or contaminated.
- When cleaning the charger, always first unplug the device.
- Make note of the information and warnings on the charger before you begin to charge the battery.
- Always pull the mains plug out of the socket before cleaning the charger.
- The charger should be disconnected from the mains once the charging process has been completed.

b. Battery

The battery is designed only for use with the Electron Wheel™. Improper use or incorrect handling can cause fires or injuries. Electron Wheel™ assumes no guarantee or responsibility of any kind for damage resulting from improper use or treatment.

DANGER

- Never place or store several batteries/Electron Wheels™ on each other. Especially not while charging. A defective battery may not be charged or used.
- Do not open the battery. Danger of short-circuiting. Opening the battery voids any and all warranty.
- Protect the wheel against heat (e.g., also against continuous intense sunlight), fire and immersing into water. Danger of explosion.
- Do not drop or throw the wheel! Avoid all kinds of impact.
- Under abusive conditions, liquid may be ejected from the battery. Avoid contact. If contact accidentally occurs, flush with water. If liquid contacts eyes, additionally seek medical help. Liquid ejected from the battery may cause skin irritations or burns.
- Vapors can escape in case of damage and improper use of the battery.
Provide for fresh air and seek medical attention in case of complaints. The vapors can irritate the respiratory system.
- Magnetic fields around the wheel/battery may also influence medical equipment such as for example heart pacemakers. Always consult a doctor or medically qualified person on this subject if in doubt.

c. Charging procedures

1. Read the information on both chargers.
2. Connect the wheel charger to the wheel.
3. Connect the charger to the mains supply with matching current. A red LED will light up. When the charging process is completed, the LED changes its color to green. Charging time is up to 5 hours.
4. Connect the Pedal sensor charger to the pedal sensor.
Connect the pedal charger sensor to the mains supply with matching current. A yellow LED lights up while charging. It turns to green when fully charged. Charging time is up to 2-4 hours.
5. After completing the charging process, please remove the power cord of the charger from the mains supply.

NOTICE

You can fully charge your battery every time. There is no memory effect. The optimal temperature range for charging the battery is between 32°F and +86°F. The charging time increases when the temperature is lower.

It is recommended to store and charge the bike in your house or in a warm garage when the outside temperatures are low. This increases the service life of the battery

⚠ DANGER

If the charging times exceeds the times listed above, stop charging and disconnect the charger from the mains supply. For safety reasons the charger and battery must be used on a dry and nonflammable surface.

NOTICE

The battery may get warm during charging. Temperatures up to a maximum of 115°F are within the permitted range.

The allowed temperature range to charge a battery is from 32°F to 115°F.

Disconnect the battery from the charger when it is not within the charging-temperature range.

Do not connect the battery pack to the charger until it has reached the allowed charging temperature.

10. MAINTENANCE

DANGER

The electrical motor in your E Bike is very powerful. To operate it correctly and safely, it may be necessary to have it serviced by a specialist.

Immediately stop using the bike if you identify any damage to the electrical system or see live parts exposed after a fall or accident. Always consult us directly if you require repairs, want to ask about a question or problem, or have identified a defect. A lack of specialized knowledge can lead to severe accidents and injuries.

DANGER

Before performing any kind of work on your E Bike, turn off the electric system.

NOTICE

Only replace parts of your E Bike with original parts or those approved by the manufacturer. This could otherwise nullify any guarantee and warranty claims.

- When you clean, check or repair the bike, ensure that you do not touch the contacts of the battery and connect them accidentally. If these contacts are live, you could be injured and damage the battery.
- Cleaning your E Bike with a high-pressure cleaner can damage the electrical systems. The high pressure can force cleaning fluid into sealed parts and damage them as a result.

a. Storing your Electron Wheel™

If you are going to store the Electron Wheel™ or E Bike for an extended period of time, store it in a cool, dry location (68 to 77 °F).

Charge the battery to a 50% state of charge. Recharge every 3 month.
Store it the power OFF position.

b. Transportation

Only trained staff may dispatch batteries. Contact your specialist dealer when you want to dispatch the wheel. Staff is usually in a position to collect the battery free of charge and in accordance with the Dangerous Goods Act.

11. WEAR & WARRANTY

Please note that the parts of a E Bike are subject to higher levels of wear than a bicycle without an additional integrated motor. This is due to the heavier weight of the E Bike and higher average speed from the motor. This increased wear is not a material defect and is not covered by the warranty. Typically, this definition of wear includes the following parts:

- Tires
- Brake pads
- Spokes

The battery is subject to aging and is therefore also a wearable part. Please note that the battery gradually loses its capacity depending on its age and operating life. Take this into account when planning journeys and ensure that you use a wheel in good condition.

NOTICE

In the case of a defect/possible liability claim, please contact us directly at:

support@electronwheel.com

We recommend filing all purchase receipts and inspection reports as proof for your records and registering online as required.

Please keep all original packaging.

12. DISPOSAL

This product and/or its battery should not be disposed of with household waste. It is your responsibility to dispose electronic equipment at recycling centers. When you dispose of this product and/or its battery, do this accordingly to your local environmental laws and guidelines.

13. RETURN & WARRANTY POLICY

For direct sales purchases, Electron Wheel™ has a 15 day return policy from the day your unit is delivered. All returns must be in like new condition and have no more than 50 miles registered.

Our units come with a 1 year limited warranty on the battery, motor, and other components.

Please contact us directly before returning to store.

For our full policy, please review our refund & warranty pages found here:

<http://electronwheel.com/legal>

It is the customer's responsibility to retain the wheel's original packaging and to ensure all components are adequately protected before shipping back. Damage in transit will result in additional charges.

Each Electron Wheel must be registered using the form on our website at:

<https://electronwheel.com/warranty>

This registration will be used as evidence of ownership when making a warranty claim.

14. SPECIFICATIONS

Dropout Size	100mm
Dimensions	26" model: 26" x 1.75" rim, 26" x 1.25" (ETRTO 32-559) tire 700c model: 24.6mm x 18mm x 19mm rim, 700c x 32c (ETRTO 32-622) tire
Valve	Schrader valve
Brake Type	Rim brakes (NOT compatible with disc brakes)
Weight Limit	120 kg (265lbs)
Battery	36V 7.8Ah (281Wh) lithium ion battery with advanced BMS
Charger Type	UL listed charger with LED status indicator.
Charge Time	5 hours
Connectivity	Bluetooth low energy (4.0)
Operating Temp	-10°C - 60°C If internal motor temperature exceeds 80°C, torque is restricted Battery charging and storage temperature is 0°C - 45°C
Top Speed	20 mph (USA) 16 mph (EU)
Motor	400W hub motor
Range	Up to 50 miles
Warranty	1 year limited on battery, motor, and parts

NOTICE

FCC Caution: Any changes or modifications not expressly approved by the party responsible for compliance could void the user's authority to operate this equipment.

This device complies with Part 15 of the FCC Rules. Operation is subject to the following two conditions:

(1) This device may not cause harmful interference, and (2) this device must accept any interference received, including interference that may cause undesired operation.

For product available in the USA/Canada market, only channel 1~11 can be operated. Selection of other channels is not possible.

Technical Support

To reach out with any questions
or comments, please email us at:
support@electronwheel.com

User Manual No. 1
Version 4

© Electron Wheel™ 2017



San Diego, CA 92127
info@electronwheel.com • www.electronwheel.com