

Cloud IP Camera

Quick Installation Guide

1.Install 'VsmaHome' APP

a.Scan 'VsmaHome' APP QR code.



b. Download 'VsmaHome' APP from APP Store(iOS) or Play Store(Android).

Note: PC users please download our APP: www.vsmahome.com/download.

2.Add camera to account

a. Plug in device, open the APP, register an account, and log in.

b. Click on '+' in top left corner, select the device model, scan the QR code and add the device ID, and enter the network connection interface.



Note: Due to the continuous updating of the product and software, there may be a discrepancy between the operating guide and the APP interface.All the instructions are subject to the actual operation interface.

3. Select network connection

a. Wi-Fi connection

Click the WiFi connection icon and press the RESET button to enter the WiFi configuration mode. Input the WiFi password, the connection should be successful!

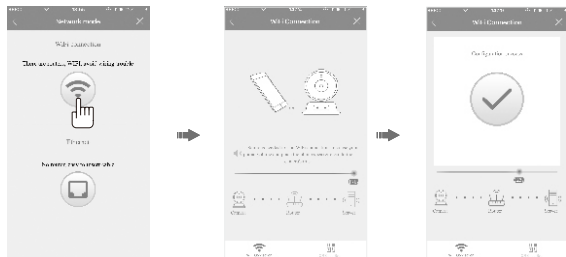

Note: ① Press RESET key, hold for 1-2 seconds to enter the WiFi configuration, long press 10-12seconds to restore the factory settings.

② If the WiFi configuration fails, try an ethernet connection.

b. Ethernet connection

Click on the Ethernet connection icon, connect the network cable, change the password, and set WiFi.

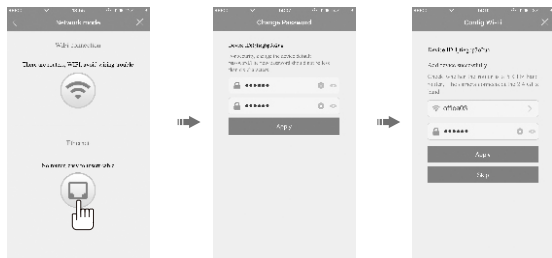

4. SD card video recording setup

When the SD card is inserted into the camera, it is required to manually set up the Settings to open the recording function.

Step 1: View the video

Step 2: Enter the Settings screen

Step 3: Select Schedule Recording

Step 4: Select video recording mode

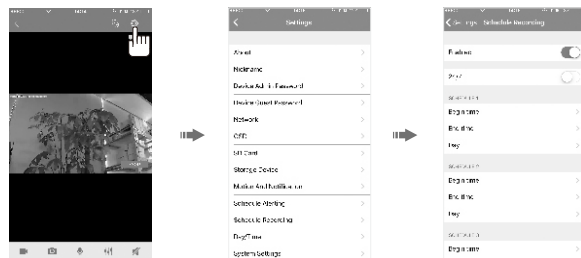

CAUTION

- Adapter shall be installed near the equipment and shall be easily accessible.
- For best results, operating temperature: -10°C - 50°C
- The adaptor is used as the power switch.
- The power adapter must be included by the device vendor.
- The device complies with RF specifications when the device is used 0.5 cm from your body.
- Operating Frequency Range: 2.400GHz-2.4835GHz; Max Output Power: 16dBm.

Note:

*. This device complies with Part 15 of the FCC Rules. Operation is subject to the following two conditions: (1) This device may not cause harmful interference, and (2) This device must accept any interference received, including interference that may cause undesired operation.

Changes or modifications not expressly approved by the party responsible for compliance could void the user's authority to operate the equipment.

This equipment has been tested and found to comply with the limits for a Class B digital device, pursuant to part 15 of the FCC Rules. These limits are designed to provide reasonable protection against harmful interference in a residential installation. This equipment generates, uses and can radiate radio frequency energy and, if not installed and used in accordance with the instructions, may cause harmful interference to radio communications. However, there is no guarantee that interference will not occur in a particular installation. If this equipment does cause harmful interference to radio or television reception, which can be determined by turning the equipment off and on, the user is encouraged to try to correct the interference by one or more of the following measures:

- Reorient or relocate the receiving antenna.
- Increase the separation between the equipment and receiver.
- Connect the equipment into an outlet on a circuit different from that to which the receiver is connected.
- Consult the dealer or an experienced radio/TV technician for help.

RF Exposure: A distance of 20 cm shall be maintained between the antenna and users, and the transmitter may not be co-located with any other transmitter or antenna.