



USER MANUAL

RF Remote Control

Need Help?

✉: Support@treatlife.tech

Tech Support: www.treatlife.tech/pages/support

THANK YOU

If you have any questions, please feel free to contact us first. We are always here for you.

ADD DEVICES

- Press and hold the switch power button for 5 seconds to enter pairing mode, then press and hold the remote control power button for 1 second to confirm.

- Adjusting the Minimum Brightness:

Method 1:

Step 1: Press and hold the power button on the remote for 6 seconds to enter minimum brightness adjustment mode.
Step 2: Use the +/- buttons to adjust the brightness in 1% increments.
Step 3: Once the desired brightness is set, press the power button for 1 second to confirm.

Method 2:

Step 1: Press and hold the +/- buttons simultaneously for 3 seconds to enter minimum brightness adjustment mode.
Step 2: Use the +/- buttons to fine-tune the brightness in 1% increments.
Step 3: Once the desired brightness is reached, press the main button for 1 second to confirm.

- Press and hold the "-" button on the remote control for about 15 seconds to clear the remote control.
- Quickly press the switch power button three times to reverse the white load indicator.
- Press the reset button if the device is stuck or experiencing issues like being unable to adjust brightness (this will not reset the factory default minimum brightness).
- The minimum brightness setting will be saved even after a power outage.

PRODUCT APPEARANCE

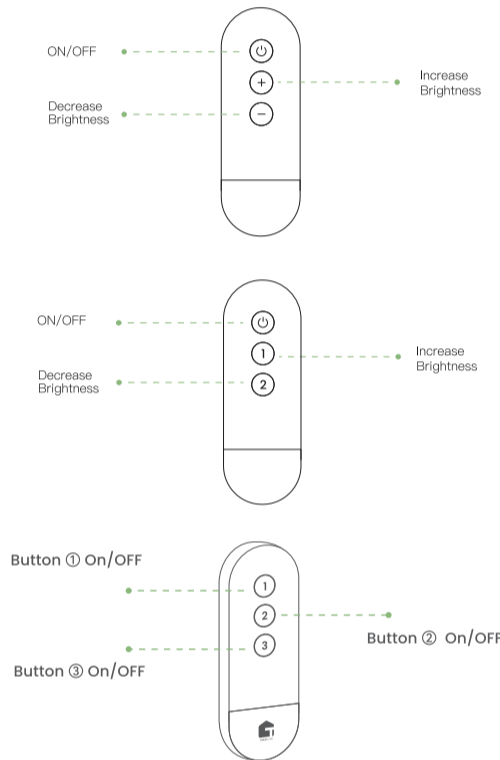

RF Remote Control

Indicator Light Status

Light Color	Light Status	Switch Status
White	ON	Power ON
	OFF	Power OFF
Red	Twinkle	Minimum Brightness Setting
		Remote Control Pairing

BATTERY INSTALLATION/REPLACEMENT

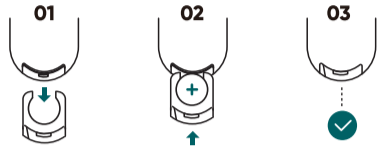

Common Issues:

- If the light is flashing, try increasing the minimum brightness (refer to the Minimum Brightness Setting Steps).
- If the minimum brightness is too bright, try decreasing it (refer to the Minimum Brightness Setting Steps).
- If the remote control is unresponsive or not working properly, minimum brightness (refer to the Minimum Brightness Setting Steps). If the issue persists, please check if the socket or the bulb is damaged.
- If the remote control is unresponsive or not working properly, it may be due to low battery power. Please replace the CR2032 battery.

⚠ WARNING

- Remove and immediately recycle or dispose of used batteries according to local regulations, and keep them away from children. Do NOT dispose of batteries in household trash or incinerate them.
- Even used batteries may cause severe injuries or death.
- Call a local poison control center for treatment information.
- Battery: CR2032
- Voltage: 3V
- Non-rechargeable batteries are not to be recharged.
- Do not force discharge, recharge, disassemble, heat above the manufacturer's specified temperature rating, or incinerate. Doing so may result in injuries due to venting, leakage, or explosions resulting in chemical burns.
- Ensure the batteries are installed correctly according to polarity (+ and -).
- Do not mix old and new batteries, different brands, or types of batteries such as alkaline, carbon-zinc, or rechargeable batteries.
- Remove and immediately recycle or dispose of batteries from equipment not used for an extended period of time according to local regulations.
- Always completely secure the battery compartment. If the battery compartment does not close securely, stop using the product, remove the batteries, and keep them away from children.

⚠ WARNING

- INGESTION HAZARD:** This product contains a button cell or coin battery.
- DEATH** or serious injury can occur if ingested.
- A swallowed button cell or coin battery can cause **Internal Chemical Burns** in as little as **2 hours**.
- KEEP** new and used batteries **OUT OF REACH OF CHILDREN**
- Seek immediate medical attention** if a battery is suspected to be swallowed or inserted inside any part of the body.

FCC Caution:

This device complies with part 15 of the FCC Rules. Operation is subject to the following two conditions: (1) This device may not cause harmful interference, and (2) this device must accept any interference received, including interference that may cause undesired operation.

Any Changes or modifications not expressly approved by the party responsible for compliance could void the user's authority to operate the equipment.

Note: This equipment has been tested and found to comply with the limits for a Class B digital device, pursuant to part 15 of the FCC Rules. These limits are designed to provide reasonable protection against harmful interference in a residential installation. This equipment generates uses and can radiate radio frequency energy and, if not installed and used in accordance with the instructions, may cause harmful interference to radio communications. However, there is no guarantee that interference will not occur in a particular installation. If this equipment does cause harmful interference to radio or television reception, which can be determined by turning the equipment off and on, the user is encouraged to try to correct the interference by one or more of the following measures:

- Reorient or relocate the receiving antenna.
- Increase the separation between the equipment and receiver.
- Connect the equipment into an outlet on a circuit different from that to which the receiver is connected.
- Consult the dealer or an experienced radio/TV technician for help.

RSS (Category I Equipment):

This device complies with Innovation, Science, and Economic Development Canada's licence-exempt RSS standard(s). Operation is subject to the following two conditions:

- this device may not cause interference, and
- this device must accept any interference, including interference that may cause undesired operation of the device.

Le présent appareil est conforme aux CNR d'Innovation, Sciences et Développement économique Canada applicables aux appareils radio exempts de licence. L'exploitation est autorisée aux deux conditions suivantes :

- l'appareil ne doit pas produire de brouillage, et
- l'utilisateur de l'appareil doit accepter tout brouillage radioélectrique subi, même si le brouillage est susceptible d'en compromettre le fonctionnement.

The device is compliance with RF exposure guidelines, users can obtain Canadian information on RF exposure and compliance. The minimum distance from body to use the device is 20cm. Le présent appareil est conforme

Après examen de ce matériel aux normes de conformité ou aux limites d'exposition au champ RF, les utilisateurs peuvent sur l'exposition aux radiofréquences et la conformité and compliance d'acquiescer les informations correspondantes. La distance minimale du corps à utiliser le dispositif est de 20cm.