

# Instruction Manual

## IMPORTANT SAFETY INSTRUCTIONS

When using electrical products, basic precautions Should always be followed:

### READ & FOLLOW ALL SAFEIY INSTRUCTIONS

- This is an electric product -not a toy! To avoid risk of fire, burns, personal injury ,and electrical shock, it should not be played with or placed within reach of children.
- Do not use seasonal products outdoors unless marked suitable for outdoor use. When products are used in outdoor applications, connect the product to a Ground Fault Circuit Interrupter (GFCI). If one is not provided, contact a qualified electrician for proper installation.
- Do not use product for anything other than its intended use.
- This seasonal use product is not intended for permanent use or installation.
- Unplug when leaving the house, retiring lor the night, or if left unattended.
- Do not mount or place near gas or electric heaters, fireplaces, candles or other similar sources of heat.
- Do not secure the wiring of this product with staples or nails, Do not place on sharp hooks or nails.
- Do not hang ornaments or other objects from cord, wire, or light string.
- Do not close doors or windows on the product or extension cords, as this may damage the wire insulation.
- Do not cover the product with cloth, paper or any material not provided with the product when in use.
- This product is equipped with non-shunted type L.E.D. lamps. Do not twist or attempt to remove lamps.
- Do not let lamps rest on the supply cord or on any wire.
- Read and follow all instructions that are on the product or provided with the product .

### CAUTION: To reduce the risk of fire and electric shock;

- Do not install on trees having needles, leaves,or branch coverings of metal or materials that look like metal.
- Do not mount or support strings in a manner that can cut or damage wire insulation

### USE AND CARE INSTRUCTIONS:

1. Before using or reusing, inspect product carefully. Discard any products that have cut, damaged, or frayed wire insulation or cords, cracks in the lamp holders or enclosures, loose connections, or exposed copper wire.
2. When storing the product, carefully remove the product from wherever it was installed, including trees, branches, or bushes, in order to avoid any undue strain or stress on the product's conductors, connections, and wires.
3. When not in use, store neatly, in a cool dry location protected from sunlight.
4. When the product is used on a live tree, the tree should be well maintained and fresh. Do not place
5. If the product is placed on a tree, the tree should be well secured and stable.
6. A cotton string with plastic hook is attached with the sphere, you can tie up the sphere on a safe area you pick; or you can hook it up safely with the provided plastic hook on hanger. on live trees in which the needles are brown or break off easily. Keep the tree holder filled with water.

**SAVE THESE INSTRUCTIONS continued on back**

品号：

材质：80克书纸 尺寸：200\*310mm

**NOTE:** This equipment has been tested and found to comply with the limits for a Class B digital device, pursuant to Part 15 of the FCC Rules. These limits are designed to provide reasonable protection against harmful interference in a residential installation. This equipment generates, uses and can radiate radio frequency energy and, if not installed and used in accordance with the instructions, may cause harmful interference to radio communications. However, there is no guarantee that interference will not occur in a particular installation. If this equipment does cause harmful interference to radio or television reception, which can be determined by turning the equipment off and on, the user is encouraged to try to correct the interference by one or more of the following measures:

- Reorient or relocate the receiving antenna.
- Increase the separation between the equipment and receiver.
- Connect the equipment into an outlet on a circuit different from that to which the receiver is connected.
- Consult the dealer or an experienced radio/TV technician for help.

## FCC Radiation Exposure Statement:

This equipment complies with FCC radiation exposure limits set forth for an uncontrolled environment. This transmitter must not be co-located or operating in conjunction with any other antenna or transmitter.

## USER SERVICING INSTRUCTIONS:

The sphere lighting is connected with a 24V, 1A adapter. If you want to replace the adapter, it must meet 24V, 1A or above adapter.

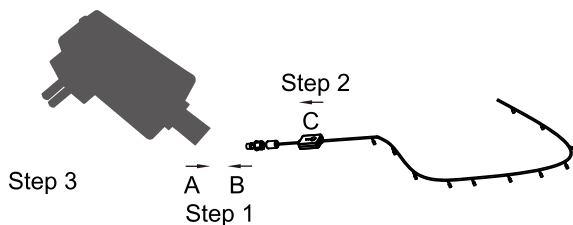

- Step 1. Attach B to A
- Step 2. Screw C cover B to A
- Step 3. Locate power supply

## FCC Warning Instruction

**Caution:** The user is cautioned that changes or modifications not expressly approved by the party responsible for compliance could void the user's authority to operate the equipment.

This device complies with Part 15 of the FCC Rules. Operation is subject to the following two conditions:

This device may not cause harmful interference.

This device must accept any interference received, including interference that may cause undesired operation.

The position of ferrites are 2cm from the adapter and 10cm from the controller, can't be removed casually, otherwise will be conducted emission fail

Made in China