

NT-SPL2  
WirelessSpeaker *Classic*



north-tech.us /NTproducts

Designed in USA by  
NORTH TECH Group Corp.

RoHS CE FC  
MADE IN CHINA

2. Please turn off the speaker if you don't use it to prevent power drain.

WORKING TEMPERATURE	STORAGE CONDITION
Temperature: 0° C ~ 40° C Humidity: 0% ~ 85% RH	Temperature: -30° C ~ 60° C Humidity: 0% ~ 90% RH

### TROUBLE SHOOTINGS

#### 1. My mobile phone can't find any new Bluetooth devices?

- Make sure the Bluetooth speaker has entered pairing mode;
- Ensure the speaker is within the effective working range;

#### 2. Bluetooth devices can't pair up

- Make sure your mobile phone allows new connections and it doesn't reach the maximum allowed connection number. Please refer to your mobile's user manual
- Make sure the pairing password entered is "0000". If you are using a Bluetooth transmitter device, please ensure the responding password of your Bluetooth transmitter supports "0000" code.

#### 3. My speaker does not play music / answer call when it connected to a Bluetooth mobile phone?

- Make sure your Bluetooth mobile phone supports A2DPand HSF (hands-free) profile;
- Ensure your Bluetooth cell phone is within effective working range.

#### 4. When paired with my computer, windows ask for new driver? Can you supply?

We can't supply. The Bluetooth A2DP/HSF drivers may require playing stereo sound via Bluetooth connection. But the driver is actually needed for the Bluetooth module on your PC, instead of the speaker. Different Bluetooth module may require different drivers. Please contact your PC or Bluetooth module's manufacturer for driver update.

#### 5. Why can't I remotely control the pause, play, previous song and skip track functions with the speaker when playing music?

a) When you are using 3.5mm AUX audio in connection, you can't pause, change volume or skip tracks with the buttons on the speaker;

b) This feature needs the Bluetooth devices paired with the speaker to support AVRCP (Audio/Video Remote Control Profile). Please make sure your cell phone or other Bluetooth device supports AVRCP.

### SAFETY NOTICES

Read the following recommendations before using the Bluetooth speaker.

- Keep it dry and don't take it to damp places to avoid the product's internal circuit being affected.
- Keep the product away from direct sunlight or hot places. High temperatures will shorten the life of electronic devices destroy the battery or distort certain plastic parts.
- Don't expose the product to extremely cold area. It may damage the internal circuit board.
- Don't try to disassemble the product as it may get damaged if you are not professional. The internal circuit might get damaged.
- Don't use intensive chemical products or detergent to clean the product.
- Don't scratch the surface with sharp tips.

NORTH TECH



NT-SPL2  
WirelessSpeaker *Classic*

User Manual



## ACCESSORIES

1x NT-SPL2 Classic Wireless Speaker  
1x User Manual  
1x USB Charging Cable  
1x AUX 3.5mm Audio Cable



NT-SPL2  
*Classic*

## HIGHLIGHTS

NT-SPL2 Classic is a compact Bluetooth speaker that can be wirelessly connected to Bluetooth devices such as smart phones, tablets and computers to playback any music collection stored on them. Thanks to the powerful battery and passive radiator, the speaker delivers long time play time and powerful BASS. The speaker with its substantial battery life offers 6 to 8 hours play time and is the perfect companion for you in the house and party. The easy operation helps you get rid of complicated connections and wiring distance constraints. Therefore, users can enjoy high-quality music anytime and anywhere.

## PAIRING AND CONNECTION

Turn on the speaker by pressing the power button for several seconds, then the blue LED on the power button flashes quickly. The speaker now has entered the Bluetooth pairing mode.

## BLUETOOTH CONNECTION

1. Activate your phone's Bluetooth.
2. Go to your phone's Bluetooth settings and scan for new Bluetooth devices.
3. Click the device pairing name "NT-SPL2 Classic" and pair.
4. If your phone asks for pairing code, please enter "0000" and confirm it.
5. After successful pairing, the speaker will make a prompt sound and the LED light stays blue.

### Note:

Pairing time varies with different mobile phones. It only needs pairing at the first time and it will automatically connect the devices which have already been paired before (The speaker can remember the last 8 paired devices' names only)

## AUX-IN CONNECTION

The speaker also features 1x AUX-IN audio port to simply connect the speaker with your non-Bluetooth mobile phones/MP3 players/PCs/laptops with the 3.5mm jack audio cable. The LED on the power button turns green, and then you can play music via wired connection.

## LOW POWER INDICATION

The red LED beside the USB charging port will blink if battery is low. Users need to charge the speaker timely.

## CHARGING

Connect the micro USB charging cable to a computer or USB charger to charge the speaker.

### NFC Function

There is a built-in NFC chip in the speaker. Activate the NFC function on the phone and put the phone close onto the NFC position of the speaker. Then, do according to the phone instructions to fast connect the phone with the Bluetooth speaker via NFC function.

## SPECIFICATIONS

### Speaker Interfaces

AUX-IN Interface: Audio input connector 3.5mm;  
Charging interface: Micro USB; Input 5V

## ELECTRICAL SPECIFICATIONS

- Bluetooth Compatibility: It is compatible with Bluetooth 4.0 Class II and supports A2DP V1.2, AVRCP V1.4 profiles agreement.
- Transmission distance: up to 10m
- Sound track: Dual track
- Signal to noise ratio S / N:  $\geq 85\text{dB}$
- Frequency Range: 160Hz-20 KHz
- Distortion THD:  $\leq 1\%$
- Speaker unit: outer diameter 52mm, inner magnet, 4 $\Omega$ , 10W x 2 with DSP

## Parameters of power

- Battery: Built-in lithium battery 7.4V/2500mAh
- Charging Voltage/Current: 5V/1A
- Charging time: 4~5 hours
- Playing time: 6~8 hours

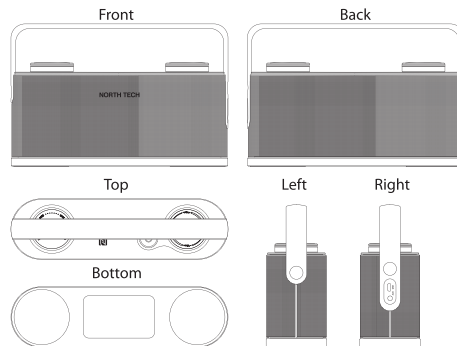

## DIMENSIONS AND BASIC PARAMETERS

Length: 232mm  $\pm$  0.5mm  
Width: 65  $\pm$  0.5mm  
Height: 153mm  $\pm$  0.5mm  
Material: Aluminum + ABS+Fabric  
Weight: 1200g  $\pm$  10g

## FUNCTION ANALYSIS

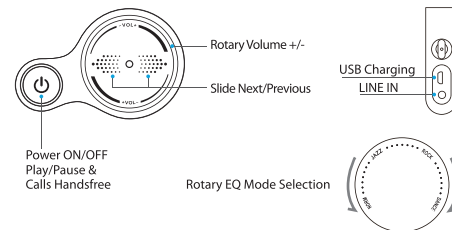

Power ON / OFF	Press long  to power on/off.
Volume - or +	Turn clockwise to turn up the Volume and counterclockwise to turn the Volume down.
Next/Previous	In the Bluetooth mode, slide to the right to get to the next track and to the left to get to the previous track .
Play/Pause	When playing music, press  short to Pause/Play.
Answering a call	When a call comes in, press  short to pick up the call and press it again to hang up.
Refuse a call	When a call comes in, press  twice "quickly" to refuse the call.
EQ Mode Selection	Rotate  to select the EQ mode, the icon will be illuminate accordingly.

### Note

1. Under Bluetooth mode when the 3.5mm audio plug is inserted, the speaker will switch to line in status automatically;



**FCC WARNING**

This device complies with Part 15 of the FCC Rules. Operation is subject to the following two conditions:

- (1) This device may not cause harmful interference, and
- (2) this device must accept any interference received, including interference that may cause undesired operation.

NOTE 1: Any changes or modifications to this unit not expressly approved by the party responsible for compliance could void the user's authority to operate the equipment.