

User Guide

Step1:

Install the lock according to the instruction

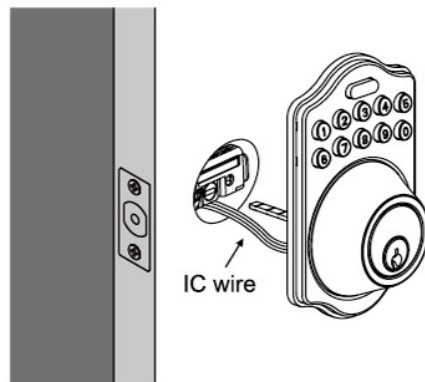

Step2:

Search iMagic lock on iOS App Store/Android Google Play to download our app manually.



Step3:

Use smart phone to configure the lock.



Contact us at contact@imagicdevice.com

ELECTRONIC DEADBOLT

Installation Guide



WARNING

Do not use an electric screwdriver during installation.

WARNING

This Manufacturer advises that no lock can provide complete security by itself. This lock may be defeated by forcible or technical means, or evaded by entry elsewhere on the property. No lock can substitute for caution, awareness of your environment, and common sense. Builder's hardware is available in multiple performance grades to suit the application. In order to enhance security and reduce risk, you should consult a qualified locksmith or other security professional.

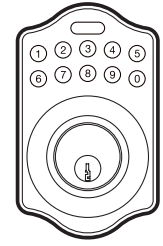

iSL2S_SE01

PACKAGE CONTENTS

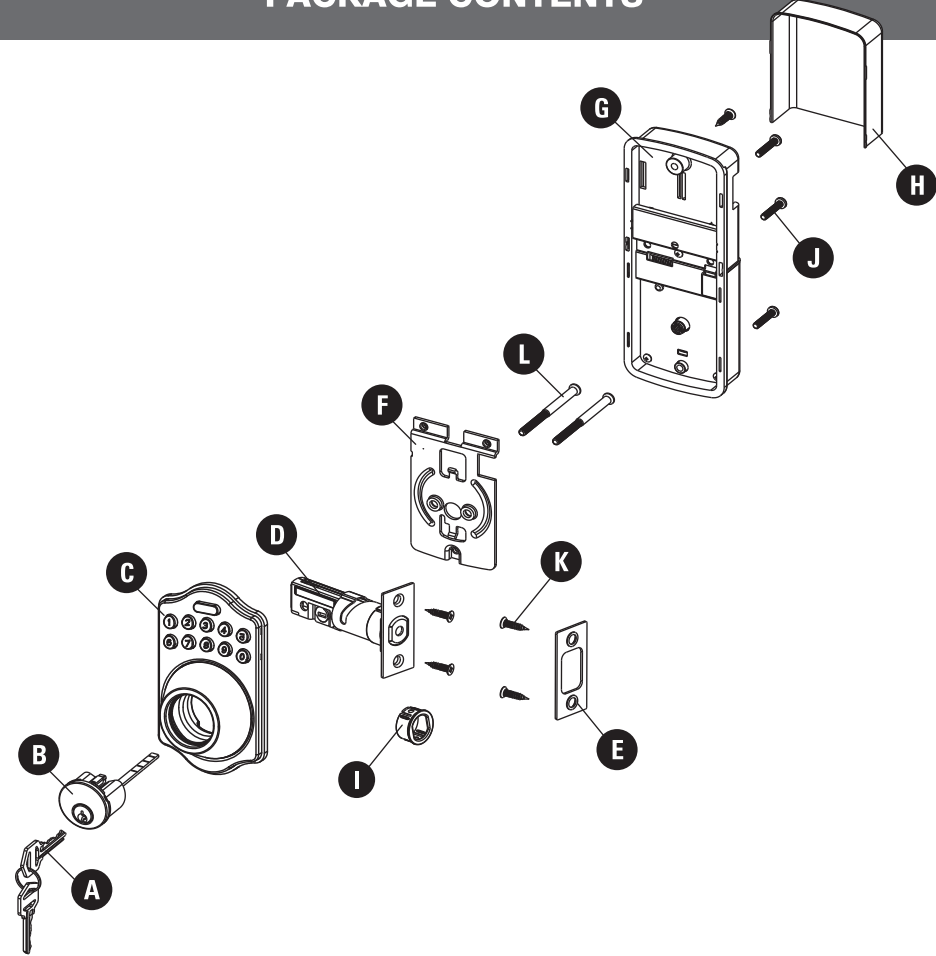

Part	Description	Quantity	Part	Description	Quantity
A	Key	2	E	Strike Plate	1
B	Cylinder	1	F	Mounting Plate	1
C	Deadbolt Keypad Assembly	1	G	Receiver Assembly	1
D	Deadbolt Latch	1	H	Battery Cover	1
			I	Drive-in Sleeve (Optional)	1

HARDWARE SCREWS CONTENTS

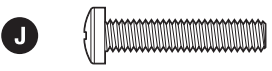

Machine Screws Qty. 3

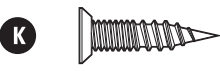

Wood Screws Qty. 5

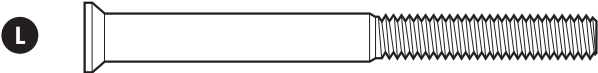

Deadbolt Chassis Screws Qty. 2

LATCH ADJUSTMENT

Determine if the latch needs to be adjusted to the 2-3/4" (70 mm) backset. To adjust, rotate the latch until it stops.

Reverse the direction to return to the 2-3/8" (60 mm) backset.

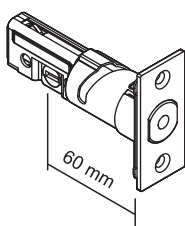

2-3/8" (60 mm)

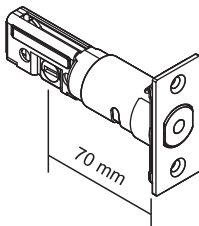
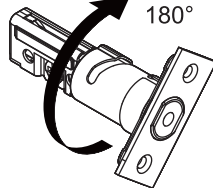

2-3/4" (70 mm)

CHANGE LATCH FACE

Determine which latch mounting method will be used and make necessary adjustments. No adjustment required for square latch face plate.

a. Use a flat screwdriver to separate the face plate.

b. Snap selected latch face onto back plate.

Drive-in Installation

Remove original latch faceplate. Align the drive-in sleeve as illustrated and snap into the latch case.

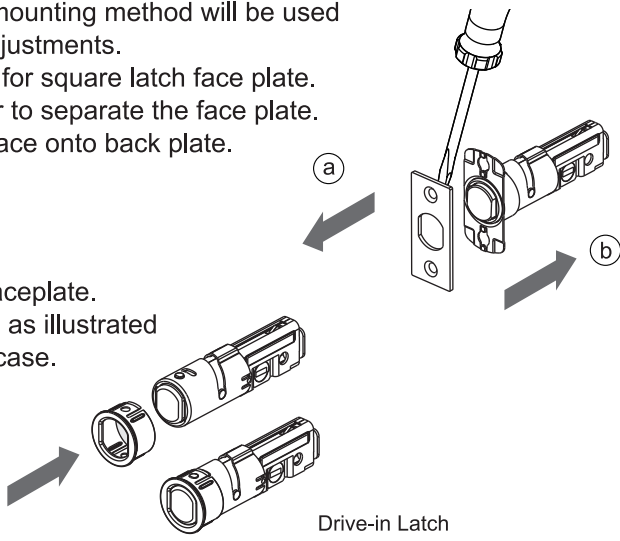

Drive-in Latch

1 Backset Determination

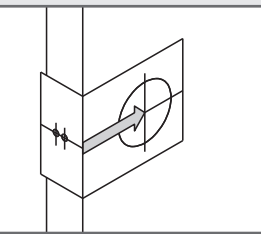

Backset is a distance from door edge to centre of hole on door face. Adjustable latch fits both backset of 2-3/8" (60 mm) and 2-3/4" (70 mm).

2 Mark the Door with Template

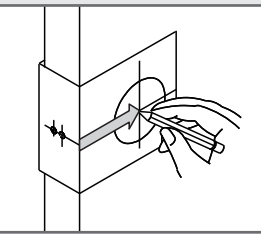

Select the height and backset as desired on the door face; use the TEMPLATE as an indication to mark the centre of the circle on the door face and the centre of the door edge.

3 Drill Holes

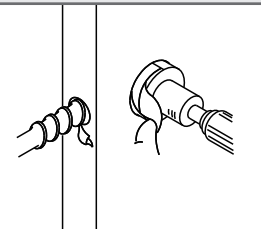

Using the marks as a guide to drill a hole Ø2-1/8" (54 mm) through the door face for the lockset, then a hole of Ø1" (25.4 mm) for latch.

4 Install Latch

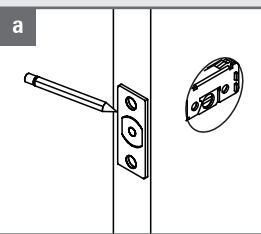

Insert the latch and ensure it is parallel to the door face. Mark the outline of the faceplate, then take out the latch.

You need to stay this way up when inserting the latch.

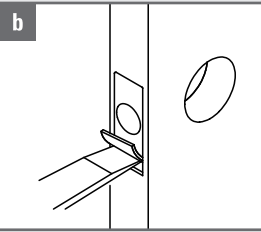
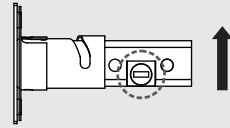

Chisel 5/32" (4 mm) deep along the outline to allow the faceplate to be aligned with the door edge.

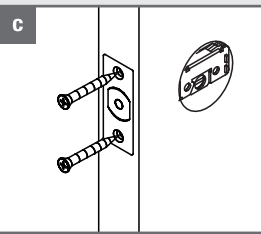

Insert the latch into the door. Use 2 wood screws to secure latch. Please do not fully tighten the screws until lock is completely installed.

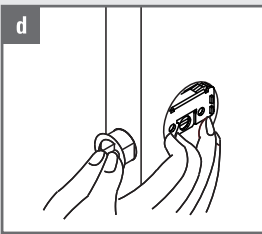

Install Drive-in Latch
Drive the latch into the hole on edge of door.

5 Install Strike

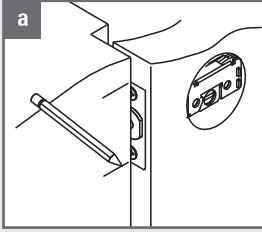

To identify the centre of strike: close the door to lay the latchbolt against the door frame. Mark the centre line on the doorframe exactly opposite the latch hole in the door edge.

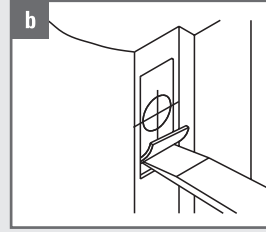

Measure one half of door thickness from door stop and vertically mark centre line of strike. Drill 1" (25.4 mm) hole, 1" (25.4 mm) deep at intersection of horizontal and vertical line of strike.

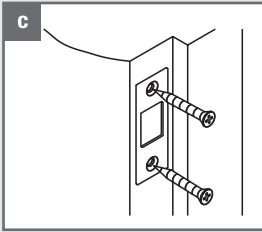

Install the strike plate into your door frame and tighten with wood screws.

6 Install Keypad Assembly

Install cylinder into the deadbolt keypad assembly with tailpiece in horizontal position inserted through hub of the latch.

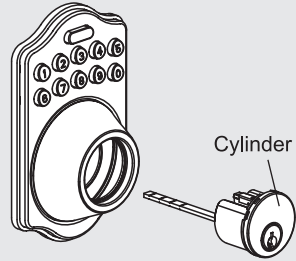

Cylinder

Pass the IC wire under the latch to the interior side of the door.

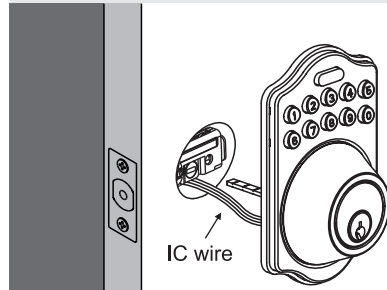

IC wire

7 Install Inside Mounting Plate

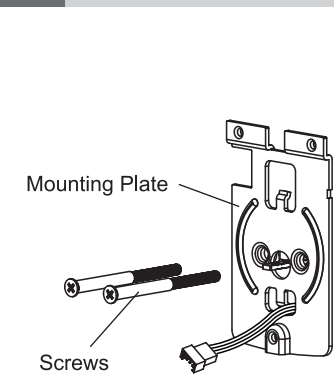

Mounting Plate

Screws

Pass the IC wire through the wire hole of the mounting plate. Fix the mounting plate with screws. If outside lock assembly is lopsided, please loosen the screws to adjust its position and tighten the screws again.

8 Identify Door Handing

Face the door from the outside. The door is left-handed if the hinges are on the left side of the door, whereas the door is right-handed if the hinges are on the right side of the door.

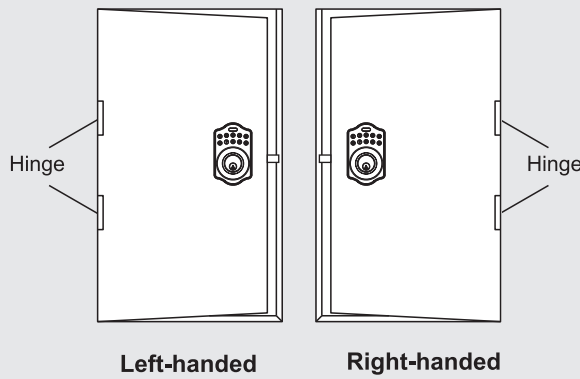

Left-handed

Right-handed

9 Adjust Thumb Turn Piece

Rotate the thumb turn piece to the LEFT at 45 degrees for right-handed doors.

Rotate the thumb turn piece to the RIGHT at 45 degrees for left-handed doors.

Note : The thumb turn piece is opposite to the latching side.

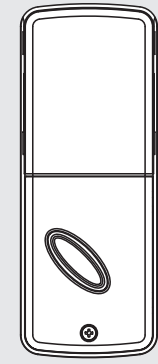

For right-handed door

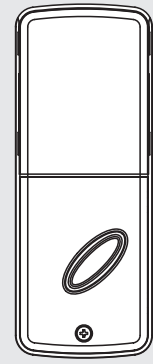

For left-handed door

10 Install Receiver Module

Remove the battery cover (push it up first then pull it out).

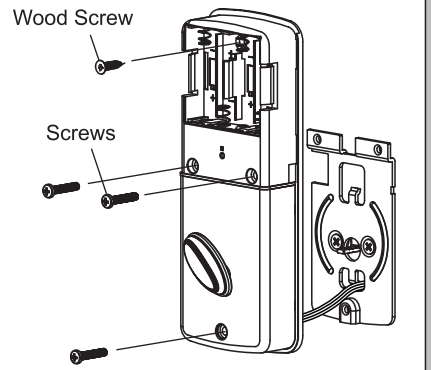
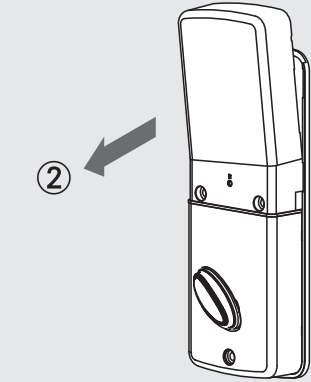
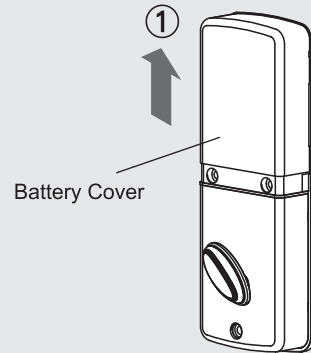

Connect the IC wire into the back of the receiver module. Ensure that the deadbolt tailpiece is engaged with turn piece, then attach receiver module to the door with screw. Use the optional wood screw to secure the receiver module to wood doors only.

11 Insert Batteries

Insert 4 (AA) 1.5 V alkaline batteries and slide the battery cover back onto the receiver module.

Remarks:

(1) Alkaline batteries are recommended in order to stabilize the power supply. If you don't use alkaline, battery performance will be reduced greatly.

(2) All settings will be retained in the memory even if the batteries are completed dead.

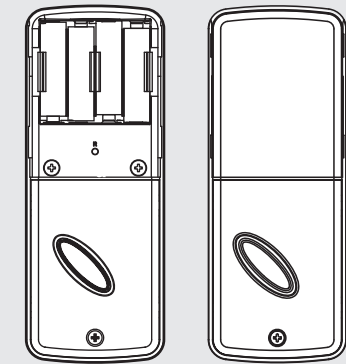

TEMPLATE

FOR BACKSET 2-3/4" (70 mm)

FOR BACKSET 2-3/8" (60 mm)

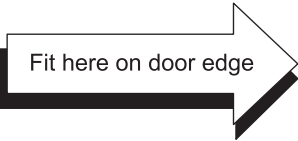

51mm 45mm 40mm 35mm
2" 1-3/4" 1-9/16" 1-3/8"

Mark Ø1" (25.4 mm) hole at centre of door edge.

Ø2-1/8" (54 mm)

This device complies with Part 15 of the FCC Rules. Operation is subject to the following two conditions: (1) this device may not cause harmful interference, and (2) this device must accept any interference received, including interference that may cause undesired operation.

FCC Caution:

Changes or modifications not expressly approved by the part responsible for compliance could void the user's authority to operate the equipment.

FCC Statement:

"This equipment has been tested and found to comply with the limits for a Class B digital device, pursuant to part 15 of the FCC Rules. These limits are designed to provide reasonable protection against harmful interference in a residential installation. This equipment generates, uses and can radiate radio frequency energy and, if not installed and used in accordance with the instructions, may cause harmful interference to radio communications. However, there is no guarantee that interference will not occur in a particular installation. If this equipment does cause harmful interference to radio or television reception, which can be determined by turning the equipment off and on, the user is encouraged to try to correct the interference by one or more of the following measures:

- Reorient or relocate the receiving antenna.
- Increase the separation between the equipment and receiver.
- Connect the equipment into an outlet on a circuit different from that to which the receiver is connected.
- Consult the dealer or an experienced radio/TV technician for help."