

Snap UL Listed Fast Wireless Power Bank Stand Kit

Instruction Manual

7121-70

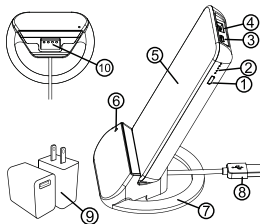

Features:

1. Powerbank ON/OFF Button
2. LED Indicator
3. Type-C Input
4. USB Output
5. Wireless Charging Surface
6. Charging Dock LED Indicator
7. Charging Dock
8. Charging Dock USB Cable
9. UL Listed QC 3.0 AC Adapter
10. Dock to Power Bank Contacts

What's included:

- 1 x 10000mAh Wireless Power Bank
- 1 x UL Listed QC 3.0 AC Adapter
- 1 x Instruction Manual
- 1 x USB to Type-C Cable

Tech Specifications

- Capacity: 10000mAh/3.7V/74Wh
- Type-C Input: 5V/2A, 9V/2A
- USB A Output: 5V/2.4A (Max)
- Wireless Output: 5W/7.5W/10W

LED Indicators

- Press the Powerbank ON/OFF Button(1) once to view the remaining power capacity.

Number of LEDs	●●●● Blue	●●●● Blue	●●●● Blue	●●●● Blue
Capacity Remaining	about 100%	about 75%	about 50%	about 25%

INSTRUCTIONS:

1. Charging the PowerBank:

- Charge the powerbank fully before usage.

a. Charging Option 1:

- Connect the provided charging cable to a power source and to the Type-C Input port(3) on the powerbank.
- Once connected the LED Indicator(2) will begin to flash blue when charging.
- Once fully charged LED will stop flashing.

b. Charging Option 2:

- Place the powerbank on to the Dock Contacts(10) of the Charging Dock(7).
- Connect the charging docks intergrated USB cable to the provided AC Adapter(9) to a power source.
- Once connected the LED Indicator will begin to flash blue when charging.
- Once fully charged LED will stop flashing.
- ***Charging Dock LED Indicator (6) will illuminate BLUE

2. Charging Electronic Devices with the Power Bank:

- Connect the charging cable to your mobile phone/device using the appropriate connector.
- Connect the USB part of the cable to the USB Output, the LED Indicator will

illuminate BLUE when charging.

- Remove the charging cable from your mobile device when fully charged.

3. Charging Electronic Devices with the Wireless Charging:

- Wireless charge with the powerbank either docked or undocked by pressing the powerbank ON/OFF button(1) to turn on wireless charging function.
- Once on standby mode place wireless charging supported mobile device on the charging surface(5), LED will glow RED when device is charging.

**** Note:** If the LED indicator is flashing RED an unknown object is being detected between the wireless charging pad and the phone by FOD(Foreign Object Detection). (The device will not begin to charge until object is removed.)

SAFETY PRECAUTIONS:

- WARNING-When using this product, basic precautions should always be followed:

1. Read all the instructions before use.
2. Never store or use this product in temperatures below 32°F (0°C) or above 115°F (45°C).
3. Do not overcharge your phone. The unit may become hot under excessive use. Remove your phone once it is fully charged. Never charge your phone for more than 7 hours at a time.
4. The unit will only achieve full performance after 2 or 3 completed charge and discharge cycles.
5. To reduce the risk of injury, close supervision is required when the product is used near children.
6. Do not expose the device to moisture.
7. Do not use the device in excess of its

output rating. Overload outputs above the rating may result in a risk of fire or injury.

8. Do not use the device if damaged or modified.
9. Damaged or modified batteries may exhibit unpredictable behaviour resulting in fire, explosion or risk of injury.
10. Do not disassemble the device. For repairs, seek a qualified service professional. Incorrect reassembly may result in a risk of fire or injury.
11. Do not expose the device to fire or excessive temperatures. Exposure to fire or temperatures above 104°F (40°C) may result in explosion.
12. To ensure product safety, ensure that qualified service professionals use only identical replacement parts.
13. Attachments on the back of your phone can impede the effectiveness of the wireless charger, and lead to overheating. Please remove attachments from the phone before charging on this device.

FCC WARNING

This device complies with part 15 of the FCC Rules. Operation is subject to the following two conditions: (1) this device may not cause harmful interference, and (2) this device must accept any interference received, including interference that may cause undesired operation.

Any changes or modifications not expressly approved by the party responsible for compliance could void the user's authority to operate the equipment.

NOTE: This equipment has been tested and found to comply with the limits for a Class B digital device, pursuant to Part 15 of the FCC Rules. These limits are designed to provide reasonable protection against harmful interference in a residential installation. This equipment generates, uses and can radiate radio frequency energy and, if not installed and used in accordance with the instructions, may cause harmful interference to radio communications.

However, there is no guarantee that interference will not occur in a particular installation. If this equipment does cause harmful interference to radio or television reception, which can be determined by turning the equipment off and on, the user is encouraged to try to correct the interference by one or more of the following measures:

- Reorient or relocate the receiving antenna.
- Increase the separation between the equipment and receiver.
- Connect the equipment into an outlet on a circuit different from that to which the receiver is connected.
- Consult the dealer or an experienced radio/TV technician for help.



MADE IN CHINA