

Instructions for use

LED indicator

01. When the APP remote control machine turns, the green light flashes quickly.
02. When the machine automatically cleans the pool, the green light flashes slowly.
03. Breathing flashes red when garbage basket is full.
04. When the machine's power is low, the red light flashes slowly.
05. When the machine is charging via Type-C, the red light flashes. The light turns off when charging is complete.
06. When the machine is faulty, the red light is steady on.
07. When the machine is in standby state, it is steady green. Turn off the lights after sleep.

troubleshooting

When a foreign body clogs the impeller or propeller, resulting in a slow motor speed, the LED light on the machine will be steady red. The machine is in the stopped state, need to clean the blockage, switch the machine again to activate the machine.

When the battery is low, the LED on the machine will flash red. The machine should be placed in a place with ambient light intensity for solar charging or type C charging.

The ultrasonic sensor is dirty and water stained, which will affect the ranging, resulting in the machine constantly rotating in the working mode. Wipe the ultrasonic sensor clean with a towel and return to normal.

Instructions for use

3.2APP connection

APP settings

Scan QR code of Figure 1 , then download and install "LIBOS HOME" APP or Search for LIBOS HOME on the App Store or Android App platforms. Then, download and install it.



Figure1

Open the "LIBOS HOME" App and log in. There are two ways to log in: by verification code or by password.

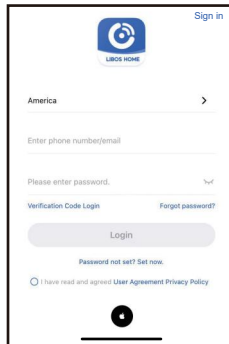

Figure2

After logging in, click "+" in the upper right corner of Figure 3 to add equipment. Select "Pool Cleaner" and follow the instructions on the page to connect.

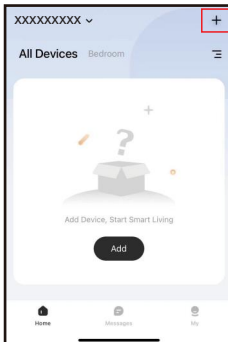

Figure3

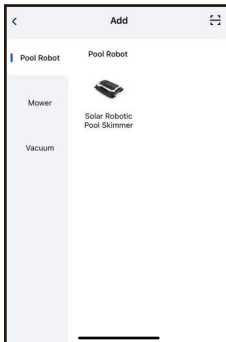

Figure4

The final interface is subject to the actual product, thank you.

Instructions for use

Follow the page prompts to turn on your device and keep it within range and turn on your phone's Bluetooth. After confirming the completion of the above steps and the status of the device, click Next. Wait for the device to be bound.



Figure5

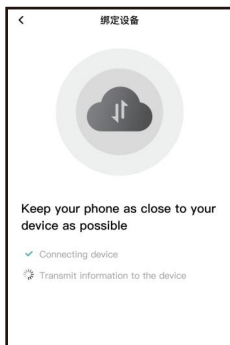

Figure6

After successful binding, you can control the device.

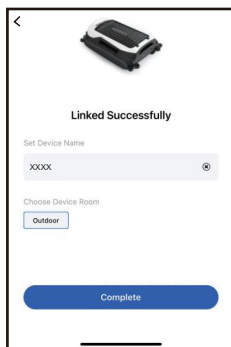

Figure7

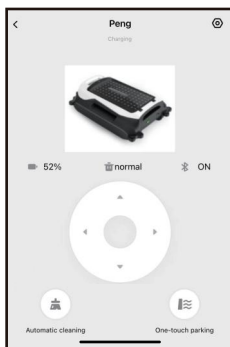
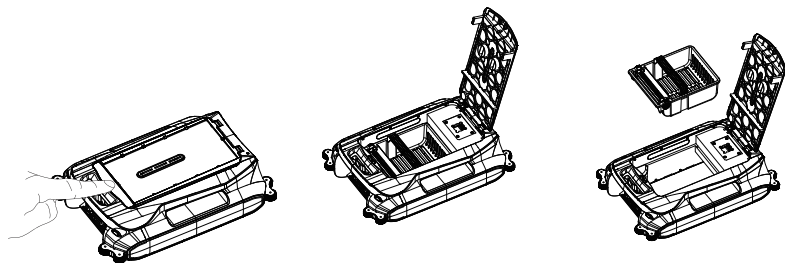

Figure8

Instructions for use

3.3 Product maintenance



Press the flip open button to remove the trash basket.

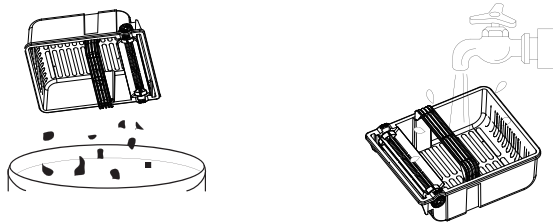

Clean out the trash in the trash basket, clean it with water, and put it back into the machine.

Instructions for use

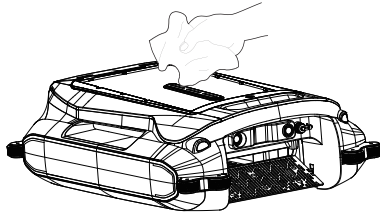

In order to ensure the efficiency of solar charging, it is necessary to regularly clean up dust, fallen leaves and other debris. The solar panel can be rinsed with water and wiped clean.

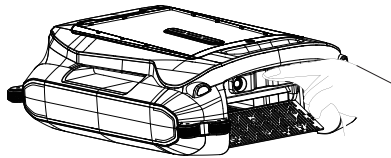

For ultrasonic sensors, dust should be cleaned regularly. If there is dirt and water stains, it will affect the distance measurement of the machine, causing the machine to keep rotating. Use a clean towel to wipe clean and return to normal.

Common Faults

Faults Description

Faults	Possible Reasons	Solution
Machine does not work	The power switch at the rear of the machine is not turned on	Turn the power switch on
	The machine is out of power or the power is not enough	Please use the adapter to fully charge or put it under the sunlight to charge (the machine will work automatically after charging to 30%)
	The machine triggers an alarm fault	According to the indicator status or APP prompts, troubleshooting
	The waste basket is full, the light flashes red.	The machine needs to be switched on and off again to activate the machine after clearing the blockage
	The machine is in non-automatic cleaning mode	Enter auto-cleaning mode in APP or switch on the machine again.
The product cannot be charged	The power switch at the rear of the machine is not turned on	Turn the power switch on
	The charging plug of Type C cable is not fully inserted	Please check whether the charging cable is plugged in properly
	Outdoor sunlight is not enough	Please use the Type C adapter to charge the machine.
Machine rotates in place	The ultrasonic sensor surface is dirty or excessively waterlogged	Please wipe the ultrasonic sensor with a towel

Replaceable modules

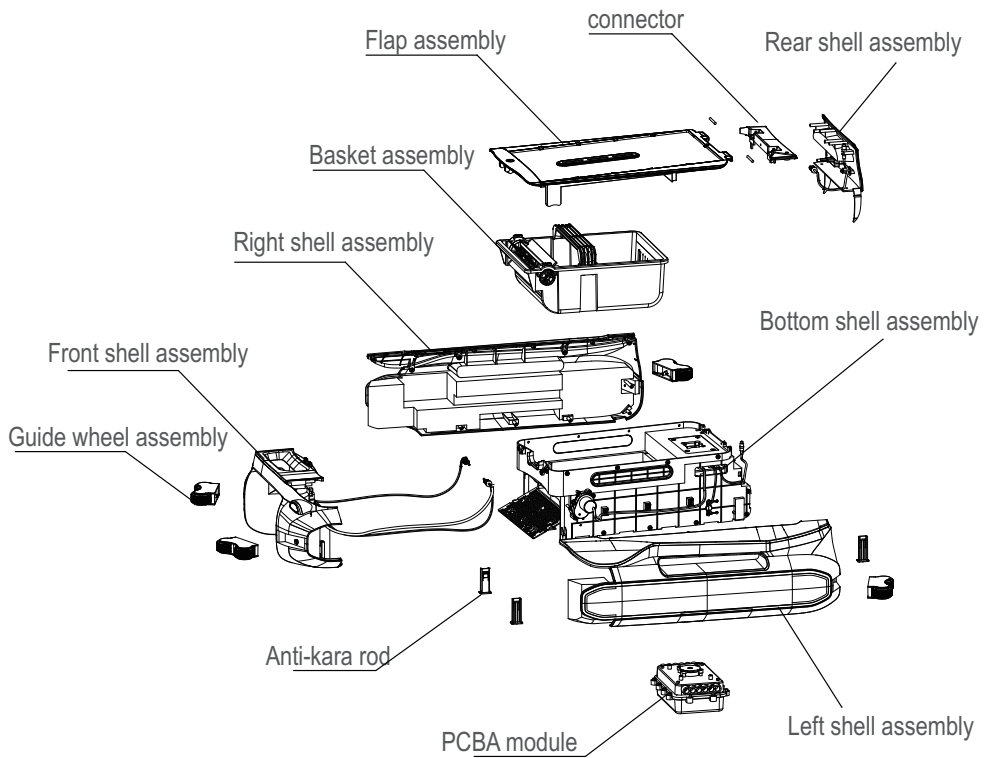

IC Warning

This device complies with Innovation, Science and Economic Development Canada's licence-exempt RSS standard(s).

Operation is subject to the following two conditions:

- (1) this device may not cause interference, and
- (2) this device must accept any interference, including interference that may cause undesired operation of the device.

Le présent appareil est conforme aux CNR d'Innovation, Sciences et Développement économique Canada applicables aux appareils radio exempts de licence. L'exploitation est autorisée aux deux conditions suivantes:

- (1) l'appareil n' doit pas produire de brouillage, et
- (2) l'utilisateur de l'appareil doit accepter tout brouillage radioélectrique subi, même si le brouillage est susceptible d'en compromettre le fonctionnement.

This Class B digital apparatus complies with Canadian ICES-003.

Cet appareil numérique de la classe B est conforme à la norme NMB-003 du Canada.

IC RF Statement:

When using the product, maintain a distance of 20cm from the body to ensure compliance with RF exposure requirements.

Déclaration IC RF:

Lors de l'utilisation du produit, maintenez une distance de 20 cm du corps pour garantir
conformité aux exigences d'exposition aux RF.