

ZEISS DTC

4/50

Quick Guide /
Customer Service and Warranty

Patents: www.zeiss.com/cop/patents

EN



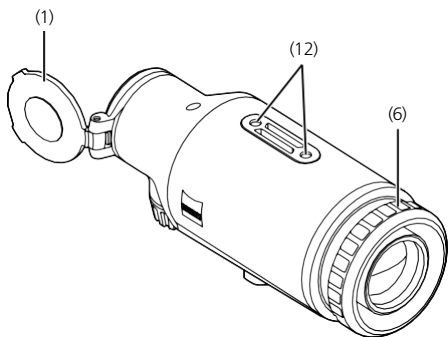
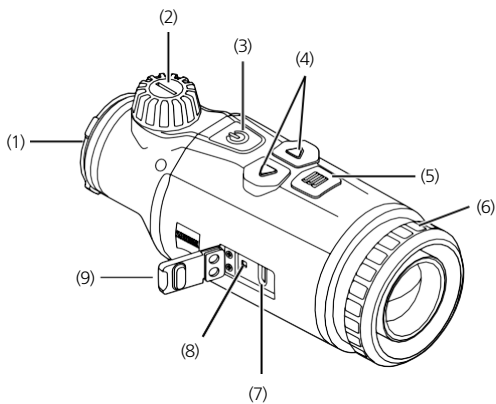

**WARNING!**

Please note the enclosed safety instructions and regulatory information, they can be found under:
www.zeiss.com/cop/safety

**Power on/off**

Press and hold the on/off button **(3)** (approx. 1.5 seconds) to switch on the device.
Press and hold the on/off button again **(3)** to switch off the device.

Standby mode

Briefly press the on/off button **(3)** to switch the device to standby mode. Briefly press the on/off button **(3)** again to switch the device back to observation mode.

Observation mode

Turn the focusing turret **(2)** to bring the scene into focus.

Color modes

The scene can be displayed in eight different color modes. Briefly press the menu button **(5)** to change the color mode. When changed, the selected mode is shown on the display as text for about 2 seconds.

Shooting mode

You have the possibility to take photos and videos. To capture a photo, press the left arrow button **(4)** briefly. To record a video, press and hold the left arrow button **(4)**. You can also capture a photo during video recording. To do this, briefly press the left arrow button **(4)**. Press and hold the left arrow button **(4)** again to stop the video.

Menu

Press and hold the menu button **(5)** to show the main menu on the display. The arrow buttons **(4)** and the menu button **(5)** are used to navigate in the main menu. Press the right arrow button **(4)** to scroll down. Press the left arrow button **(4)** to scroll up. Briefly press the menu button **(5)** to select a menu item. This opens the submenu. Make your settings using the arrow buttons **(4)**.

Briefly press the menu button **(5)** to confirm your selection and return to the main menu.

Press and hold the menu button **(5)** to exit the main menu and return to observation mode.

Note: for a detailed description of the menu items, please consult the user manual.

Charging the device

Charge the device via the USB port **(7)** when the battery is empty. When the charge level is low, the display changes to red. The LED **(8)** also flashes red at the same time. When the battery is fully charged, the LED **(8)** lights up green.

WLAN

This device is equipped with a WLAN function. Go to the menu and switch on the WLAN function. Connect your smartphone via WLAN to the device. Open the ZEISS Hunting app and follow the steps in the menu.

Note: When first used, the preset password for the WLAN connection to the device needs to be changed to prevent unauthorized access by third parties. The ZEISS Hunting app is required to change the password.

Default password: 12345678

To extend battery life, we recommend that you only switch on the WLAN function in the device when the device needs to establish a data connection to the ZEISS Hunting App. To increase the security of the connection, we recommend that you change your password.

Additional information

Please refer to the user manual for further and detailed explanations on mounting and zeroing in the ZEISS DTC 4 as well as the other functions. This is available on our website in the download center:

www.zeiss.com/hunting/manuals

Technical data

DTC 4/50

Optics

Focal length		50 mm / F1.1
Lens type		Germanium
Range	m (Object 1.8 m × 0.6 m) yd (Object 2 yd × 0.7 yd)	2,886.8 (3,137.4)
Field of view in m at 100 m (Field of view in ft at 100 yd)	m (ft)	15.35 (46.05)
Field of view in degrees (horizontal × vertical)	°	8.8 × 7
Optical magnification		1
Maximum image adjustment X to 100 m (Maximum image adjustment X to 100 yd)	cm (ft)	± 88 (2.9)
Maximum image adjustment Y to 100 m (Maximum image adjustment Y to 100 yd)	cm (ft)	± 53 (1.7)
Adjustment per click at 100 m (Adjustment per click at 100 yd)	cm (inch)	1.6 (0.576)

Sensor

Sensor resolution	px	640 × 512
Sensor pixel pitch	μm	12
Frame rate	Hz	50
NETD	mK	< 28

Display

Display resolution	px	1,024 × 768
Display type		AMOLED

Technical data

		DTC 4/50
Electronics		
Interfaces	USB: charging WLAN: data transfer	
Battery	Lithium-ion	
Battery life	h	5
External power supply (not included in the delivery package)	5 V / 2 A (USB)	
Connection to other devices	ZEISS Hunting app, WLAN	
Internal memory	GB	32
General		
Protection class	IP65 / IP67 (protected from heavy rain)	
Operating temperature range	°C (°F)	-10 / +50 (+14 / +122)
Length x width x height	mm	182.1 x 60.5 x 65
	(in)	(7.2 x 2.4 x 2.6)
Weight	g	680
	(oz)	(24)

Customer service and warranty



For service questions or obtaining the warranty terms, please see our website:

www.zeiss.com/cop/warranty

For service inquiries or a free copy of the warranty terms for your region, please contact:

ZEISS Customer Service

Carl Zeiss Sports Optics GmbH

Gloelstr. 3–5

35576 Wetzlar

Germany

Phone +49 800 934 77 33

E-mail consumerproducts@zeiss.com

ZEISS Customer Service USA

Carl Zeiss SBE, LLC

Consumer Products

1050 Worldwide Blvd.

Hebron, KY 41048-8632, USA

Phone +1-800-441-3005

E-mail info.sportsoptics.us@zeiss.com

ZEISS Hunting app

Download the ZEISS Hunting app to receive the latest hardware updates:



Hunting
App



Carl Zeiss AG

Consumer Products

Carl-Zeiss-Strasse 22

73447 Oberkochen

Germany

www.zeiss.com/consumer-products