

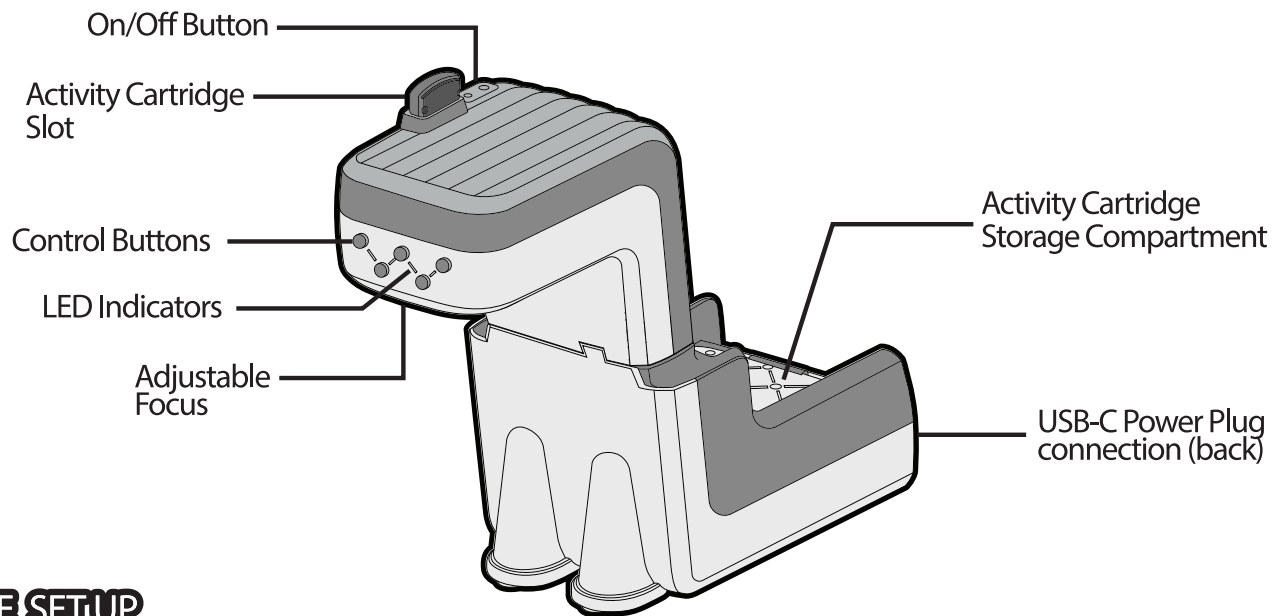

USER MANUAL



Requires Android 10.0+
Requires Apple iOS 15.0+



SIMPLE SETUP

1. Separate the smART Sketcher® AI head from the base unit (picture A).
Place the head on the connector base and rotate it clockwise (picture B) until the head is aligned with the body (picture C).

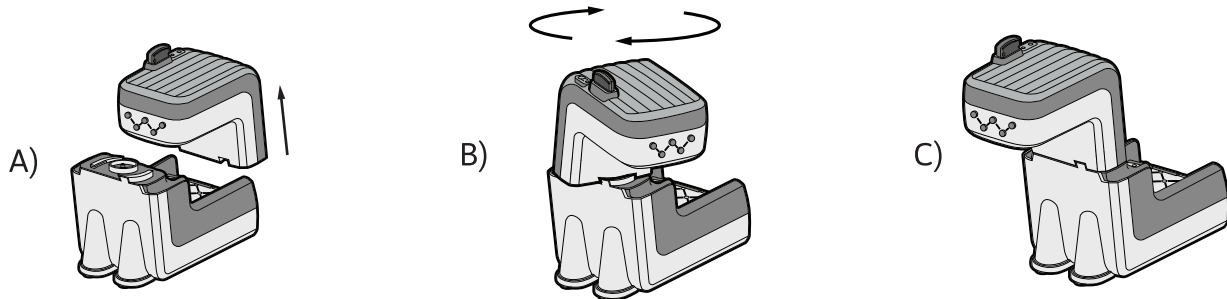

2. Plug the USB-C Power Cable (included) into the back of the unit and into a USB-C power plug (not included) that delivers an output of **5V DC and a minimum current rating of 2A (2000mA)**.
Once everything is connected properly, a green light will appear next to the USB-C connector.
3. Press the On/Off button on top of the device to turn it on.
4. Insert the pre-loaded **Activity Cartridge** with the sticker side facing outward into the top of the device (picture D).
5. Place a piece of **paper** at the base of your smART Sketcher® AI. Anchor it under the front “legs”.
6. After 30 minutes of no activity, the smART Sketcher® AI will automatically turn off. The unit will blink its blue LED indicators for 10 seconds to signal it’s going to turn off. Press any of the smART Sketcher® AI buttons to continue to play.

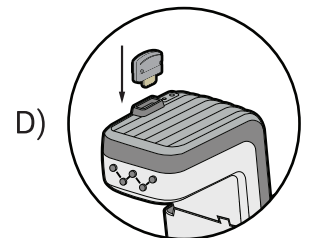

For more fun, additional Activity Cartridges and accessories are available at:
www.flycatcher.toys/smart-sketcher-ai-accessories

Periodically examine your smART Sketcher® AI for potential parts that need to be repaired or replaced.

Please retain this user manual for future reference



QUICKSTART

1. Download the free **smART sketcher® AI app** on your mobile device or tablet.
2. Make sure **Bluetooth** is enabled on your mobile device and then open the app.
3. If you need to **register**: tap the “I have a smART sketcher® AI” button and follow the instructions to complete the one-time registration process. If you have already registered, tap the “Sign in with Flycatcher ID” link.
4. Once your device is connected to the smART sketcher® AI, place a piece of **paper** at the base of the unit, anchoring it under the front “legs.”
5. Use the app to choose your mode of play:

1. Learn to Draw: (pre-loaded Activity Cartridge)

- Insert the **Activity Cartridge** that came with your smART Sketcher® AI, or any smART Sketcher® AI Activity Cartridge (purchased separately) into the top of the unit.
- On the Home screen of the app, tap the “**Activities**” button.
- Scroll to find the activity you want to draw and **select** it.
- The activity will be projected onto your paper.
- Begin drawing **step by step** using the control buttons or the app.

2. Create AI-Generated Images:

- On the Home screen of the app, tap the “**AI**” button.
- Describe the idea you want to create in the **text box**.
- Tap the “**Create**” button.
- Select a **filter** and adjust your image. Once you're done, tap “**Project**” to transfer the image to your paper.
- Start **sketching**!

3. Sketch Pictures:

- Tap the “**Camera**” button on the app. You will need to enable permissions for camera and/or photo gallery access.
- **Select an image** from your photo gallery or take your own using the in-app camera.
- Select a **filter** and use the slider to adjust it.
- Tap the “**Project**” button to transfer the image to the smART Sketcher® AI.
- Begin **sketching** your picture on the paper.

CONTROL BUTTONS

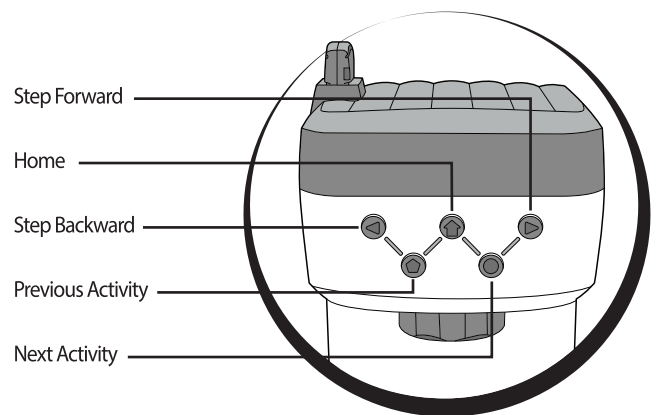

SAFETY INFORMATION

RADIO STATEMENT

Warning: Changes or modifications to this unit not expressly approved by the party responsible for compliance could void the user's authority to operate the equipment.

This device complies with Part 15 of the FCC Rules. Operation is subject to the following two conditions: (1) this device may not cause harmful interference, and (2) this device must accept any interference received, including interference that may cause undesired operation.

This device contains licence-exempt transmitter(s)/receiver(s) that comply with Innovation, Science and Economic Development Canada's licence-exempt RSS(s). Operation is subject to the following two conditions: (1) This device may not cause interference. (2) This device must accept any interference, including interference that may cause undesired operation of the device.

The antenna(s) used for this transmitter must be installed to provide a separation distance of at least 20 cm from all persons and must not be collocated or operating in conjunction with any other antenna or transmitter. End-Users must be provided with transmitter operation conditions for satisfying RF exposure compliance.

Note: This equipment has been tested and found to comply with the limits for a Class B digital device, pursuant to part 15 of the FCC Rules. These limits are designed to provide reasonable protection against harmful interference in a residential installation. This equipment generates, uses and can radiate radio frequency energy and, if not installed and used in accordance with the instructions, may cause harmful interference to radio communications. However, there is no guarantee that interference will not occur in a particular installation. If this equipment does cause harmful interference to radio or television reception, which can be determined by turning the equipment off and on, the user is encouraged to try to correct the interference by one or more of the following measures:

- Reorient or relocate the receiving antenna.
- Increase the separation between the equipment and receiver.
- Connect the equipment into an outlet on a circuit different from that to which the receiver is connected.
- Consult the dealer or an experienced radio/TV technician for help.

EXTERNAL POWER SUPPLY

Connect to an AC ADAPTER having output DC voltage rating of 5V DC and a minimum current rating of 2A 

The transformer, power supply used with the electric toy shall be regularly examined for damage to the supply cord, plug, enclosure or other parts, and in the event of damage, it shall not be used until the damage has been repaired.

WARNING!

DO NOT PLUG USB CABLE INTO A LAPTOP OR COMPUTER!



smART sketcher® is a trademark of Flycatcher Toys Inc. Copyright © 2025 Flycatcher Inc. All rights reserved. www.flycatcher.toys/smart-sketcher-ai

Manufactured by: Flycatcher Toys Inc. 1111B S Governors Ave STE 21691 Dover, DE 19904

For more detailed instructions, questions or problems, please visit: www.flycatcher.toys/smart-sketcher-ai/support