



Pomelo
Smart way to travel

P5

USER MANUAL



1. Overview of POMELO P5.....	1
1.1 P5	1
1.2 Remote Controller.....	2
2. Operation.....	3
2.1 Turn ON/OFF.....	4
2.2 Charging.....	4
2.3 Rematch/Reconnect Remote Controller with P5.....	5
2.4 Install / Remove Battery.....	5
3. LED & Buzzer Indicator.....	6
4. Product Parameters.....	7
5. Packing List.....	8
6. Riding Safely.....	8
7. After-sales information.....	9
8. Warranty Card.....	10

1. Overview of P5

1.1 P5

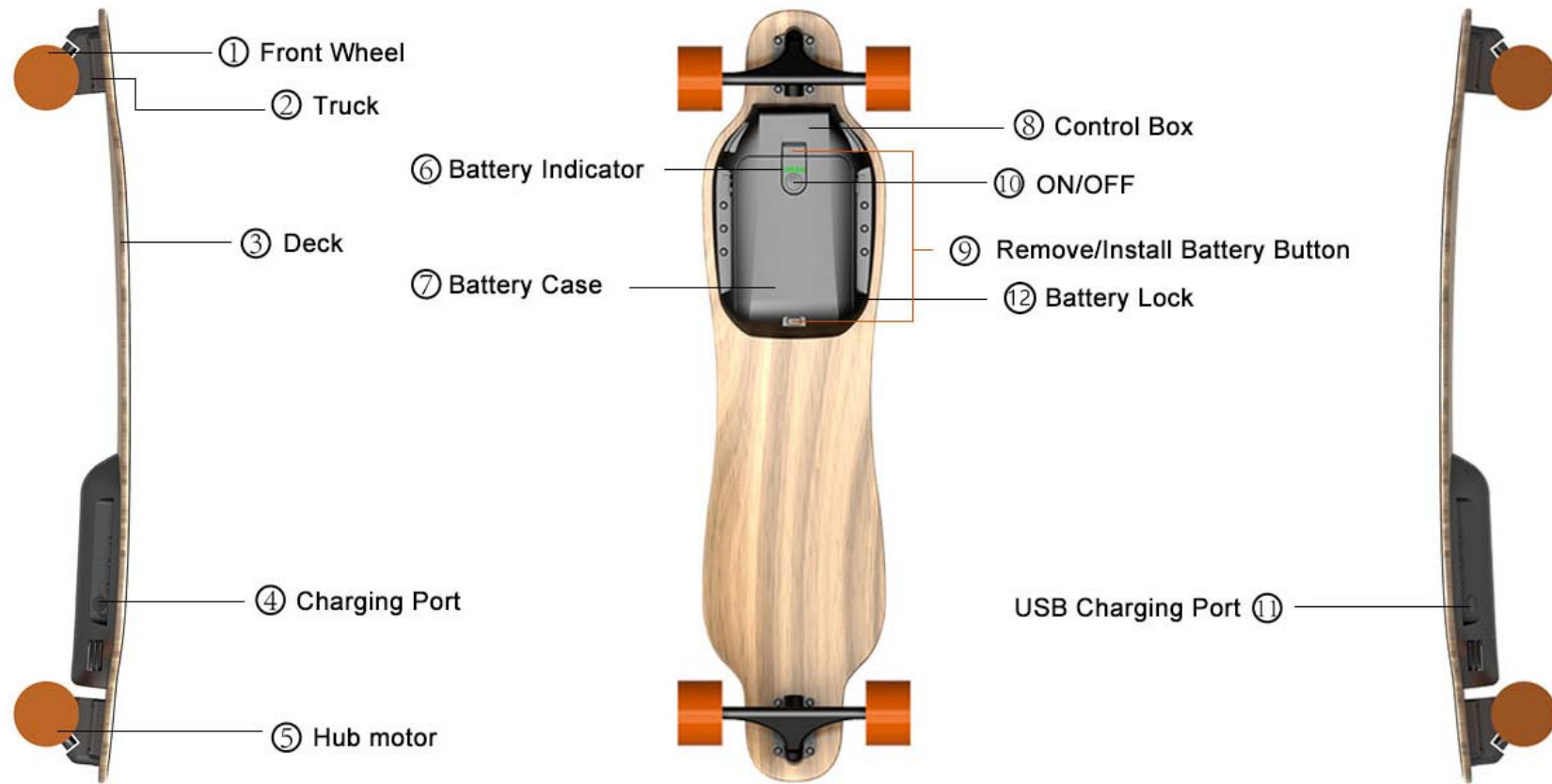

User Manual



Charger



Remote Controller



USB cable



Tool

1.2 Bluetooth Remote Controller



2. Operation

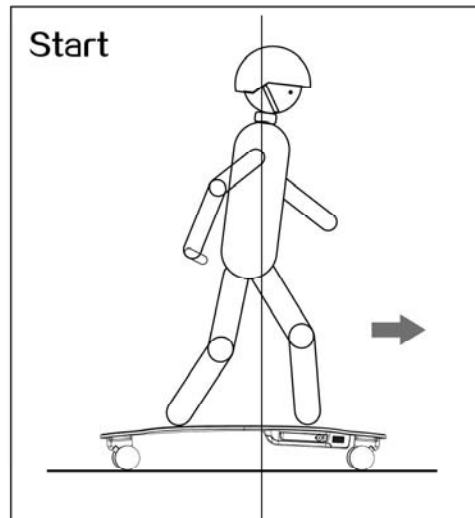

Turn on both P5 and remote controller. Slowly push the accelerator to check the moving direction, Then step on P5 and push the accelerator again to start.

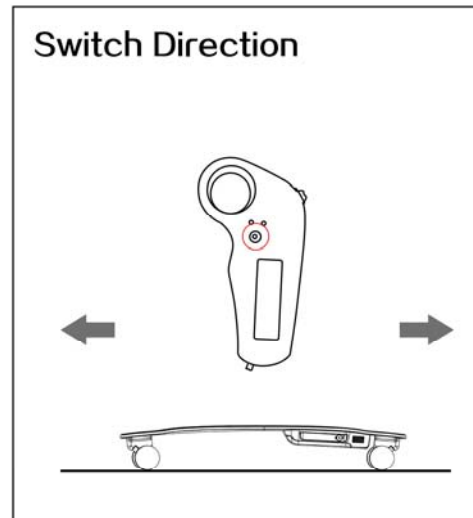

Press the switch direction button then push the accelerator to go forward.

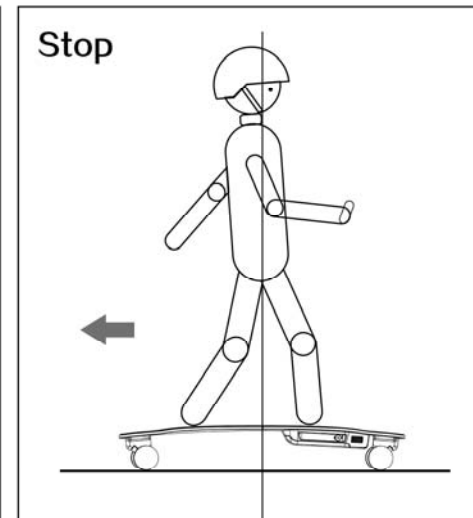

Press the switch direction button then push the accelerator to go forward.

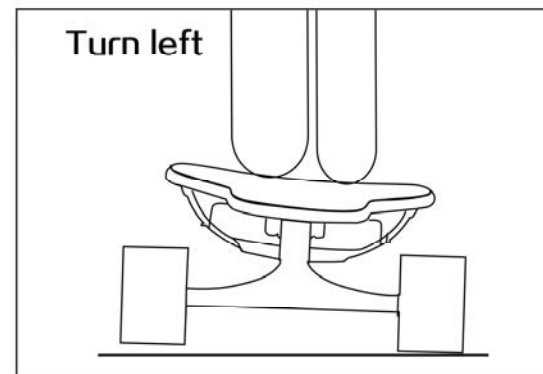
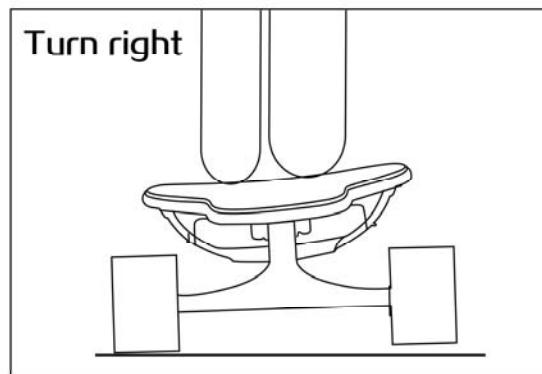

Tilt your body to the left side/right side to turn left/right.

2.1 Turn ON/OFF

⊙P5:

ON : Press the ⑩ON/OFF button about 5 seconds until ⑥Battery Indicator blinks.

OFF : Press the ⑩ON/OFF button on the back about 5 seconds until the red and green lights blink.

⊙Remote controller :

ON : Turn the ② ON/OFF button to left, ②Signal LED blink one time.

OFF : Turn the ② ON/OFF button to right, ②Signal LED off.

2.2 Charging

Please use the original charger only.

⊙P5:

Insert the charger cable to ④Charging Port, ⑥battery indicator lights on from red to green, turn green when full charged, which takes 2-3 hours.

☉ Remote controller:

4

Connect ⑦Charging Port with ⑦USB Charging Port. ⑦The Charging LED keeps turning red, light off when full, need 1.2hour.

Disclaimer: Must charge and discharge every two months, otherwise battery will be out of work, Supplier won't take responsibility for that.

2.3 Rematch/Reconnect Remote Controller with P5

Rematch with P5 each time you change a new remote controller.

Turn on P5, press ⑩ON/OFF button three times, ⑥Battery Indicator blinks red and green, matching need 20 seconds. Then turn on the remote controller, use tools to press the ⑦Rematch Button 1 time. The ⑦Signal LED will blink if succeed, otherwise failed.

2.4 Install / Remove Battery



3. LED&Buzzer Indicator

Remote Controller

Situation	LED
Turn ON/OFF	Signal LED blinks one time
Matching with skateboard	Signal LED blinks by 0.5 second a

	time
Charging	Charging LED turns on , off once full
Situation	Buzzer
ON	Beeps one time
Battery low voltage	Beeps continue

POMELO P5

Situation	Battery LED
Turn ON/OFF	Battery LED blink 2 seconds
Charging	Green lights
Matching	Battery LED blink 20 seconds
Situation	Buzzer
Turn ON/OFF	Beep one time
Battery low voltage	beeps continue

4. Product Parameters

Name	Parameters	Notes
Dimension of the P5	Length : 99cm Width : 27cm Height : 14cm	
Dimension of package	Length : 103.5cm	

	Width : 31cm Height : 17cm	
N.W	7.5kg	
G.W	10kg	
Max speed	30km/h(PRO mode) ,12km/h(Beginner mode)	
Mileage	20km	Riders weight 80kg on smooth road
Max climbing Angle	17° (30%)	Load 80kg
Max Load	120kg	
Material of the deck	bamboo+glass fiber	
Battery Capacity	208.8wh	Extendable and Removable
Charging time	2h	
Charger	AC110-240V 50-60Hz	
Remote control battery capacity	0.9wh	
Remote control charging time	0.2h	
Remote control charge cable	USB 5V/1A	
Motor Power	160w*2 (MAX: 432W*2)	
Wheel size	diameter : 90mm , width:52mm	Four wheels are same
Working temperature	-10°C~40°C	10°C-30°Crecommended

5. Packing List

Pomelo P5	1	Charger	1
Remote controller	1	User Manual/Warranty card	1
USB cable	1	Tool	1

6. Riding Safely

Please well know about following precautions before using.

Attention:

1. Please keep your body balance during riding. Don't hit the brake at a high speed which may cause injury.
2. Please practice P5 at low speed in the open place if you're a new player.
3. Please bear in mind that leave enough time and distance to avoid obstacles and others when you are riding P5.
4. One rider only when riding P5.
5. Please wear protective equipment before you ride such as helmets, knee pads, elbow pads, eye wear, etc.
6. Don't ride P5 in heavy traffics or crowed public place.
7. Prohibit riding P5 on bumpy or wet pavements.
8. Prohibit riding on the ramp over 17°.
10. Prohibit teenagers less than 15 years old and people over 60 years old learning and riding P5. Teenager should use P5 with adult companion.
11. Prohibit those people riding the board after drinking alcohol.
12. Prohibit riding it in rainy days.
13. Don't ride it if self-reasons or other objective factors affect rider not able for riding.

7. After-sales information

Please keep the warranty card and purchase voucher.

Warranty & After sales service

- 1, One year warranty, except the battery and consumables.
- 2, Warranty of Battery and charger is 6 months, and one month for the USB cable.

The following conditions are not included in warranty & after sales service:

- 1, If the user doesn't follow guidance in user manual.
- 2, Damage cause by rider's wrong maintenance actions
- 3, The user is not suitable for riding or traffic accidents caused.
- 4, There is no warranty card and shopping vouchers, or P5s and warranty cards contradictory.
- 5, Don't belong to the scope of the warranty.
- 6, Riding in rain or water for a long time.

8. Warranty Card

Record of extended warranty

Part Name		Start of extended warranty		Extended Period	
-----------	--	----------------------------	--	-----------------	--

Part Name		Start of extended warranty		Extended Period	
Part Name		Start of extended warranty		Extended Period	

Please refer to the Freefeet official website for latest info update

User info

Name:_____Tel: _____Email:_____

Address:_____

Products Info

Model:_____Service center: _____

Repair date:_____

Repair details:_____

Cause of Malfunction: _____

S/N:_____

Signature of the repairman:_____

Seal of the service center

After sales info

Please contact after sales service through information from below or visit our official website for the address of the service center and other related information.

Freefeet Technology., Co Ltd.

Website: www.efreefeet.com

Email: aftersales1@efreefeet.com

§ 15.19 Labelling requirements.

This device complies with part 15 of the FCC Rules. Operation is subject to the following two conditions: (1) This device may not cause harmful interference, and (2) this device must accept any interference received, including interference that may cause undesired operation.

§ 15.21 Information to user.

Any Changes or modifications not expressly approved by the party responsible for compliance could void the user's authority to operate the equipment.

§ 15.105 Information to the user.

12

Note: This equipment has been tested and found to comply with the limits for a Class B digital device, pursuant to part 15 of the FCC Rules. These limits are designed to provide reasonable protection against harmful interference in a residential installation. This equipment generates uses and can radiate radio frequency energy and, if not installed and used in accordance with the instructions, may cause harmful interference to radio communications. However, there is no guarantee that interference will not occur in a particular installation. If this equipment does cause harmful interference to radio or television reception, which can be determined by turning the equipment off and on, the user is encouraged to try to correct the interference by one or more of the following measures:

- Reorient or relocate the receiving antenna.
- Increase the separation between the equipment and receiver.
- Connect the equipment into an outlet on a circuit different from that to which the receiver is connected.
- Consult the dealer or an experienced radio/TV technician for help.

13

*** RF warning for Portable device:**

The device has been evaluated to meet general RF exposure requirement. The device can be used in portable exposure condition without restriction.