

# Heart Care Manual

Hartcall Design E

---



**MICRO<sup>®</sup>**  
Micro Medi Inc.

# **Table of Contents**

## **1.Explanation of equipment**

- Power on/off
- How to charge
- How to attach

## **2.The App's operation and connect to ECG**

# 1.Explanation of equipment

## 1) Power on/off

- Change on the power switch to on.



- When the power is turned on, the blues LED lights up on the front side.



- When the power is turned off, the blue LED light

goes off.

## 2) How to charge

- Turn off the power switch.



- Plug in a 5-pin (same as a smartphone recharger) cable to charge





-During charging, the red LED is displayed on the right side of the front. And the LED will be off when the battery is fully charged.



### 3)How to attach

- Tighten the medical patch as shown the pictures.

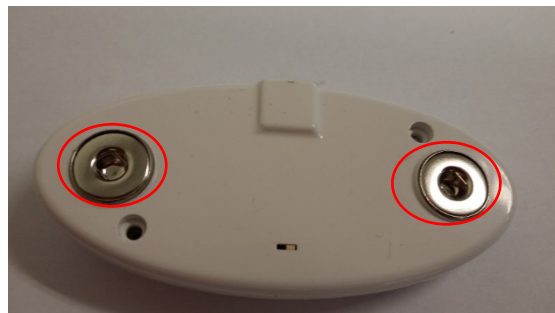

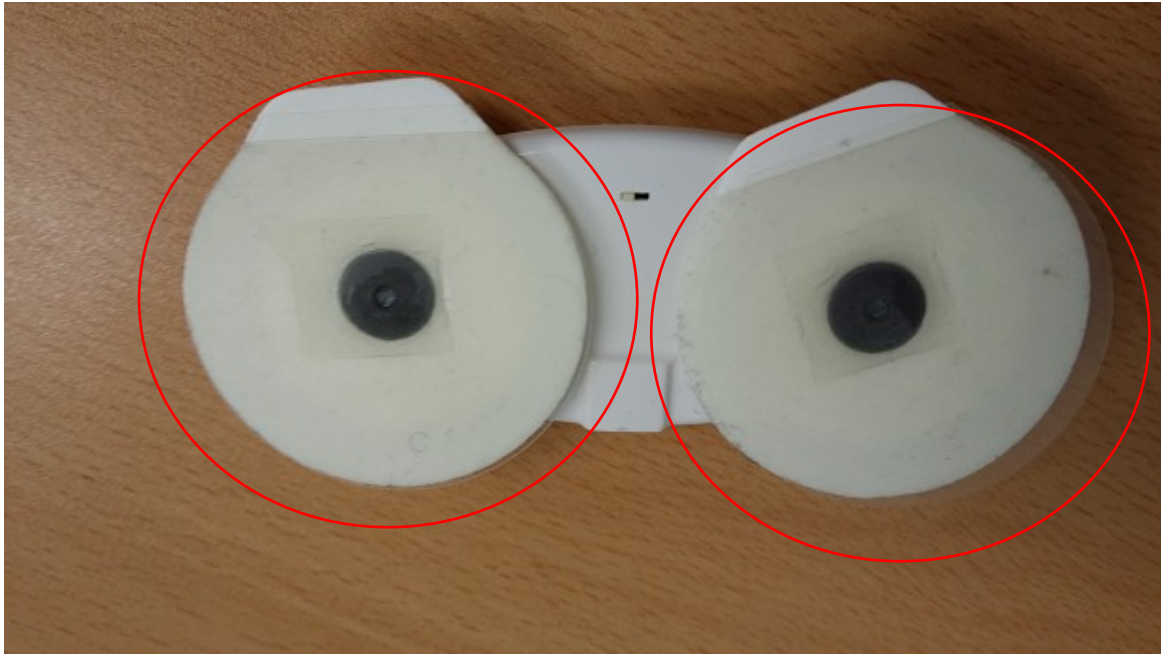

- Attach on a left upper chest with the charging terminal of the device faced down.

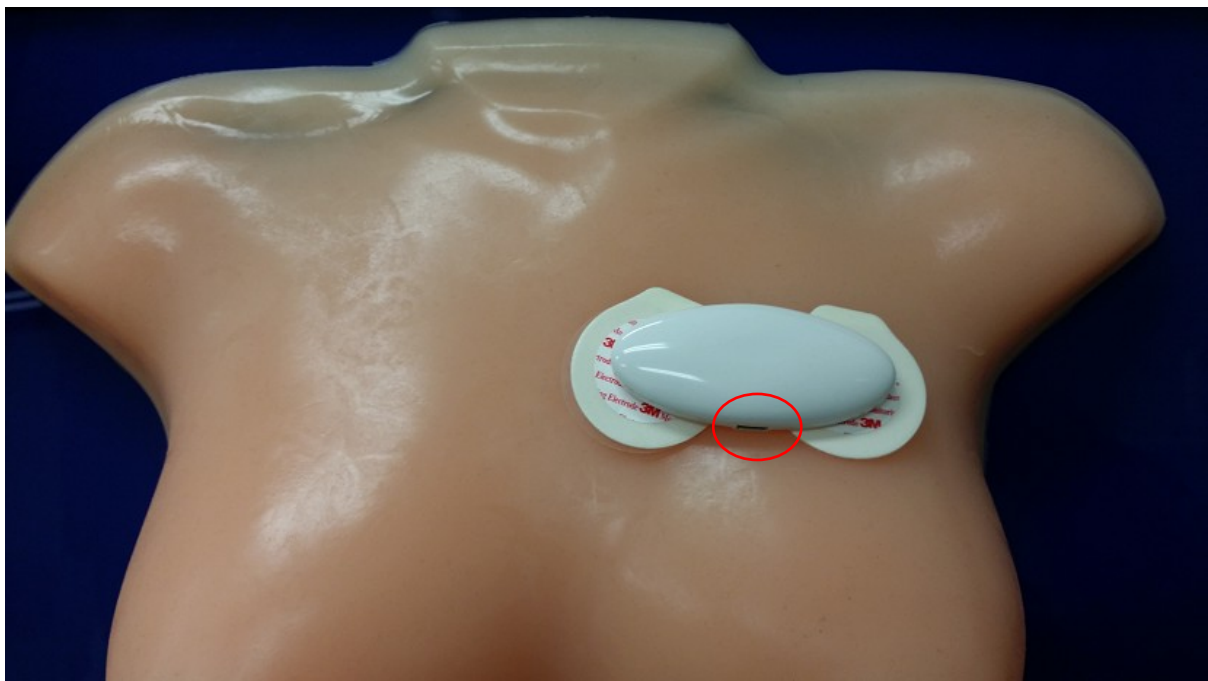

## 2.The App's operation and connect to ECG

### 1)Install the Heart Care App.

- Please confirm that it is V 0.1.4 version.
- The App is going to be registered on App store later.

### 2)Change the power switch to the "ON" state.

- Make sure the blue LED is on

### 3)Start the App.

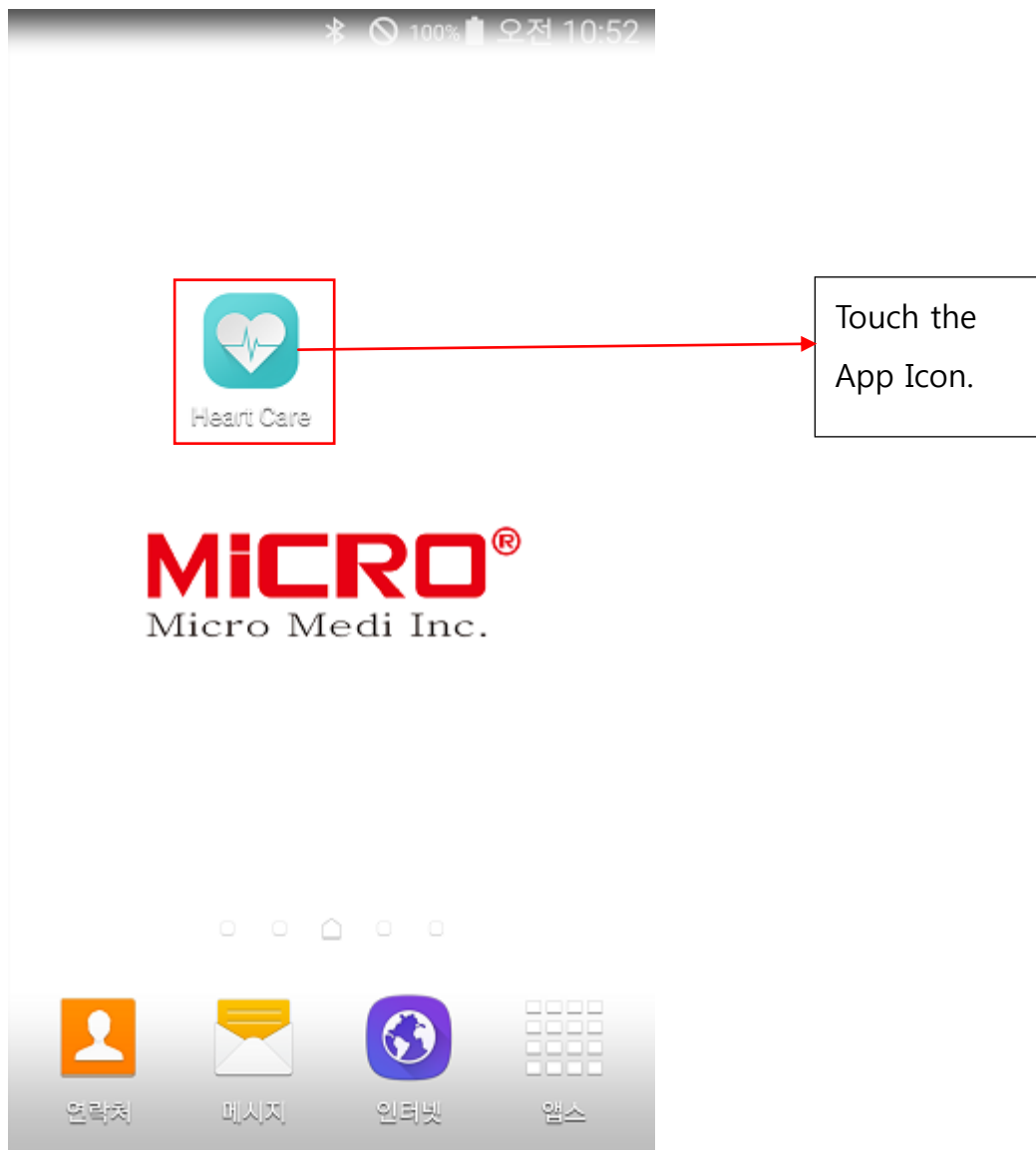

4) Automatically retrieves Heart Care as you run the App.

If the search fails, press the connection button in the center.

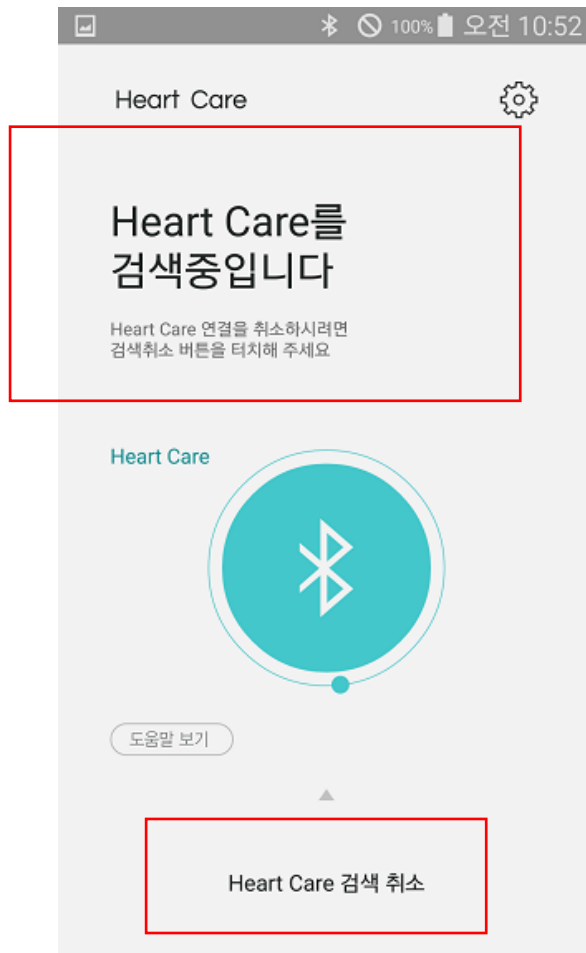

<Searching Screen>  
screen>

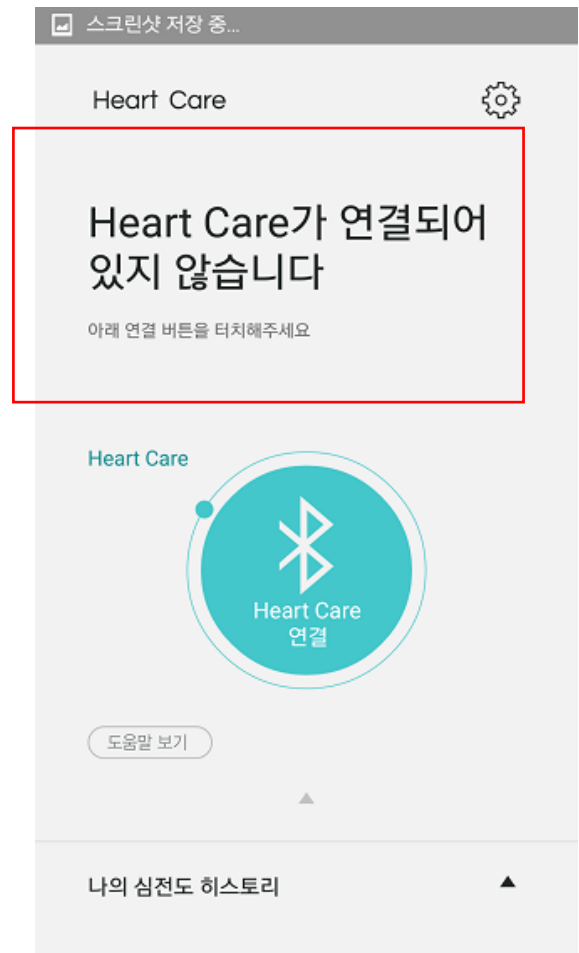

<searching failure  
screen>



5)The App and Heart Care are successfully connected.

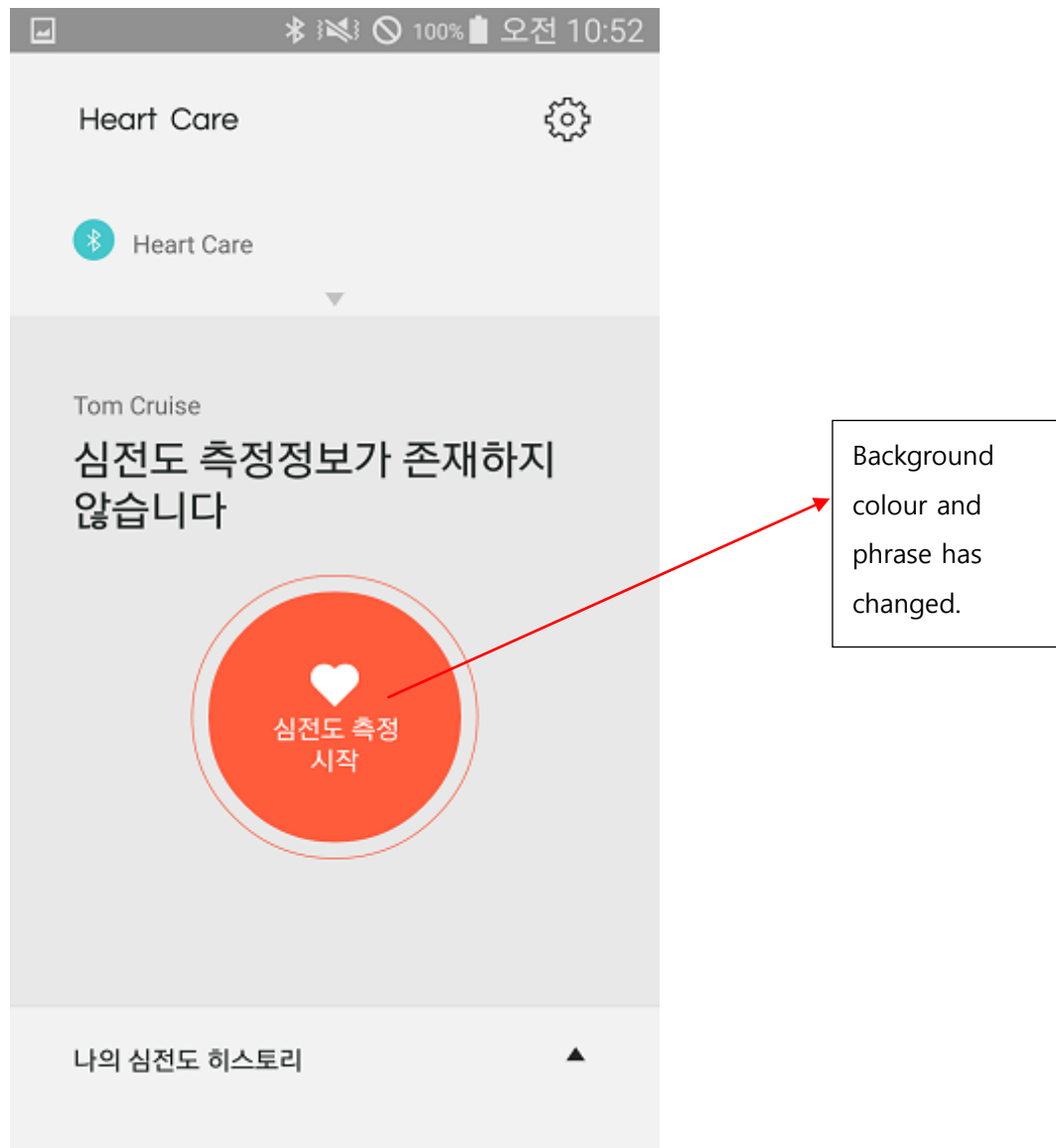

6)Press the ECG measurement start button

7) ECG graph appears on the screen.

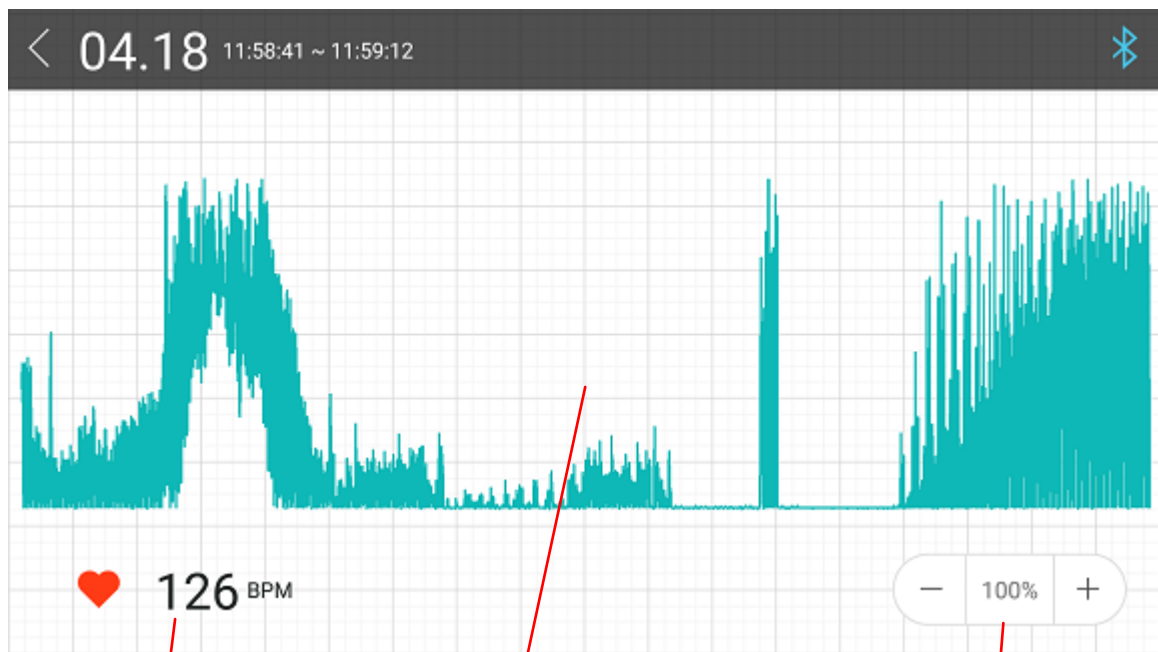

displays the  
heart rate  
per minute.

The ECG graph flows  
in real time.

The ECG graph is enlarged  
and reduced in 100 units  
from 100 to 1000%.

- 8) After the measurement has completed, go back to the previous screen and touch the 'My ECG History'. You can see the measured ECG again.

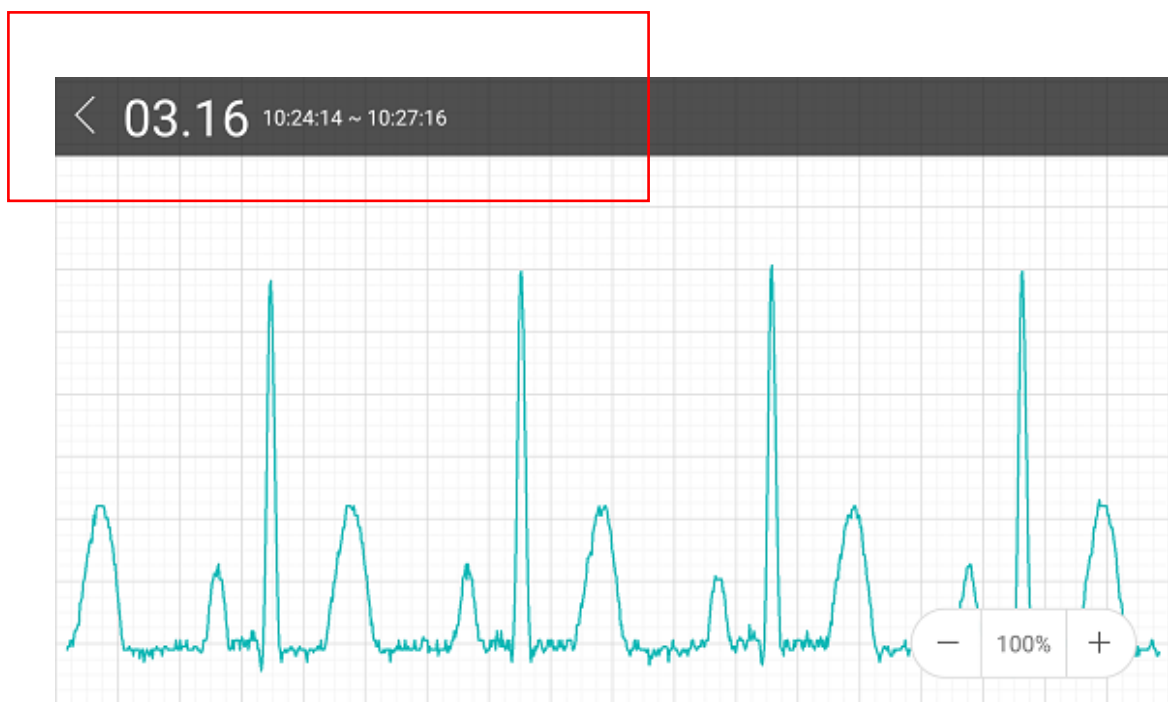
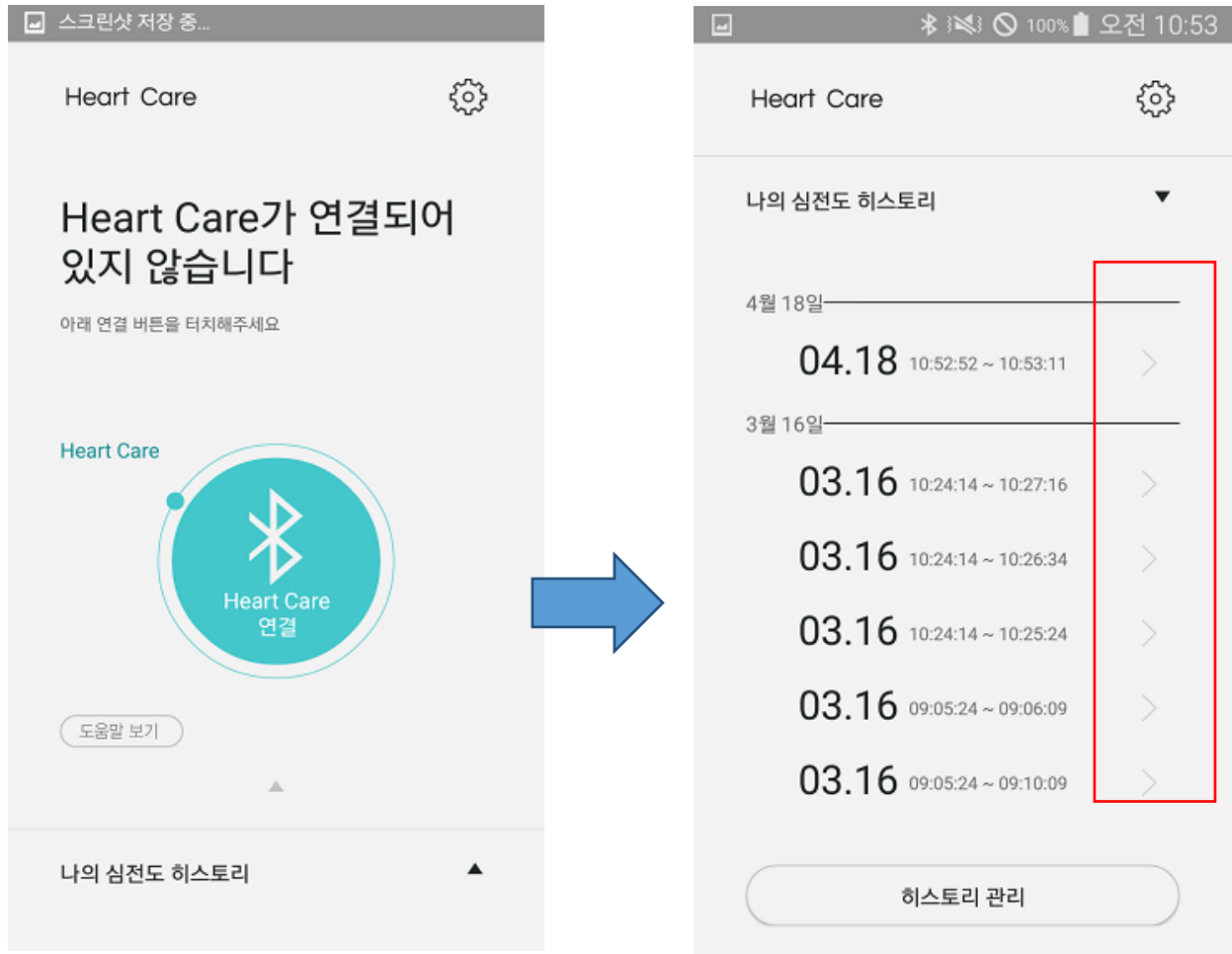

## **Approval Information**

### **FCC compliance Information**

#### **FCC Information to User**

This equipment has been tested and found to comply with the limits for a Class B digital device, pursuant to Part 15 of the FCC Rules. These limits are designed to provide reasonable protection against harmful interference in a residential installation. This equipment generates, uses and can radiate radio frequency energy and, if not installed and used in accordance with the instructions, may cause harmful interference to radio communications. However, there is no guarantee that interference will not occur in a particular installation. If this equipment does cause harmful interference to radio or television reception, which can be determined by turning the equipment off and on, the user is encouraged to try to correct the interference by one of the following measures:

- Reorient or relocate the receiving antenna.
- Increase the separation between the equipment and receiver.
- Connect the equipment into an outlet on a circuit different from that to which the receiver is connected.
- Consult the dealer or an experienced radio/TV technician for help.

#### **Caution**

Modifications not expressly approved by the party responsible for compliance could void the user's authority to operate the equipment.

**FCC Compliance Information** : This device complies with Part 15 of the FCC Rules. Operation is subject to the following two conditions: (1) This device may not cause harmful interference, and (2) this device must accept any interference received, including interference that may cause undesired operation  
Including interference that may cause undesired operation. Modifications not expressly approved by the manufacturer could void the user's authority To operated the equipment under FCC rules. To satisfy FCC exterior labeling requirements, the following text must be placed on the exterior of the end product.

**Contains Transmitter Module FCC ID : 2AMNDheartcare**

**CAUTION : This device and its antenna(s) must not be co-located or operated in conjunction with any other antenna or transmitter. End users cannot modify this transmitter device. Any unauthorized modification could void the user's authority to operate this device.**