



USB THIN BEAM - PHONE CONTROL

PART #: 78540

⚠ WARNING: THE FAILURE TO FOLLOW THESE INSTRUCTIONS WHEN INSTALLING THE USB THIN BEAM - PHONE CONTROL MAY CAUSE ELECTRIC PROBLEMS IN YOUR VEHICLE WHICH COULD CAUSE VEHICLE DAMAGE, ELECTRICAL SYSTEM DAMAGE, FIRE, ELECTRICAL SHOCK, PERSONAL INJURY OR DEATH.

⚠ WARNING: DO NOT LOOK DIRECTLY INTO THE USB THIN BEAM - PHONE CONTROL. DO NOT DRIVE OR POSITION YOUR VEHICLE NEAR ON ROAD TRAFFIC WHEN THE USB THIN BEAM - PHONE CONTROL IS POWERED ON – DOING SO MAY RESULT IN VISION IMPAIRMENT AND OR VEHICULAR COLLISION. THE INTENDED USE OF THE USB THIN BEAM - PHONE CONTROL IS TO PROVIDE EXTERIOR AUXILIARY LIGHTING FOR OFF ROAD USE ONLY. THIS PRODUCT IS NOT DOT APPROVED.

INSTALLATION GUIDELINE

⚠ WARNING: SAFETY GLASSES MUST BE USED WHEN INSTALLING THIS PRODUCT.

USB Thin Beam - Phone Control is an interior auxiliary light designed to provide auxiliary lighting while driving off road. USB Thin Beam - Phone Control has a distinct amperage draw noted in the installation instructions. If you are not confident in your ability to install the USB Thin Beam - Phone Control please consult a licensed mechanic.

USB Thin Beam - Phone Control has specific voltage and amperage ratings for power input and amperage draw. ENSURE THESE RATINGS ARE FOLLOWED. USB Thin Beam - Phone Control must be installed in a properly functioning electrical system. Do not install this product in a malfunctioning electrical system.

Select a mounting location that will not obstruct the operation of instruments or any vehicle functions

Clean mounting surfaces with isopropyl alcohol (70%) and wait for the surface to dry before proceeding.

Before permanently mounting to vehicle, test fit to ensure wiring is long enough to be safely installed and does not obstruct any operating functions of the vehicle. These lights should not be installed where their operation hinders the visibility of the driver or other drivers

⚠ WARNING: DURING OPERATION LIGHTING UNITS CAN GET HOT - DO NOT TOUCH WHILE OPERATIONAL OR WITHIN 30 MINUTES OF POWERING DOWN.

Before disconnecting battery terminals, please check your owner's manual for proper procedure

⚠ WARNING: Cancer and Reproductive Harm - www.P65Warnings.ca.gov

ALPENA® LIMITED WARRANTY

This Limited Warranty covers defects in materials or workmanship of this product for one (1) year from the date of purchase. Normal wear and tear over time are not product defects. Product problems caused by not following the product instructions, abuse, misuse, alteration, accident and/or use beyond the product's intended purpose are not covered. This warranty is valid for the original owner and is not transferable. Proof of purchase is required.

Any implied warranties and conditions, such as merchantability and fitness for a particular purpose are hereby excluded, or if not excludable under law, are limited to one (1) year period. Some jurisdictions do not allow limitations on how long an implied warranty lasts, so this limitation may not apply to you

NO INCIDENTAL, CONSEQUENTIAL OR SPECIAL DAMAGES ARE RECOVERABLE. SOME JURISDICTIONS DO NOT ALLOW THE EXCLUSION OF INCIDENTAL, CONSEQUENTIAL OR SPECIAL DAMAGES, SO THE ABOVE LIMITATION OR EXCLUSION MAY NOT APPLY TO YOU. THIS WARRANTY GIVES YOU SPECIFIC LEGAL RIGHTS AND YOU MAY HAVE OTHER RIGHTS WHICH VARY DEPENDING ON THE JURISDICTION.

We will replace any product we determine to be defective provided you follow our product return directions. Please note that replacement product may not be exact due to style changes to our products. We will cover the mailing expense to send you a replacement product. However, mailing costs to return to us the original product which is claimed to be defective must be paid by you. If a replacement product is not available at the time you submit your warranty request, we will issue a credit.

For warranty service, please see below.

Problems? We can solve them!

NORTH AMERICAN
SUPPORT AVAILABLE



@AlpenaAutomotive
1-800-387-3217

Marklyn Group Inc, 753011 2nd line EHS Mono, ON, Canada L9W 5W4
Alpena® is a registered trademark of Marklyn Group Inc. © Copyright 2024
Made in China

STEP 1

CHOOSE LIGHTING STRIP MOUNTING LOCATION

Determine the installation location for the LED strip; ideal spots include dashboard gaps, center console, or footwell areas. Long, sweeping locations and straight sections work best. Avoid sharply folding the strip to prevent damage.



NOTE: Do not bend the LED strips in a radius of less than 5/8" (15mm) or circuit traces will be damaged and void warranty.

STEP 2

CUTTING TO SIZE (IF REQUIRED)

Cut strip to your desired size if needed with scissors or side cutters as shown. Caution once the strip is cut the extra section cannot be add, measure twice before cutting.

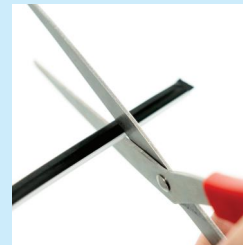

STEP 3

MOUNTING THE STRIP INTO PANEL GAPS

The LED strip can be installed into panel gaps without using the peel-and-stick tape provided. Use the supplied tool to help with installation. Note that the strip cannot be folded on itself or sharply bent. For other locations, you will need to use the peel-and-stick adhesive. See Step 4 for more information.



STEP 4

MOUNTING THE STRIP USING PEEL-AND-STICK ADHESIVE

Grab the roll of peel-and-stick adhesive from the box and apply the tape to the side of the strip the you want to mount.

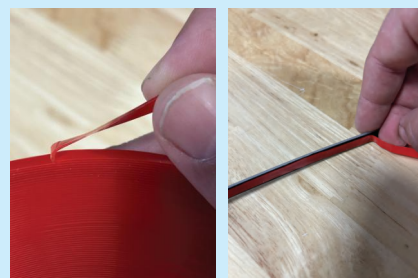

STEP 5

ROUTING WIRES & POWERING UP

Run the wires so that vehicle operation is not interfered with directly to your USB 5V or USB-C outlet. If you need USB-C use the supplied **adapter** to convert the plug to use the LED strip.

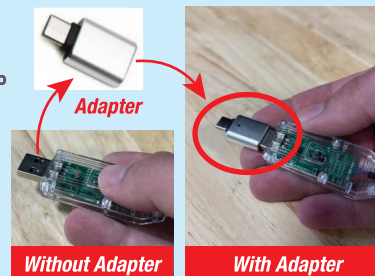

STEP 6

CONTROLLING STRIP FUNCTION

Download "Alpena Auto" phone control with the below QR codes for both Apple App store or Google play store.



You can also cycle through many of functions using the button on the USB 5V plug.

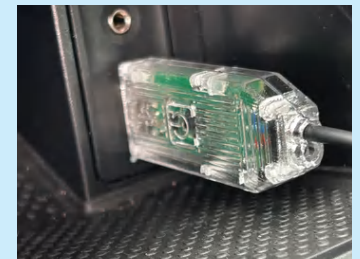

Federal Communications Commission (FCC) Interference Statement

FCC ID: 2AMN5-78540

This equipment has been tested and found to comply with the limits for a Class B digital device, pursuant to Part 15 of the FCC Rules.

These limits are designed to provide reasonable protection against harmful interference in a residential installation. This equipment generates, uses and can radiate radio frequency energy and, if not installed and used in accordance with the instructions, may cause harmful interference to radio communications.

There is no guarantee that interference will not occur in a particular installation. If this equipment does cause harmful interference to radio or television reception, which can be determined by turning the equipment off and on, the user is encouraged to try to correct the interference by one of the following measures:

- Reorient or relocate the receiving antenna
- Increase the separation between the equipment and receiver
- Connect the equipment into an outlet on a circuit different from that to which the receiver is connected
- Consult the dealer or an experienced radio/TV technician for help

This device complies with Part 15 of the FCC Rules. Operation is subject to the following two conditions:

(1) This device may not cause harmful interference, and (2) this device must accept any interference received, including interference that may cause undesired operation.

FCC Caution: Any changes or modifications not expressly approved by the party responsible for compliance could void the user's authority to operate this equipment.

RF exposure warning

This equipment complies with FCC radiation exposure limits set forth for an uncontrolled environment.

The equipment must not be co-located or operating in conjunction with any other antenna or transmitter.