

MB Wireless Digital Speaker Setup Guide

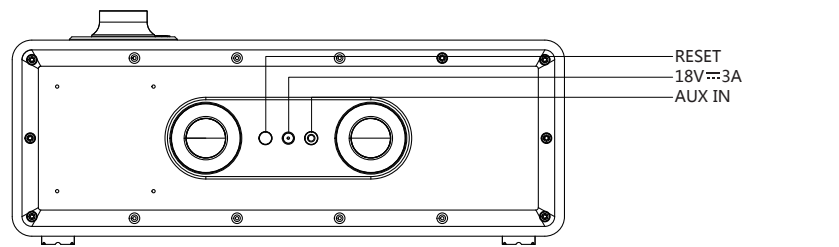

www.ggmm.com

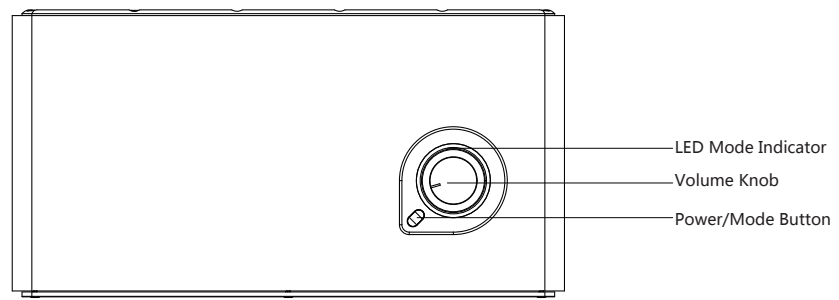
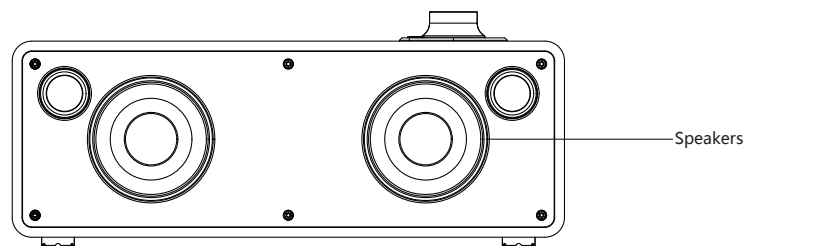

M3 Wireless Digital Speaker Box Content

M3 + AC power adaptor + AUX audio cable + Setup Guide + Warranty card

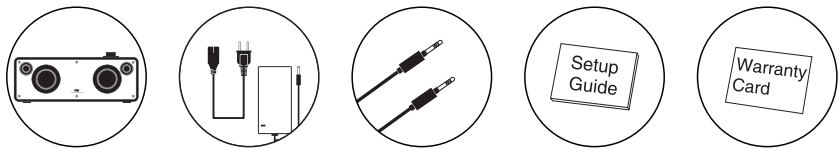

Top Button Function

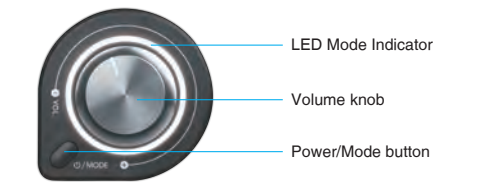

Power/Mode Button:
- Press and Hold the Power/Mode button for 3 seconds to power your speaker on and off.
- Press the Power/Mode button to switch the audio input modes: Wi-Fi/Bluetooth/AUX.
Volume knob:
Turn the knob clockwise to increase volume; turn the knob counter clockwise to decrease volume.

Back Button Control



Reset:
Hold and press the Reset button for 3 seconds or until the mode light turns off. This will reset your product to Wi-Fi factory default settings.

M3 LED Mode Indicators

Indicator Color	Status	Description
Purple	Solid	Processing to Wi-Fi Mode
Blue	Solid	Wi-Fi Connection Ready
Red	Flashing	Wi-Fi Mode failed to connect
White	Flashing	Processing Bluetooth Setup, waiting for the connection of external device
	Solid	Bluetooth Connection Mode
Green	Solid	AUX Connection mode

Setup Guide

Step 1: Take out M3 and accessories, please connect the power adaptor, press and hold down the Power/Mode button for 3 seconds to turn on the speaker.
Step 2: Press the Power/Mode button to choose the music source (Wi-Fi→Bluetooth→AUX).

Wi-Fi Mode

Press Power/Mode button - the MODE LED will flash purple for 3-5 seconds, then change to BLUE; it is now in Wi-Fi Mode.
Please Note: Avoid using the speaker in a complicated public Wi-Fi network environment (e.g., office, airport and hotel), as this may lead to an unstable connection (play buffer, connection failure, etc.)

Two modes are available to play music wirelessly with M3: Router Mode (Standard Mode) and Direct Mode (Optional Mode).

Router Mode (Standard Mode): Router Mode is recommended in a Wi-Fi environment, in which both local and online music can be played. Once Router Mode is successfully set, all devices (e.g., your smart phone, tablet PC, PC, MAC, etc.) within the same Wi-Fi network can directly play music without having to repeatedly log in and out.



Direct Mode (Optional Mode): Use Direct Mode in a non-Wi-Fi environment. Wireless local music play can be realized after successful point-to-point connection, but streaming from online sources will generate cellular mobile network data flow.



Router Mode (Standard Mode)

For iOS users: Download the GGMM Music app from Apple App Store onto your compatible iOS device; or scan the QR code to download and install the GGMM Music app.
For Android users: Download the GGMM Music app from Google play onto your compatible Android device; or scan the QRcode to download and install GGMM Music app.



Open the app by tapping on the icon. Follow the prompts in the app to continue pairing your smart device to M3.

Scan the QR code to download and install GGMM Music App

iOS client



Android client



For Mac OS users: Please visit www.ggmm.com to download setup instructions, after setup is complete, you can play music through iTunes. When streaming from other music source, you can use AirPlay to wirelessly play your music.



For Windows PC users: Please visit www.ggmm.com to download setup instructions.

Direct Mode (Optional Mode):

Boot your device (smart phone, tablet PC, PC, MAC, etc.) and then enter Wi-Fi settings. Enable Wi-Fi and connect to the network marked as "GGMM_M3_XXX". After connection, users with different operating systems may operate according to the steps below:

Please Note: After the successful connection of iOS device, a symbol "✓" will appear in front of Wi-Fi signal icon and Wi-Fi icon will no longer appear on the status bar.

For iOS users: No need to download any app. You can operate directly with AirPlay
For users with system version above IOS 7.0: To play music wirelessly, slide the screen from bottom to top with your finger to enable AirPlay and then select GGMM_M3_XXX.

Please Note: Turn up the mobile phone or tablet PC in priority when wirelessly playing music.

(iPhone as example)



Setting AirPlay Choose GGMM_M3_XXX

For Android users: No need to download any app. Please use the 'Cast' button in the built-in music jukebox of your smart phone or tablet to wirelessly play your music.

(SAMSUNG as example)



Setting DLNA, Choose GGMM_M3_XXX

(HTC as example)



(SONY as example)



Android users: May also use the third party DLNA music player. The following recommended players can be downloaded in the Google Play store or other Android application markets.

Please note: If the built-in media player doesn't work due to the difference in phones or application versions, please use the third party DLNA music player.



For Mac OS users: Use iTunes to push music, When using other music players, you may use AirPlay to wirelessly play your music.

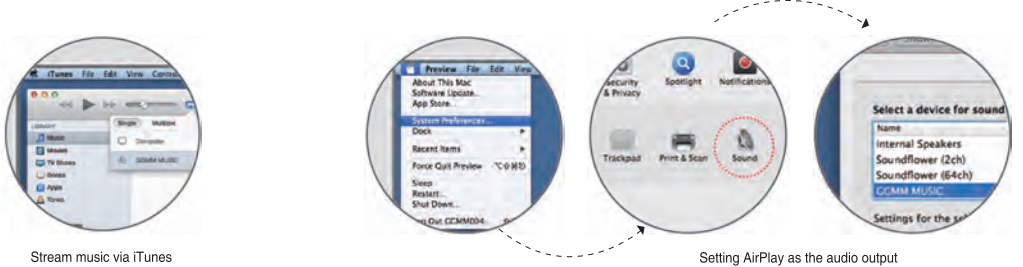

For Windows PC users: Please go to GGMM's official website www.ggmm.com to download a dedicated music player.

Bluetooth Mode:

Press Power/Mode button - the MODE LED will flash white and Bluetooth Mode is now on. In your device settings, turn Bluetooth ON. Connect to 'GGMM_M3' open your music player and press play. (iPhone as example)

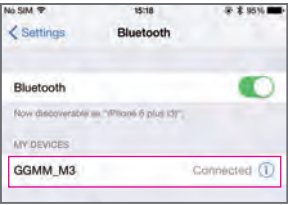

AUX Mode:

Press Power/Mode button - the MODE LED will turn solid green, and it is now in AUX Mode. Connect your device to the speaker with the AUX cable, open your player and play your music.

Multi-room Play in Wi-Fi mode

Please Note: "GGMM MUSIC" app is required to set up.

Multiple M3 units can be connected in Wi-Fi mode; you can also set up multiple M3 in different rooms to play the same music.

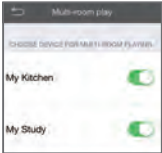

Setting up M3 L/R channels in Wi-Fi mode

Please Note: "GGMM MUSIC" app is required for set up.

When you use two M3 units in Wi-Fi mode, you can set up the M3 as individual 'L' (left) channel and 'R' (right) channel to get wider range of the stereo effect.

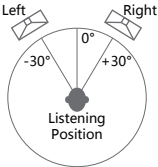

FCC Warning:

This equipment has been tested and found to comply with the limits for a Class B digital device, pursuant to part 15 of the FCC Rules. These limits are designed to provide reasonable protection against harmful interference in a residential installation. This equipment generates, uses and can radiate radio frequency energy and, if not installed and used in accordance with the instructions, may cause harmful interference to radio communications. However, there is no guarantee that interference will not occur in a particular installation. If this equipment does cause harmful interference to radio or television reception, which can be determined by turning the equipment off and on, the user is encouraged to try to correct the interference by one or more of the following measures:

- o Reorient or relocate the receiving antenna.
- o Increase the separation between the equipment and receiver.
- o Connect the equipment into an outlet on a circuit different from that to which the receiver is connected.

o Consult the dealer or an experienced radio/TV technician for help.

Caution: Any changes or modifications to this device not explicitly approved by manufacturer could void your authority to operate this equipment.

This device complies with part 15 of the FCC Rules. Operation is subject to the following two conditions: (1) This device may not cause harmful interference, and (2) this device must accept any interference received, including interference that may cause undesired operation.

To comply with FCC RF exposure compliance requirements, this grant is applicable to only mobile configurations. The antennas used for this transmitter must be installed to provide a separation distance of at least 20 cm from all persons and must not be co-located or operating in conjunction with any other antenna or transmitter.

AirPlay: Please go to Apple's official website <http://www.apple.com/airplay> for more information.

DLNA: Please go to <http://en.wikipedia.org/wiki/DLNA> for more information.

Wi-Fi is a registered trademark of the Wi-Fi Alliance.
Bluetooth is a registered trademark of the Bluetooth SIG, Inc.
Airplay is a registered trademark of Apple Inc.