

billboard

 Bluetooth

BC

- ① VOLUME UP BUTTON
 - ② POWER ON BUTTON
 - ③ VOLUME DOWN BUTTON
 - ④ LED INDICATOR
 - ⑤ AUX-IN JACK
 - ⑥ MICROPHONE
 - ⑦ TYPE-C CHARGING PORT
 - ⑧ ANC ON/OFF SWITCH

- 1 Insert the USB TYPE-C plug end into the charging port located on the headphones.
- 2 Insert the USB charging plug end into a USB port of a computer or suitable USB charging adapter.
- 3 The LED indicator will turn **RED** while the headphones are charging. The LED indicator will turn **BLUE** when charging is complete.

- Remove the charging cable once charging is complete.
- Overcharging could reduce the life of the battery.
- A charged battery will lose its capacity if it is not used on a regular basis.
- To avoid a complete discharge of the battery, charge your headphones at least once every six months.

① Press & hold the **POWER BUTTON** for **3 SECONDS** to turn headphones on

- 1 The LED indicator will flash **RED & BLUE** indicating the headphones are in pairing mode.
- 2 Open up your smart device. Under **BLUETOOTH** settings, search and select "**BB-BT-HP**"

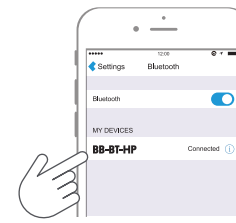

- 3 The LED indicator will slowly flash a **BLUE** light indicating the headphones are paired with your smart device.

- PRESS TO PLAY OR PAUSE
- PRESS TO ANSWER OR END PHONE CALLS
- PRESS AND HOLD TO DECLINE AN INCOMING CALL
- Double press to call back the last number
- THREE PRESS TO ACTIVATE THE Siri OR GOOGLE VOICE ASSISTANT



- PRESS TO INCREASE THE VOLUME
- PRESS AND HOLD TO GO TO THE NEXT TRACK



- PRESS TO DECREASE THE VOLUME
- PRESS AND HOLD TO GO TO THE PREVIOUS TRACK

The **ACTIVE NOISE CANCELLING** function reduces distracting background noise to provide clear sound in loud environments. You can use ANC mode alone or in combination with playing music via **BLUETOOTH**.

To turn on the Active Noise Cancelling mode, slide the ANC switch button to the ON position. The LED indicator light will turn **GREEN**.

Slide the ANC button to the OFF position to turn it off.

Insert the auxiliary cable into the AUX-IN JACK to listen to music from another device. Your headphones will automatically turn on AUX MODE.

Note:
You can play music through AUX MODE when your headphone battery is low or depleted, or the device you want to listen to does not utilize Bluetooth, although headphone functions and controls will be unresponsive.

When using your Headphones, basic safety precautions should always be followed including:

- Read all instructions before using your headphones.
- Do not submerge your headphones in water or place on wet surfaces.
- Do not allow children to play with your headphones without adult supervision.
- Keep out of reach from infants.
- Do not expose your headphones to excessive heat, flames or fire.
- Always press all buttons carefully. Do not mishandle your headphones.
- Do not use in extremely dry environments, as this can lead to static discharge during use.
- Do not expose your headphones to temperatures above 104°F / 40°C.
- Keep out of direct sunlight.
- Do not drop, throw, crush or expose your headphones to excessive physical force.
- Your headphones are not intended for commercial use.
- Do not place near objects that generate a strong magnetic field.

- Your headphones have internal rechargeable batteries. Improper usage may result in the headphones becoming hot, ignite or burst and cause injury if they come in contact with your face.
- Do not disassemble, throw away or damage the True Headphones[®].
- Store the headphones in a dry place, keeping them away from damp corrosive materials and environments such as salt air.
- Keep the headphones away from direct sunlight, fire and high voltage equipment. Do not store the headphones inside a car during hot weather.
- Remember a closed case can reach very high temperatures, allowing the inside to reach high temperatures.
- The headphones are not a toy. Please keep them out of the reach of young children.
- Please do not discard the headphones.
- Consult your local waste collection agency for proper disposal of your headphones.
- You may also contact "Call2Recycle" at 877-273-2925 or online at Call2Recycle.com for a local recycling drop off location near you.



BATTERY CAUTION: Do not disassemble, short circuit, or expose to fire or high temperature. Properly connect specified devices. Recycle battery according to local, state and national regulations.

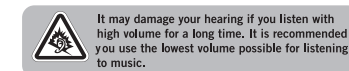

This device complies with Part 15 of the FCC rules. Operation is subject to the following two conditions: (1) This device may not cause harmful interference, and (2) This device must accept any interference received; including interference that may cause undesired operation. The Federal Communications Commission (FCC) Statement: This Equipment has been tested and found to comply with the limits for a Class B digital device, pursuant to Part 15 of the FCC rules. These limits are designed to provide reasonable protection against harmful interference in a residential installation. This equipment generates, uses, and can radiate radio frequency energy and, if not installed and used in accordance with the instructions, may cause interference to other devices. It is your responsibility to take measures to prevent such interference. However, there is no guarantee that interference will not occur in a particular installation. If this equipment does cause harmful interference to radio or television reception, which can be determined by turning the equipment off and on, the user is encouraged to take the following steps to correct the interference by one or more of the following measures:

- Reorient or relocate the receiving antenna.
- Increase the separation between the equipment and receiver.
- Connect the equipment into an outlet on a circuit different from that to which the receiver is connected.
- Consult the dealer or an experienced radio/TV technician for help.

Warning: Changes or modifications to this unit not expressly approved by the party responsible for compliance could void the user authority to operate the equipment. Tested to comply with FCC standard.
FOR HOME OR OFFICE USE.

Warning:
This equipment complies with FCC RF radiation exposure limits set forth for an uncontrolled environment. This device and its antenna(s) must not be co-located or conjunction with any other antenna or transmitter.

ESI Cases & Accessories, Inc., warrants to the first consumer purchaser that this product, when shipped in its original container to the original purchaser will be free from defective workmanship and materials for one year and agrees that it will, at its option, either repair the defect or replace the defective product or part thereof at no charge to the purchaser for parts or labor for the time periods described.

This warranty does not apply to any appearance items of the product nor to the additional excluded item(s) set forth below nor at any product the extent of which has been covered by a preceding warranty design or construction. The following is a description of the items in addition to an applicable law, ALL IMPLIED WARRANTIES OF MERCHANTABILITY AND FITNESS FOR USE ARE LIMITED TO THE PERIOD FROM THE DATE OF ORIGINAL PURCHASE SET FORTH BELOW.

Some states do not allow limitations on how long an implied warranty lasts, so the above limitation may not apply to you. Neither the sales personnel of the seller nor any other person is authorized to make any warranties other than those described herein or to extend the duration of any warranties beyond the time period described herein on the behalf of ESI Cases & Accessories, Inc.

The warranties described herein shall be the sole and exclusive warranties granted by ESI Cases & Accessories, Inc. and shall be the sole and exclusive remedy available to the purchaser corrections of defects, in the manner and for the period of time described herein, shall constitute complete fulfillment of all liabilities and responsibilities of ESI Cases & Accessories, Inc. to the purchaser with respect to the product and shall constitute full satisfaction of all claims, whether based on contract negligence, strict liabilities and responsibilities of ESI Cases & Accessories, Inc. be liable or in any way responsible, for any incidental or consequential damages, so the above exclusion may not apply to you. THIS WARRANTY GIVES YOU SPECIFIC LEGAL RIGHTS. YOU MAY ALSO HAVE OTHER RIGHTS, WHICH VARY FROM STATE TO STATE.

This warranty does not cover cables that have become frayed, cracked, or broken from use. The user should immediately replace this, or any, charge cable that has become frayed, cracked, or broken, as it may constitute a serious safety risk, including electrocution, if it is continued to be used.

Send product with \$11.95 shipping & handling fee to:
ESI Cases & Accessories
One Gateway Center, Suite 2600 Newark, NJ 07102
TechSupport@ESICellular.com