

billboard

TRUE WIRELESS EARBUDS



USER MANUAL

Bluetooth Pairing:

Using a pair of earbuds:

Step 1: Open the upper cover of the charging box and take out the earbuds, then the earbuds are automatic pairing.

Step 2: Now the L-left /R-right headsets will flash red and blue, the one headset will flash red and blue the other one will not flash any light meaning the headsets are paired together.

Step 3: The earbuds are now ready to get paired with your Bluetooth device via the Bluetooth menu in your smartphone or another Bluetooth device. Simply open up the Bluetooth function on your phone device, select the pairing name "BB-BT-EB" from the list of Bluetooth devices found, pair your earbuds with your phone.

Step 4: Listen to music and enjoy it. Single click the Left/Right earbuds to Play/Pause music. Double click the Left/Right earbuds to play the Last/Next song. Three click the Left/Right earbuds to Decrease/Increase volume.

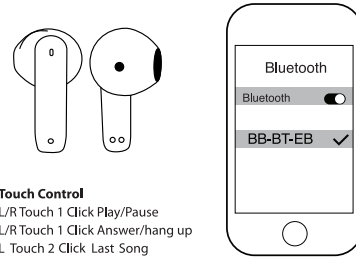

Touch Control

L/R Touch 1 Click Play/Pause
L/R Touch 1 Click Answer/hang up
L Touch 2 Click Last Song
R Touch 2 Click Next Song
L/R 2 Seconds Press Refuse to answer
L Touch 3 Click Volume -
R Touch 3 Click Volume +
L/R 3 Seconds Press Activate voice assistant

Device Safety

- Your True Wireless Earbuds have internal rechargeable batteries. Improper usage may result in the Earbuds becoming hot, ignite or burst and cause injury if exposed to conditions of abuse.
- Do not disassemble, throw away or damage the True Wireless Earbuds.
- Store the True Wireless Earbuds in a dry place, keeping them away from damp corrosive materials and environments such as salt air.
- Keep the True Wireless Earbuds away from direct sunlight, fire and high voltage equipment. Do not store the True Wireless Earbuds inside a car during hot weather. Remember a closed car acts as a green house allowing the inside to reach high temperatures.
- The True Wireless Earbuds are not a toy. Please keep them out of the reach of young children.
- Please do not discard the True Wireless Earbuds. Consult your local waste collection agency for proper disposal or recycling methods. You may also contact "Call2Recycle" at 877-273-2925 or online at "call2recycle.org" for a battery recycling drop off location near you.

Additional information.

Make sure the earbuds are paired before use and the Bluetooth function is activated on your phone. Make sure the earbuds are charged before use. Safety use of the lithium battery. The lithium batteries inside these products or not removable, do not attempt to remove these batteries.



FCC Information

FCC ID: 2AML6KR315A

This device complies with Part 15 of the FCC rules. Operation is subject to the following two conditions: (1) this device may not cause harmful interference, and (2) this device must accept any interference received, including interference that may cause undesired operation. Federal Communications Commission (FCC) Statement This Equipment has been tested and found to comply with the limits for a Class B digital device, pursuant to Part 15 of the FCC rules. These limits are designed to provide reasonable protection against harmful interference in a residential installation. This equipment generates, uses, and can radiate radio frequency energy and, if not installed and used in accordance with the instructions, may cause harmful interference to radio communications. However, there is no guarantee that interference will not occur in a particular installation. If this equipment does cause harmful interference to radio or television reception, which can be determined by turning the equipment off and on, the user is encouraged to try to correct the interference by one or more of the following measures:

- Reorient or relocate the receiving antenna.
- Increase the separation between the equipment and receiver.
- Connect the equipment into an outlet on a circuit different from that to which the receiver is connected.
- Consult the dealer or an experienced radio/TV technician for help.

Warning: Changes or modifications to this unit not expressly approved by the party responsible for compliance could void the user authority to operate the equipment. Tested to comply with FCC standard. FOR HOME OR OFFICE USE.

Warning:

This equipment complies with FCC RF radiation exposure limits set forth for an uncontrolled environment. This device and its antenna(s) must not be co-located or conjunction with any other antenna or transmitter.

INTRODUCTION

Thank you for purchasing the Billboard® True Wireless Earbuds. For best use of this device, we recommend carefully reading this user manual and keeping it for your records.

Package contains:

- a. Wireless Two Earbuds
- b. Charging case
- c. USB-C charging cable
- d. User manual

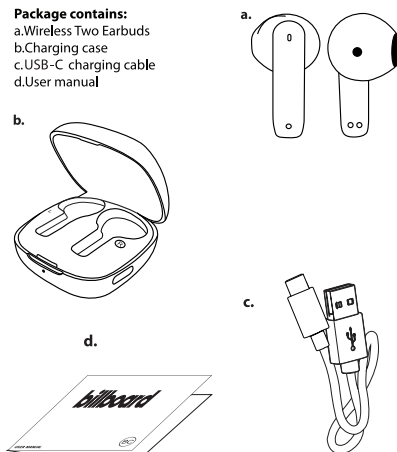

Automatic pairing:

After the earbuds are paired once with your device, next time the pairing will be done automatically. In other words, you do not need to look for your Bluetooth device the next time you wish to pair them with your device. The earbuds are paired with your phone or Bluetooth device automatically when turned on again.

Charging the Charging case.

(it is recommended to charge the case before the earbuds)

- Please plug the charger cable into the charging case.
- Connect the charger to USB power source (not included); the charging indicator will flash red during charging. If charging does not start, disconnect the charger, plug it in again and retry. Charging the batteries fully may take several hours.
- When the battery of the charging case is fully charged, the red indicator light will be solid. Disconnect the charger from the USB power source and the charging case.

Charging the earbuds.

- Plug the earbuds into the charging case, the charging case indicator will be solid blue and the earbuds indicator will be solid red during charging.
- When the battery of earbuds is fully charged, the indicator of the charging case will turn off.



Battery Information

Your earbuds are powered by a rechargeable batteries. The full performance of new batteries is achieved only after two to three complete charge and discharge cycles. The batteries can be charged and discharged hundreds of times, but it will eventually wear out.

- Do not leave a fully charged earbuds connected to a charger, overcharging may shorten their lifetime. If left unused, fully charged earbud batteries will lose their charge over time.
- Never use any charger that is damaged.
- Leaving the device in hot or cold places will reduce the capacity and lifetime of the batteries. Optimal temperature for the batteries is between 59°F and 77°F. A device with a hot or cold batteries may not work temporarily, even when the batteries are fully charged.
- Do not dispose of batteries in a fire as they may explode. Batteries may also explode if damaged. Always dispose of batteries according to local regulations. Please recycle. Do not dispose as household waste.

Manufactured by: ESI Cases & Accessories
One Gateway Center, Suite 2600 Newark, NJ 07102
TechSupport@ESICellular.com
All other trademarks are property of their respective companies.

© Billboard Media, LLC Billboard and the Billboard logo are registered trademarks of Billboard IP Holdings, LLC. Used under license.



It may damage your hearing if you listen with high volume for a long time. It is recommended you use the lowest volume possible for listening to music.

VENDOR: PLEASE ADD FCC ID

BB-BT-EB