

INNO LUMI
LED Remote Controller
User Manual

Statement

Copyright © Shenzhen Dr. Kon Technology Co., Ltd. Shenzhen Dr. Kon Technology Co., Ltd. reserves the right to change the product specifications and client software, and the actual products shall prevail. No further notice will be provided beforehand.

FCC Requirement

changes or modifications not expressly approved by the party responsible for compliance could void the user's authority to operate the equipment.

This device complies with Part 15 of the FCC Rules. Operation is subject to the following two conditions:

- (1) this device may not cause harmful interference, and
- (2) this device must accept any interference received, including interference that may cause undesired operation.

Note: This equipment has been tested and found to comply with the limits for a Class B digital device, pursuant to Part 15 of the FCC Rules. These limits are designed to provide reasonable protection against harmful interference in a residential installation. This equipment generates, uses, and can radiate radio frequency energy, and if not installed and used in accordance with the instructions, may cause harmful interference to radio communications. However, there is no guarantee that interference will not occur in a particular installation. If this equipment does cause harmful interference to radio or television reception, which can be determined by turning the equipment off and on, the user is encouraged to try to correct the interference by one or more of the following measures:

- Reorient or relocate the receiving antenna.
- Increase the separation between the equipment and receiver.
- Connect the equipment into an outlet on a circuit different from that to which the receiver is connected.
- Consult the dealer or an experienced radio/TV technician for help.

Basic Parameters

Product model	LUMI-R2
Operating voltage	3.3 V
Battery capacity	450 mA
Standby time	21 days
Emission frequency	2.4 GHz ISM
Transmitting power	7 dBm
Modulation mode	GFSK/FSK
Effective control distance	10 m
Outline dimension (length x width x thickness)	131.5 mm x 38.5 mm x 7 mm
Number of controllable LED lights	96 groups
Color	Cool gray

Safety Precautions

1. Please read through the user manual carefully before using the product.
2. This product applies to our INNO LUMI series of smart light sources.
3. This product is a high-tech precision product. Keep it far from high temperature, humidity, flammable gas, or liquids to avoid damaging the parts.
4. Please use this product within the current and voltage ranges indicated in "Specifications".
5. If the product is damaged, ask our authorized after-sales service personnel to check and repair the product.

Operation Instructions

I. Getting familiar with the device

- ① : Power key: Press this key to turn on the display backlight; long-press it to turn the device on or off;
- ②: Display;
- ③: Light-off key: used to turn off the light;
- ④: Light-on key: used to turn on the light;
- ⑤: Up key: used to select a function in the up direction;
- ⑥ : Down key: used to select a function in the down direction;
- ⑦: Left key: used to go back or adjust left;
- ⑧ : Right key: used to confirm the operation or adjust right;
- ⑨ : Micro USB2.0: used for charging and data transmission.

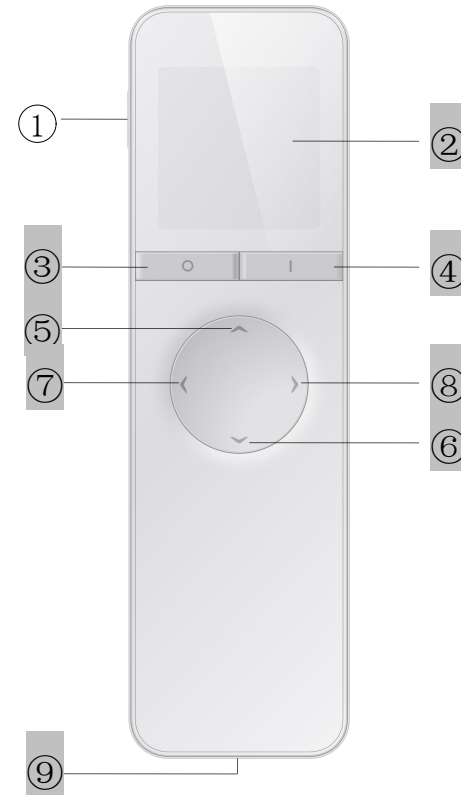

II. Adapting to the LED series light sources

Step 1: Turn on the remote controller, and select "Settings" —> "Add LED" —> "Select Area" (select the light installation position) —> "Configuration" to enter the corresponding interface, as shown below:

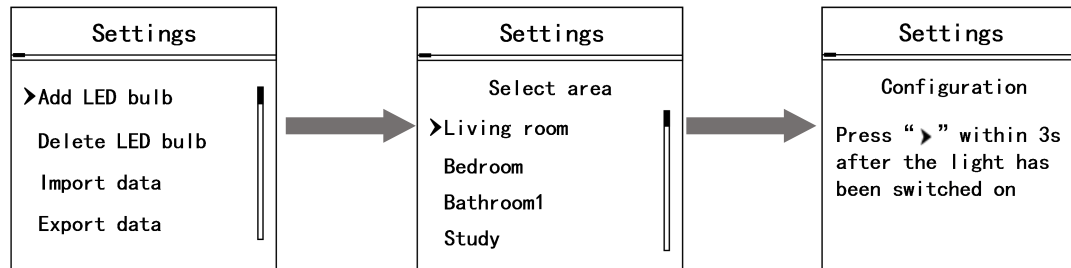

Step 2: Turn on the power switch to turn on the light source.

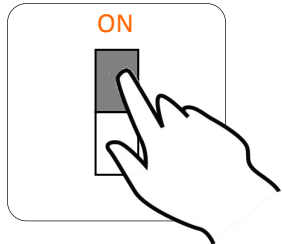

Step 3: Press the ">" key on the remote controller 3 s after the light is turned on. If the light blinks, pairing has succeeded.

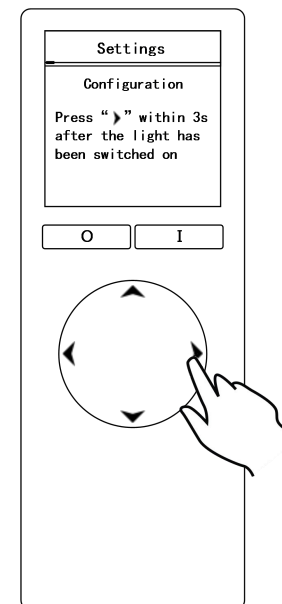

Note: The LUMI-R2 remote controller uses 2.4G RF. Wi-Fi and Bluetooth signals will interfere with it. During the adding operation or brightness, color temperature or color adjustment process, the operation of a light source may fail occasionally. Repeated operations can restore normal status.

III. Adjusting the light

Press the "O" key to turn on the light or the "I" key to turn off the light;
Press the up and down keys to select the brightness and color temperature, and then press the left or right key to adjust the light.

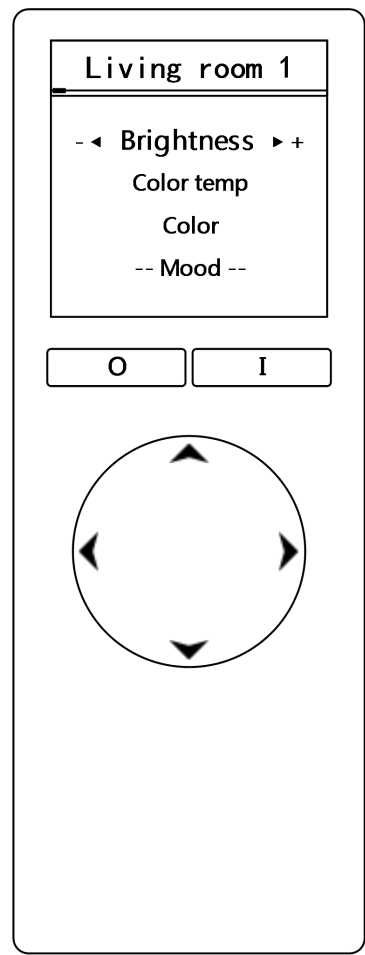

IV. Switching the light

When multiple lights can be controlled on the remote controller, press or long-press the up key to move the cursor to the title bar (the top black area on the screen, as shown below), and press the left or right key to switch to the light for control.

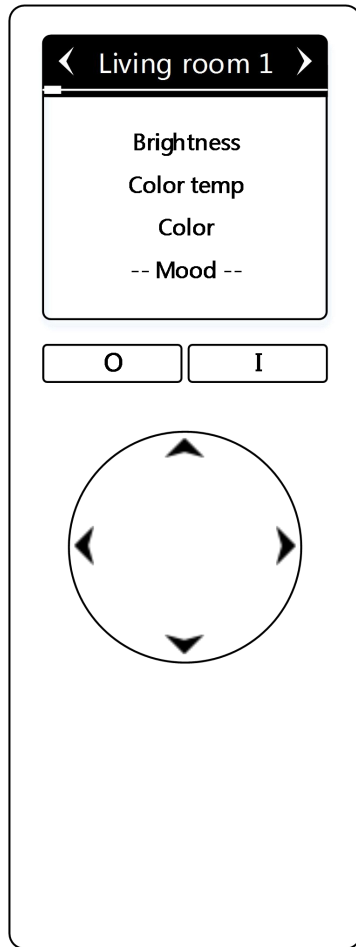

V. Exporting the adapted light to other remote controllers

When multiple remote controllers are used, import/export mode can be used to export the adapted light to other remote controllers, which saves time by avoiding repeated adaptation.

Step 1: Select the lights to be exported.

Open the "Export" page in "Settings", and select the lights to be exported. Press the right key to select or deselect the light. "✓" indicates that the light is selected.

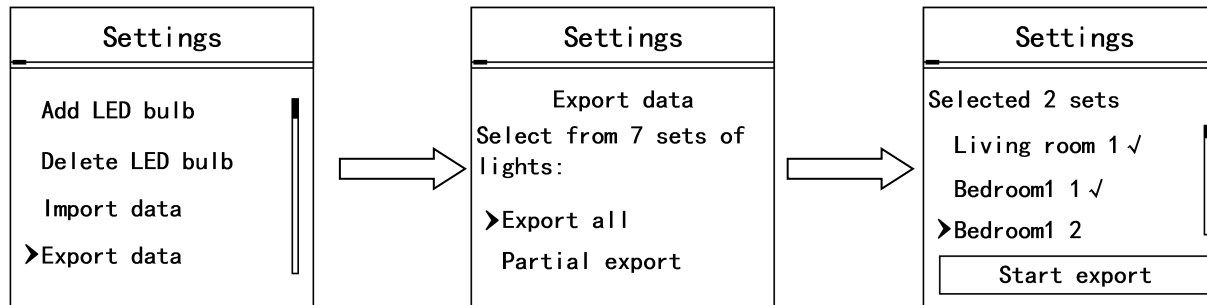

Step 2: Connect to the import-end remote controller.

After selecting the lights to be exported, press the down key to move the cursor to "Confirm Export". Press the right key to enter the next step.

After that, press the right key as prompted to connect to the import-end remote controller.

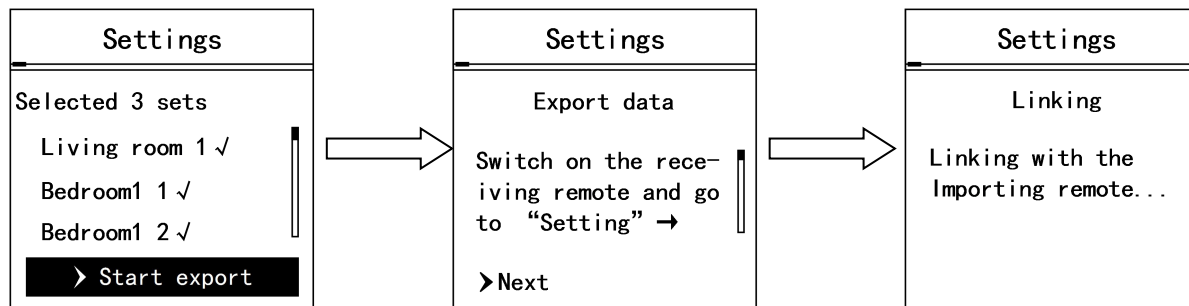

Step 3: Turn on the import-end remote controller.
Take another remote controller, start the import function, enter the connection interface, and then press the right key to connect to the export-end remote controller.

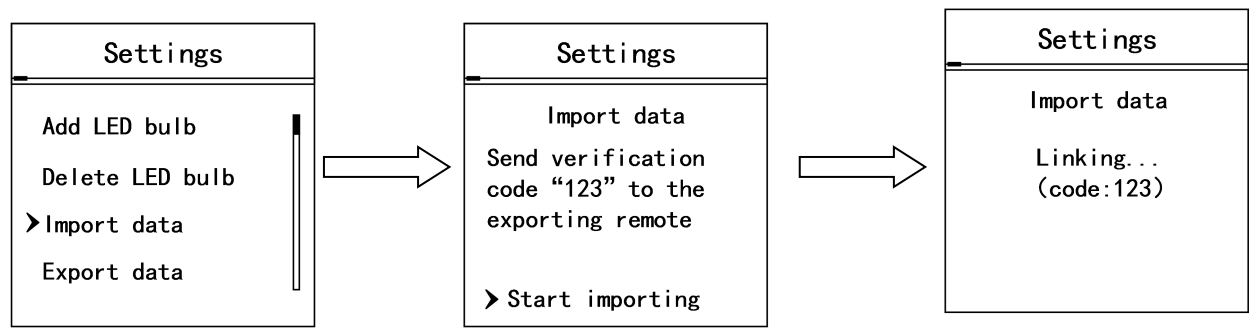

If the connection succeeds, the interface displays "Importing..."

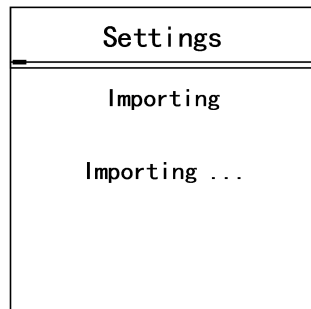

Step 4: Confirm the identification code and send data.

After the connection succeeds, the export-end remote controller will receive the identification code sent from the import-end remote controller. If the identification code is consistent with the one sent from the import-end remote controller, press the right key to send the lights to be exported to the import-end remote controller.

Note: The identification code aims to prevent sending data to other remote controllers by mistake.

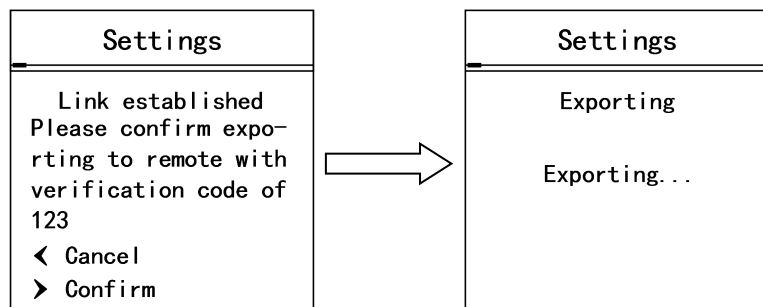

After sending is successful, the interface displays "Successfully". Press the right key to go back to the "Settings" interface.

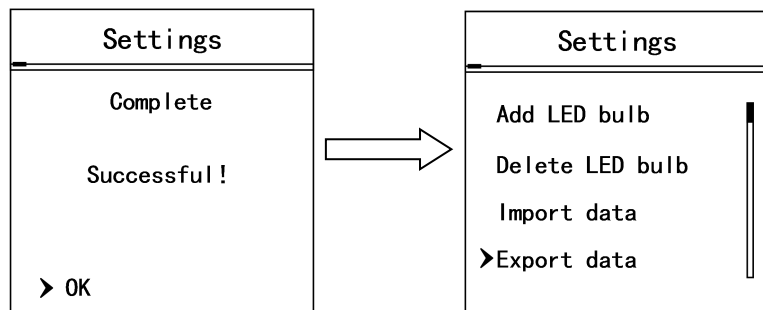

Note: If the names of an imported light and original light are the same, the name of the original light will be unchanged and the name of the imported light will be arranged in turn according to the serial number of the original light name.

For example, if the light named "Living room 1" exists already on the original remote controller and the names of imported lights are "Living room 1" and "Living room 2", then the imported names "Living room 1" and "Living room 2" will change to "Living room 2" and "Living room 3" in turn.

VI. Upgrading

The firmware version and functions of LUMI-R2 can be updated through an upgrade. To upgrade the product, visit Dr. Kon's website (www.drkon.net) to download the upgrade tool, upgrade package, and operations manual.

Product Warranty Card

Product model:

Serial number:

Purchase date:

Customer name: _____ Tel: _____

Store:

Store address:

Three-guarantee Clauses

Shenzhen Dr. Kon Technology Co., Ltd. implements the government's three guarantees for consumer electronics.

The specific three-guarantee regulations are as follows:

1. The three-guarantee period starts from the date of issuing the valid purchase voucher. Please keep the purchase voucher and Product Warranty Card properly;
2. Guaranteed return with a full refund within 7 days if there's a quality problem;
3. Guaranteed replacement within 15 days of purchase if there's a quality problem;
4. Guaranteed free repair within 1 year after the purchase or replacement with an equivalent product;
5. We provide a paid maintenance service for all products not within the scope of guaranteed return, replacement, or repair;
6. If the product is unsealed and damaged, please contact the salesman to replace it.

The three-guarantee service excludes the following circumstances:

1. Accessories such as packaging and technical documents;
2. The user fails to install or use the product according to instruction requirements and damages the product;
3. Product information is altered or deleted or the user repairs or disassembles/assembles the product without permission;
4. The product is damaged due to human error such as exposure to high temperatures, water, mechanical disruption, or falling;
5. The three-guarantee period has expired.

Special Notice:

1. The above service commitment applies to our company's smart home products that are sold in Mainland China and abroad. For the region where special three-guarantee regulations are implemented, our company will comply with the local regulations;
2. Our company will not bear any responsibilities for commitments that are made by the distributor but not by us;
3. The after-sale services of our company are applicable to customers who have purchased our smart home products.

Remarks:

The final interpretation right and revision right of this commitment shall go to Shenzhen Dr. Kon Technology Co., Ltd. For the detailed three-guarantee commitment of smart home products, please refer to the content on the website of Shenzhen Dr. Kon Technology Co., Ltd.

Shenzhen Dr. Kon Technology Co., Ltd.

Address: Room 606, Floor 6, A-FONTANE Center, Jinlong Industrial City, Majialong, Shenzhen City, Guangdong Province

Tel: 400-050-2525

Website: www.drkon.net



Please follow our official account of WeChat.

Declaration of Toxic and Hazardous Substances in Electronic Information Products

Part name	Toxic and hazardous substance or element					
	Plumbum (pb)	Hydrargyrum (Hg)	Cadmium (Cd)	Hexavalent chromium (Cr6+)	Polybrominated biphenyl (PBB)	Polybrominated diphenyl ether (PBDE)
Structural part	○	○	○	○	○	○
Board/circuit module	X	○	○	○	○	○
Cable	○	○	○	○	○	○
Battery	X	○	○	○	○	○
Plastic shell	○	○	○	○	○	○
Other parts	○	○	○	○	○	○

This table is prepared according to the provisions of SJ/T 11364.

1. "○" indicates that the content of this toxic and hazardous substance in all the homogeneous materials of this part is below the limit requirement provided in the GB/T 26572 standard.

2. "×" indicates that the content of this toxic and hazardous substance in at least one homogeneous material of this part exceeds the limit requirement provided in the GB/T 26572 standard.

