

Sound Sync Car Interior Light Strips



Product Instruction Manual

Please read carefully prior to use.

Use inside vehicle only. Carefully peel off adhesive backing from LED strip without removing clear adhesive layer. Remove plastic battery protector from remote prior to use.



Please call customer service at **1-800-254-0111** with any questions

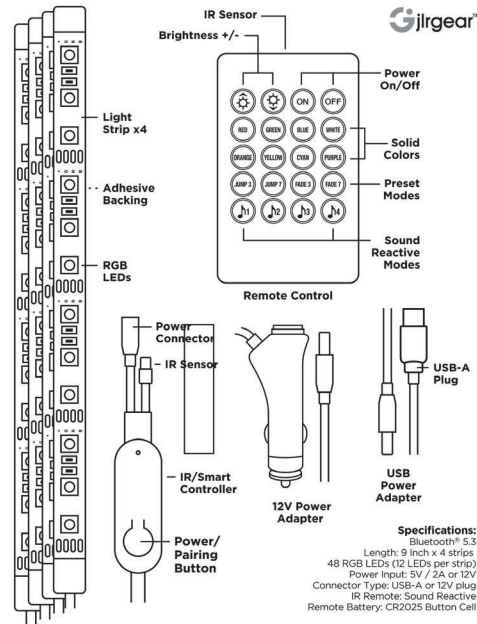

Light Strip Setup

- Choose smooth and hard surfaces in vehicle to mount LED strips. Smooth plastic and metal are ideal mounting surfaces.
- Position LED strips around vehicle to make sure power cables can reach mounting locations. There are 2 shorter cables for front of cabin and 2 longer cables reach to rear.
- Run cables in location that do not interfere with vehicle or seat operation.
- Carefully peel off adhesive backing without removing clear adhesive layer. Adhesive layer is very thin, clear and can come off inadvertently while removing backing.
- Apply pressure while sticking LED strip.
- Connect USB plug to 5V / 2A USB power source or 12V power outlet with included power cables.

Installation Tip: For best results and long-lasting adhesion, go back over LED strip one more time by carefully running finger over entire strip to make sure strip is securely attached to mounting surface. Apply pressure to any areas that are not fully attached to surface until firmly stuck.

BE CAREFUL WHEN PEELING OFF BACKING THAT YOU DON'T REMOVE CLEAR ADHESIVE LAYER!

Sound Reactive Remote Control

- Make lights dance to the music!
- Remove plastic battery protector from remote control prior to use.
- Point remote toward light that is already setup and press ON button to test.
- Remote controls lights up to 30 feet away. Make sure to point remote at IR sensor on light and that there is clear line of sight.
- Choose colors, adjust brightness level or select preset color or color flow light modes.
- Press music button for sound reactive mode that makes lights change colors to sound.
- Place remote less than 20 inches away from speaker or other sound source and less than 30 feet away from lights with clear line of sight.

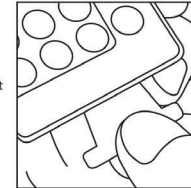
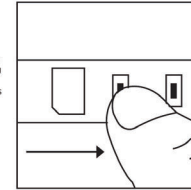
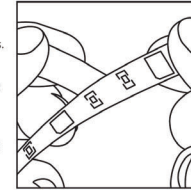

Scan the above QR code or download the **Smart Life** App for your iOS® or Android™ device available for free download from the App Store® or Google Play™

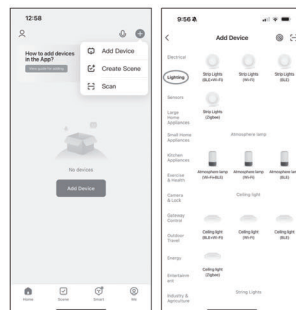

Connecting Smartphone

- Download Smart Life App from App Store or Google Play.
- Allow App access. You may choose to register or continue as guest.
- Connect light strip to USB power source. Press and hold button on controller until light strip starts flashing.
- Tap + in upper right to add device.
- Discovering devices tile with quick Add button will automatically appear in upper screen area if light is flashing in pairing mode and device is discoverable. Tap Add button to connect automatically.
- Follow prompts in App to connect and proceed to home screen.
- Select Strip Lights. Lights can connect via Bluetooth®
- Make sure flashing light strip and smartphone are nearby.

Must have Bluetooth® enabled smartphone to connect locally.



Advanced App Control

- Advanced lighting controls and customization using App.
- Tap power button in bottom left of screen to turn light On/Off. Each menu has custom light settings.
- Tap color, color preset, music sync at bottom of screen.
- Choose color ● at the bottom of screen to select color from spectrum. Tap color type and adjust by tapping wheel.
- Choose ● at the bottom of screen to select from preset color modes
- Choose music sync 🎵 at the bottom of the screen. Select microphone sensitivity 🗣️ or select from preset light colors ★ and patterns to customize.
- Choose ⚙️ to access timer menu settings for the lights to automatically turn off at a preset time.

Control lights with Smart App, remote control or turn on and off with power button.

Replacing Remote Control Battery

- Pinch end of battery tray with finger nail and pull out by sliding.
- Insert new "CR2025" button cell battery with positive side facing upwards in tray.
- Slide battery tray back into remote and test.

Care Tip: Periodically wipe clean with soft cloth. Never use abrasive cleaning agent or get wet.

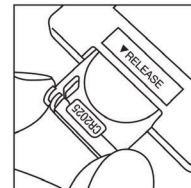

WARNING: KEEP AWAY FROM CHILDREN. CAUTION LED'S ARE VERY BRIGHT. AVOID DIRECT EXPOSURE OF LED LIGHTS TO EYE. INJURY TO EYES MAY OCCUR. DO NOT SHINE IN THE EYES OF OTHERS.

WARNING! IMPORTANT CARE AND SAFEGUARDS

Failure to follow the safety instructions can lead to personal injury or property damage and damage to this product.

- Make sure lights and cables do not interfere with vehicle or seat operation
- Use inside vehicle only, not rated for use outside of vehicle
- Unplug light strips when not in use to avoid draining vehicle battery
- Do not use the lights for anything other than intended use
- Always use the specified power source and voltage
- This product contains small parts and is not suitable for children
- Do not expose this product to rain, water or excessive humidity
- Do not handle power plug or connectors with wet hands
- Do not use lights if they have been dropped or damaged in any way
- Never take this device apart and always get repaired by a qualified technician
- Keep light away from heat sources and direct sunlight

FCC Disclaimer:

This device complies with part 15 of the FCC Rules. Operation is subject to the following two conditions: (1) This device may not cause harmful interference, and (2) this device must accept any interference received, including interference that may cause undesired operation. NOTE: THE MANUFACTURER IS NOT RESPONSIBLE FOR ANY RADIO OR TV INTERFERENCE CAUSED BY UNAUTHORIZED MODIFICATIONS TO THIS EQUIPMENT. SUCH MODIFICATIONS COULD VOID THE USER AUTHORITY TO OPERATE THE EQUIPMENT.

App Store is a service mark of Apple Inc., registered in the U.S. and other countries. Android, Google Assistant, Google Play and the Google Play logo are trademarks of Google Inc. iOS is a registered trademark of Cisco in the U.S. and other countries and is used under license. The Bluetooth® word mark and logos are registered trademarks owned by Bluetooth SIG, Inc.

SAVE THESE INSTRUCTIONS FOR FUTURE REFERENCE

Any questions, please call customer service at 1-800-254-0111

8:30am - 5pm, PST, Monday - Friday, or email us at customerservice@jlgear.com

2434 Research Dr., Livermore, CA 94550

© 2024 JLR Gear - Made in China



Any changes or modifications not expressly approved by the party responsible for compliance could void the user's authority to operate the equipment.

NOTE: This equipment has been tested and found to comply with the limits for a Class B digital device, pursuant to Part 15 of the FCC Rules. These limits are designed to provide reasonable protection against harmful interference in a residential installation. This equipment generates, uses and can radiate radio frequency energy and, if not installed and used in accordance with the instructions, may cause harmful interference to radio communications. However, there is no guarantee that interference will not occur in a particular installation. If this equipment does cause harmful interference to radio or television reception, which can be determined by turning the equipment off and on, the user is encouraged to try to correct the interference by one or more of the following measures:

- Reorient or relocate the receiving antenna. -- Increase the separation between the equipment and receiver. -- Connect the equipment into an outlet on a circuit different from that to which the receiver is connected. -- Consult the dealer or an experienced radio/TV technician for help.
- To maintain compliance with FCC's RF Exposure guidelines, This equipment should be installed and operated with minimum 20cm distance between the radiator and your body. Use only the supplied antenna.