

IQsound®

NANO PODS Ture Wirelss Earbuds

with Tuya APP Control



Model No.: IQ-241TWS

Please read carefully this manual before operating the device.

Un-boxing the device

- 1 x Wireless Earbuds
- 1 x Charging Case
- 1 x Type C Cable
- 1 x User Manual

Specifications

Bluetooth Version: V5.3
Speaker Diameter: 10 mm
Speaker Power Output: 3 mW
Speaker Sensitivity: 105dB at 1KHz
Speaker Impedance: 32 Ω
Battery Capacity: 3.7V, 300mAh
Frequency Response: 50Hz-5KHz
Bluetooth Connecting Range: 10m
APP: Tuya Smart APP

Introduction

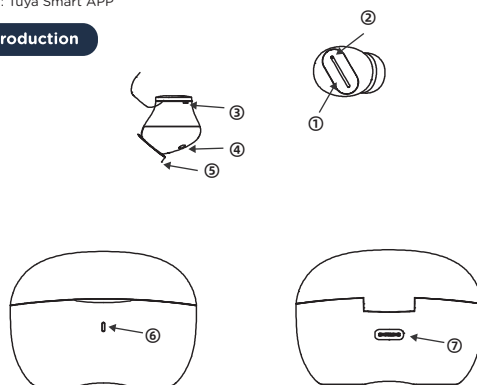

FCC ID:2AMD81Q-241TWS

BATTERY CASE:

Capacity: 300 mAh
Charging Port: USB Type-C
Earphone Battery: 35 mAh
Playing Time:
Up to 5H + 15H with charging case
Charging Time: approx. 1H

- 1.Multi Function Touch Button
- 2.Mic
- 3.Earbuds LED indicator
- 4.Charging Pin
- 5.Silicon Ear Tips
- 6.Charging Case LED Indicator
- 7.Type C Charging Port

How to connect

Pairing the Earbuds with your mobile device

- Once you take out the earbuds from the charging case, they will pair with each other automatically within 2 seconds. The LED indicator (4) on both earbuds will be flashing green alternately. After pairing, the left earbuds will flash green alternately.

- Activate the Bluetooth function on your device and search for nearby devices.
- Select "IQ-241TWS" from the list to connect with the TWS earbuds.
- Once paired successfully, you would hear a beep and the LED will turn off.
- Your device is now connected and you can play music or take calls with your IQsound Nano Pods TWS Earbuds.

AUTO CONNECTION

- After you pair the earbuds to your device for the first time, the earbuds will pair your device automatically once they're taken out of charging case.
- Note:** When the abnormal operation of the user causes the device to only connect to a single earbud or cannot search for the Bluetooth name, please put the dual earbuds back into the charging case, delete the pairing record in the device, then turn off the device Bluetooth. Then reconnect your device with the earbuds in standard way.

How to use the MFB Touch Button

- Power On:** Take out the earbuds from charging case. The earbuds will power on automatically or long press MF touch button for 3 seconds.
- Power Off:** Put it into the charging case to automatically power off or long press

MF touch button for 4 seconds until green light flashes.

- Play/Pause:** Touch one of the earbuds MF button during play to pause, and touch MF button to re play again.
- Answer /End call:** Touch any of the earbud MF button to answer the call. To end the call, touch any of the MF button again to hang up while on call.
- Reject the call:** Long touch MF button for 1.5 seconds when incoming call.
- Increase Volume:** Double touch the right MF button when the device is connected to increase volume.
- Decrease Volume:** Double touch the left MF button when the device is connected to decrease volume.
- Previous Track:** Touch the left MF button 3 times to skip previous track.
- Next Track:** Touch the right MF button 3 times to skip next track.
- Google / Siri Activate:** Touch and hold the MF button for 2 seconds on either of the earbuds to activate.

How to Charge the Earbuds

Once the earbuds reach low battery, the LED indicator (6) will be flashing green on the earbuds three times. Put both earbuds into the charging case, the earbuds will now automatically start charging.

How to charge the charging case

- Plug the Type C end of the included cable into the charging case (7)
- Plug the USB-A side of the included cable into a suitable USB charger on other power source or any computer or other 5V but current do not exceed 2A output charger.
- While the earbuds are charging, the LED indicator on the charging case (6) will be constantly green.
- Once the charging case is fully charged the LED indicator will automatically turn off.

How to use Tuya Smart APP

APP Download

Download the Tuya Smart App on your mobile phone. You can search Tuya Smart App in your APP store or scan below QR Code.



Connect with APP and mobile phone at the first time

- 1.After the earbus is turned on, click on the APP and wait for the pairing popup. Click Add - NEXT- Done in sequence to complete the connection with the APP.
 - 2.Then connect device with Bluetooth.
- TIPS:**Please turn on your Bluetooth and location before connecting.

Connect with APP and mobile phone at the second time

After the earbus is turned on, ensure the network signal is good. Click the APP and wait for the connection.

EQ Choice (Equalizer)

- 1.There are 20 different kinds of EQ for choice. Dynamic, bass boost and vocals.....
- 2.The equalizer can be adjusted through Tuya App. Enter APP and got to setting page, you can choose the sound effect you want.

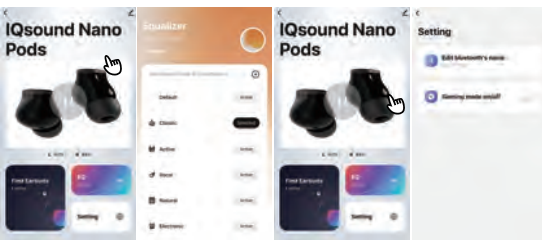

Settings

- 1.From the setting menu, you can change the bluetooth name of your TWS. Enter APP and go to setting page, edit the bluetooth name.
- 2.You can turn on/off the gaming mode function (low latency).

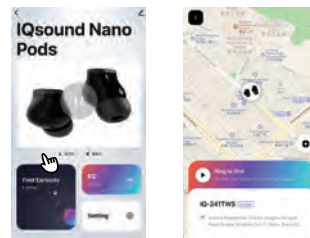

Last TWS Location

- 1.This function can help you in locating the TWS. While using the online status will record your position in use, the last offline position and the time since the last use.
- 2.The earbuds Ring to find after receiving the phone, you can control the sound of the earbuds to help you find the earbuds hidden in the corner.

Disconnection and Connecting to another Device:

- 1.If you want to use the IQsound Nano Pods (IQ-241TWS) on another mobile phone, first you need to disconnect to the current device and connected Tuya Smart App.
- 2.Click on the upper right button of the APP (As shown in image) to enter device disconnection interface.
- 3.Follow the below process:
Remove Device > Disconnect and wipe Data, this will disconnect your device with Tuya Smart App, then disconnect the bluetooth device from the phone.
And search for IQsound Nano Pods (IQ-241TWS) in new mobile device.

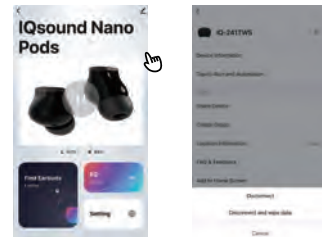

TIPS: If you can't find the TWS on your new device, reset the earbuds with six quick taps on the MFB touch button on either earbud, and you can find it on your new device.

Cleaning

- Do not expose the earbuds to excessive amounts of liquid, moisture or humidity to avoid the product's internal circuit of being affected.
- Do not use abrasive cleaning solvents to clean the device.
- Only clean the product with a slightly damp cloth and mild washing-up liquid.

Attention/Danger!

- Do not listen to high volume sound for a prolonged time to avoid hearing damage. Set the volume to a safe level. The louder the volume, the higher the damage.
- Only use a charger with the right output, the output can be found on the rating label of the earbuds. In case of any doubts don't use the charger!

The device has been evaluated to meet general RF exposure requirement. The device can be used in portable exposure condition without restriction.

Safety Precaution

- Do not expose earbuds to extreme temperatures.
- Do not attempt to modify this product. Doing so will void the warranty and could result in personal injury or product failure.
- Do not immerse in water, such as while taking a bath or washing your face, otherwise sound deterioration or failures may result.

- Wipe the earbuds and sleeves with mild antiseptic to avoid infections. Do not use alcohol-based disinfectants.
- The cable connectors to the earbuds may collect debris or other deposit that can affect audio quality. If this happens, disconnect the cables and clean them using a dry cotton swab.
- Set the volume level of the audio device to minimum, and then after connecting the earbuds, adjust the volume gradually. Sudden exposure to loud noises could cause hearing damage.
- Stop using the earbuds immediately if they are causing great discomfort, irritation, rash, discharge, or any other uncomfortable reaction.
- Do not use when a failure to hear your surroundings could be dangerous, such as while driving, or when biking, walking, or jogging where traffic is present and accidents could occur.

DISPOSAL

ENVIRONMENTAL PROTECTION
Waste electrical production should not be disposed of with household waste. Please recycle where facilities exist. Check with your Local Authority or retailer for recycling advice.

Warranty

Basic Warranty Statement
Supersonic Inc. ("Supersonic") warrants this product to the original purchaser ONLY, to be free from defects in materials and workmanship under normal use, for ninety (90) DAYS from the date of original purchase. Proof of purchase (receipt) required. Please visit <http://www.supersonicinc.com/warranty> for additional information.

Garantía

Declaración básica de garantía
Supersonic Inc. ("Supersonic") garantiza este producto al comprador original SOLAMENTE, para estar libre de defectos en materiales y mano de obra bajo uso normal, por noventa (90) DÍAS a partir de la fecha de compra original. Se requiere una prueba de compra (recibo). Visite <http://www.supersonicinc.com/warranty> para obtener información adicional.

This device complies with part 15 of the FCC Rules. Operation is subject to the following two conditions:
(1) This device may not cause harmful interference, and
(2) this device must accept any interference received, including interference that may cause undesired operation.

FCC: This equipment has been tested and found to comply with the limits for a Class 1 digital device, pursuant to part 15 of the FCC Rules. These limits are designed to provide reasonable protection against harmful interference in a residential installation. This equipment generates, uses and can radiate radio frequency energy and, if not installed and used in accordance with the instructions, may cause harmful interference to radio communications. However, there is no guarantee that interference will not occur in a particular installation. If this equipment does cause harmful interference to radio or television reception, which can be determined by turning the equipment off and on, the user is encouraged to try to correct the interference by one or more of the following measures:
—Reorient or relocate the receiving antenna.
—Increase the separation between the equipment and receiver.
—Connect the equipment into an outlet on a circuit different from that to which the receiver is connected.
—Consult the dealer or an experienced radio/TV technician for help.
Warning: Changes or modifications not expressly approved by the party responsible for compliance could void the user's authority to operate the equipment.