

Specifications

Bluetooth Range: Up to 33 feet (10 meters)
 Charging Input: DCSV 1A max
 Play Time: 6 Hours**

**Applicable at 50% of maximum volume. Results will be lower when volume is higher.

The Bluetooth® word mark and logos are registered trademarks owned by the Bluetooth SIG, Inc. and any use of such marks by Sakar International is under license. Other trademarks and trade names are those of their respective owners.

A Quick Look

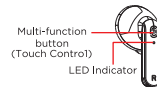

Earbuds

Charging Case

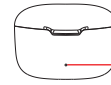

LED Indicator

Charging

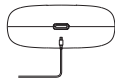

1. Insert the included charging cable's USB-C end into the port on the case.

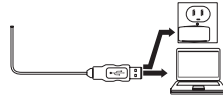

2. Insert the charging cable's standard USB end into the USB port of a computer or suitable wall adapter (not included).

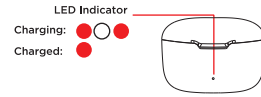

3. The LED Indicator will flash red when the case is charging and turn solid red when it is fully charged.

Bluetooth Pairing

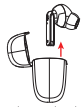

1. Remove the earbuds from the case and they will turn on automatically.
**If the earbuds are out of the charging case, put them into the case and take out again to turn on.*

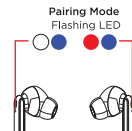

2. When in pairing mode, one earbud will flash red and blue and the other earbud will flash blue.

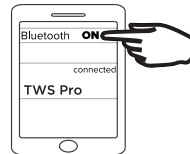

3. On your phone, go in the Bluetooth page in the Settings app, Make sure Bluetooth is on before connecting to the available device 'TWS Pro'.



4. Both earbud's LED Indicator will slowly flash blue once paired to your phone.

Using Your Earbuds: Music Controls



1. Press either earbud's Multi-function button to pause and play music.



2. Press the left earbud's Multi-function button three times to go back to the previous song.



3. Press the right earbud's Multi-function button three times to go to the next song.



4. Press either earbud's Multi-function button twice to activate Siri or Google Assistant.

* TWS Earbuds can be used independently. One earbud can be used when the other is off, as long as connected to Bluetooth.

Important Safety Precautions

1. READ ALL INSTRUCTIONS BEFORE USING YOUR EARBUDS AND CHARGING CASE.
2. Do not use your earbuds near water. Do not place your earbuds and charging case on any wet surfaces.
3. Do not allow children to use the earbuds and charging case without proper adult supervision.
4. Do not expose your earbuds and charging case to excessive heat or fire.
5. Do not use in extremely dry environments, as this can lead to static discharge during usage.
6. Do not expose your earbuds and charging case to temperatures above 100°F. Keep out of direct sunlight.
7. Do not attempt to repair these products yourself. Contact a qualified service center if your earbuds or charging case are in need of service.
8. Do not drop, puncture or expose your earbuds and charging case to excessive physical force.
9. Your earbuds and charging case are not intended for commercial use.
10. Do not place the earbuds near objects that generate a strong magnetic field.
11. Use only the supplied charging cable. Unplug this device when not in use for long periods of time and during lightning storms.
12. Use a soft cloth to clean your earbuds and charging case. Never use any abrasive chemicals.
13. Please recycle or dispose of your earbuds and charging case properly based on the laws and rules of your municipality. Contact local recycling facilities and/or the manufacturer of your earbuds for further information.

Vivitar One Year Warranty

This warranty covers the original consumer purchaser only and is not transferable.

This warranty covers products that fail to function properly UNDER NORMAL USAGE, due to defects in material or workmanship. Your product will be repaired or replaced at no charge for parts or labor for a period of one year.

What is Not Covered by Warranty

Damages or malfunctions not resulting from defects in material or workmanship and damages or malfunctions from other than normal use, including but limited to, repair by unauthorized parties, tampering, modification or accident.

To Obtain Warranty Service and Troubleshooting Information:

Call 1-800-592-9541 in the U.S. & 0-800-917-4831 in the UK or visit our website at www.vivitar.com.

To receive Warranty service along with the name and address of an authorized product service center, the original consumer purchaser must contact us for problem determination and service procedures. Proof of purchase in the form of a bill of sale or receipted invoice, evidencing that the product is within the applicable Warranty period(s), MUST be presented in order to obtain the requested service. It is your responsibility to properly package and send any defective products along with a dated copy of proof of purchase, a written explanation of the problem, and a valid return address to the authorized service center at your expense. Do not include any other items or accessories with the defective product. Any products received by the authorized service center that are not covered by warranty will be returned unrepaiared.

Using Your Earbuds: Call Controls



1. Press either earbud's Multi-function button to answer and end a call.



2. Press and hold either earbud's Multi-function button for 1.5 seconds to reject an incoming call.

FCC Statement

FCC ID: 2AMD8-PROW

Changes or modifications not expressly approved by the party responsible for compliance could void the user's authority to operate the equipment.

This device complies with Part 15 of the FCC Rules. Operation is subject to the following two conditions: (1) this device may not cause harmful interference, and (2) this device must accept any interference received, including interference that may cause undesired operation.

This equipment has been tested and found to comply with the limits for a Class B digital device, pursuant to Part 15 of the FCC Rules. These limits are designed to provide reasonable protection against harmful interference in a residential installation. This equipment generates, uses and can radiate radio frequency energy and, if not installed and used in accordance with the instructions, may cause harmful interference to radio communications. However, there is no guarantee that interference will not occur in a particular installation.

If this equipment does cause harmful interference to radio or television reception, which can be determined by turning the equipment off and on, the user is encouraged to try to correct the interference by one or more of the following measures:

- Reorient or relocate the receiving antenna.
- Increase the separation between the equipment and receiver.
- Connect the equipment into an outlet on a circuit different from that to which the receiver is connected.
- Consult the dealer or an experienced radio/TV technician for help.

The device has been evaluated to meet general RF exposure requirement. The device can be used in the portable exposure condition without restriction.