

Smart GPS Bike Computer

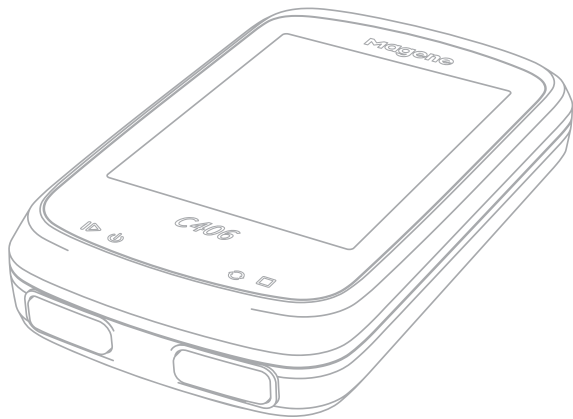

Model:C406

FCC Statement

Any Changes or modifications not expressly approved by the party responsible for compliance could void the user's authority to operate the equipment.cou
 This device complies with part 15 of the FCC Rules. Operation is subject to the following two conditions: (1) This device may not cause harmful interference, and
 (2) This device must accept any interference received, including interference that may cause undesired operation.

FCC Radiation Exposure Statement:

This equipment complies with FCC radiation exposure limits set forth for an uncontrolled environment .This equipment should be installed and operated with minimum distance 20cm between the radiator& your body.

Package Contents



①Main bike computer ②Bike computer mount ③Charging Cable

Optional Accessories:

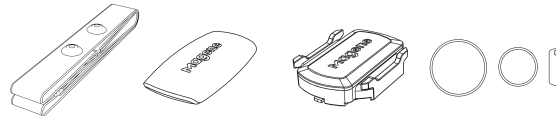

④Heart Rate Monitor Strap
 ⑤Heart Rate Monitor Unit
 ⑥Speed/Cadence Sensor Accessories

Bike Computer Installation Guide

Step1- Open the clamp and attach to the handlebar. Stick the clamp to the handbar

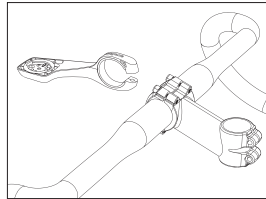

Step2- Tighten the screw

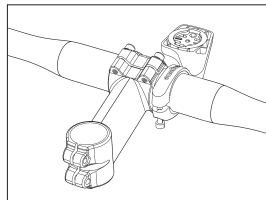

Step3- Install the computer according to the direction indicated by the arrow, Rotate the bike computer

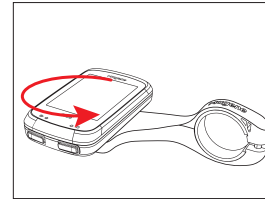

Step4- Completed

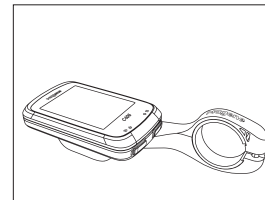

Smart Phone Companion App

After acquiring your C406 computer, please download the Magene Utility:



1. Activating the GPS Bike Computer

- Step 1- Use the app to search for the bike computer.
- Step 2- Enter a valid mobile phone number to receive a verification code
- Step 3- Verification is complete

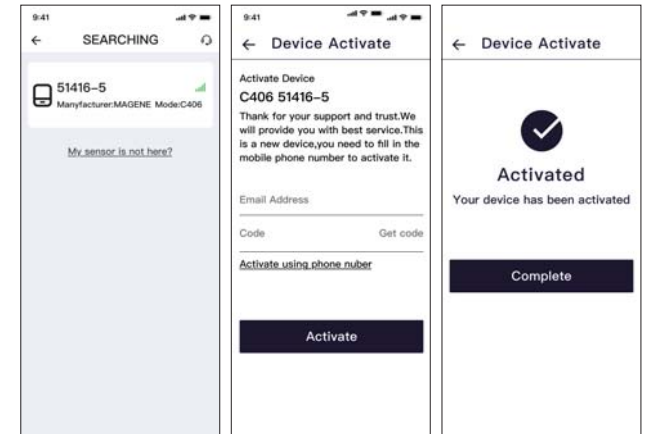

2. Binding the GPS Bike Computer

Long-press the right-hand button to bind your bike computer with the app. At each startup the app will automatically search for the bike computer look for new ride records and sync the data.



3. Settings

After completing the activation and binding procedures, you'll be brought to the settings screen. Here you can adjust the number of pages, and the content of each page to give options for a "limitless screen expansion" and adjust the auto-shutdown time, sound on/off, current time zone, personal information, etc.

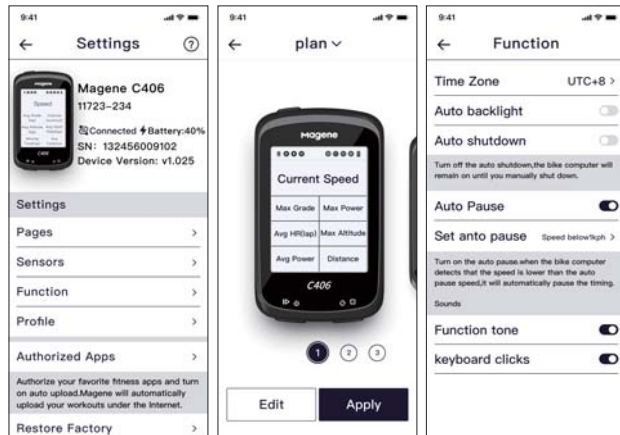

4. Connecting new sensors

The C406 supports a wide range of external sensors such as speed sensors, cadence sensors, power meters, and heart rate monitors. Please follow these steps to connect your sensors:

Step 1- Search for the sensor

Step 2- Click on your device in the list

Step 3- The device you selected is displayed in the "Connected Devices" position and connection is complete.

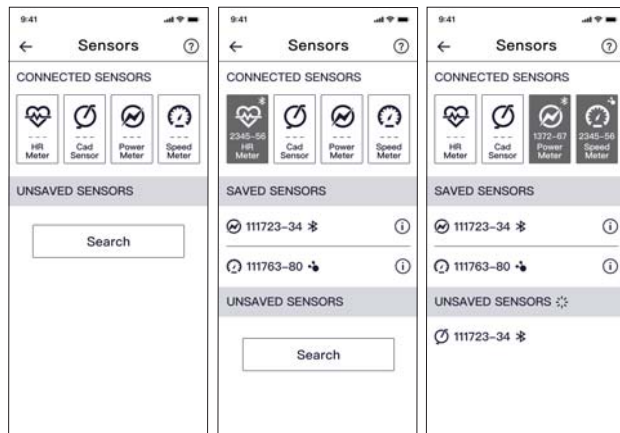

5. Syncing and analyzing data

After finishing your ride, open the Onelap app on your phone. The app will automatically sync the data you can also manually send ride records to the phone. In the app, "Mine", "Ride Records" – you can analyze all ride records on the device.

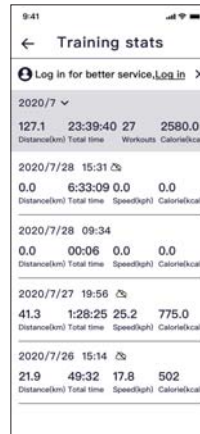

Bike Computer Unit Main Functions

1. Button Functions

Unit State	A Key	B Key	C Key
Powered off	Long press: Turn on device		
Ready State	Short press: Start ride Long Press Turn off device	Short press: Next page	Long press: Turn on/off backlight
Ride in progress	Short press: Pause Ride Long press: Turn off device	Short press: Next page Long press: End ride and return to ready state	Short press: New lap Long press: Turn on/off backlight
Ride Paused	Short press: Continue ride Long press: Turn off device	Short press: Next page Long press: End ride and return to ready state	Long press: Turn on/off backlight
Powered on	Long press A+B together: Calibrate power meter		

2.Charging

Open the rubber cover on the back of the device to charge via USB

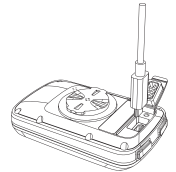

C406 Smart GPS Bike Computer Warranty Terms

Warranty:

Thank you for purchasing the Magene C406 Smart GPS Bike Computer. Please read the following clauses carefully to ensure that the product has a valid warranty.

Three Guarantees:

This product has passed strict quality control inspections. According to the instructions of this warranty card, we will give free warranty for the failure caused by product quality under normal use conditions within the warranty period. The product warranty period is 24 months, subject to the activation time. For non-activated products, the date of purchase shall prevail. If there is no date of purchase, the date of shipment shall prevail. Product warranty repair needs to select the specified logistics and transportation; otherwise the user will bear the freight or the loss caused by transportation.

The following situations are not within the scope of the Three Guarantees:

1. The validity period of the three guarantees is exceeded.
2. Any loss caused by improper use, maintenance and storage.
3. Failure to use or install according to the instructions causes damage to the product.
4. Unauthorized maintenance, misuse, collision, negligence, abuse, liquid infusion, accidents, changes, unclear use of non-product accessories.
5. Unauthorized alteration of the Three Guarantees certificate.
6. There is no valid three guarantees certificate and valid invoice.
7. The product number and code on the three-guarantee certificate do not match the physical product.
8. Other failures and damages caused by problems other than product design, manufacturing, quality, etc.
9. Wear and dirt caused by normal use such as: scratches, and damage caused by factors such as contact with chemical reagents, sharp objects, drops, squeezing, etc.
10. Damage caused by force majeure.

Product after-sale service period:

The company provides lifetime after-sales service for products. When the product is beyond the warranty period, the cost and transportation cost will be charged when the product fails to repair, and the labor and accessories cost and transportation freight will be charged when the artificial damage is repaired. The company reserves the right to modify and interpret the above content.