

The Lenovo logo, consisting of the word "Lenovo" in white sans-serif font on a black rectangular background, with a small trademark symbol (TM) to the right of the word.

# Lenovo Heart Rate Band

# G10

USER GUIDE



## Quick User Guide

### **1 Download“Lenovo Go”APP**

The Lenovo Heart Rate Band need to support the phone connection. Please check the compatible list before download to ensure your phone is matched.

#### **Search to download**

Search“Lenovo Go”in APP Store or Google Play anddownload the APP.

### **2 Product Activation and charging**

For the first time use, please inser the USB port to charge the wristband.

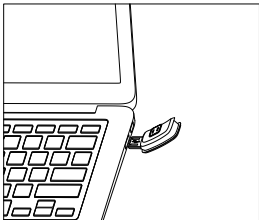

### 3 How to use?



Single click the touch button to activate wristband's screen and turn page



Long press the touch button to enter and exit sports mode



Single click the touch button to choose sports type and waiting to start

#### 4 Pair G10 with Lenovo Go APP



Register an account or login

---



Register by email

---



Search and connect your device in the APP

---

## **5** How to replace the wristband's bracelet?

1. Look for the "open" sign on the inside of the bracelet.
2. Release and remove the bracelet gently.



## **6** How to wear?

Use right thumb and index finger to press buckle strap, remain just a finger gap for proper tightness.

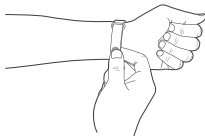

## **7 Users Instruction**

**Time display:**synchronized with the phone, the wristband will automatically calibrate the time

**The notification:**Incoming call,Facebook, SMS WhatsApp,WeChat text,Twitter.

**Activity log:**record your daily activities, identify dynamically for different motion status,to calculate calorie consumption more scientifically.

**Sleep log:**the wristband can recognize your status automatically,and record your sleeping quality.

**Heart rate monitor:**users can monitor heart rate at any time of static condition,band will also monitor and auto record the heart rate data regularly.If any movement detected, the band will delay in reporting.

### **Common Problem**

#### **■ Cannot find the band during paring?**

1.Please ensure your phone is on the compatible list and enable the bluetooth function.

2.Please ensure the band and the phone is in the Bluetooth connection range(in 10 meters)

3. Please ensure the band's power condition. If problem still not solved after battery charged, please contact us.

### ■ **Bluetooth disconnected occasionally?**

The situation appeared occasionally when the Bluetooth is connected with the other phones.

### ■ **Wristband fail to receive the message?**

If it is connected successfully but fail to receive the messages, please try out the following steps:

1. Go to the security setting on the phone, enable the access to read the message
2. If it can't be resolved, please connect the G10 with APP again and click the button of "factory reset" in the main menu, clear up the data and reconnect the wristband.

### ■ **How to restore the factory setting**

1. If the wristband has connected with the phone, select the "device" in APP, click restore the factory setting.
2. While charging the wristband, long press the "battery and device ID" to wake up the restore setting option.



## Environmental, recycling, and disposal information

### General recycling statement

Lenovo encourages owners of information technology (IT) equipment to responsibly recycle their equipment when it is no longer needed. Lenovo offers a variety of programs and services to assist equipment owners in recycling their IT products. For information on recycling Lenovo products, go to:

<http://www.lenovo.com/recycling>.

### Important WEEE information



Electrical and electronic equipment marked with the symbol of a crossed-out wheeled bin may not be disposed as unsorted municipal waste. Waste of electrical and electronic equipment (WEEE) shall be treated separately using the collection framework available to customers for the return, recycling, and treatment of WEEE.

Country-specific information is available at:

<http://www.lenovo.com/recycling>

## Recycling information for India

Recycling and disposal information for India is available at:

[http://www.lenovo.com/social\\_responsibility/us/en/sustainability/ptb\\_india.html](http://www.lenovo.com/social_responsibility/us/en/sustainability/ptb_india.html).

## Battery recycling mark

### Battery recycling information for the European Union



Batteries or packaging for batteries are labeled in accordance with European Directive 2006/66/EC concerning batteries and accumulators and waste batteries and accumulators. The Directive determines the framework for the return and recycling of used batteries and accumulators as applicable throughout the European Union. This label is applied to various batteries to indicate that the battery is not to be

thrown away, but rather reclaimed upon end of life per this Directive. In accordance with the European Directive 2006/66/EC, batteries and accumulators are labeled to indicate that they are to be collected separately and recycled at end of life. The label on the battery may also include a chemical symbol for the metal concerned in the battery ( Pb for lead, Hg for mercury, and Cd for cadmium). Users of batteries and accumulators must not dispose of batteries and accumulators as unsorted municipal waste, but use the collection framework available to customers for the return, recycling, and treatment of batteries and accumulators. Customer participation is important to minimize any potential effects of batteries and accumulators on the environment and human health due to the potential presence of hazardous substances. For proper collection and treatment, go to: <http://www.lenovo.com/recycling>.

## **Restriction of Hazardous Substances Directive (RoHS)**

### **Turkish**

The Lenovo product meets the requirements of the Republic of Turkey Directive on the Restriction of the Use of Certain Hazardous Substances in Waste Electrical and Electronic Equipment (WEEE).

### **Türkiye AEEE Yönetmeliğine Uygunluk Beyanı**

Bu Lenovo ürünü, T.C. Çevre ve Orman Bakanlığı'nın "Atık Elektrikli ve Elektronik Eşya Bazı Zararlı Maddelerin Kullanımının Sınırlandırılmasına Dair Yönetmelik (AEEE)" direktiflerine uygundur. AEEE Yönetmeliğine Uygundur.

### **Ukraine**

Цим підтверджуємо, що продукція Леново відповідає вимогам нормативних актів України, які обмежують вміст небезпечних речовин

## **India**

RoHS compliant as per E-Waste (Management & Handling) Rules, 2011.

## **Vietnam**

Lenovo products sold in Vietnam, on or after September 23, 2011, meet the requirements of the Vietnam Circular 30/2011/TT-BCT ("Vietnam RoHS").

## **European Union**

Lenovo products sold in the European Union, on or after 3 January 2013 meet the requirements of Directive 2011/65/EU on the restriction of the use of certain hazardous substances in electrical and electronic equipment ("RoHS recast" or "RoHS 2").

For more information about Lenovo progress on RoHS, go to:

[http://www.lenovo.com/social\\_responsibility/us/en/RoHS\\_Communication.pdf](http://www.lenovo.com/social_responsibility/us/en/RoHS_Communication.pdf)

## **FCC Statement**

This equipment has been tested and found to comply with the limits for a Class B digital device, pursuant to Part 15 of the FCC Rules. These limits are designed to provide reasonable protection against harmful interference in a residential installation. This equipment generates uses and can radiate radio frequency energy and, if not installed and used in accordance with the instructions, may cause harmful interference to radio communications. However, there is no guarantee that interference will not occur in a particular installation. If this equipment does cause harmful interference to radio or television reception, which can be determined by turning the equipment off and on, the user is encouraged to try to correct the interference by one or more of the following measures:

- Reorient or relocate the receiving antenna.

- Increase the separation between the equipment and receiver.
- Connect the equipment into an outlet on a circuit different from that to which the receiver is connected.
- Consult the dealer or an experienced radio/TV technician for help.

This device complies with part 15 of the FCC Rules. Operation is subject to the following two conditions:

(1) This device may not cause harmful interference, and (2) this device must accept any interference received, including interference that may cause undesired operation.

Changes or modifications not expressly approved by the party responsible for compliance could void the user's authority to operate the equipment.

Manufactured, distributed, or sold by  
Beijing Kangshuo Information  
Technology Co.,Ltd official licensee  
for this product.

LENOVO and the Stylized LENOVO  
Logo are trademarks or registered  
trademarks of Lenovo (Beijing) Ltd

All other trademarks are the property  
of their respective owners.

**FCC ID:2ALYI-G10**  
**SDPPI**  
**IDA**



**Bluetooth®**

**RoHS**

Complies With  
IDA Standards  
DB106306



**Reduce | Reuse | Recycle**



Printed in China