

Handheld Remote Instruction Sheet

Model No.: RFR

1. Introduction

The handheld touch remote control allows a user to control up to 32 channels of motorized shading devices. It uses Bluetooth technology to communicate with a wireless gateway that is part of the motor control core network.

2. Safety

2.1 Safety and responsibility

Please read this guide carefully before installing and using this product.

2.2 Warning

- a) Do not spill liquid on the product or immerse it in liquid.
- b) Do not use abrasive products or solvents to clean the product.

3. Contents

See Fig.1.

Items	Description	Quantity
1	Remote	1
2	Wall mount	1
3	Screw Kit	1
4	Type AAA batteries	2

4. Touch Remote in detail

Warning Statement

This device complies with part 15 of the FCC Rules. Operation is subject to the following two conditions: (1) This device may not cause harmful interference, and (2) this device must accept any interference received, including interference that may cause undesired operation.

Any Changes or modifications not expressly approved by the party responsible for compliance could void the user's authority to operate the equipment.

Note:

This equipment has been tested and found to comply with the limits for a Class B digital device, pursuant to part 15 of the FCC Rules. These limits are designed to provide reasonable protection against harmful interference in a residential installation. This equipment generates uses and can radiate radio frequency energy and, if not installed and used in accordance with the instructions, may cause harmful interference to radio communications. However, there is no guarantee that interference will not occur in a particular installation. If this equipment does cause harmful interference to radio or television reception, which can be determined by turning the equipment off and on, the user is encouraged to try to correct the interference by one or more of the following measures:

- Reorient or relocate the receiving antenna.
- Increase the separation between the equipment and receiver.
- Connect the equipment into an outlet on a circuit different from that to which the receiver is connected.
- Consult the dealer or an experienced radio/TV technician for help.

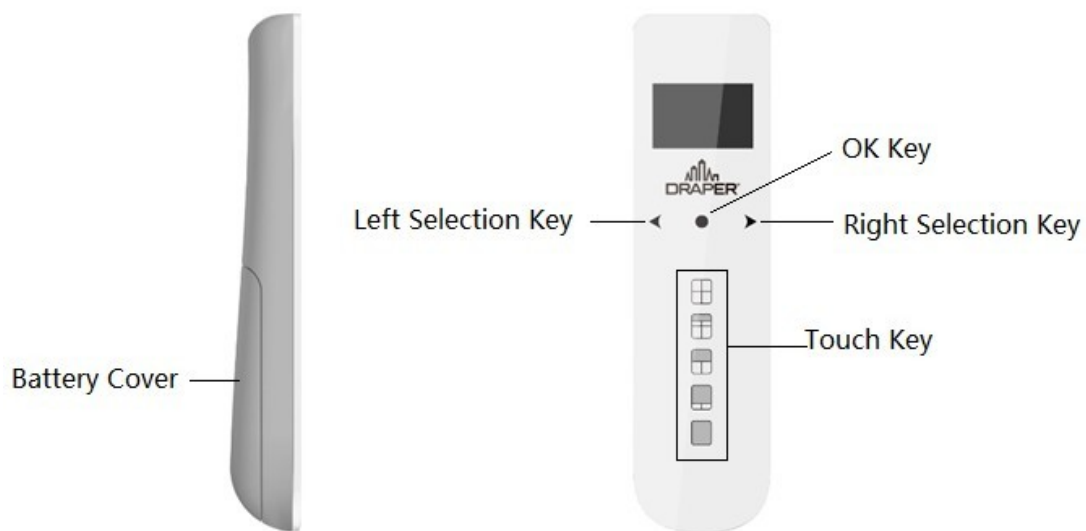

Icon	Description	Function
	Left selection key	Choose the previous option from the menu
	Right selection key	Choose the next option from the menu
	OK key	Confirm the selected option
	Touch key	<p>Tap to stop moving shades</p> <p>Tap to move shades to the closest preset stop</p> <p>Swipe to move to upper or lower limits</p>

5. Technical data

Remote control dimensions	151 x 40 x 22mm
Power supply	2 Type AAA batteries
Working current	10mA
Current in sleeping mode	20uA
Communication technology	Bluetooth 2.4GHz

6. Commissioning

Before using the remote, ensure the core motor control system is commissioned with a Wireless Gateway in the network. See Fig.2 for the core system diagram.

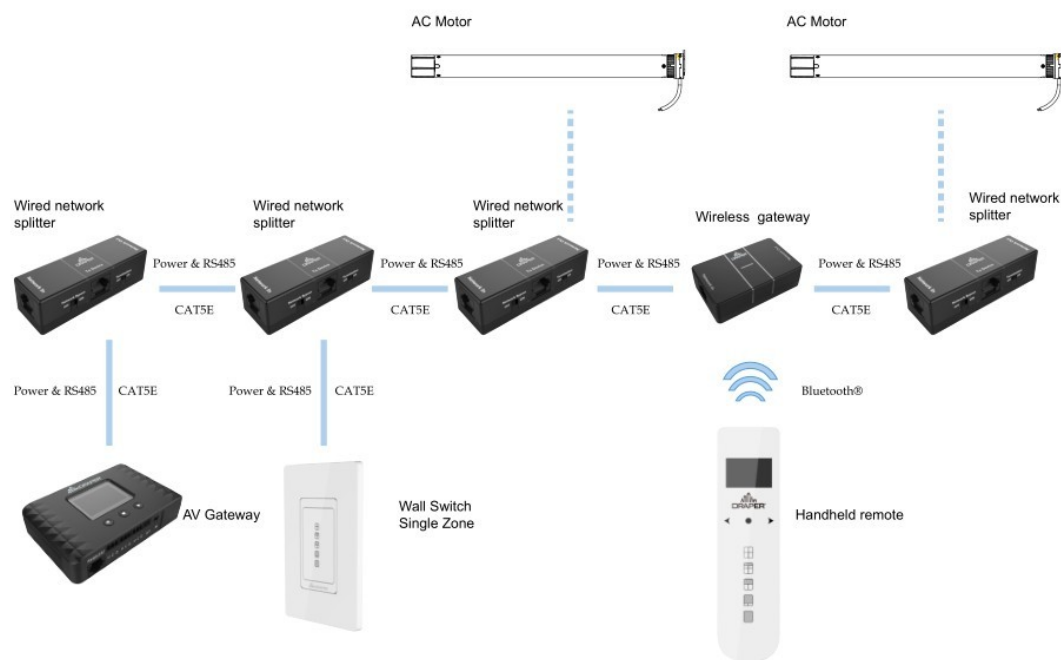

Fig.2 Core system Diagram

6.1 Battery installation

- Remove the battery cover from the back of the touch remote.
- Insert 2 AAA batteries, following the indicated polarity.
- Set the power switch to the "ON" position to turn on the touch remote
- Replace the battery cover on the rear of the touch remote. See Fig.3.



Fig.3 Battery Installation

6.2 Pairing with Wireless Gateway

- a) After powering ON, the remote will display “Connecting...” . The Red and Blue LEDs on the Wireless Gateway will also alternately blink. See Fig.4.



Fig.4 Connecting to Wireless Gateway

- b) Ensure the distance between the Wireless Gateway and touch remote is less than 10 meters when connecting to achieve better signal quality. After connected, it will show Channel 1 by default. See Fig.5.

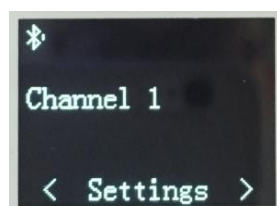



Fig.5 Settings Homepage

6.3 Channel Settings customization

Tap  to modify Channel Settings. There are 5 options in this menu.

Tap  to scroll between the options. See Fig.6.

- 1) Change Name
- 2) Set Channel
- 3) Add Channel
- 4) Delete Channel
- 5) Done



Fig.6 Channel Settings Menu

6.3.1 Change Name

When Change Name is selected, tap  to access the submenu as shown in Fig.7. There are 4 name options to choose from.

- 1) Bedroom
- 2) Living Room
- 3) Office
- 4) Boardroom

Choose the name you want, then tap  to confirm.

Once the name is set, it will return to the Settings homepage.

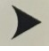



Fig.7 Change Name Process

6.3.2 Set Channel

Highlight the Set Channel option, then tap  to begin the channel setting procedure.

Once started, a shade will begin identifying.

Tap  to Add shade, or tap  to Skip shade. The next shade will start identifying. Continue until all shades for the channel have been set, then tap  to finish. See Fig.8.

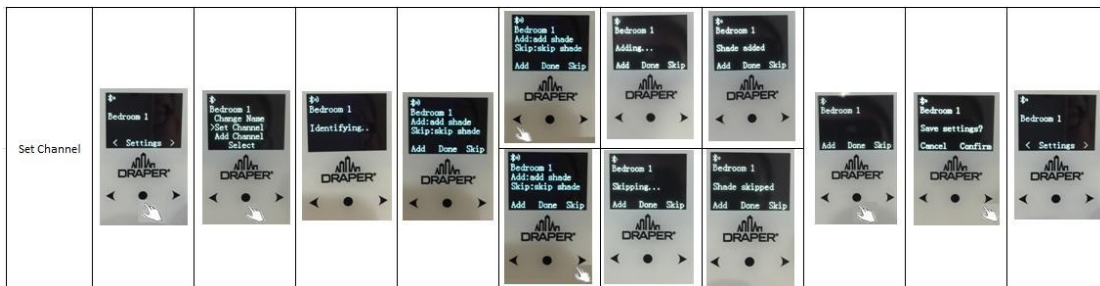

Fig.8 Set Channel Process

6.3.3 Add Channel

See Fig.9 for the procedure to add a new channel.

Up to 32 channels can be added.



Fig.9 Add Channel Process

6.3.4 Delete Channel

See Fig.10 for the procedure to delete a channel.

This option is disabled if there is only one channel remaining.



Fig.10 Delete Channel Process

6.3.5 Done

Select Done to return to homepage.

7. Sleep Mode and Wakeup Function

- To reduce power consumption, the touch remote will enter into sleep mode after 30 seconds with no operation.
- The remote will wake up if any of active touch areas are tapped. It will show the "Connecting..." dialog.

