

poppah™

S1 PORTABLE SPEAKER

USER'S GUIDE

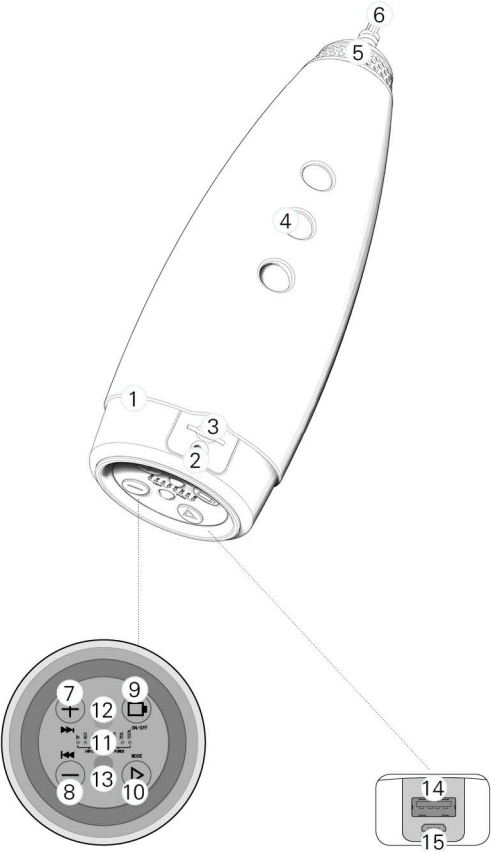



- | | |
|-----------------|-------------------------------------|
| 1. SPEAKER 1 | 9. ON/OFF |
| 2. AUX IN | 10. PAUSE / PLAY / MODE(LONG PRESS) |
| 3. TF CARD SLOT | 11. STATUS INDICATOR |
| 4. SOUND HOLE | 12. FLASHLIGHT |
| 5. SPEAKER 2 | 13. ON/OFF INDICATOR |
| 6. HANGING RING | 14. DC OUT 5V 2A |
| 7. VOLUME UP | 15. DC IN 5V 2A |
| 8. VOLUME DOWN | |

I、ON/OFF/FLASHLIGHT

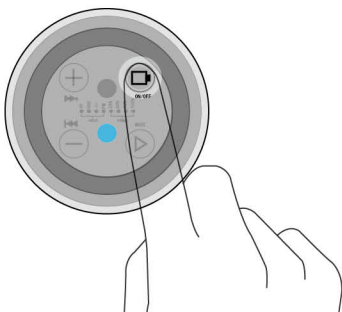

Single-click the On/Off button to turn on or off the device. Double-click the On/Off button to turn on the flashlight. System will be reset after being pressed for 3 secs.

After the device is turned on, it will play a boot music, and indicate the remaining power (screen will be off after 60 secs), and then enter different modes according to the following situations (priority: AUX, Bluetooth, TF card, FM) :



1, When the device detects an audio input, it will enter AUX mod. Now the AUX indicator is on, and it will automatically play AUX audios.



2, When the device detects an available TF card, it will enter TF Card mode. Now the TF Card indicator is on, and it will automatically play the first song in the TF card.



3, When the device detects no audio sources from AUX or TF card, it will enter Bluetooth mode. Now the Bluetooth indicator is on, the indicator will flash rapidly, the device is ready to be connected.

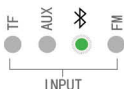

II、MANUAL SWITCH MODE

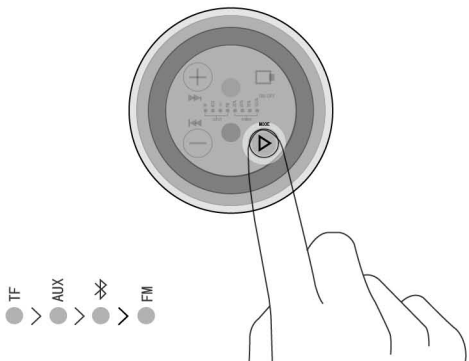

Long press "△" key to switch the play mode, the sequence is: TF card → AUX → Bluetooth → FM. (When there is no audio input, the switch is invalid, such as: No TF card is inserted, it is skipped directly when switching, and so on.)

III、PLAYER

Mobile phones, computers and other players with Bluetooth.

Poppah-S1)))



1、Bluetooth Pairing:

Connect to Poppah™ Portable Speaker via a Bluetooth device such as a cell phone / computer(Bluetooth name is: "Poppah-S1"). After it's connected, the Bluetooth indicator will flash slowly and play the Bluetooth successful connection sound effect. Now we can play the music.(Low-version Bluetooth devices should enter the password "0000" before connection).

Three Time



Flash Status



Replace Paired Equipment:

If you want to connect another Bluetooth device when the Poppah™ Bluetooth has been already connected, you can press the "△" key for three times. Now Poppah™ will disconnect and enter Bluetooth pairing , the Bluetooth indicator will flash rapidly.

Answer Phone Calls:

Press "△" key to play/pause music. Also press it to answer calls.

2、TF Card Play



Insert a TF card (up to 32GB) with songs (support for all lossless formats: APE, FLAC, MP3, WAV and most current music formats), Poppah™ Bluetooth speaker enters TF card mode.

Now it will play music. The TF card indicator will flash slowly and be always on when it's paused.

3、AUX



Plug-in an audio cable to the AUX port, it will switch to AUX mode (AUX mode will be invalid without an audio cable plugged in). Now the AUX indicator light flashes slowly. You can choose your favorite music on the external audio player. (Under AUX mode, press the "△" key to mute, and the AUX indicator is always on.)

4、Radio



Poppah™ Bluetooth has a built-in FM radio, you can long press the "△" key to enter the FM radio mode (may need to operate multiple times, the device will switch among four modes).

When it's under FM mode, simply press the "△" key to search and store the stations and press "+", "-" key to change any station.

⚠ Note :

(1) The quantity and quality of FM radio stations depend on the local radio stations and the environment. With the same signal strength, the obstacle-intensive places (such as the cities) the quality of radio is worse than in the open places (such as suburbs).

(2) When you come into a new place, please press the Play key to search the radio stations again.

5、Volume Adjustment



Press the "+" key to turn up the volume, and press the "-" key to turn down the volume.

If the audio source is from AUX or Bluetooth audio, you may also need to adjust the volume on the AUX source player, or the Bluetooth device.

6、Track / Radio Selection (FM Radio Mode)



Bluetooth / TF card mode: long press "+" key to play the next track, long press "-" key to play the last track.



FM Radio mode: long press "+" key to switch to the next stored station, long press "-" key to switch to the last stored station.



Note:

This function does not apply to AUX mode.

IV、CHARGE

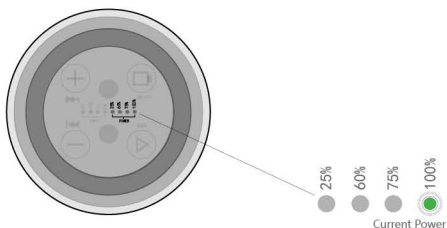

When the power is low, connect it to a computer or DC5V / 1A, or DC5V / 2A charger with an USB cable.

When being charged, the power indicator will display the current power, and the corresponding light will flash continuously.



When fully charged, the power indicator lights will be all on. Now we should disconnect the USB cable and finish the charging.



!! WARNING:

Must use a reliable charger! Otherwise it may result in a short circuit, device destroyed or even a fire!

V、CHARGING PO FUNCTION



Poppah™ Bluetooth audio can charge other devices, output: 5V ~ 2A.

VI、 SPECIFICATION

Power amplifier:

Rated output power: 8W, impedance 4 ohms.

Signal to noise ratio: ≥ 85 dB

Frequency response range: 80Hz ~ 20KHz

Input sensitivity: ≤ 250 mV

Connectivity:

Bluetooth mode: A2DP, AVRCP, HFP, HSP

Bluetooth version: 4.2 dual mode (BLE)

General Message:

Charging: DC5V 2A

Power supply: 5000 mAh Built-in rechargeable lithium polymer battery (2x2500mAh)

VII、 SAFETY WARNING



high temperature



high pressure



Fire source



Wading

The device has a large capacity built-in lithium-polymer battery, its storage and use must avoid high temperature, high pressure, fire, wading and other environments.



fall



collision

Avoid falling or collision.

COMPANY INFORMATION:

Name:
Shenzhen Neukong Science and Technology Co., Ltd

Address:
Longgang District, Shenzhen, South Bay Street, Lan Lan Road, Li Lan,
a design park 606

mailbox: support@neukong.com

URL: <http://www.neukong.com>

In the end,

Thank you very much for choosing our products!
Wish you a pleasant experience!!

Neukong Technology Corporation Limited.

yours truly!

March 2017

FCC Statement

This equipment has been tested and found to comply with the limits for a Class B digital device, pursuant to Part 15 of the FCC Rules. These limits are designed to provide reasonable protection against harmful interference in a residential installation. This equipment generates uses and can radiate radio frequency energy and, if not installed and used in accordance with the instructions, may cause harmful interference to radio communications. However, there is no guarantee that interference will not occur in a particular installation. If this equipment does cause harmful interference to radio or television reception, which can be determined by turning the equipment off and on, the user is encouraged to try to correct the interference by one or more of the following measures:

- Reorient or relocate the receiving antenna.
- Increase the separation between the equipment and receiver.
- Connect the equipment into an outlet on a circuit different from that to which the receiver is connected.
- Consult the dealer or an experienced radio/TV technician for help.

This device complies with part 15 of the FCC Rules. Operation is subject to the following two conditions:(1) This device may not cause harmful interference, and (2) this device must accept any interference received, including interference that may cause undesired operation.

Changes or modifications not expressly approved by the party responsible for compliance could void the user's authority to operate the equipment.

The device has been evaluated to meet general RF exposure requirement. The device can be used in portable exposure condition without restriction.

