

WIRELESS DOORBELL INSTALLATION INSTRUCTION

DOORBELL KEY INSTALLATION

1. OPEN THE BATTERY DOOR, INSERT ONE 9 VOLT(6F22) BATTERY INTO THE BATTERY COMPARTMENT WITH CORRECT POLARITY.
2. CLOSE THE BATTERY DOOR.
3. CHOOSE THE PLACE TO MOUNT THE DOORBELL KEY.
4. USE PENCIL TO MARK THE SCREW HOLES FOR THE BELL KEY.
(SHOWN IN FIG. 1)
5. REMOVE THE BELL KEY AND DRILL THE REQUIRED HOLES.
6. SECURE THE BELL KEY IN PLACE WITH TWO SCREWS.

OPERATION:PRESS THE BELL KEY,ITS RED LED LIGHTS ON AND IT STARTS TO SEND WIRELESS SIGNAL. THE RECEIVER CHIME CAN SOUND MUSIC UNTIL THE BELL KEY STOPS SENDING WIRELESS SIGNAL AFTER RELEASING THE BELL KEY AND ITS RED LED TURNING OFF.

HINTS : IF WHEN THE BELL KEY IS PRESSED AND THE RED LIGHT DOES NOT GO ON, THAT INDICATES THE KEY'S BATTERY IS LOW. REPLACE WITH A NEW BATTERY

THE TWO RECTANGLE ADHESIVES ARE TO BE PLACED ON THE FRONT OF DOORBELL RECEIVER TO LOWER THE SOUND VOLUME IF NEEDED

CHANGE THE BATTERY

1. REMOVE THE BELL KEY FROM WHERE IT IS MOUNTED WITH A SCREW DRIVER.
2. OPEN THE BATTERY DOOR. (SHOWN IN FIG. 1)
3. INSERT A NEW BATTERY.
4. SECURE THE BELL KEY BACK INTO POSITION.

DOORBELL RECEIVER INSTALLATION

1. HOLD THE DOORBELL RECEIVER FROM THE PLASTIC CASING CAREFULLY. DO NOT TOUCH THE METAL PARTS.(SHOWN IN FIG .2)
2. PLUG THE DOORBELL RECEIVER INTO ANY A.C. (110 VOLT) OUTLET UP TO 50 FEET AWAY FROM DOORBELL KEY.
3. PLUG ANOTHER DOORBELL RECEIVER INTO ANOTHER A.C. (110 VOLT) OUTLET UP TO 50 FEET AWAY FROM DOORBELL KEY.

C. No. : Pe9202 INST. VER.0

PRINTED IN CHINA
MAP 2009/10

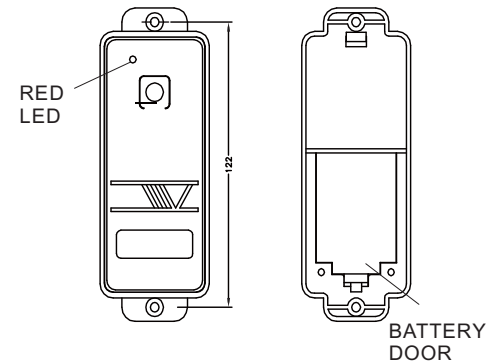

FIG. 1

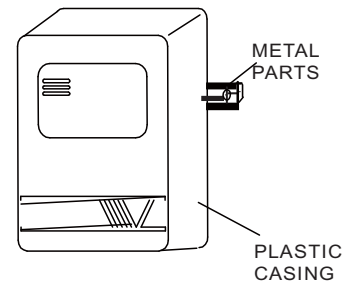

FIG. 2

FCC Statement:

1. This device complies with Part 15 of the FCC Rules. Operation is subject to the following two conditions:

(1) This device may not cause harmful interference.

(2) This device must accept any interference received, including interference that may cause undesired operation.

2. Changes or modifications not expressly approved by the party responsible for compliance could void the user's authority to operate the equipment.

NOTE: This equipment has been tested and found to comply with the limits for a Class B digital, pursuant to Part 15 of the FCC Rules. These limits are designed to provide reasonable protection against harmful interference in a residential installation. This equipment generates, uses and can radiate radio frequency energy and, if not installed and used in accordance with the instructions, may cause harmful interference to radio communications. However, there is no guarantee that interference will not occur in a particular installation. If the equipment does cause harmful interference to radio or television reception, which can be determined by turning the equipment off and on, the user is encouraged to try to correct the interference by one or more of the following measures:

--- Reorient or relocate the receiving antenna.

--- Increase the separation between the equipment and receiver.

--- Connect the equipment into an outlet on a circuit different from that to which the receiver is connected.

--- Consult the dealer or an experienced radio/ TV technician for help.