

INSIGNIA™

QUICK SETUP GUIDE

Qi Wireless Charging Pad

NS-MWPC2 / NS-MWPC2-C

PACKAGE CONTENTS

- Qi Wireless Charging Pad
- Micro USB charge/sync cable
- Power adapter
- Quick Setup Guide

Before using your new product, please read these instructions to prevent any damage.

展开尺寸 (W×H): 12 × 2.75 in. (304.8 × 69.85 mm)
 折叠尺寸: 3 × 2.75 in. (76.2 × 69.85 mm)
 材质: 80克书纸

COMPATIBILITY

Works with all Qi v1.2.2 and newer devices. This includes Samsung devices such as the Note 5, S6 Edge, S6, S6 Edge +, S7 Edge, and S7.

PRODUCT OVERVIEW



USING YOUR CHARGING PAD

- 1 Connect the micro USB charge/sync cable to the micro USB port on your charging pad.
- 2 Plug the USB connector into the power adapter.
- 3 Connect the power adapter to the power outlet.

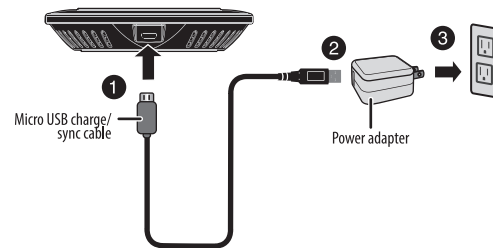

- 4 Place your Qi-enabled device on the charging pad with the screen facing up. The LED is blue or purple when your device is charging.

Note: If the LED is red, your device is not charging. See "Troubleshooting" for more information.

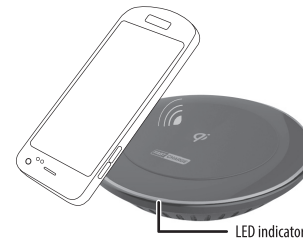



LED INDICATOR STATUS

LED	STATUS
Blue	Device is charging.
Purple (solid)	Fast wireless charging (only if your device is compatible).
Red (solid)	Device is not charging. See "Troubleshooting" for more information.
Off	Charging pad is not connected to power.

TROUBLESHOOTING

Device not charging/LED is red

- Make sure that your device is Qi-enabled.
- Make sure that your charging pad is connected to a working power outlet.
- Make sure that you are using the power adapter that came with this product.
- Make sure that your device is positioned correctly on your charging pad.
- Make sure that there are no other objects on the charging pad.
- Remove your device's case. It may be blocking the wireless signal.



Device charges slowly

- Your device may charge more slowly with the charging pad than a charging cable.
- Make sure that you are using the power adapter that came with this product.
- Make sure that your device is positioned correctly on your charging pad.

SPECIFICATIONS

Qi Wireless Charging Pad:

- Input: 5V/2A, 9V/1.67A
- Output: 10W Max
- Dimension: 3.9 × 0.8 in.
(100 × 20.5 mm)
- Weight: 70+/-5 g
- Qi version: 1.2.2

AC Power Adapters:

- Input: 100-240V, 50/60Hz, 0.4A
- Output: 5V/2A, 9V/1.67A, 12V/1.25A

LEGAL NOTICES

FCC Information

FCC Caution: Changes or modifications not expressly approved by the part responsible for compliance could void the user's authority to operate the equipment.

FCC Statement: This equipment has been tested and found to comply with the limits for a Class B digital device, pursuant to part 15 of the FCC Rules. These limits are designed to provide reasonable protection against harmful interference in a residential installation. This equipment generates, uses and can radiate radio frequency energy and, if not installed and used in accordance with the instructions, may cause harmful interference to radio communications. However, there is no guarantee that interference will not occur in a particular installation. If this equipment does cause harmful interference to radio or television reception, which can be determined by turning the equipment off and on, the user is encouraged to try to correct the interference by one or more of the following measures:

- Reorient or relocate the receiving antenna.
- Increase the separation between the equipment and receiver.
- Connect the equipment into an outlet on a circuit different from that to which the receiver is connected.

—Consult the dealer or an experienced radio/TV technician for help.

FCC statement: This device complies with part 15 of the FCC Rules. Operation is subject to the following two conditions: (1) This device may not cause harmful interference, and (2) this device must accept any interference received, including interference that may cause undesired operation.

RSS-Gen statement:

This device complies with Industry Canada license-exempt RSS standard(s). Operation is subject to the following two conditions: (1) this device may not cause interference, and (2) this device must accept any interference, including interference that may cause undesired operation of the device.

Le présent appareil est conforme aux CNR d'Industrie Canada applicables aux appareils radio exempts de licence. L'exploitation est autorisée aux deux conditions suivantes : (1) l'appareil ne doit pas produire de brouillage, et (2) l'utilisateur de l'appareil doit accepter tout brouillage radioélectrique subi, même si le brouillage est susceptible d'en compromettre le fonctionnement.

SAFETY INFORMATION

- 1 Use only the power adapter that came with the product. Do not make unauthorized changes to the power supply.
- 2 Do not attempt to disassemble the product. It may result in short-circuit or damage.
- 3 The product should be kept in a dry and ventilated environment. Do not store it in an area of high humidity and high temperature.
- 4 Do not use an organic solvent to clean the product.

ONE-YEAR LIMITED WARRANTY

Visit www.insigniaproducts.com for details.

CONTACT INSIGNIA:

For customer service, call U.S. and Canada (877-467-4289)
Mexico (01-800-926-3000)
www.insigniaproducts.com

INSIGNIA is a trademark of Best Buy and its affiliated companies
Distributed by Best Buy Purchasing, LLC
7601 Penn Ave South, Richfield, MN 55423 U.S.A.
©2017 Best Buy. All rights reserved. **Made in China**

V3 ENGLISH 17-0217

