

# MAGIC STICK™

User Manual

## Package included



Magicstick



Power adapter



USB cable



HDMI Male to Female cable



Bag for Magicstick



User Manual

## Optional accessories

- USB C type dock
- HDMI VGA Adaptor
- Keyboard and Mouse kits
- Remote control

## Notices :

- ☐ Before power off Magicstick, please turnoff all running programs and power off OS. Magicstick has battery inbuilt, Please don't keep device running on battery for longer time.
- ☐ Power adapter, USB cable and HDMI cable must maintain good connection. Please avoid loose connection and voltage fluctuation.
- ☐ Please Avoid not use of device for long time like 1 – 3 months.
- ☐ Magicstick has battery in built for protection from power fluctuation and power failure. It can give 5 to 10 mins backup when 100% charged. Please shutdown device when you have long time power failure or you are not using it.
- ☐ Prevent the corrosion of vapor and prevent liquid, debris drop in to the device.

# Opening package

## Open box and Bag



Open the box



Take out the bag



Open the bag

## Making ready power adapter.



Fix connector on adapter



Take out USB cable



Connect USB cable

# HOW TO START MAGICSTICK?

## STEP 1 : Connect power adapter to Magicstick



Connect USB port(red part) of power adapter to First 5V micro usb port of device.

## STEP 2 : Connect HDMI port to TV, Monitor , projector or any display device

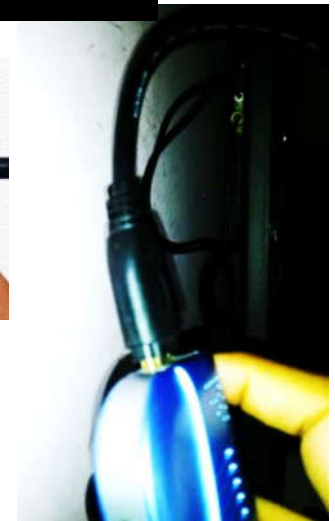
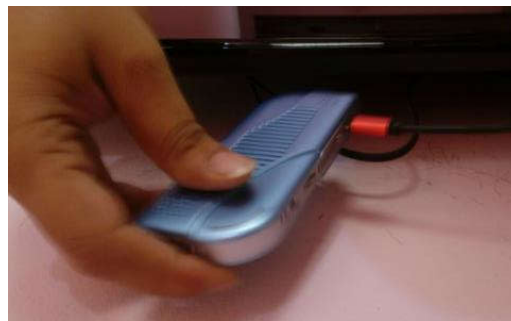

Remove the HDMI cap and connect it directly to TV or connect by HDMI cable provided in the package.

## STEP3 : Press start button of Magicstick to start magicstick

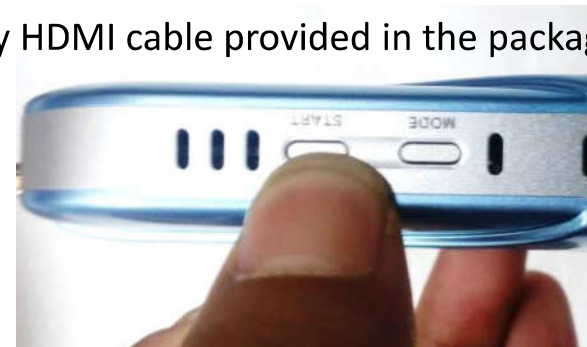

## STEP 4 : select OS

After pressing start button, Device will start and show OS selection screen for 10 seconds. You can select OS for your preference.

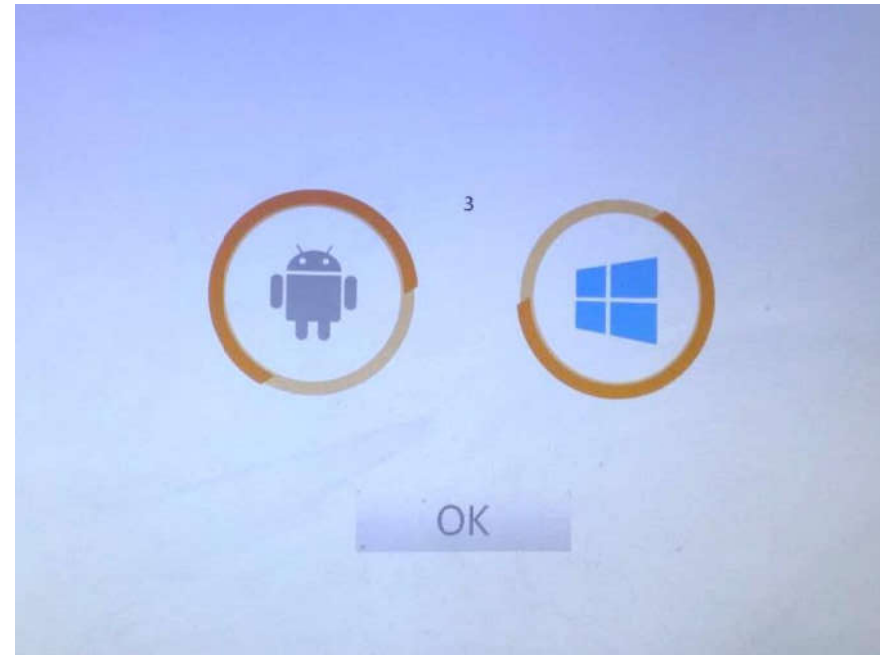

## How to boot in windows from Android

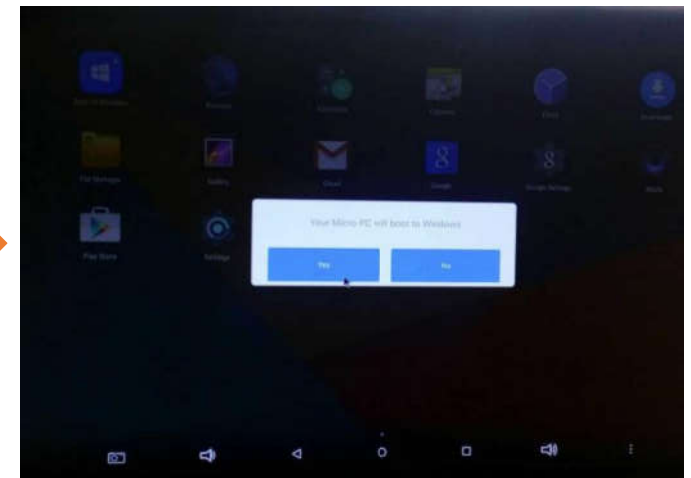
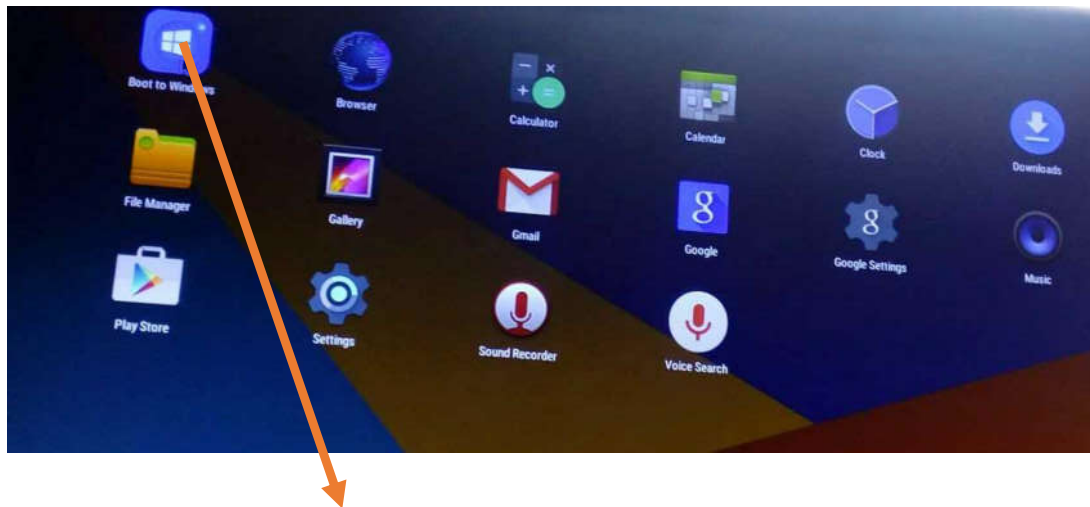

You can boot to windows from android by clicking and to windows App.



# How to boot in android from windows



1. Click win to android app

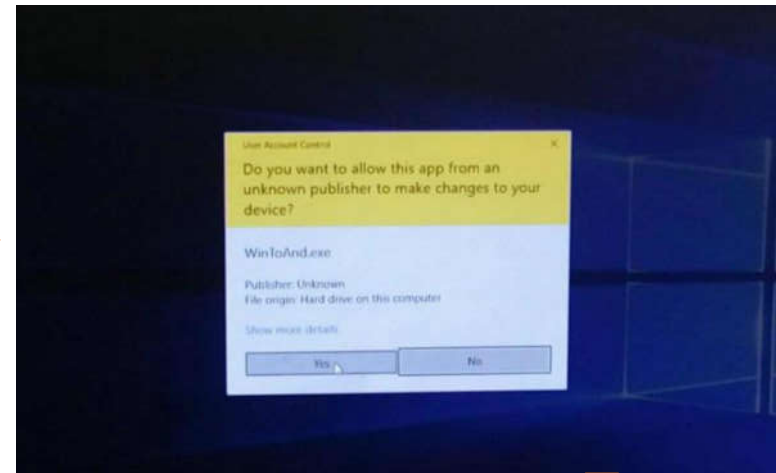

2. Click 'yes'

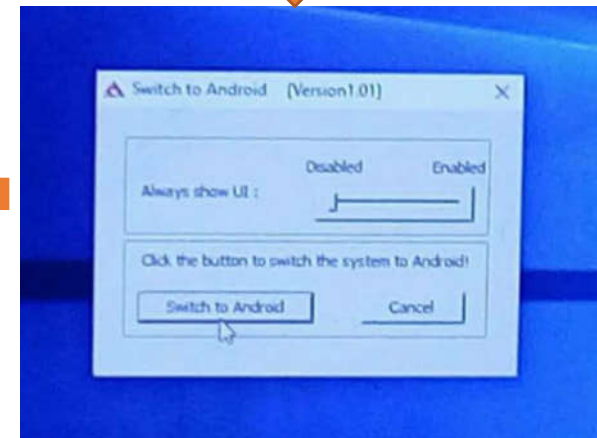

3. Click 'switch to Android'

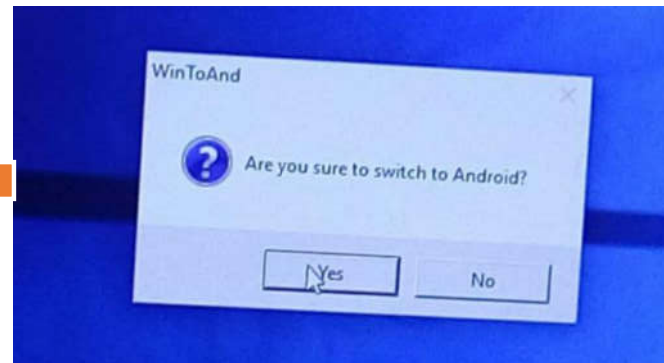

4. Click 'yes'



5. Click 'ok'

## IOT and Mobile apps

**NOTE : IOT Mobile app will be launched in June 2017. You will be notified once launched.**



IOT LED Light



IOT switch

**Dual Mode : USB Drive as well as computer mode and PC in to PC**



**NOTE : To run as dual mode, You need to press mode button.**

## Troubleshooting

**You should press start button for 10 s to shutdown the device in case of any trouble like display not coming and other issues. You should start device only after 20 s of shutting down.**

# Technical specifications

| CPU             | Intel cherry trail quad core Z8300           |
|-----------------|--|
| Gpu             | 12 core intel GPU                            |
| RAM             | 2GB DDR3L                                    |
| Emmc            | 32 GB  |
| Network         | Wifi 150 mbps speed and Bluetooth 4.0        |
| USB C TYPE      | 1 PORT with display, data and power delivery |
| USB 2.0         | 2 type A and one micro usb                   |
| Micro sdcard    | To extend storage support up to 128 GB       |
| Earphone socket | Microphone as well as Audio                  |
| IOT Module      | Inbuilt IOT module to use as IOT device      |

## Product interface

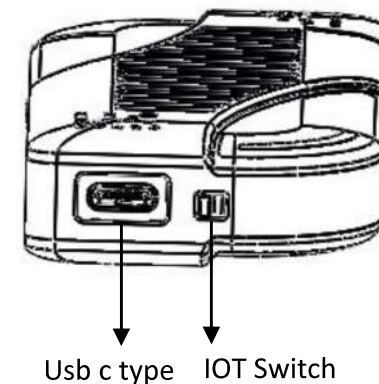
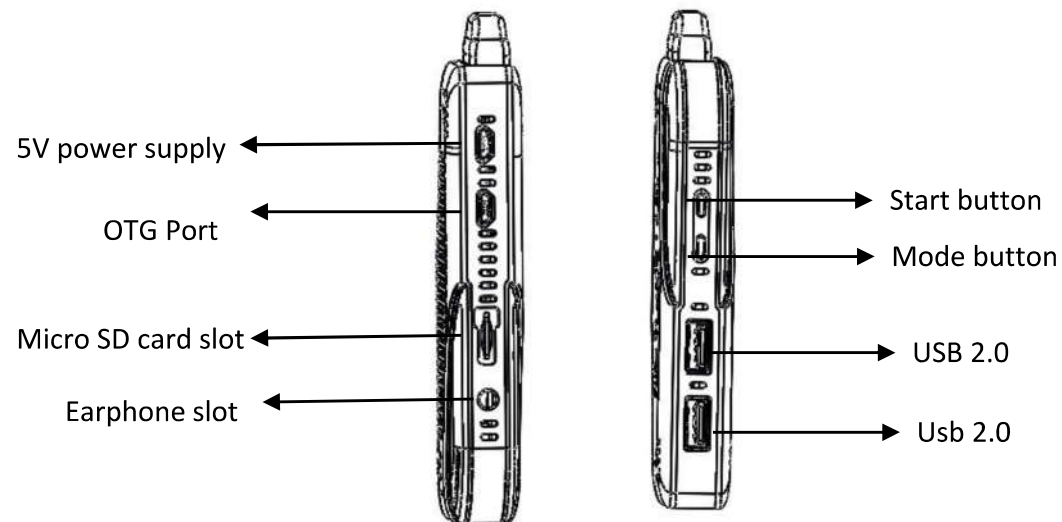



**FCC Warning:**

This equipment has been tested and found to comply with the limits for a Class B digital device, pursuant to part 15 of the FCC Rules. These limits are designed to provide reasonable protection against harmful interference in a residential installation. This equipment generates, uses and can radiate radio frequency energy and, if not installed and used in accordance with the instructions, may cause harmful interference to radio communications. However, there is no guarantee that interference will not occur in a particular installation. If this equipment does cause harmful interference to radio or television reception, which can be determined by turning the equipment off and on, the user is encouraged to try to correct the interference by one or more of the following measures:

Reorient or relocate the receiving antenna.

Increase the separation between the equipment and receiver.

Connect the equipment into an outlet on a circuit different from that to which the receiver is connected.

Consult the dealer or an experienced radio/TV technician for help.

Caution: Any changes or modifications to this device not explicitly approved by manufacturer could void your authority to operate this equipment.

This device complies with part 15 of the FCC Rules. Operation is subject to the following two conditions: (1) This device may not cause harmful interference, and (2) this device must accept any interference received, including interference that may cause undesired operation.

To comply with FCC RF exposure compliance requirements, this grant is applicable to only mobile configurations. The antennas used for this transmitter must be installed to provide a separation distance of at least 20 cm from all persons and must not be co-located or operating in conjunction with any other antenna or transmitter.

