

## WIFI CAMERA

### Quick Manual

#### Quick Operation Guide

##### Step 1 Download and install the App

Tips one: Scan the QR code below to download the "iCSee"App.



Tips two: Search "iCSee" in the App store and download.

##### Step 2 Turn on the power

Power on the camera, turn on the device, it will send "system starting up, wait be configured, Wait for the connection, please configure the network according to the Instructions" prompt after several seconds. If the camera does not have a prompt sound for a long time, you can press and hold the camera Reset button until you hear the prompt! Restore factory settings, please do not power off "and release it to restore the camera to factory settings and then configure the network.

##### Note:

If you need local storage, please install the memory card firstly, and then power on the device (the memory card does not support hot swapping, please plug and unplug the memory card when the device is powered off). Cloud storage is recommended, which is safe and convenient. Details See "Step 4" for operation.

##### Step 3 Configure the network of the camera

##### Bluetooth network configuration

Note: If the device supports Bluetooth network configuration, please configure it as follows.

- 1.Connect your phone to WiFi network and turn on Bluetooth.
- 2.Open the iCSee app, register an account and login(Figure 1).

Figure 1

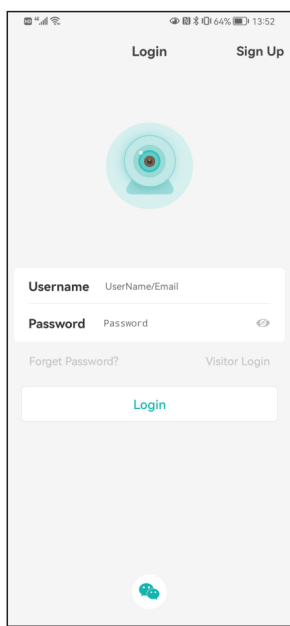

3.After successful login, Click the "+" button in the top right corner of the screen (Figure 2).

4.Click on the main interface to search for found devices (Figure 3) (if the camera is not searched please turn the phone Bluetooth off for 5 seconds and turn it back on, then search again or long press the camera Reset button to reset Search again).

Figure 2

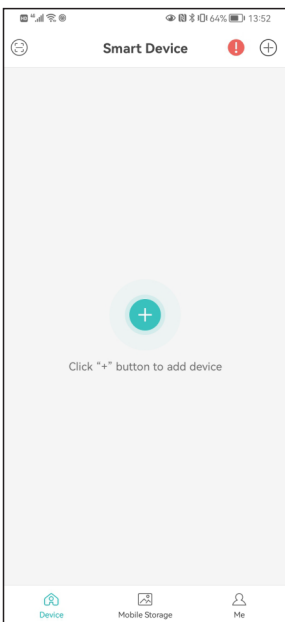
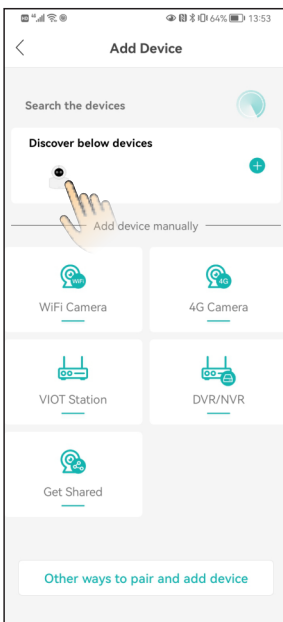

Figure 3



5.Enter the wireless router password and click "Confirm" (Figure 4).

6.Wait for the camera network configuration, when the camera emits the voice message "connecting, please wait, connect router successfully", the network configuration is successful (Figure 5).

Figure 4



Figure 5

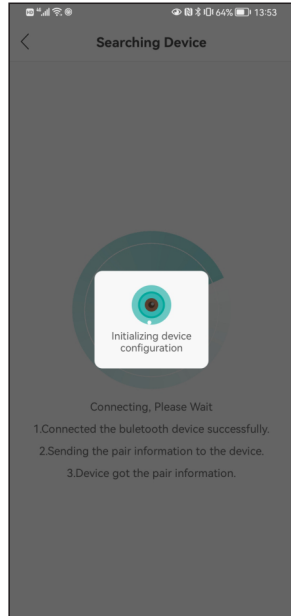

7.After the network configuration is successful, set the camera name(Figure 6).

8.Follow the APP interface to guide you through the setup. After the configuration is completed, the device is displayed in the device list interface. Click to open the real-time preview screen, and carry out relevant operations and settings(Figure 7).

Figure 6

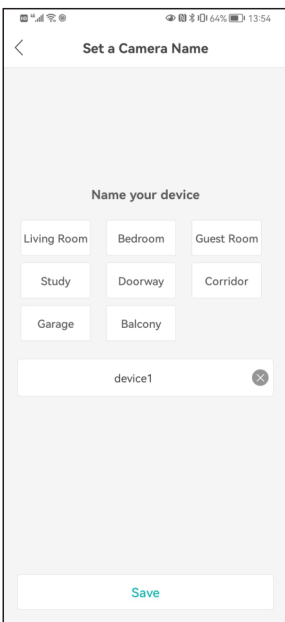
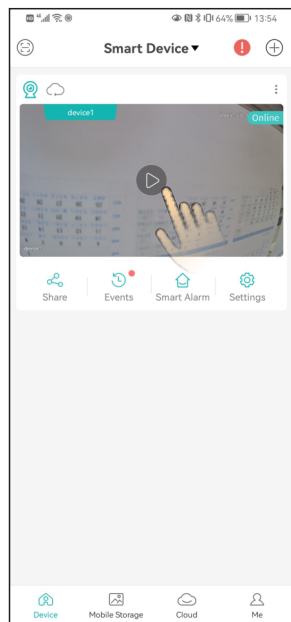

Figure 7



##### WiFi network configuration

Note: If the device does not support Bluetooth network configuration or Bluetooth network configuration fails, please configure it as follows.

- 1.Connect your phone to WiFi network .
- 2.Login to iCSee App, click "+" to add devices (Figure 8), and select "WiFi Camera" (Figure 9).
- 3.Set network configuration according to the camera's voice prompts and the APP interface step-by-step guide. When the camera emits a "Connect router successfully" prompt, it means that the camera has successfully configured the network.

Figure 8

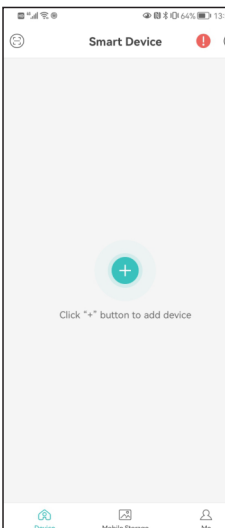
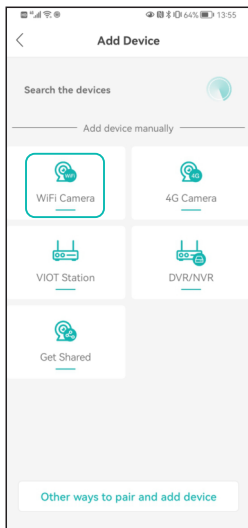

Figure 9



4.After the network configuration is successful, follow the instructions on the APP interface to set the camera password and name.

5.After the configuration is completed, the device is displayed in the device list interface. Click to open the real-time preview screen, and carry out relevant operations and settings(Figure 10).

Figure 10

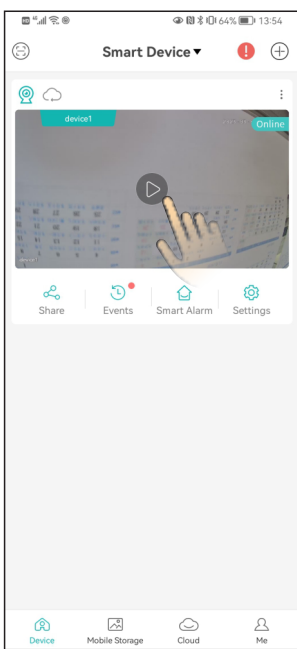

##### Step 4 Cloud Storage

Steps to open cloud storage: click the "cloud" icon in the device list interface (Figure 11), and follow the guidance of the app interface to understand and open the cloud storage package, with a variety of packages available.

Figure 11

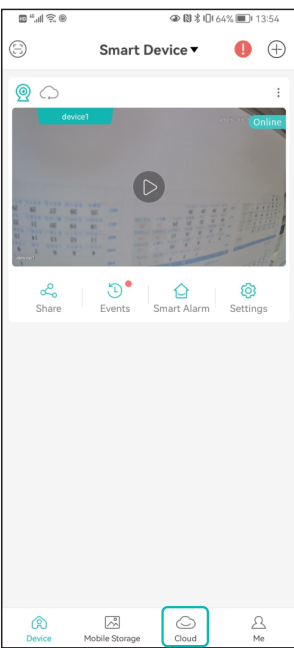

##### FAQ

##### Q: How do cameras store video?

- A: 1. Local TF card storage, maximum support up to 128G TF card after full automatically delete earlier video, overwrite video.  
2.Cloud storage.

##### Q: How to do if the camera is not connected or offline?

- A: 1. Check if the camera power or network of router normally .  
2.Plug the camera power to restart camera.  
3.Restore the camera to factory settings.

##### Q: Is 5g router supported ?

A : If you use 5g router, 5G and 2.4G use the same connection hotspot (that is, SSID is the same), you can connect directly. If 5G and 2.4G are not the same connection hotspot (that is, SSID is different, generally SSID of 2.4G is xxxxx-2.4G, SSID of 5G is xxxxx-5G), please connect WiFi of mobile phone to hotspot of xxxxx-2.4G of router before configuring camera.

##### Notice

1. Please change the user password while using this product to avoid being misappropriated by criminals.
2. Do not install the device in a place that is damp, dusty, or accessible to children.
3. Please use and store within the allowable temperature and humidity range, and do not disassemble the equipment at will.

##### Directions

1. Please refer to the actual product, the manual is for reference only.
2. The APP and product firmware will be updated from time to time. You can upgrade to the latest firmware online by yourself without notice. The manual is for reference only.
3. The manual may contain technically inaccurate parts or parts that are inconsistent with product functions or printed errors. Please refer to our company's final interpretation..

##### Warranty Card

Product Name		Model	
Purchase Date		Purchase Store	
Cause			
Process			
Customer Name		Customer Gender	
Customer Phone		ZIP	
Address			

Warranty period: one year.  
This warranty card is only for our company's products.

##### § 15.19 Labelling requirements.

This device complies with part 15 of the FCC Rules. Operation is subject to the following two conditions:  
(1) This device may not cause harmful interference, and  
(2) this device must accept any interference received, including interference that may cause undesired operation.

##### § 15.21 Information to user.

Any Changes or modifications not expressly approved by the party responsible for compliance could void the user's authority to operate the equipment.

##### Class B

##### § 15.105 Information to the user.

Note: This equipment has been tested and found to comply with the limits for a Class B digital device, pursuant to part 15 of the FCC Rules. These limits are designed to provide reasonable protection against harmful interference in a residential installation. This equipment generates uses and can radiate radio frequency energy and, if not installed and used in accordance with the instructions, may cause harmful interference to radio communications. However, there is no guarantee that interference will not occur in a particular installation. If this equipment does cause harmful interference to radio or television reception, which can be determined by turning the equipment off and on, the user is encouraged to try to correct the interference by one or more of the following measures: -Reorient or relocate the receiving antenna. -Increase the separation between the equipment and receiver. -Connect the equipment into an outlet on a circuit different from that to which the receiver is connected. -Consult the dealer or an experienced radio/TV technician for help.  
\*RF warning for Mobile device:This equipment complies with FCC radiation exposure limits set forth for an uncontrolled environment. This equipment should be installed and operated with minimum distance 20cm between the radiator & your body.