

User Manual

for 2in1 CarPlay & Andorid Auto wireless adapter series

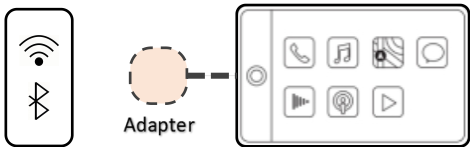

Pay Attention

1. Please turn on both Wi-Fi and Bluetooth on your phone
2. This adapter's bluetooth device name is smartBox-****.
3. Please read this manual carefully before use.
4. Suggest keeping this manual for future reference

1. Product Introduction

This adapter is mainly used to achieve wireless connection between mobile phones and cars with wired CarPlay or Android Auto functions.

Working principle:

The adapter first pairs with the phone by Bluetooth, and then switches to remain wireless connection and data transmission with the phone by WiFi. After a successful WiFi connection, the phone will automatically disconnect Bluetooth connection from adapter by default and connect to your car's Bluetooth.

What's in the box?

1pc wired to wireless adapter (CarPlay/Android Auto)
1pc USB-A to USB-C adapter

2. Compatibility Note

For Cars - Please make sure your car supports **wired** CarPlay or Andorid Auto

For iPhone - Required iPhone 6 or later models with iOS 10 or above for cars with wired **CarPlay**

For Android Phone - Required Android 10 or above for cars with wired **Android Auto**.

** If you have Android 9 or below, please get the Android Auto APP from Google Play. With Android 10, Android Auto is built in- so you don't need the APP to get started.*

Check if the car has CarPlay/Android Auto

Method 1 - Connect your iPhone or Android phone to your car via a USB cable and check for the presence of CarPlay or Android Auto icon on the car display screen.



Method 2 -Scan the QR code below to view **a list of compatible cars**, or contact your car manufacturer to see if your car has this feature.



CarPlay



Android Auto

3. Quick Guide

Cars with wired CarPlay can only be wirelessly connected to iPhones, and cars with wired Android Auto can only be wirelessly connected to Android phones.



Adapter

① Plug Start your car and car screen. Plug the adapter to the USB port for wired CarPlay or Android Auto on your car. The working indicator light of the adapter will light up

② Pair Turn on Bluetooth and Wi-Fi on your phone, and pair with the adapter. The adapter's bluetooth name is **smartBox-******. Allow all pop-up requests on your phone, such as "**Use Carplay**", "**□ Allow ...**", etc.

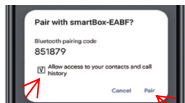
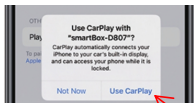

③ **Play** If the connection is successful, CarPlay or Android Auto UI will be displayed in a few seconds. Now you can access your favourite app.

④ **Auto Connect** After the first successful connection, the adapter will pair with the last used phone automatically when the phone is within the Bluetooth pairing range and WiFi + Bluetooth is on.



Adapter

FAQ

Q: What is the Wi-Fi password for the adapter?

A: Wi-Fi password is NOT required. After Bluetooth pairing, Wi-Fi will automatically connect. Please ensure that your Wi-Fi is turned on and not occupied.

Q: When using the adapter, can the phone access the internet by Wi-Fi?

A: No, you cannot. Because your phone's Wi-Fi has been occupied by the adapter. But you can use your phone's SIM card to access the internet.

Q: My adapter is not working. What should I do?

A: Before troubleshooting, please make sure that the working indicator light of the adapter is on, and confirm that the adapter is plugged into the correct USB port for wired CarPlay / Android Auto. Possible reasons are as follows:

① The car doesn't support CarPlay/Android Auto.

If your car supports CarPlay/Android Auto, you can find the icon of CarPlay / Android Auto on the screen.

② The car supports CarPlay/Android Auto, but it has not been activated. Please connect your phone and car with a USB cable and activate CarPlay /Android Auto function by a wired connection.

③ The phone doesn't support CarPlay/Android Auto.

If your phone supports CarPlay or Android Auto, you can find it in the settings on your phone by searching for the keyword - CarPlay or Android Auto.

④ The CarPlay/Android Auto version on the phone is too old. Please upgrade the system and app to the latest version. (iOS 10 /Android 10 and above)

⑤ Cache error affected Bluetooth connection.

Please turn off your phone's Bluetooth and enter the "Mobile Application Management" section of your

phone to search for "Clear Cache". After clearing the cache, re-plug the adapter and pair with the phone.

⑥ The car and the smart phone are not matched.

If your car supports CarPlay, you must use an iPhone to connect to the adapter. If your car supports Android Auto, you must use an Android phone to connect to the adapter.

⑦ You think your mobile phone has been paired with the adapter successfully. In fact, your mobile phone has been paired with other Bluetooth device.

Please ensure that only the adapter and your phone's Bluetooth are turned on inside the car. This can prevent situations where the adapter is paired with someone else's phone, or your phone is paired with other Bluetooth devices.

⑧ The Wi-Fi of your mobile phone is not turned on.

Wi-Fi is required for data transmission in wireless

connection. Please ensure your phone's Wi-Fi is on.

⑨ During the waiting period, the user plugged in and out the adapter. After pairing, some cars have to wait for a while to see the UI of Carplay/Android. Please wait patiently. Don't move the adapter and ensure that Bluetooth and Wi-Fi remain on and not occupied.

Q: Encountering issues related to audio input and output, such as call rejection or transfer to voice mailbox, no sound, microphone not working, etc.

A: ① Please check your phone's Bluetooth to see if it is connected to another device. If so, please disconnect and pair with car again.

② During a call, please check if your "audio output" option is Carplay/Android Auto.

Q: Unable to automatically reconnect

A: ① When getting on the car, please make sure that the Bluetooth and Wi-Fi on your phone are turned on and the Bluetooth is not occupied.

② Clear the Bluetooth pairing record on the phone, restart the phone, and re-pair with the adapter

③ A few cars have compatibility issues and require plug in and out the adapter before reconnecting.

Q: Both my wife and I connected to this adapter before, and it always automatically connects to my wife's phone when we are all in the car.

A: Turn off the Bluetooth on your wife's phone before starting the car.

Q: Can the adapter pair with multiple phones?

A: The adapter can pair to Max. 5 phones, but can only pair one device at a time. If you want to pair it with a new phone, please disconnect the current connection first. Please note that according to the

default settings of Bluetooth, the adapter will only automatically connect to the last used phone.

Q: Does it support watching YouTube Video

A: Wireless CarPlay does not support YouTube, but Wireless Android Auto can support it. Please follow these steps: Run Google Chrome → Type "AAADAPK" → Download APK → Run "AAAD" → Download "Carstream" → Run "Carstream" → Enter Settings → Select "Enable Desktop Mode", then you can enjoy videos on YouTube by wireless Android auto.

IC Warning

This device complies with Industry Canada licence-exempt RSS standard(s). Operation is subject to the following two conditions:

- (1) This device may not cause interference, and
- (2) This device must accept any interference, including interference that may cause undesired operation of the device.

Le présent appareil est conforme aux CNR d'Industrie Canada applicables aux appareils radio exempts de licence. L'exploitation est autorisée aux deux conditions suivantes:

- (1) l'appareil ne doit pas produire de brouillage, et
- (2) l'utilisateur de l'appareil doit accepter tout brouillage radioélectrique subi, même si le brouillage est susceptible d'en compromettre le fonctionnement

*RF warning for Mobile device:

This equipment complies with IC radiation exposure limits set forth for an uncontrolled environment. This equipment should be installed and operated with minimum distance 20cm between the radiator & your body.

L'appareil a été évalué pour répondre aux exigences générales d'exposition aux RF. Cet équipement doit être installé et utilisé avec une distance minimale de 20 cm entre le radiateur et votre corps.

FCC Caution.

This device complies with part 15 of the FCC Rules. Operation is subject to the following two conditions:

- (1) This device may not cause harmful interference, and
- (2) this device must accept any interference received, including interference that may cause undesired operation.

Any Changes or modifications not expressly approved by the party responsible for compliance could void the user's authority to operate the equipment.

Note: This equipment has been tested and found to comply with the limits for a Class B digital device, pursuant to part 15 of the FCC Rules. These limits are designed to provide reasonable protection against harmful interference in a residential installation. This equipment generates uses and can radiate radio frequency energy and, if not installed and used in accordance with the instructions, may cause harmful interference to radio communications. However, there is no guarantee that interference will not occur in a particular installation. If this equipment does cause harmful interference to radio or television reception, which can be determined by turning the equipment off and on, the user is encouraged to try to correct the interference by one or more of the following measures:

- Reorient or relocate the receiving antenna.
- Increase the separation between the equipment and receiver.
- Connect the equipment into an outlet on a circuit different from that to which the receiver is connected.
- Consult the dealer or an experienced radio/TV technician for help.

FCC Radiation Exposure Statement:

This equipment complies with FCC radiation exposure limits set forth for an uncontrolled environment. This equipment should be installed and operated with minimum distance 20 cm between the radiator & your body.