

EAPIL

EPN-C12

User manual

User Guide

Product Introduction

Package List

Panorama Camera x1, Charging Cable x1, Power Adaptor x1, Reset Needle x1, User Guide x1, Three-Guarantee Voucher x1

Names of Parts

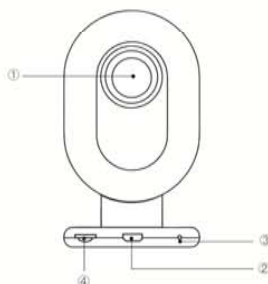

- ① Lens
- ② Micro USB Port
- ③ Reset Hole
- ④ Micro SD Card Slot

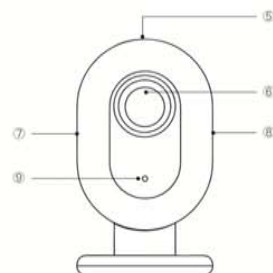

- ⑤ Infrared Light
- ⑥ Lens
- ⑦ Loudspeaker
- ⑧ Microphone
- ⑨ Indicator Light

Indicator Light Status

Red always: Initiating / Malfunction
Red flashing: Waiting for connection
Green flashing: Network connecting
Green always: Functioning
Green flashing in long intervals: Real-time video being viewed by mobile terminal

Basic Parameters

Product Name: Eapil Pano C Panorama Camera
Product Size: 96×55×55mm
Product Model: EPN-C12
Product Weight: 155g
Power Input: 5V/2A
Pixels: 4 Million
Resolution: 2592×1520
Field of View: Horizontal 360° x Vertical 360°
Work Temperature: -10°C ~ 50°C
Wi-Fi Standards: Wi-Fi IEEE802.11b/g/n 2.4GHz
Storage: Micro SD Card (Not provided; maximum storage supported: 128G; class10-supported ones are recommended)
System Supported: Android4.4 / IOS8.0 or Higher

Product Connection Instruction

Install APP

Scan the QR code below to download and install "Eapil Panorama" App.



Android/iOS

Power Up and Initiate Your Camera

Plug the charging cable into the Micro USB port at the bottom of the camera to power it up until the indicator light is red and constantly lit. Seconds later the indicator light turns to green flashing indicating the camera is waiting for connection.

Note: Use the standard power adaptor lest malfunction be caused.

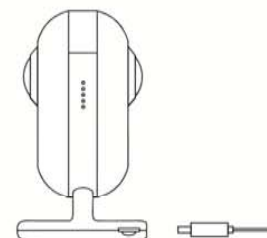

Network Connection

Open App, find the corresponding device (Eapil Pano C) and click on "Connect".



Scan the QR code on your phone using any lens of the camera. The indicator light will turn green after successful connection of network.

Product Function Specifications

Real-time Viewing

- You can view the real-time panorama of the camera's surroundings 24/7.
- The infrared light will be turned on automatically during nighttime (Can be turned off in settings) to ensure normal performance at night.



Daytime



Nighttime

History Playback

- Insert Micro SD card to record history videos.
- You can view history videos via phone APP or PC after importing the contents of the SD card to the computer (Please download PC panoramic video player from the official website of Eapil).

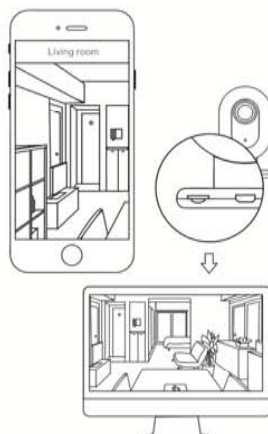

Two-way Voice Intercom Function

- Tap Voice button on your phone to initiate two-way voice intercom function.

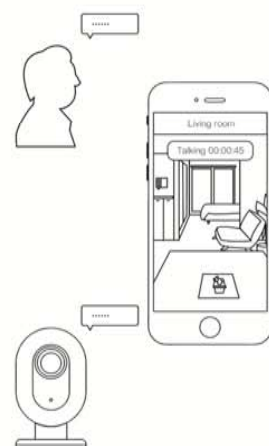

Motion Detection

- The camera can discern every movement in its detection range once the function of motion detection is initiated. Should it detect any suspicious motion during the preset time period, it would send notification to your phone to keep you informed of any unusual states inside your home at any time.
- You can set the time period and range of motion detection according to your own circumstances.



FCC Statement

This device complies with Part 15 of the FCC rules. Operation is subject to the following two conditions: 1) this device may not cause harmful interference, and 2) this device must accept any interference received, including interference that may cause undesired operation.

Note: This equipment has been tested and found to comply with the limits for a Class B digital device, pursuant to part 15 of the FCC Rules. These limits are designed to provide reasonable protection against harmful interference in a residential installation.

This equipment generates uses and can radiate radio frequency energy and, if not installed and used in accordance with the instructions, may cause harmful interference to radio communications. However, there is no guarantee that interference will not occur in particular installation. If this equipment does cause harmful interference to radio or television reception, which can be determined by turning the equipment off and on, the user is encouraged to try to correct the interference by one or more of the following measures:

- Reorient or relocate the receiving antenna.
 - Increase the separation between the equipment and receiver.
 - Connect the equipment into an outlet on a circuit different from that to which the receiver is connected.
 - Consult the dealer or an experienced radio/TV technician for help.
- Changes or modifications not expressly approved by the party responsible for compliance could void the user's authority to operate the equipment.

FCC Radiation Exposure Statement

This device complies with FCC RF radiation exposure limits set forth for an uncontrolled environment. This transmitter must not be co-located or operating in conjunction with any other antenna or transmitter. This device must operate with a minimum distance of 20 cm between the radiator and user body.